

STEERING LEVERS, STEERING CLUTCH

BB 440  
A

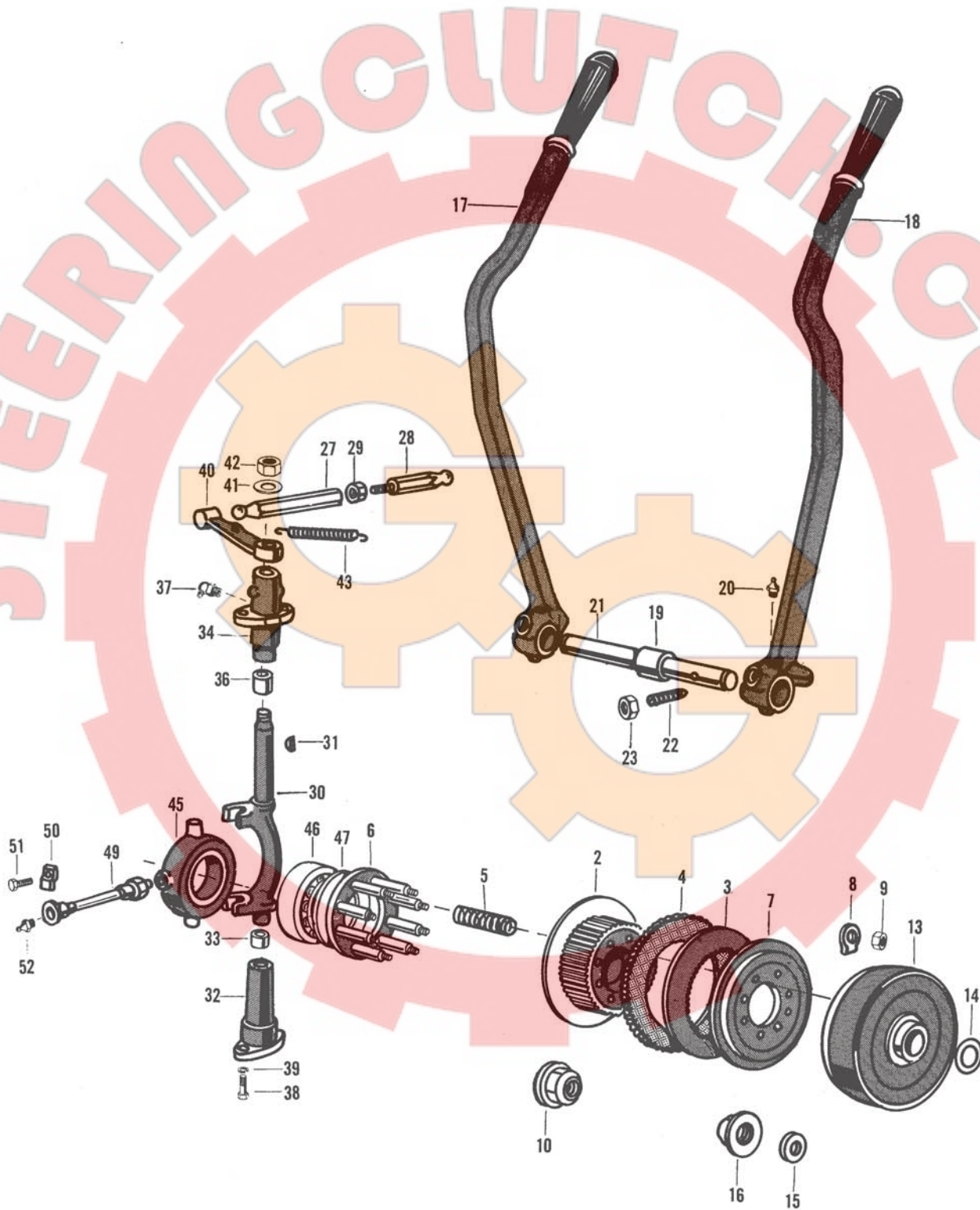

STEERING LEVERS, STEERING CLUTCH

Ref. No.	Part No.	Description	No. Req.
1	492 712 M91	Clutch Assembly, Steering.....	2
2	975 742 M1	Drum, Driving Plate.....	1
3	975 743 M1	Plate, Driving.....	8
4	975 744 M1	Plate, Driven.....	8
5	975 745 M1	Spring, Pressure.....	8
6	975 746 M93	Retainer Assembly, Spring.....	1
7	975 749 M2	Plate, Pressure.....	1
8	1 441 407 X1	Washer, Safety Lock.....	8
9	339 252 X1	Nut, Spring Retaining (12 MM - 1.75, Half Hex.).....	8
10	975 752 M1	Nut, Shaft (24 MM - 2.0 Hex., Special).....	1
13	975 750 M1	Drum, Outer.....	2
14	975 751 M1	Gasket, Drum.....	2
15	975 753 M1	Washer, Drum.....	2
16	975 752 M1	Nut, Drum Retaining (24 MM - 2.0 Hex., Special).....	2
17	977 632 M92	Lever Assembly, Steering, Left.....	1
18	977 633 M92	Lever Assembly, Steering, Right.....	1
19	975 697 M1	Bushing, Lever.....	2
20	365 572 X1	Grease Fitting (1/8" P.T., Str.)(Order 1900 482 M91, Pkg. of 10)	2
21	973 383 M1	Shaft, Lever.....	1
22	1 440 265 X1	Screw, Shaft (8 MM - 1.25 x 25 Sstd. Cone Pt., Set).....	1
23	339 169 X1	Nut, Screw (8 MM - 1.25, Hex.).....	1
27	973 384 M1	Link, Ball, Female.....	2
28	973 385 M1	Link, Ball, Male.....	2
29	1 440 219 X1	Nut, Link Adjusting (10 MM - 1.0, Half Hex.).....	2
30	973 386 M3	Fork, Steering Clutch.....	2
31	1 440 365 X1	Key, Woodruff.....	2
32	975 700 M1	Support, Fork, Lower.....	2
33	975 701 M1	Bushing, Support, Lower.....	2
34	1 452 321 M91	Support, Fork, Upper.....	2
36	975 703 M1	Bushing, Fork, Upper.....	4
37	13 533 X	Grease Fitting (1/8" P.T., 90°)(Order 1900 486 M91, Pkg. of 10)	2
38	339 451 X1	Bolt, Support Attaching (10 MM - 1.50 x 28 MM, Hex.).....	8
39	353 432 X1	Washer (7/16" Lock).....	8
40	973 390 M2	Arm, Steering, Left.....	1
40	973 391 M2	Arm, Steering, Right.....	1
41	353 774 X1	Washer, Arm (5/8" Heavy Flat).....	2
42	1 440 239 X1	Nut, Arm Retaining (16 MM - 1.50, Half Hex.).....	2
43	973 157 M1	Spring, Steering Arm Return.....	2
	975 704 M92	Bearing and Sleeve Assembly, Clutch Release.....	2
45	975 705 M1	Sleeve, Bearing.....	1
46	1 441 038 X1	Bearing, Clutch Release.....	1
47	973 394 M2	Screen, Clutch Release Bearing.....	1
49	977 624 M1	Hose Assembly, Bearing Lubrication.....	2
50	973 141 M1	Plate, Hose Attaching.....	2
51	339 124 X1	Bolt, Plate Attaching (8 MM - 1.25 x 16 MM, Hex.).....	2
52	365 572 X1	Grease Fitting (1/8" P.T., Str.)(Order 1900 482 M91, Pkg. of 10)	2