

TRANSMISSION

REF. NO.	PART NUMBER	DESCRIPTION
----------	-------------	-------------

TRANSMISSION GEAR SHIFTER MECHANISM (TD-91)

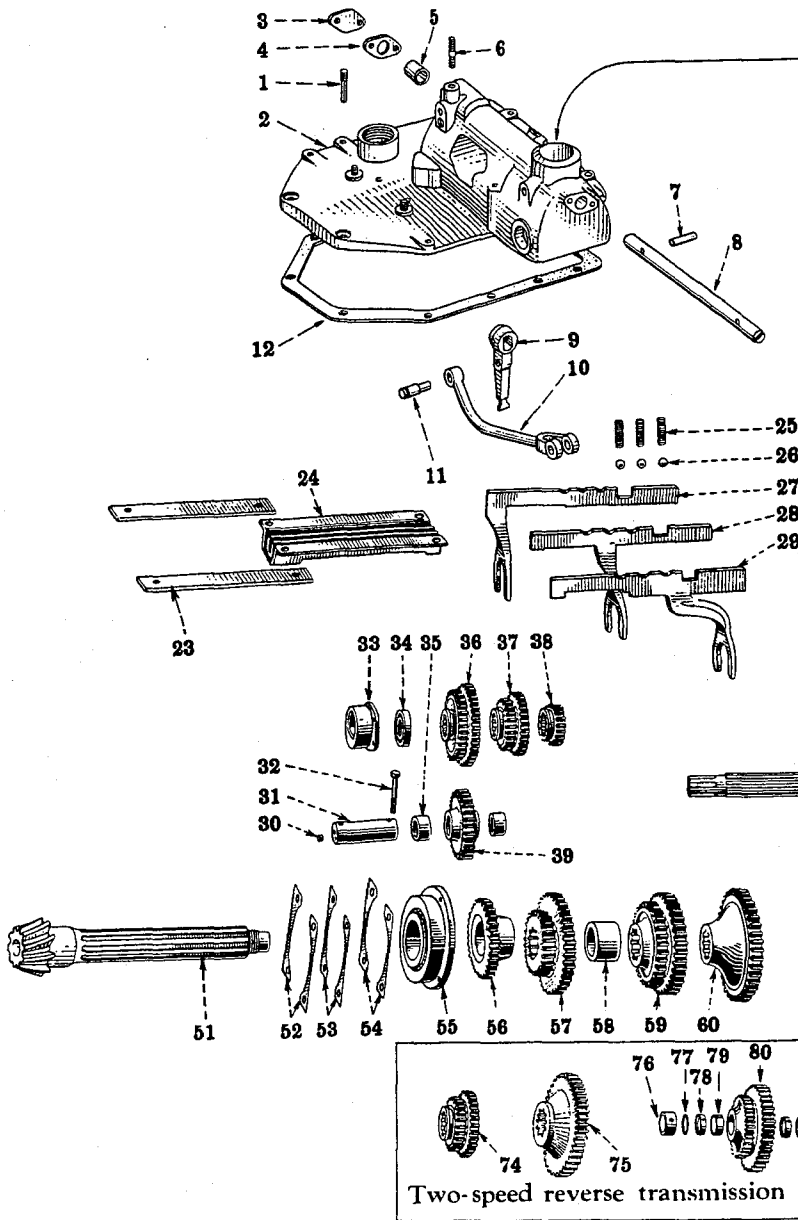

TRANSMISSION

REF. NO.	PART NUMBER	DESCRIPTION
----------	-------------	-------------

TRANSMISSION GEAR SHIFTER MECHANISM (TD-91) - Continued

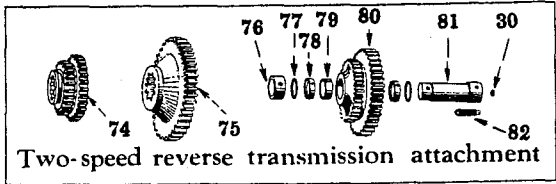
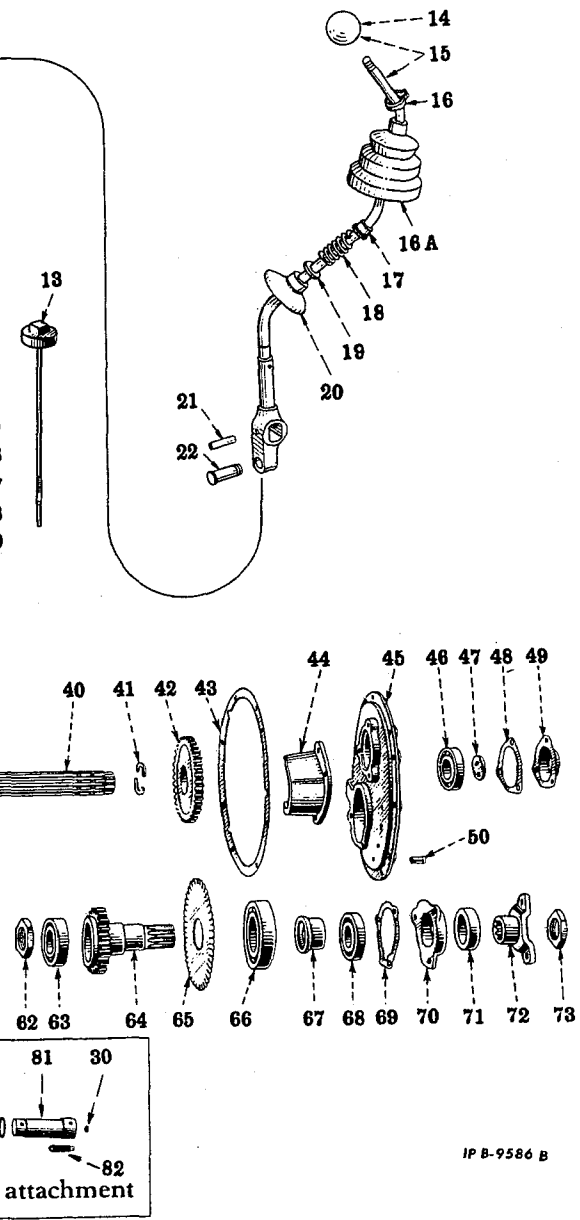

IP 8-9586 B

1	18 585 DA	DOWEL, transmission gear shifter housing main frame (2)
2	275 738 R11	HOUSING ASSEMBLY, transmission gear shifter (not odometer attachment) (together w/four PLUGS, 172 529 and three PLUGS, 172 574 will work for 276 030 R91) (Composed of - 2 ANCHOR 50 826 D 1 BUSHING 276 156 R1 51 HOUSING 1 STUD 41 633 D)

3	275 226 R1	COVER, transmission gear shift lever shaft end (2) 3/8 x 5/8" hex-hd. cap SCREW (4) 3/8" lock WASHER (4)
4	275 225 R1	GASKET, transmission gear shift lever shaft end cover (2)

6 - Not Furnished Separately



TRANSMISSION

REF. NO.	PART NUMBER	DESCRIPTION
TRANSMISSION GEAR SHIFTER MECHANISM (TD-91) - Continued		
5	276 156 R1	BUSHING, shifter lever shaft
6	41 633 D	STUD, platform
7	277 037 R1	PIN, transmission gear shift hand lever upper (will work for 577 139 R1)
8	275 744 R1	SHAFT, transmission gear shift lever upper
9	275 747 R12	LEVER w/PIN, 275 748 R2, transmission gear shift
10	275 745 R11	LINK w/CLEVIS, transmission gear shift selector
11	275 748 R2 148 152	PIN, transmission gear shift lever lower SPRING, 1/2" retainer
12	53 486 D	GASKET, transmission gear shifter housing
13	53 683 DA	ROD w/PLUG and SHIELD, transmission oil level
14	264 055 R2	BALL, transmission gear shift hand lever
15	275 739 R12	LEVER, transmission gear shift hand (together w/BALL, 264 055 R2 will work for 275 741 R91)
16	64 604 D	CLAMP, transmission gear shift hand lever boot
16A	275 742 R1	BOOT, transmission gear shift hand lever
17	11 373 D	STOP, transmission gear shift hand lever swivel shield spring upper 3/16 x 1-1/4" rd-hd. RIVET (iron)
18	29 547 D	SPRING, transmission gear shift hand lever swivel shield
19	17 700 D	STOP, transmission gear shift hand lever swivel shield spring lower
20	275 743 R1	SHIELD, transmission gear shift hand lever swivel
21	277 037 R1	PIN, transmission gear shift hand lever upper (will work for 577 139 R1)
22	275 746 R1 148 152	PIN, transmission gear shift hand lever lower SPRING, 1/2" retainer
23	62 779 D	LOCK, gear shifter rail guide support bolt (2)
24	69 466 DA	GUIDE, gear shifter rail 3/8 x 3/4" hex-hd. cap SCREW (4)
25	64 163 D	SPRING, gear shifter rail poppet (3)
26	D 2 616	POPPET, gear shifter rail (grade 3, 1/2" steel ball) (optional with 13 722 D) (3)
26	13 722 D	POPPET, gear shifter rail (grade 4, 1/2" steel ball) (optional with D 2 616) (3)
27	53 480 DA	RAIL and FORK, fourth and fifth gear shifter
28	53 481 DA	RAIL and FORK, second and third gear shifter
29	69 464 DB	RAIL and FORK, low and reverse gear shifter
	50 826 D	ANCHOR, steering clutch release lever return spring (2)



TRANSMISSION

REF. NO.	PART NUMBER	DESCRIPTION
TRANSMISSION (Five Speeds Forward, One Reverse) (TD-91)		
30	45 361 D	PLUG, transmission reverse idler gear shaft
31	46 905 DX	SHAFT w/PLUG, 45 361 D, transmission, reverse idler gear
32	4 457 D	BOLT, transmission reverse idler gear shaft 3/8NF slt-hex. NUT 3/32 x 3/4" cotter PIN
33	6 477 DA	CAGE, transmission spline shaft rear bearing 3/8 x 7/8" hex-hd. cap SCREW (2) 3/8" lock WASHER (2)
34	272 478 R91	BEARING, transmission spline shaft rear
35	46 904 DR	BUSHING, transmission reverse idler gear (2)
36	271 861 R1	GEAR, sliding transmission fourth and fifth speed (33 and 38 T)
37	63 256 DA	GEAR, sliding transmission second and third speed (24 and 29 T) (not used with two speed reverse transmission attachment)
38	258 626 R3	GEAR, transmission first and reverse speed sliding (19 T)
39	52 237 DAX	GEAR, transmission reverse idler (33 T) (not used with two speed reverse transmission attachment)
40	258 625 R2	SHAFT, transmission spline
41	53 632 DX	COLLAR, transmission driven gear split (two halves)
42	52 211 D	GEAR, transmission driven (39 T)
43	46 918 D	GASKET, transmission end cover
44	8 779 D	POCKET, transmission end cover oil 5/16 x 7/8" hex-hd. cap SCREW (3) 5/16" lock WASHER (3)
45	6 480 DC	COVER, transmission end 7/16NF NUT (4) 7/16 x 1-1/4" hex-hd. cap SCREW (4) 7/16" lock WASHER (8)
46	ST 238	BEARING, transmission spline shaft front
47	45 357 D	WASHER, transmission spline shaft bearing retainer front 7/16 x 1" hex-hd. cap SCREW (2) 7/16" lock WASHER (2)
48	46 913 D	GASKET, transmission spline shaft front bearing retainer
49	46 912 D	RETAINER, transmission spline shaft bearing front 3/8 x 3/4" hex-hd. cap SCREW (3) 3/8" lock WASHER (3)
50	45 132 D	PIN, transmission end cover dowel
51	279 337 R1	PINION and SHAFT, bevel (10 T) (will work for 271 859 R1)
51	279 339 R91	PINION and SHAFT, bevel, 279 337 R1 w/GEAR, 279 338 R1 (matched pair) (will work for 271 858 R91) (See NOTE)
NOTE - Also listed and illustrated under heading STEERING SYSTEM - "Drive Bevel Gear".		



TRANSMISSION

REF. NO.	PART NUMBER	DESCRIPTION
TRANSMISSION (Five Speeds Forward, One Reverse) (TD-91) - Continued		
52	53 635 D	SHIM, bevel pinion and shaft rear bearing cage (heavy) (X)
53	53 636 D	SHIM, bevel pinion and shaft rear bearing cage (medium) (X)
54	53 637 D	SHIM, bevel pinion and shaft rear bearing cage (light) (X)
54	250 307 R1	SHIM, bevel pinion and shaft rear bearing cage (extra light) (X)
55	271 863 R91	BEARING, bevel pinion and shaft rear 1/2 x 1-5/8" hex-hd. cap SCREW (4) 1/2" lock WASHER (4)
56	271 860 R1	GEAR, transmission fourth speed (32 T)
57	52 213 DA	GEAR, transmission second and fifth speed (27 and 41 T)
58	46 859 D	SPACER, bevel pinion shaft
59	63 255 DA	GEAR, transmission third and reverse speed (36 and 41T) (not used with two speed reverse transmission attachment)
60	52 215 DA	GEAR, transmission first speed (46 T)
62	279 733 R1	NUT, bevel pinion and shaft lock (will work for 46 887 D)
63	ST 200	BEARING, bevel pinion shaft front
64	262 751 R2	SHAFT and GEAR, transmission driving (26 T)
65	262 752 R1	SLINGER, transmission oil
66	272 480 R91	BEARING, transmission driving shaft rear
67	6 478 D	SPACER, transmission driving shaft bearing
68	ST 216	BEARING, transmission driving shaft front
69	46 916 D	GASKET, transmission driving shaft bearing retainer front
70	6 479 DB	RETAINER, transmission driving shaft bearing front 3/8 x 1" hex-hd. cap SCREW (3) 3/8" lock WASHER (3)
71	279 749 R91	OIL SEAL, transmission driving shaft
72	52 208 D	COUPLING, transmission drive
73	255 630 R1	NUT, transmission drive coupling retaining
74	260 153 R1	GEAR, transmission second and high reverse sliding (24 and 28 T) (⊕)
75	260 151 R1	GEAR, transmission high and low reverse speed (41 T) (⊕)
76	279 433 R1	SLEEVE, reverse idler gear shaft (⊕)
77	279 427 R1	RING, high and low reverse idler gear snap (⊕) (2)
78	279 466 R91	BEARING, high and low reverse idler gear (⊕) (2)



TRANSMISSION

REF. NO.	PART NUMBER	DESCRIPTION
TRANSMISSION (Five Speeds Forward, One Reverse) (TD-91) - Continued		
79	279 432 R1	SPACER, high and low reverse idler gear (⊕)
80	260 152 R11	GEAR, transmission high and low reverse idler (order 279 437 R91) (⊕)
80	279 431 R1	GEAR, transmission high and low reverse idler (24 and 33 T) (⊕)
81	279 435 R11	SHAFT w/PLUG, 45 361 D, reverse idler gear (⊕)
82	279 434 R91	STRAINER, oil reverse idler (⊕)
	275 772 R92	ATTACHMENT, two speed reverse transmission Factory Application - Order on Machine Order Form. Field Application - Order through Regular Service Parts Channels. (Composed of - 1 DECAL 2 750 008 R1 2 BEARING 279 466 R91 1 GASKET 46 913 D 1 GASKET 46 918 D 1 GASKET 53 486 D 1 GEAR 260 151 R1 1 GEAR 279 431 R1 1 GEAR 260 153 R1 2 RING 279 427 R1 1 SHAFT 279 435 R11 1 SLEEVE 279 433 R1 1 SPACER 279 432 R1 1 STRAINER 279 434 R91)
	2 750 005 R1	DECALCOMANIA, shifting diagram
	2 750 008 R1	DECALCOMANIA, shifting diagram (⊕)
	279 437 R91	PACKAGE, high and low reverse idler gear field service (service for 260 152 R11) (⊕) (Composed of the following parts - 2 BEARING 279 466 R91 1 GEAR 279 431 R1 2 RING 279 427 R1 1 SHAFT 279 435 R11 1 SLEEVE 279 433 R1 1 SPACER 279 432 R1 1 STRAINER 279 434 R91)
	175 529	PLUG, 5/8" expansion (4)
	172 574	PLUG, 1-1/2" expansion (3)

(⊕) - Used only on tractors equipped with "two speed reverse transmission attachment."
X - As Required