

STEERING CLUTCH

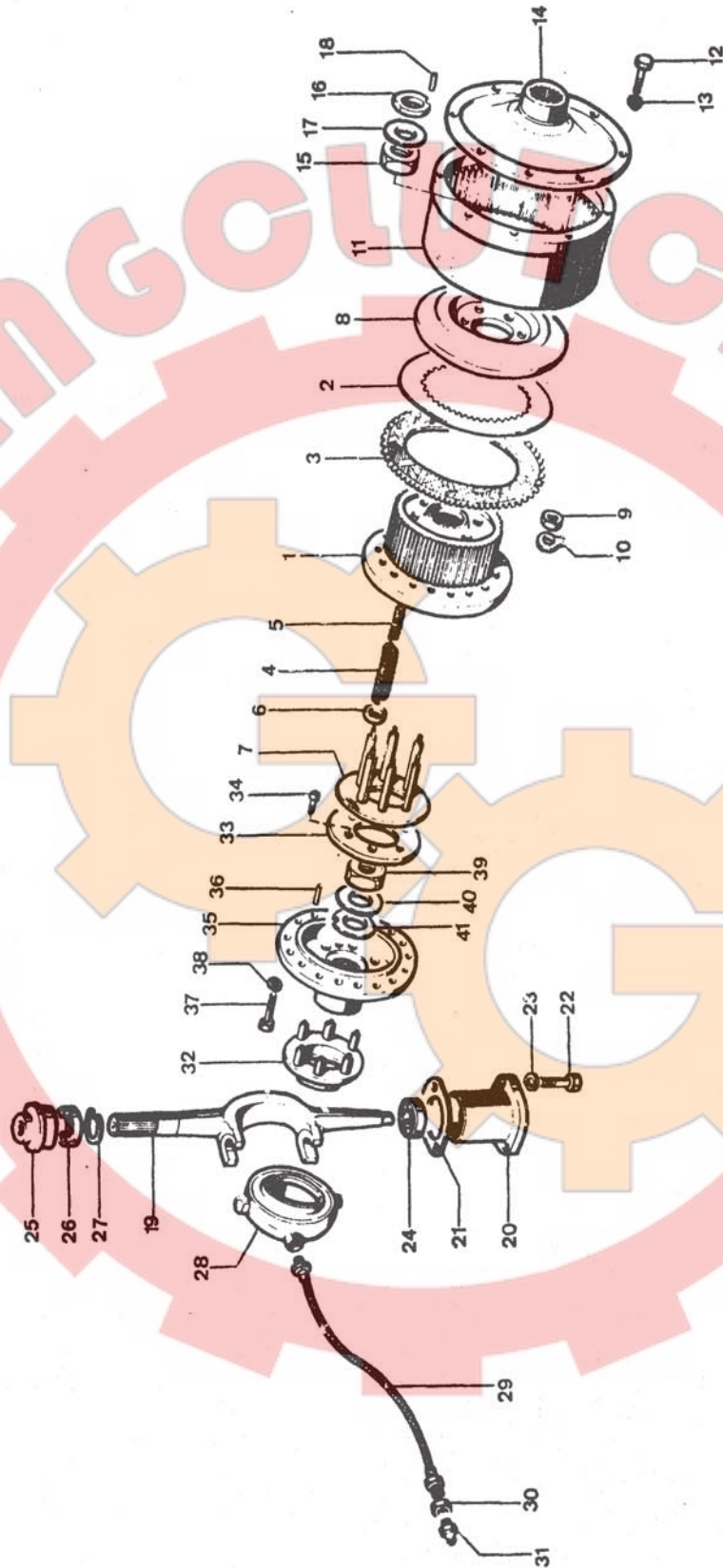

N.te	Ref.	MF numbers	Q.ty	Description	Denominazione	Description	Désignation	Benennung
		980 798 M92	2	Steering clutch (c/w ref. 1 to 10)				
	1	980 122 M3	2	Drum				
	2	980 131 M1	22	Plate driving				
	3	980 130 M1	22	Plate driven				
	4	980 128 M1	12	Spring outer				
	5	980 127 M2	12	Spring inner				
	6	980 129 M2	24	Washer				
	7	980 122 M92	2	Plate pressure assy				
	8	980 125 M2	12	Pin				
	9	980 126 M3	2	Plate				
	10	339 070 X1	12	Nut				
	11	1441 533 X1	12	Lock				
	12	980 135 M1	2	Drum				
	13	391 863 X1	24	Bolt				
	14	1440 314 X1	24	Lockwasher				
	15	980 132 M3	2	Housing				
	16	1440 243 X1	2	Nut				
	17	980 121 M3	2	Washer				
	18	980 120 M3	2	Tabwasher				
	19	339 806 X1	2	Dowel				
	20	981 284 M2	2	Fork				
	21	980 856 M1	2	Support				
		980 107 M1		Shim 0,1 mm				
		980 108 M1		Shim 0,2 mm				
		980 109 M1		Shim 0,5 mm				
		980 110 M1		Shim 1 mm				
	22	391 870 X1	4	Bolt				
	23	1440 316 X1	4	Lockwasher				
	24	1440 565 X1	2	Bearing				
	25	980 038 M3	2	Support				
	26	1440 563 X1	2	Bearing				
	27	1440 515 X1	2	Circlip				
	28	980 111 M94	2	Sleeve				
		980 112 M2	2	Ring				
		2736 868 M91	2	Bearing				
		980 113 M2	2	Screen				

STEERING CLUTCH

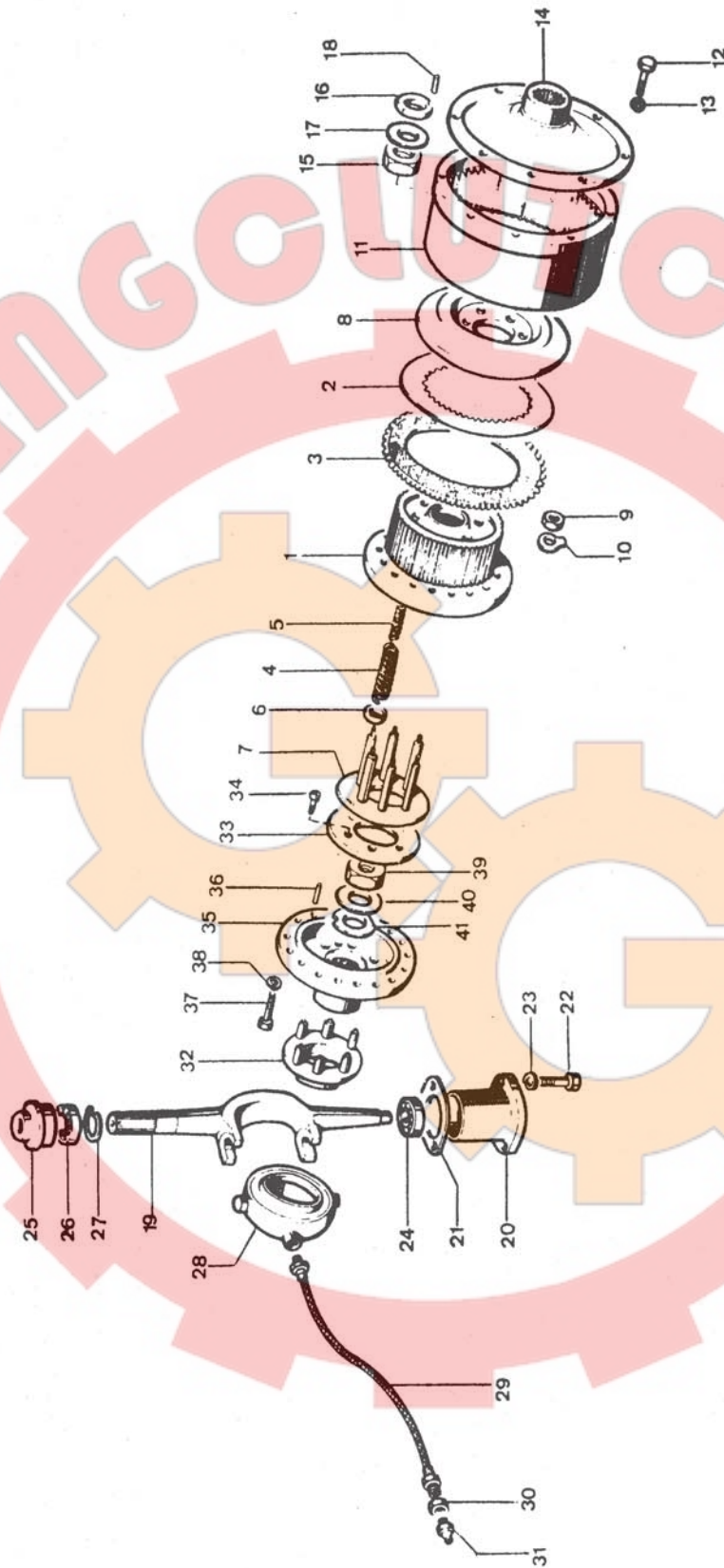

No.3	Ref.	MF numbers	Qty	Description	Denominazione	Description	Désignation	Benennung
29		980 557 M1	2	Hose assy, bearing lub.				
30			2	Nut, hose attaching				
31		372 608 X1	2	Grease, fitting				
32		980 753 M93	2	Collar assy, clutch release				
33		980 755 M2	2	Quill, collar				
34		393 988 X1	6	Nut, quill				
35		980 119 M4	2	Flange, clutch drum-inner				
36		339 806 X1	2	Dowel				
37		391 319 X1	40	Bolt, inner drim attach				
38		1440 314 X1	40	Washer, Spring				
39		1440 243 X1	2	Nut, flange attach				
40		980 120 M3	2	Washer, safety lock				
41		980 121 M3	2	Washer, flat				