

TRANSMISSION

TRANSMISSION

* Used on all tractors except Model HD5G units, serial No. 13309 and up. Provides 5 forward speeds and 1 reverse speed.

** Standard on HD5G tractors serial No. 13309 and up. Optional on other Models. Provides 4 forward speeds and 2 reverse speeds.

ITEM	PART NUMBER	QUANTITY	DESCRIPTION	KIT NUMBER
1	075745	1 -	TRANSMISSION ASSEMBLY (Consists of items 4 thru 50. Also includes gear shift mechanism)	
	075746	- 1	TRANSMISSION ASSEMBLY (Consists of items 4 thru 54. Also includes gear shift mechanism)	
2	035733	12 12	CAPSCREW, 1/2"NC x 1-3/8"	
	904208	12 12	LOCKWASHER, 1/2"	
3	050298	1 1	GASKET, transmission case to steering clutch housing	069628
4	-----	1 -	CASE only (Not serviced. Order CASE ASSEMBLY 075711)	
	075711	- 1	CASE ASSEMBLY (Includes one each of items 45, 46, 52, 53 and 54)	
	901653	1 1	PLUG, pipe, 3/8"NPT (oil drain)	
5	080808	1 1	COVER, side	
	901653	1 1	PLUG, pipe, 3/8"NPT (Tractors prior to #22005)	
6	901652	1 1	PLUG, pipe, 1/4"NPT (Tractors #22005 and up)	
	035244	8 8	CAPSCREW, 3/8"NC x 3/4"	
	904206	8 8	LOCKWASHER, 3/8"	
7	050304	1 1	GASKET, side cover	069628
8	035250	1 1	PLUG, oil filler	
9	035249	1 1	GASKET, oil filler plug	069628
10	050297	1 1	COVER, top shaft front bearing	
11	013058	5 5	CAPSCREW, 3/8"NC x 1-1/4"	
	904206	5 5	LOCKWASHER, 3/8"	
12	050296	1 1	GASKET, top shaft front bearing cover	069628
13	049938	1 1	SHAFT, top	
14	051344	2 2	RING, snap, top shaft	
15	051346	1 1	BEARING, ball, top shaft, front (Includes snap RING)	
16	051345	1 1	BEARING, roller, top shaft, rear	
17	053237	1 1	RING, snap, top shaft rear bearing	
18	050295	2 2	WASHER, top shaft	
19	049915	1 1	GEAR, constant mesh, top shaft (43 teeth)	
20	049924	1 1	GEAR, 3rd speed, top shaft (35 teeth)	
21	049916	1 -	GEAR, 4th speed, top shaft (38 teeth)	
	068797	- 1	GEAR, high speed reverse, top shaft (36 teeth)	
22	049934	1 1	GEAR, second speed, top shaft (30 teeth)	
23	049944	1 1	GEAR, low speed, top shaft (22 teeth)	
24	057415	1 1	PINION AND SHAFT (9 teeth)	
25	052231	1 1	SHIELD, pinion shaft rear bearing	
26	081670	1 1	BEARING, ball, pinion shaft, rear (Includes snap RING)	
27	052272	2 2	SHIM, pinion shaft rear bearing (.005" thick. Use as req'd)	
	052273	2 2	SHIM, pinion shaft rear bearing (.007" thick. Use as req'd)	
	052274	3 3	SHIM, pinion shaft rear bearing (.010" thick. Use as req'd)	

(Continued)

TRANSMISSION (Continued)

ITEM	PART NUMBER	QUANTITY	DESCRIPTION	KIT NUMBER
28	052247	1 1	RETAINER, pinion shaft rear bearing	
29	013058	6 6	CAPSCREW, 3/8"NC x 1-1/4"	
30	052281	3 3	STRIP, capscrew locking	
31	053209	3 3	SHIM, bearing retainer (.005" thick. Use as req'd)	
	053206	3 3	SHIM, bearing retainer (.007" thick. Use as req'd)	
32	048693	1 1	NUT, retaining, pinion shaft rear bearing	
33	048694	1 1	LOCKWASHER, bearing retaining nut	
34	049921	1 1	GEAR, low speed and reverse, pinion shaft (44 teeth)	
35	049922	1 1	GEAR, 2nd speed, pinion shaft (36 teeth)	
36	049920	1 -	GEAR, 4th speed, pinion shaft (28 teeth)	
	068807	- 1	GEAR, high speed reverse, pinion shaft (26 teeth)	
37	049919	1 1	GEAR, 3rd and 5th speeds, pinion shaft (31 teeth)	
38	050272	1 1	BEARING, roller, pinion shaft, front	
39	050291	1 1	RING, snap, pinion shaft front bearing	
40	049943	1 1	SHAFT, input (23-tooth gear)	
41	050270	1 1	BEARING, ball, input shaft, rear (Includes snap RING)	
42	050292	1 1	RING, snap, input shaft, rear	
43	042847	1 1	BEARING, ball, input shaft, front	
44	050293	1 1	RING, snap, input shaft, front	
45	073000	1 2	SHAFT, reverse gear (When making first replacement on tractors prior to #12261, also furnish item 46)	
	905359	1 2	BALL, steel, 5/16" diam.	
46	051496	1 2	PLUG, reverse gear shaft (Tractors #12261 and up)	51786
47	050271	1 2	ROLLER ASSEMBLY, reverse gear bearing	
48	051300	1 2	WASHER, thrust, reverse gear, inner	
49	051301	1 2	WASHER, thrust, reverse gear, outer	
50	049933	1 1	GEAR, low speed reverse (18 teeth)	
51	073001	- 1	GEAR, high speed reverse (28 teeth)	
52	069999	- 1	PLUG, high speed reverse shaft hole	
53	067768	- 1	RING, sealing, reverse shaft hole plug	
54	056362	- 1	RING, snap, reverse shaft hole plug	
55	049110	1 1	RING, seal, input shaft (steel)	082876
56	056589	1 1	RING, seal, input shaft (bronze)	082876
57	049836	1 1	GASKET, input shaft seal ring	069628 082876
58	056588	1 1	SPRING ASSEMBLY, input shaft seal (Serviced only as a unit)	082876
59	082795	1 1	BOOT, input shaft seal	082876
60	-----	1 1	YOKE (See UNIVERSAL JOINT)	
61	050548	1 1	SEAL, universal joint yoke	082876

(Continued)

1998
6/90
E

TRANSMISSION (Continued)

ITEM	PART NUMBER	QUANTITY	* **	DESCRIPTION	KIT NUMBER
62	050547	1	1	WASHER, retaining, universal joint yoke	
63	070162	1	1	CAPSCREW, retaining, universal joint yoke (drilled-hd., 5/8"NF x 1-3/4")	
64	050546	1	1	LOCK, yoke retaining capscrew (Tractors prior to #4506)	
	023633	1	1	WIRE, locking, yoke retaining capscrew (1/16" x 12")(Started with tractor #4506)	

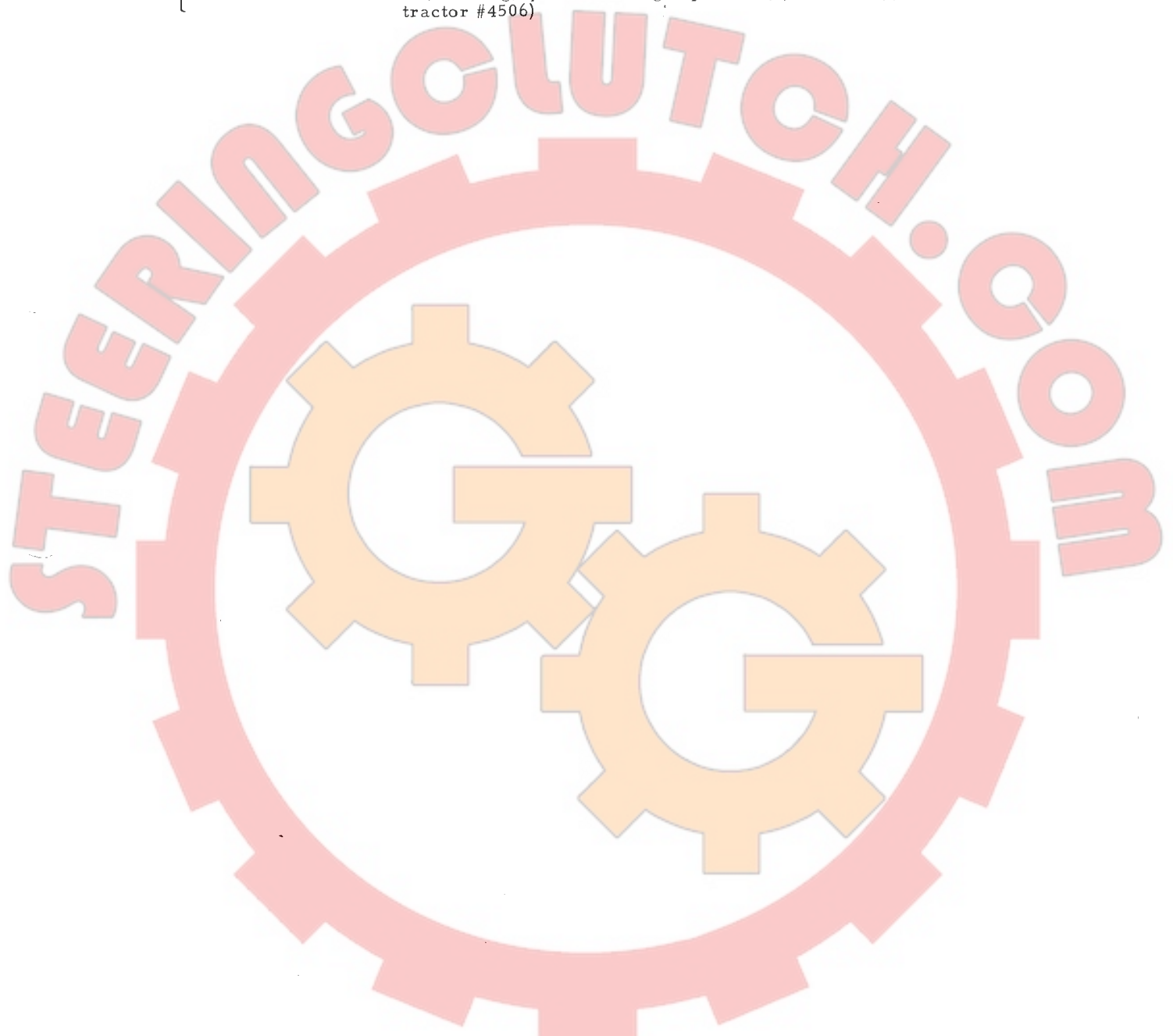

STEERING CLUTCH

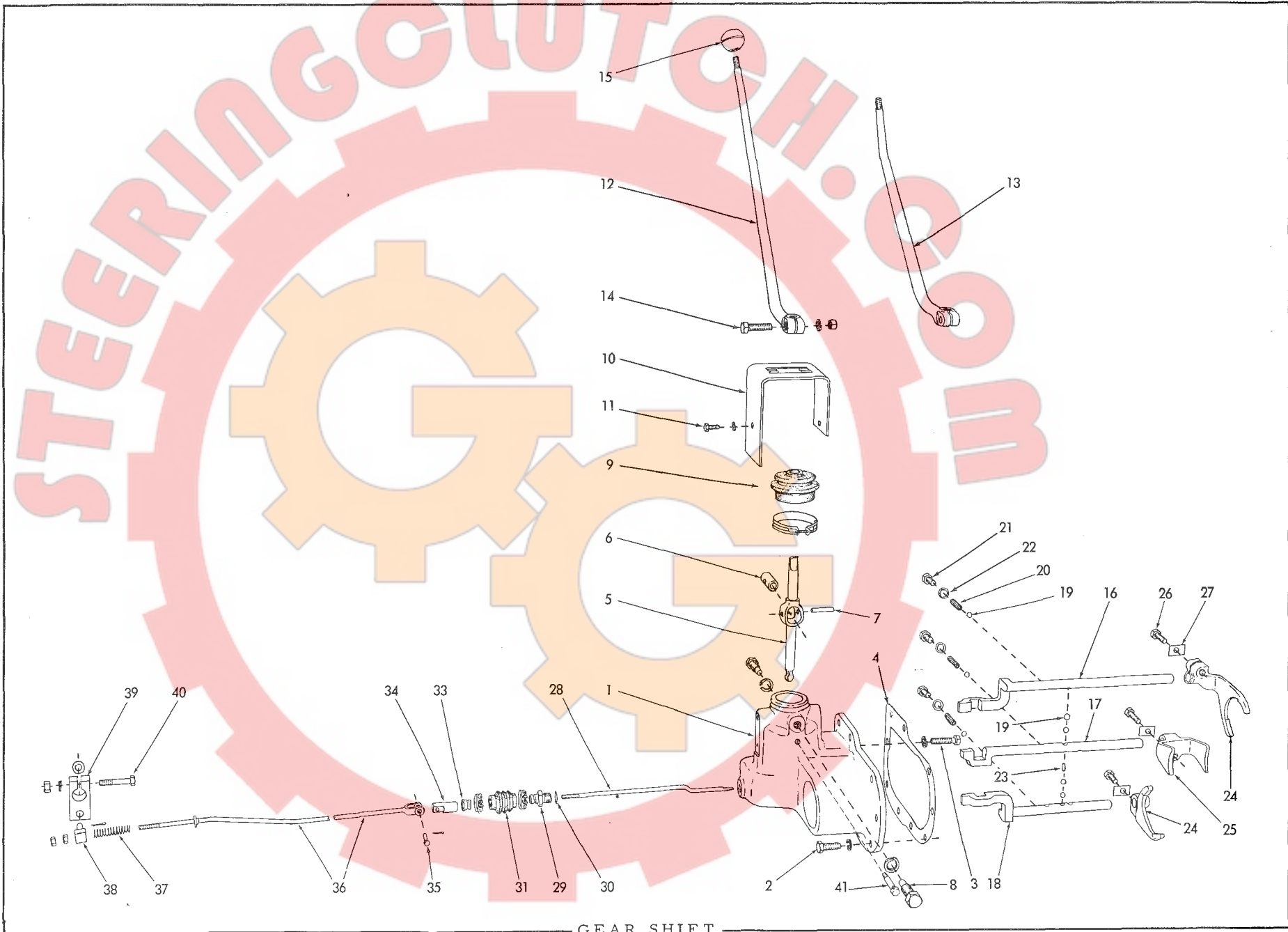

GEAR SHIFT

GEAR SHIFT

ITEM	PART NUMBER	QTY.	DESCRIPTION	KIT NUMBER
1	049961	1	HOUSING, shift lever	
2	035733	8	CAPSCREW, 1/2"NC x 1-3/8"	
3	AM-8801	1	CAPSCREW, 1/2"NC x 2"	
	904208	9	LOCKWASHER, 1/2"	
4	050294	1	GASKET, shift lever housing	069628
5	050280	1	LEVER, shift	082878
6	049964	1	SHAFT, lever pivot	082878
7	049963	1	PIN, lever pivot shaft	082878
8	049962	2	SCREW, lever pivot	082878
	904209	2	LOCKWASHER, 5/8"	082878
9	076130	1	BOOT, shift lever (When required for tractors prior to #2244, also order CLAMP)	082878
	916995	1	CLAMP, hose (Started with tractor #2244).	082878
10	050282	1	GUIDE, shift lever (For transmission with 5 forward speeds. Used on all tractors except Model HD5G units #13309 and up)	
	068843	1	GUIDE, shift lever (For transmission with 4 forward speeds. Standard on HD5G tractors #13309 and up)	
11	035244	3	CAPSCREW, 3/8"NC x 3/4"	
	904206	3	LOCKWASHER, 3/8"	
12	049986	1	LEVER, gear shift (For all tractors except Model HD5G)	
13	059997	1	LEVER, gear shift (For Model HD5G only)	
14	035073	1	CAPSCREW, lever clamping (1/2"NF x 1-3/4")	
	904208	1	LOCKWASHER, 1/2"	
	911043	1	NUT, 1/2"NF	
15	U-171	1	KNOB, gear shift lever	
16	050206	1	SHAFT, shifting, upper	
17	050207	1	SHAFT, shifting, intermediate	
18	050205	1	SHAFT, shifting, lower	
19	905362	7	BALL, steel, 1/2" diam.	
20	037195	3	SPRING, shifting shaft ball	
21	035159	3	CAPSCREW, shifting shaft ball spring (5/8"NC x 1")	
22	049918	3	WASHER, shifting shaft ball spring capscREW (copper)	
23	050266	1	PIN, shifting shaft interlock	
24	050209	2	FORK, shifting, upper and lower shafts	
25	050211	1	FORK, shifting, intermediate shaft	
26	035018	3	CAPSCREW, clamping, shifting fork (1/2"NF x 1-1/2")	
27	029752	3	LOCK, shifting fork capscREW	
28	050252	1	PLUNGER, locking (12-1/2" long)(Tractors prior to #15215)	
	076850	1	PLUNGER, locking (13-3/16")(Tractors #15215 and up)	
29	049977	1	SLEEVE, locking plunger (1-3/8" long)(Tractors prior to #15215)	
	076846	1	SLEEVE, locking plunger (1-5/8" long)(Tractors #15215 and up)	
30	050267	1	WASHER, locking plunger sleeve (copper)	069628

(Continued)

GEAR SHIFT (Continued)

ITEM	PART NUMBER	QTY.	DESCRIPTION	KIT NUMBER
31	049966	1	BOOT, locking plunger (1-1/2" long)(Used prior to tractor #15215)	
	065573	2	CLAMP (wire type)(Started with tractor #5307)	
	901173	2	SCREW, machine, #10-24NC x 5/8"	
	901310	2	NUT, #10-24NC	
	080166	1	BOOT, locking plunger (2" long)(For tractors #15215 and up)	069628
	916897	2	CLAMP, hose, 1" I.D.	
33	050254	1	NUT, locking plunger (9/16" long)(Tractors prior to #15215)	
	076847	1	NUT, locking plunger (13/16" long)(Tractors #15215 and up)	
34	050253	1	END, locking plunger	
35	917646	1	PIN, yoke 3/8" diam.	
	900942	1	PIN, cotter, 3/32" x 5/8"	
36	050255	1	ROD, locking plunger (20" long)(Tractors prior to #15215)	
	076848	1	ROD, locking plunger (19-1/2" long)(Tractors #15215 and up)	
	911041	2	NUT, 3/8"NF	
37	035910	1	SPRING, locking plunger rod	
38	050265	1	SWIVEL, locking plunger rod	
	910244	1	WASHER, plain, SAE std., 1/2"	
	910967	1	PIN, cotter, 1/8" x 7/8"	
39	050566	1	LEVER, shift lock	
40	035068	1	CAPSCREW, 1/2"NF x 2"	
	904208	1	LOCKWASHER, 1/2"	
	911043	1	NUT, 1/2"NF	
41	051447	1	BREATHER ASSEMBLY (1NIPPLE, 1 FILTER, 1 CAP and 1 cotter PIN)(Started with tractor #15106)	

