

USAGE: Tractors with dry clutch. See page 119 for optional oil clutch

ITEM	PART NO.	QTY.	DESCRIPTION
1	099133	1	BEARING, ball, clutch shaft, front
1A	088816	1	PLATE ASSEMBLY, driven (Has ceramic friction buttons)(Standard equipment)
	643314	1	PLATE ASSEMBLY, driven (Has feramic friction facings)(Special equipment)
2	643315	1	CLUTCH ASSEMBLY, engine (See page 115 for parts)(Also order item 1A)
3	035439	12	CAPSCREW, 3/8"NC x 1"
	904206	12	LOCKWASHER, 3/8"
4	099410	1	HOSE lubricating, clutch shifter bearing, lower
	911049	1	NUT, jam, 5/8"NF
	915399	1	ELBOW, street, brass, 90°, 1/8"NPT
5	050579	1	DISC, clutch brake
6	083270	6	CAPSCREW, 5/16"NF x 5/8"
	904205	6	LOCKWASHER, 5/16"
7	099411	1	HOUSING, engine clutch
8	013058	9	CAPSCREW, 3/8"NC x 1-1/4"
	904206	9	LOCKWASHER, 3/8"
9	099407	1	COVER, clutch access
10	035439	2	CAPSCREW, 3/8"NC x 1"
	044249	2	CAPSCREW, 3/8"NC x 1-1/8"
	904206	4	LOCKWASHER, 3/8"
	044973	2	WASHER, plain

(Continued)

ENGINE CLUTCH AND HOUSING (Continued)

ITEM	PART NO.	QTY.	DESCRIPTION
11	050748	1	BREATHER, clutch housing
12	085774	1	SHAFT, clutch
13	085810	1	RETAINER, clutch shaft rear bearing
14	013058	6	CAPSCREW, 3/8"NC x 1-1/4"
	904206	6	LOCKWASHER, 3/8"
15	042847	1	BEARING, ball, clutch shaft, rear
16	030123	1	WASHER, locking, rear bearing nut
17	030107	1	NUT, clutch shaft rear bearing
18	050647	1	GASKET, rear bearing cap
19	051597	1	CAP, rear bearing
20	035733	4	CAPSCREW, 1/2"NC x 1-3/8"
	904208	4	LOCKWASHER, 1/2"
21	4336526	1	HOSE, lubricating, clutch shifter bearing, upper
	911049	1	NUT, jam, 5/8"NF
	914465	1	FITTING, lubricating, straight, 1/8"NPT
22	099409	1	HOSE, lubricating, rear bearing
	911049	1	NUT, jam, 5/8"NF
	914465	1	FITTING, lubricating, straight, 1/8"NPT
23	099374	1	BRACKET, hose supporting (Used prior to tractor #16596)
	910244	2	WASHER, plain, SAE std., 1/2 "
	623658	1	BRACKET, hose supporting (Effective with tractor #16596)
	910244	3	WASHER, plain, SAE std., 1/2"

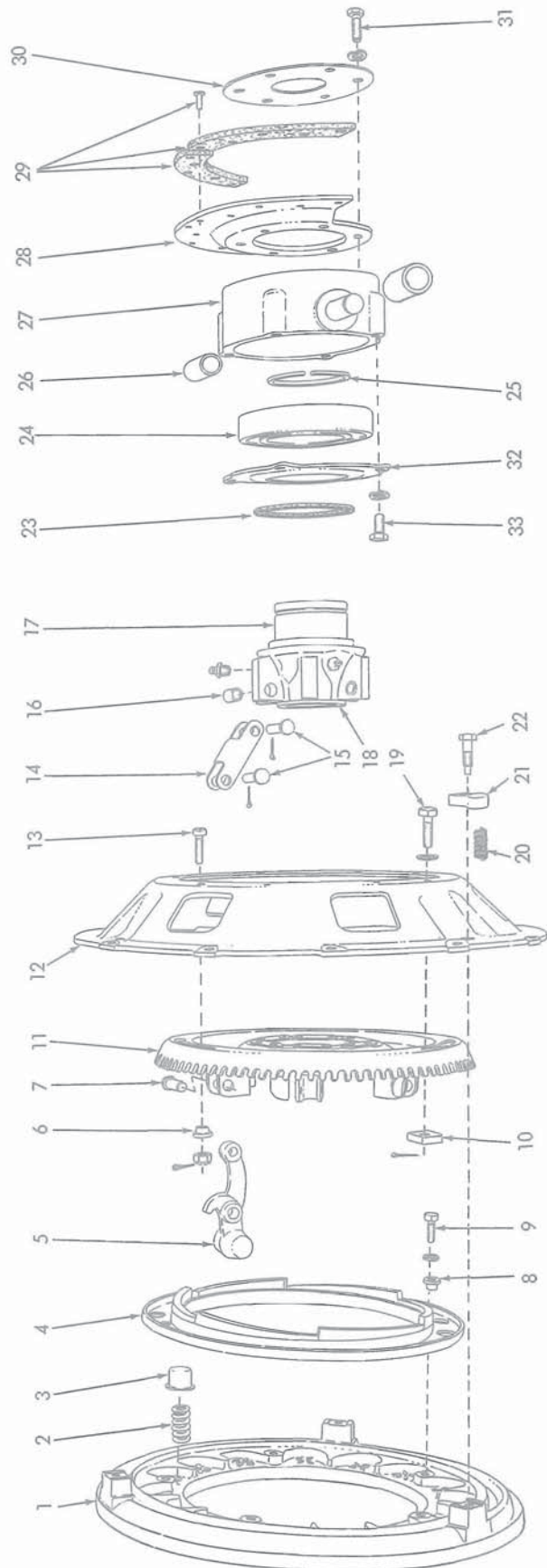

T-11274

CLUTCH ASSEMBLY 643315

CLUTCH ASSEMBLY 643315

USAGE: See page 112

ITEM	PART NO.	QTY.	DESCRIPTION
1	088814	1	PLATE, pressure
2	078278	10	SPRING, pressure
3	044753	10	CUP, pressure spring
4	055754	1	RING, pressure
5	088815	6	LEVER, actuating
6	055757	2	SPACER, adjusting ring retaining screw
7	052354	6	PIN, actuating lever (3/8" diam., 1-1/8" long)
8	042128	5	SPACER, pressure ring guiding
9	915809	5	CAPSCREW, 5/16"NC x 3/4"
	904205	5	LOCKWASHER, 5/16"
10	055761	1	PLATE, locking, adjusting ring
11	088817	1	RING ASSEMBLY, adjusting (Includes riveted brackets and wear plates. Serviced only as a unit)
12	621443	1	PLATE, back
13	055756	2	CAPSCREW, retaining, adjusting ring (fil.-hd., drilled-end, 5/16"NF x 1")
	913238	2	NUT, castle, 5/16"NF
	904001	2	PIN, cotter, 3/32" x 1/2"
14	055759	6	LINK, actuating lever
15	048173	12	PIN, actuating lever link (5/16" diam., 1" long)
	904001	12	PIN, cotter, 3/32" x 1/2"
16	048195	6	BUSHING, shifting sleeve (steel)
17	078116	1	SLEEVE ASSEMBLY, shifting (Includes items 16 and 18; also FITTINGS indented below)
	914465	3	FITTING, lubricating, straight, 1/8"NPT
18	-----	2	BUSHING, shifting sleeve (bronze)(Furnished only as part of item 17)
19	055760	1	SCREW (Hex-hd., drilled-end, 3/8"NF x 1")
	906960	1	LOCKWASHER, internal teeth, 3/8"
	900801	1	PIN, cotter, 3/32" x 3/4"
20	042130	3	SPRING, pressure plate retracting
21	042129	3	RETAINER, pressure plate retracting spring
22	074614	3	CAPSCREW, spring retainer (dog-pt., 5/16"NC x 1-1/16")
23	042141	1	RING, sealing, shifting sleeve (felt)
24	621440	1	BEARING, ball, shifting sleeve
25	042144	1	RING, locking, shifting sleeve bearing

(Continued)

CLUTCH ASSEMBLY 643315 (Continued)

ITEM	PART NO.	QTY.	DESCRIPTION
26	056864	2	RACE, shifting yoke needle bearing
27	078134	1	YOKE ASSEMBLY, shifting sleeve (Includes item 26)
28	050578	1	DISC ASSEMBLY, clutch brake, front (Includes item 29)
29	081756	1	FACING KIT, brake disc (Includes RIVETS indented below)
	911131	10	RIVET, tubular, brass, flat-hd., 3/16" x 7/16"
30	050575	1	SHIELD, grease
31	057927	6	CAPSCREW, 5/16"NF x 3/4" } Also attach brake disc.
	904205	6	LOCKWASHER, 5/16" }
32	042142	1	RETAINER, shifting sleeve bearing
33	035979	4	CAPSCREW, 3/8"NF x 5/8"
	904206	4	LOCKWASHER, 3/8"