

ITEM	PART NO.	QTY.	DESCRIPTION
1	631316	2	DRUM, brake
2	650835	16	BOLT, self-locking, 1/2"NC x 1"
3	624559	2	HUB, brake drum
4	630045	2	CAPSCREW, hub retaining (Used prior to loader #462)
	663117	2	CAPSCREW, hub retaining (self-locking)(Effective with loader #462)
5	630052	2	LOCK, hub retaining capscREW (Used prior to loader #462)
6	631584	2	WASHER ASSY., hub retaining (Includes item 7)(Used prior to loader #462)
	664330	2	WASHER ASSY., hub retaining (Includes item 7)(Used on loaders #462 thru #572)
	666324	2	WASHER, hub retaining (Loaders #573 and up)
7	035793	2	PIN, hub retaining washer (Early units only)
8	056513	2	WASHER, sealing, brake drum hub
9	628320	2	SEAL, oil
10	631577	2	CAGE, inner bearing
11	070469	12	CAPSCREW, 1/2"NF x 1-1/4"
	904208	12	LOCKWASHER, 1/2"
12	633904	2	GASKET, inner bearing cage
13	057005	2	CUP, inner bearing
14	057006	2	CONE ASSEMBLY, inner bearing

(Continued)

FINAL DRIVE PINION SHAFT (Continued)

ITEM	PART NO.	QTY.	DESCRIPTION	
15	0655628-6	2	PINION (12 teeth)	
16	0057004-4	2	CONE ASSY., outer bearing	
17	0057003-6	2	CUP, outer bearing	
18	0084905-9	4	SHIM, bearing adjustment (.005" thick)	} Use as required
	0084904-2	4	SHIM, bearing adjustment (.007" thick)	
	0084903-4	14	SHIM, bearing adjustment (.010" thick)	
19	0084319-3	2	CAGE, outer bearing	
20	0012992-4	8	CAPSCREW, 3/8"NF x 1-1/4"	
	0904206-0	8	LOCKWASHER, 3/8"	
21	0650128-2	2	TUBE ASSY., vent (Includes nuts)	} Original equipment
	0919171-9	4	CONNECTOR, flare type, 1/4" tube, 1/8"NPT male	
22	0050748-3	2	BREATHER	
	0901489-5	2	NIPPLE, pipe, 3/8"NPT x 1"	
	0901765-8	2	COUPLING, pipe, 3/8"NPT	
23	0670281-5	1	TUBE ASSY., final drive breather, left (Includes nuts)	} For use with service replacement HOUSING
	0670282-3	1	TUBE ASSY., final drive breather, right (Includes nuts)	
	0919171-9	2	CONNECTOR, flare type, 1/2" tube (1/8"NPT male)	
24	0640677-1	4	CLIP, tube supporting	}
	0922300-9	4	CAPSCREW, 3/8"NC x 3/4"	
	0910287-2	4	LOCKWASHER, 3/8"	
	0911115-4	8	WASHER, plain, SAE std., 3/8"	

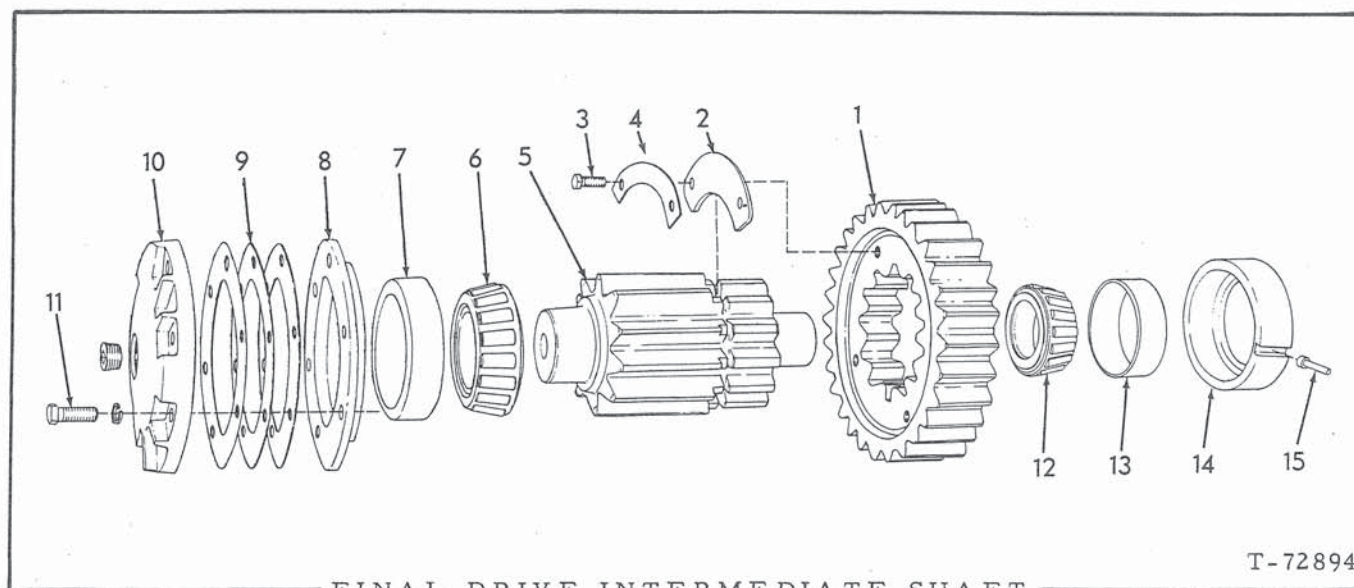

T-72894

FINAL DRIVE INTERMEDIATE SHAFT

ITEM	PART NO.	QTY.	DESCRIPTION	
1	671413	2	GEAR (30 teeth)	
2	655631	4	LOCK, gear retaining	
3	035439	8	CAPSCREW, 3/8"NC x 1"	
4	655632	4	LOCK, cap screw	
5	655630	2	PINION (12 teeth)	
6	069441	2	CONE ASSEMBLY, outer bearing	
7	069328	2	CUP, outer bearing	
8	658834	2	CAGE, outer bearing cup	
9	658838	4	SHIM, bearing adjustment (.005" thick)	} Use as required
	658839	4	SHIM, bearing adjustment (.007" thick)	
	658840	14	SHIM, bearing adjustment (.010" thick)	
10	658837	2	RETAINER, outer bearing	
	901666	2	PLUG, pipe, ctsk-hd., 1"NPT	
11	023465	12	CAPSCREW, 5/8"NF x 1-3/4"	
	904209	12	LOCKWASHER, 5/8"	
12	211582	2	CONE ASSEMBLY, inner bearing	
13	211581	2	CUP, inner bearing	
14	084297	2	CAGE, inner bearing cup	
15	089320	2	PIN, locking, inner bearing cage	

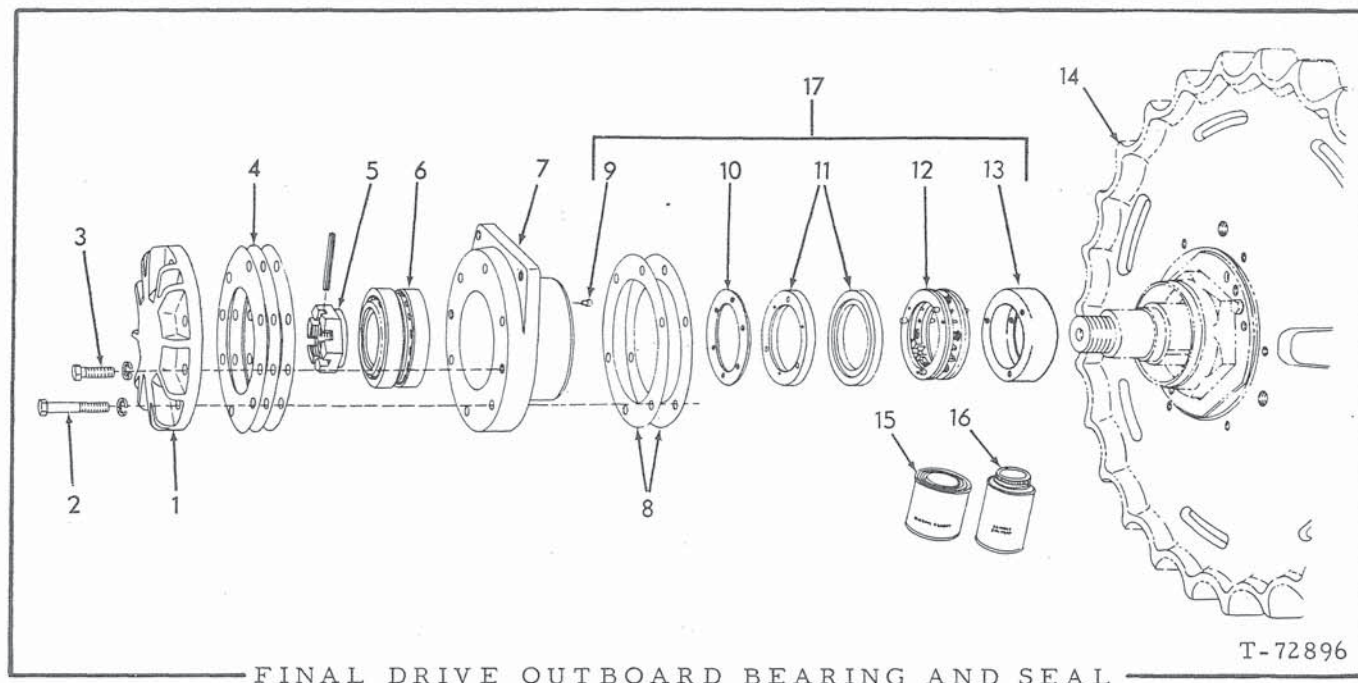

ITEM	PART NO.	QTY.	DESCRIPTION
1	084303	2	COVER, outboard bearing
2	{ 070403 915969 904208	12 12 16	CAPSCREW, 1/2"NF x 3" (Loaders prior to # 505) CAPSCREW, 1/2"NC x 3" (Loaders # 505 and up) LOCKWASHER, 1/2"
3	035018	4	CAPSCREW, 1/2"NF x 1-1/2"
4	{ 084313 084312 084311	4 4 14	SHIM, outer bearing cap (.005" thick) SHIM, outer bearing cap (.007" thick) SHIM, outer bearing cap (.010" thick)
			Use as req'd
5	058925 917904	2 2	NUT, retaining, outer bearing PIN, spring, 5/16" x 3"
6	058702	2	BEARING, roller, outboard (Each consists of 1 roller assembly and 2 cups. Serviced only as a unit)
7	084271	2	CAGE, outboard bearing
8	069080	12	SHIM, outboard bearing cage (.015" thick. Use as req'd)
9	084432	6	□PIN, outer seal ring
10	069106	2	□GASKET, seal ring
11	081787	4	□RING, outer seal
12	084337	2	□FOLLOWER ASSEMBLY, outer seal (Serviced only as a unit)
13	058814	2	□BOOT, outer seal
14	-----	-	SPROCKET (See page 145)
15	033288	-	CEMENT, neoprene, 1/2 pint can
16	054890	-	SOLVENT, neoprene cement, 1/2 pint can
			For cementing boots and gaskets
17	091972	2	SEAL KIT (Items 9 thru 13; includes parts for one (1) side only)
			□Components of item 17

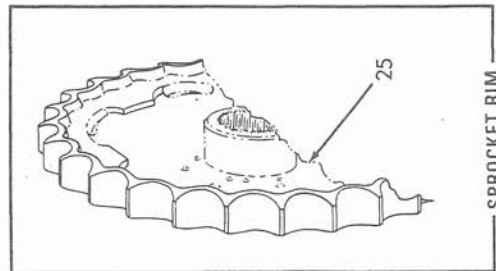
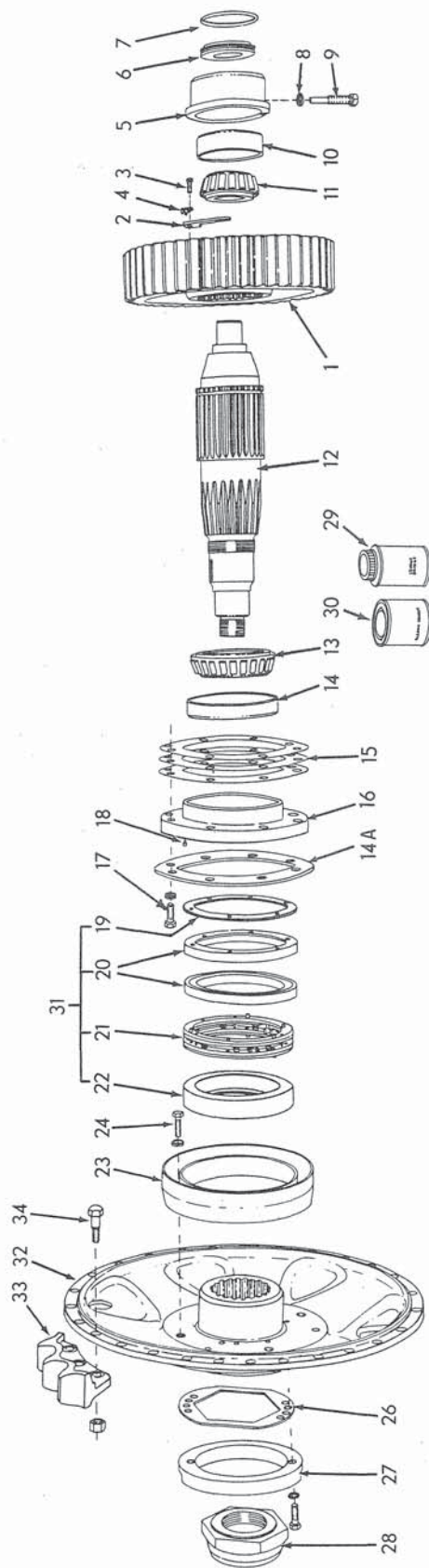

SPROCKET RIM

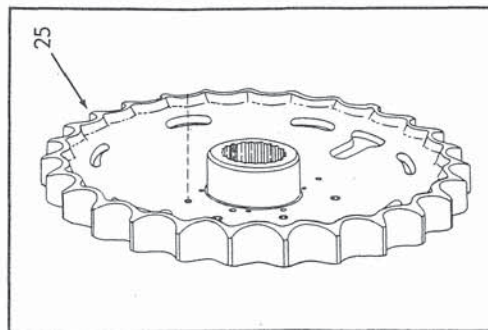

FIRST TYPE

FINAL DRIVE SPROCKET, SHAFT AND GEAR

ITEM	PART NO.	QTY.	DESCRIPTION
1	655633	2	GEAR, driving
2	058826	4	LOCK, gear retaining
3	035439	8	CAPSCREW, 3/8"NC x 1"
4	052444	8	LOCK, capscrew
5	084289	2	CAGE, inner bearing cup
6	091571	2	COVER, inner bearing
7	923817	2	O-RING, inner bearing cover
8	049918	2	WASHER, bearing cage setscrew (copper)
9	084278	2	SETSCREW, bearing cage
10	052070	2	CUP, inner bearing
11	084277	2	CONE ASSY., inner bearing
12	622135	2	SHAFT, sprocket
13	069615	2	CONE ASSY., intermediate bearing
14	069614	2	CUP, intermediate bearing
14A	668549	2	GUARD, seal
15	{ 056971	8	SHIM, bearing adjustment (.005" thick)
	{ 056970	6	SHIM, bearing adjustment (.007" thick)
	{ 056969	24	SHIM, bearing adjustment (.010" thick)
} Use as required			
16	666814	2	CAGE ASSY., intermediate bearing (Includes item 18)
17	916421	16	CAPSCREW, 1/2"NF x 2-1/2"
	904208	16	LOCKWASHER, 1/2"
18	084432	6	PIN, locating, seal ring
19	058807	2	<input type="checkbox"/> GASKET, seal ring
20	651996	4	<input type="checkbox"/> RING, inner seal
21	058796	2	<input type="checkbox"/> FOLLOWER ASSY., inner seal (Serviced only as a unit)
22	058806	2	<input type="checkbox"/> BOOT, inner seal
23	668553	2	GUARD, seal
24	035061	8	CAPSCREW, 1/2"NC x 1-1/4"
	904208	8	LOCKWASHER, 1/2"
25	{ 666799	2	SPROCKET, track
	{ 633487	2	SPROCKET, rim (Requires welding to install)
} Loaders prior to #1000			
26	084299	2	LOCK, sprocket retaining nut
	035221	4	CAPSCREW, 1/2"NC x 1"
	904208	4	LOCKWASHER 1/2"
} Loaders prior to #504			
27	666820	2	RING, screw protecting (Effective with loader #504)
	035190	4	CAPSCREW, 1/2"NC x 1-1/2"
	904208	4	LOCKWASHER, 1/2"
28	084236	2	NUT, sprocket retaining
29	054890	-	SOLVENT, neoprene cement, 1/2 pint can
30	033288	-	CEMENT, neoprene, 1/2 pint can
} For cementing boots and gaskets			
31	656664	2	SEAL KIT (Includes parts for one (1) side only; items 19 thru 22)
32	669567	2	HUB, sprocket segment
33	669330	18	SEGMENT, sprocket
34	097324	54	BOLT, sprocket segment
	012767	54	NUT, high, 3/4"NF
} Loader unit No. 1001 and up			

☐ Components of item 31