

-133-
TRANSMISSION
(Used on Power Shift Tractors)

REF. PART DESCRIPTION

NO. NO. NUMBER

DESCRIPTION

GEAR SHIFT HOUSING, LEVER AND RELATED PARTS

11	341 949 R1	TUBE, transmission vent TD-9BP 8089 to 12166
12	327 932 R91	PIPE, transmission filler (order PACKAGE, 341 950 R91) TD-9BP 6225 to 8088
12	327 932 R92	PIPE, transmission filler TD-9BP 8089 up
13	327 940 R11	ROD, transmission oil level
14	51 434 D	ELBOW, transmission vent tube TD-9BP 8089 to 12166
15	19 986 R1	NUT, transmission vent tube elbow TD-9BP 8089 to 12166
16	604 364 C1 20 049 R1 20 050 R1	HOUSING, gear shifter SCREW, 7/16 x 1-3/8" hex-hd cap (4) SCREW, 7/16 x 1-5/8" hex-hd cap (7) WASHER, 15/32 x 59/64" x 16 ga (11)
17	18 585 DA	DOWEL, gear shifter housing to main frame (3)
18	461 173 R1	"O" RING, 1-5/8 x 2 x 3/16" (illus- treated and listed with "Main Frame")
19	604 365 C1	GASKET, gear shifter housing
20	13 722 D	BALL, gear shifter rail (optional with D-2616)
20	D 2 616	BALL, gear shifter rail (optional with 13722 D)
21	64 163 D	SPRING, gear shifter rail ball
22	50 826 D	ANCHOR, steering clutch release lever return spring (2)
23	611 432 C11	TUBE, w/two NUT, 265 205 R1 and two SLEEVE, 265 204 R1, trans- mission vent TD-9BP 12167 up
24	265 204 R1	SLEEVE TD-9BP 12167 up
25	265 205 R1	NUT TD-9BP 12167 up
26	606 889 C1	ELBOW, transmission vent tube TD-9BP 12167 up
1	264 055 R2	BALL, gear shift hand lever
2	64 604 D	CLAMP, gear shift hand lever boot
3	64 603 DA	BOOT, gear shift hand lever
4	104 073	RIVET, 3/16 x 1-1/4"
5	11 373 D	STOP, upper gear shift lever spring
6	29 547 D	SPRING, gear shift lever
7	17 700 D	STOP, lower gear shift lever spring
8	365 889 R3	SHIELD, gear shift housing swivel
9	327 941 R91	LEVER, gear shift hi-low
10	57 904 DA	PIN, gear shift hand lever

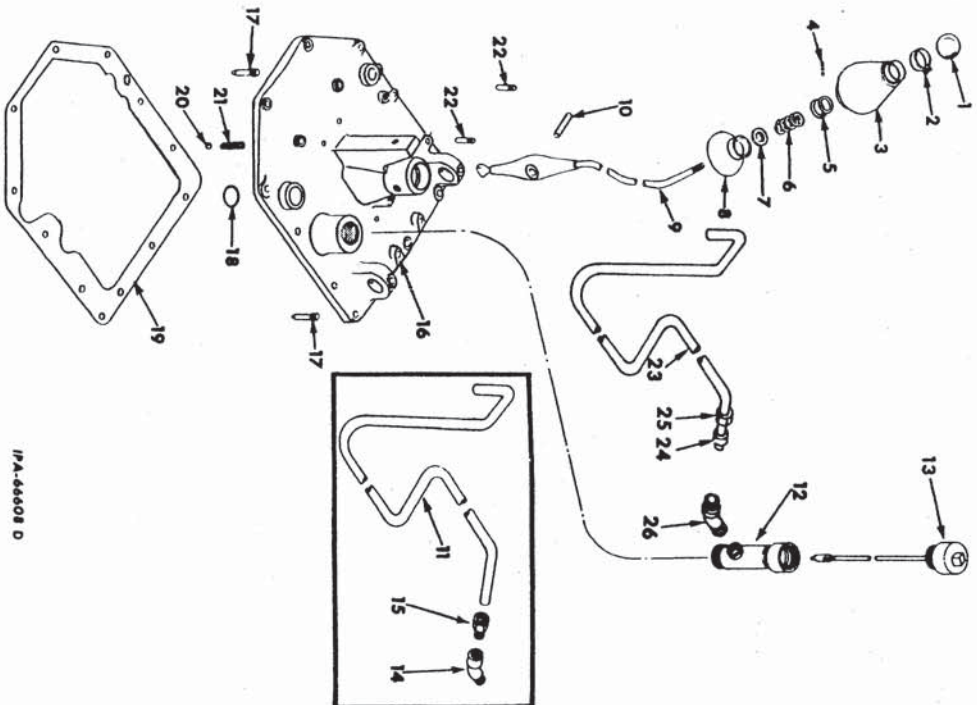

-134-
TRANSMISSION
(Used on Power Shift Tractors)

REF. NO.	PART NUMBER	DESCRIPTION	REF. NO.	PART NUMBER	DESCRIPTION
----------	-------------	-------------	----------	-------------	-------------

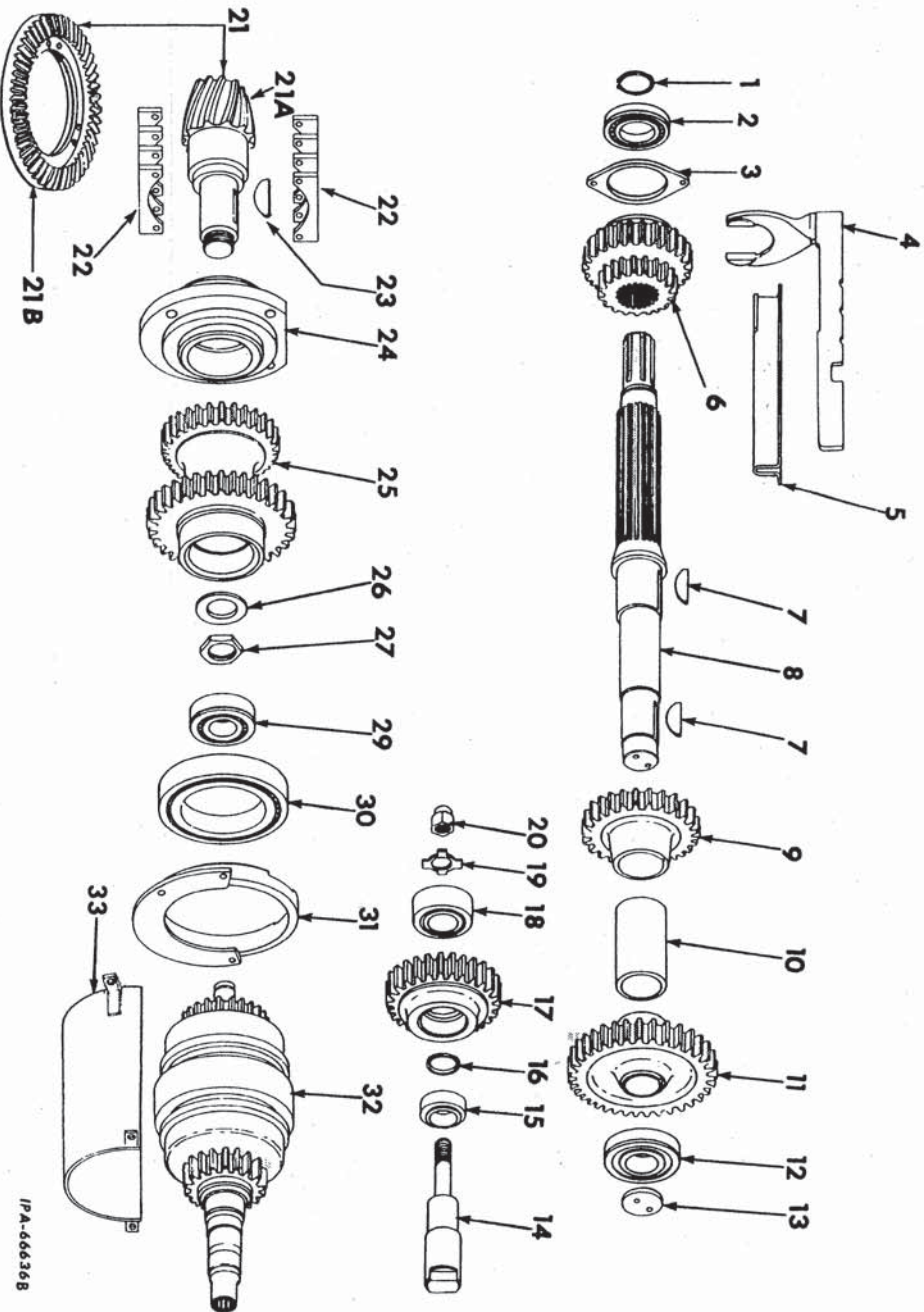

IPA-666368

1	631 255 R 1	RING, countershaft rear bearing snap	7	17 138 R 1	KEY, 1/4 x 2-3/4" (Woodruff) (2)
2	319 962 R 91	BEARING, countershaft rear	8	327 951 R 1	SHAFT, transmission counter (order gear, 331 375 R2 and shaft, 327 951 R2) TD-9BP 6525 to 6976
3	327 936 R 1 24 840 R 1 115 093	RETAINER, countershaft rear bearing SCREW, 3/8 x 1" hex-hd cap (2) WASHER, 3/8" lock (2)	8	327 951 R 2	SHAFT, transmission counter TD-9BP 6977 up
4	327 949 R 91	RAIL and FORK, hi-low speed shifter	9	327 952 R 1	GEAR, reverse countershaft (28 T)
5	327 939 R 11 62 778 D 24 839 R 1	GUIDE, gear shifter rail LOCK, gear shifter rail guide screw (2) SCREW, 3/8 x 3/4" hex-hd cap (4)	10	327 935 R 1	SPACER, transmission countershaft gear
6	331 375 R 1	GEAR, hi-low sliding (18 T and 25 T) (order shaft, 327 951 R2 and gear, 331 375 R2) TD-9BP 6525 to 6976	11	327 959 R 1	GEAR, forward countershaft (35 T)
6	331 375 R 2	GEAR, hi-low sliding (18 T and 25 T) TD-9BP 6977 up	12	327 427 R 91	BEARING, countershaft front
			13	327 929 R 1	WASHER, countershaft front bearing retainer
				181 395	SCREW, 7/16NF x 1" hex-hd cap (2)
				115 314	WASHER, 7/16" lock (2)

-135-
TRANSMISSION
(Used on Power Shift Tractors)

REF. NO.	PART NUMBER	DESCRIPTION	REF. NO.	PART NUMBER	DESCRIPTION
TRANSMISSION COUNTERSHAFT, GEARS AND RELATED PARTS - Continued					
14	327 943 R1	SHAFT, reverse idler	22	53 637 D	SHIM, rear bearing (light) (X)
15		BEARING (order 327 426 R91)	22	250 307 R1	SHIM, rear bearing (extra light) (X)
16		SPACER (order 327 426 R91)	23	38 260 D	KEY, 3/8 x 2-3/4" (Woodruff)
17	327 955 R1	GEAR, reverse idler (27 T)	24	327 425 R91	BEARING, pinion shaft
18		BEARING (order 327 426 R91)		313 692 R1	SCREW, 1/2 x 1-3/4" hex-hd cap (4)
19	327 927 R1	WASHER, reverse idler shaft nut lock		116 121	WASHER, 1/2" lock (4)
20	18 558 R1	NUT, reverse idler shaft (3/4NF)	25	331 376 R1	GEAR, hi-low driven (35 T)
21	327 965 R91	PINION and SHAFT, BEVEL, 327 960 R1 w/drive bevel GEAR, 279 338 R1 (matched pair) (order GEAR and PINION SET, 609 969 C91, RETAINER, 341 811 R1, NUT, 20 017 R1) (see NOTE) TD-9BP 6525 to 8414	26	351 048 R1	RETAINER, hi-low driven gear (for use with bevel PINION and SHAFT SET, 327 965 R91) TD-9BP 6525 to 8414
			26	341 811 R1	RETAINER, hi-low driven gear (for use with bevel PINION and SHAFT SET, 609 969 C91) TD-9BP 8415 up
			27	279 732 R1	NUT, bevel pinion shaft (for use with bevel PINION and SHAFT SET, 327 965 R91) TD-9BP 6525 to 8414
21	609 969 C91	PINION and SHAFT, BEVEL, 609 968 C1 w/drive bevel GEAR, 609 967 C1 (matched pair) (see NOTE) TD-9BP 8415 up	27	20 017 R1	NUT, bevel pinion shaft (for use with bevel PINION and SHAFT SET, 609 969 C91) TD-9BP 8415 up
21A	327 960 R1	PINION and SHAFT, bevel (9 T) (20° spiral angle) (order PINION and SHAFT SET 609 969 C91, RETAINER, 341 811 R1 and NUT, 20 017 R1) (see NOTE) TD-9BP 6525 to 8414	29	327 429 R92	BEARING, input shaft rear
21A	341 812 R1	PINION and SHAFT, bevel (9 T) (order PINION and SHAFT SET, 609 969 C91) (see NOTE) TD-9BP 8415 to 12768	30	279 456 R93	BEARING, pinion shaft front
21A	609 968 C1	PINION and SHAFT, bevel (9 T) (30° spiral angle) (see NOTE) TD-9BP 12769 up	31	327 950 R1	CAGE, pinion shaft front bearing SCREW, 3/8 x 1-1/4" hex-hd cap (3) WASHER, 3/8" lock (3)
21B	279 338 R1	GEAR, drive bevel (38 T) (20° pressure angle) (for TD-9BP 6525 to 8414 order PINION and SHAFT SET, 609 969 C91, RETAINER, 341 811 R1 and NUT 20 017 R1) (for TD-9BP 8415 to 12768 order PINION and SHAFT SET, 609 969 C91) (see NOTE) TD-9BP 6525 to 12768	32	327 956 R11	PACK ASSY, clutch (for components see list of parts under details of "Clutch Pack and Related Parts")
			33	297 330 R1	BAFFLE, transmission oil SCREW, 3/8 x 1" hex-hd cap (2) TD-9BP 6525 to 8013
21B	609 967 C1	GEAR, drive bevel (38 T) (22-1/2° pressure angle) (see NOTE) TD-9BP 12769 up		327 426 R91	BEARING, reverse idler gear (consists of Ref. Nos. 15, 16 and 18)
22	53 635 D	SHIM, rear bearing (heavy) (X)			
22	53 636 D	SHIM, rear bearing (medium) (X)			

NOTE - Also Listed and Illustrated Under Heading "STEERING SYSTEM - Drive Bevel Gear."
(X) - As Required.

-136-
TRANSMISSION
(Used on Power Shift Tractors)

REF. PART NO. NUMBER DESCRIPTION
TRANSMISSION PIPING
TD-9BP 6525 to 16366

REF. PART NO. NUMBER DESCRIPTION

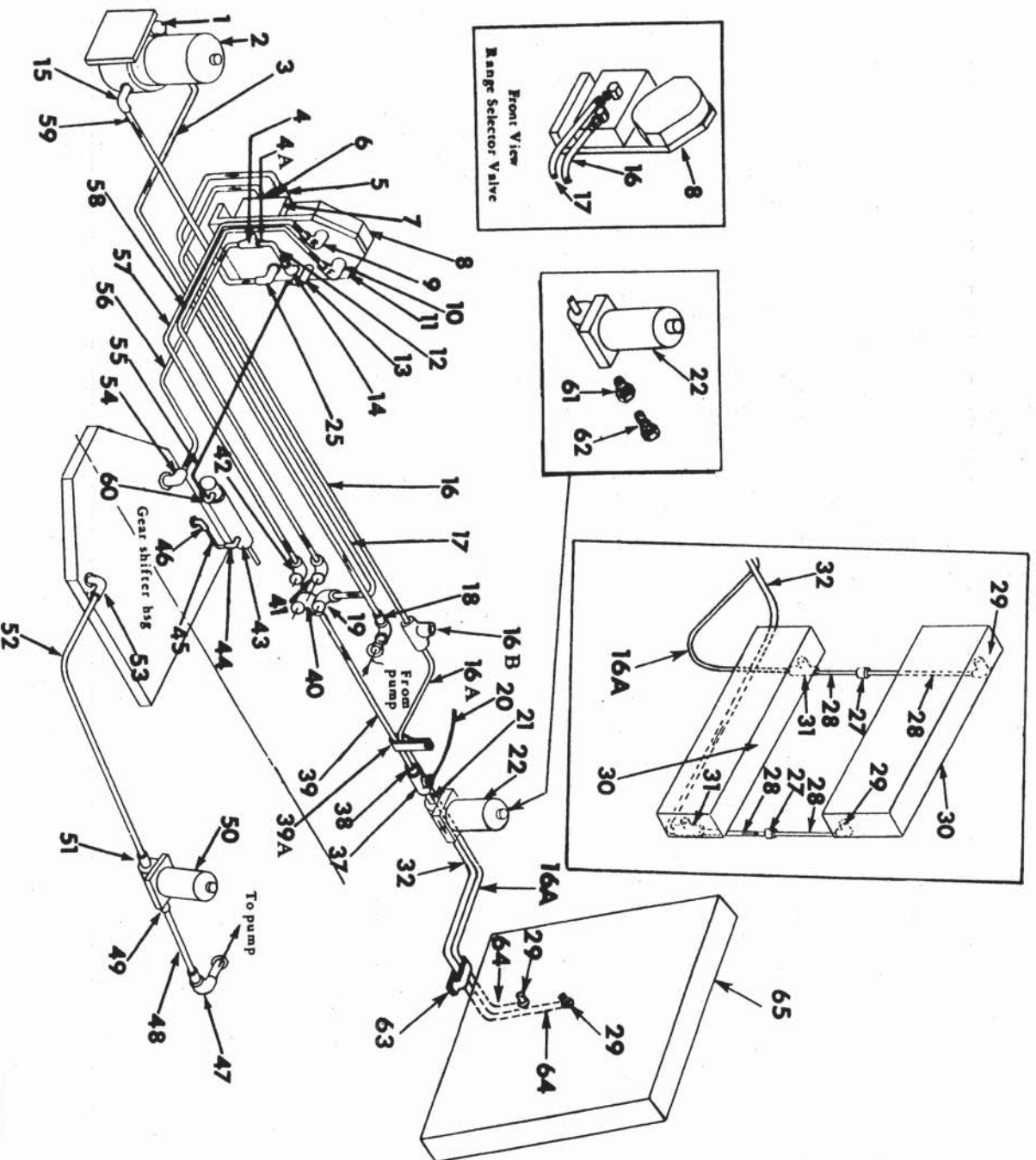

IPB-10731 F

- | | |
|--|---|
| <p>1 297 581 R91 ELBOW, 90° adapter</p> <p>2 25 522 R1 FILTER, pressure (for components see list of parts under details of "Pressure Filter")</p> <p>2 140 483 H NUT, 3/8" (4)</p> <p>115 093 WASHER, 3/8" lock (4)</p> <p>615 031 R1 WASHER, 3/8" (4)</p> | <p>3 338 621 R91 HOSE w/FITTINGS, pump to pressure filter (HOSE, 3/4" ID x 45" long w/FITTINGS)</p> <p>4 338 335 R91 ADAPTER, 90° swivel (3/4-1/8NPT)</p> <p>4A 9 409 271 CONNECTOR, 1/8NPT</p> <p>272 982 FERRULE</p> <p>9 409 521 NUT</p> |
|--|---|

-137-
TRANSMISSION
(Used on Power Shift Tractors)

REF. NO.	PART NUMBER	DESCRIPTION	REF. NO.	PART NUMBER	DESCRIPTION
TRANSMISSION PIPING - Continued					
TD-9BP 6525 to 16366					
5	297 581 R91 144 056	ELBOW, 90° adapter REDUCER, 1-3/4NPT	16A	347 958 R91	HOSE w/two FITTINGS, 347 957 R91, thermo by-pass to regulator - front (HOSE, 5/8" ID x 23" long including FITTINGS) TD-9BP 9810 to 10701
6	346 505 R91	UNION, 90° adapter	16A	319 752 R91	HOSE w/o FITTINGS, cut length 5/8" ID x 19-5/8" long cut from bulk HOSE, 319 710 R1 TD-9BP 9810 to 10701
7	24 916 R1 25 522 R1 115 093	VALVE ASSY, main regulator (for components see list of parts under details of "Main Regulator Valve") SCREW, 3/8 x 4-3/4" hex-hd cap (11) NUT, 3/8" (11) WASHER, 3/8" lock (11)	16A	619 788 C1	HOSE w/two FITTINGS, oil cooler outlet front (HOSE, 1/2" ID x 68" long w/FITTINGS) TD-9BP 15423 up
8	338 587 R91 364 839 R1	VALVE ASSY, range selector (for components see list of parts under details of "Range Selector Valve") NUT, 5/16NF (8) SCREW, 5/16NF x 4-1/2" hex-hd cap (6) SCREW, 5/16NF x 5" hex-hd cap (2) WASHER, 5/16" lock (8)	16B	347 516 R91	TEE, thermo by-pass hose swivel TD-9BP 9809 up
10	338 587 R91 364 839 R1	UNION, adapter (3/8NPT x 90°) "O" RING (.468 x .624 x .078")	17	343 563 R91	HOSE w/two FITTINGS, regulator to converter (HOSE, 5/8" ID x 41" long including FITTINGS)
11	331 669 R1	BRACKET, regulator and selector valve	18	338 586 R91	ADAPTER, union (3/4NPT)
12	334 740 R1	TUBE, regulator to tee	19	338 596 R91 570 838 R1	UNION, 90° adapter "O" RING (.644 x .818 x .087")
13	338 587 R91 364 839 R1	UNION, adapter (3/8NPT x 90°) (2) "O" RING (.468 x .624 x .078")	20	610 794 C91	CABLE, converter temperature (part of converter temperature gauge)
14	9 409 323 272 982 9 409 521	ELBOW, 1/8NPT FERRULE NUT	21	127 878	NIPPLE, 1 x 1-1/2NPT
15	444 377	ELBOW, 3/4NPT street (optional with 454 112)	22	103 343	FILTER ASSY, safety (consists of ELEMENT 346 821 R91, "O" RING, 313 337 R1 and SPRING, 346 822 R1) (Filter Assembly, 610 794 C91 will work for Filter Assembly 333 734 R91)
15	454 112	ELBOW, 3/4NPT street (optional with 444 377)	25	336 009 R91 368 269 R1	WASHER, 17/32 x 1-1/16" x 13 ga (2) WASHER, 1/2" lock (2)
16	343 562 R91	HOSE w/two FITTINGS, thermo by-pass to regulator (HOSE, 5/8" ID x 80" long including FITTINGS) TD-9BP 6501 to 9808	27	324 169 R91	UNION, adapter (3/4NPT x 90°) "O" RING (.924 x 1.166 x .116")
16	347 935 R91	HOSE w/FITTINGS, thermo by-pass to regulator (rear) (HOSE, 5/8" ID x 56" long including FITTINGS) TD-9BP 9809 to 16366	28	330 993 R1	COUPLING, pipe (2) TD-9BP 6525 to 15422
			29	444 044	PIPE, cooler connector (4) TD-9BP 6525 to 15422
			30	333 705 R92	ELBOW, 90° street (2)
				181 361	COOLER, oil (mount ahead of radiator (2))
				181 356	TD-9BP 6525 to 15422
				115 093	SCREW, 3/8NF x 7/8" hex-hd cap (2)
				106 262	SCREW, 3/8NF x 5/8" hex-hd cap (8) WASHER, 3/8" lock (6) WASHER, 3/8" plain (2)

-138-
TRANSMISSION
(Used on Power Shift Tractors)

REF. NO.	PART NUMBER	DESCRIPTION	REF. NO.	PART NUMBER	DESCRIPTION
TRANSMISSION PIPING - Continued					
31	444 138	TEE, 1/2NPT (2) TD-9BP 6525 to 15422	50		FILTER ASSY, suction (For components see list of parts under details of SAFETY and SUCTION FILTERS)
32	343 565 R91	HOSE w/FITTINGS, by-pass housing to oil cooler (HOSE, 1/2" ID x 51" long w/FITTINGS) (2) TD-9BP 6525 to 15422	51	9 409 278	CONNECTOR, 1NPT TD-9BP 6525 to 16347
32	619 789 C1	HOSE w/two FITTINGS, safety filter to oil cooler inlet (HOSE, 1/2" ID x 43" long w/FITTINGS) TD-9BP 15423 to 16366	51	9 409 528 272 989	NUT FERRULE
37	179 626	TEE, reducing (1-1/2 - 1/2")	51	9 410 708	UNION, 1" short swivel TD-9BP 16348 and up
38	336 234 R91	ORIFICE, converter outlet (1/4")	49	296 247 R1 9 409 528 272 989	"O" RING NUT FERRULE
39	343 564 R91	HOSE w/two FITTINGS, converter to safety filter (HOSE, 5/8" ID x 27" long including FITTINGS)	49	9 409 278 272 989 9 409 528	CONNECTOR, 1NPT FERRULE NUT
39A	326 078 R1	CLAMP, hose	50	610 794 C91	FILTER w/ELEMENT, 346 821 R91, "O" RING, 313 337 R91, and SPRING, 346 822 R1, suction
40	338 783 R91 570 828 R1	UNION, adapter (1/2NPT x 90°) "O" RING (.644 x .818 x .087") TD-9BP 6525 to 16366	51	9 409 278 9 409 528 272 989	CONNECTOR, 1NPT NUT FERRULE
41	338 587 R91 364 839 R1	UNION, adapter (3/8NPT x 90°) "O" RING (.468 x .624 x .078")	52	330 789 R1	TUBE, sump to filter
42	338 587 R91 364 839 R1	UNION, adapter (3/8NPT x 90°) "O" RING (.468 x .624 x .078")	53	9 409 330 272 989 9 409 528	ELBOW, 1NPT FERRULE NUT
43		CYLINDER, decelerator (illustrated and listed with "Engine Controls")	54	297 581 R91	ELBOW, 90° adapter
44	333 712 R1 272 984 9 409 523	ELBOW, 1/8NPT FERRULE NUT	55	338 622 R91	HOSE w/two FITTINGS, regulator to decelerator (HOSE, 3/8" ID x 25" long including FITTINGS)
45	330 808 R1	TUBE, decelerator to sump	56	702 200 C1	HOSE w/two FITTINGS, regulator to sump (HOSE, 3/4" ID x 17" long including FITTINGS) TD-9BP 6525 to 16366
46	9 409 325 272 984 9 409 523	ELBOW, 1/4NPT FERRULE NUT	57	338 624 R91	HOSE w/FITTINGS, reverse selector to manifold (HOSE, 1/2 x 40" long w/FITTINGS)
47	9 409 343 272 989 9 409 528	ELBOW, 1NPT FERRULE NUT	58	338 623 R91	HOSE w/FITTINGS, forward selector to manifold (HOSE, 1/2 x 44" long w/FITTINGS)
48	330 790 R1	TUBE, filter to pump	59	702 200 C1	HOSE w/two FITTINGS, pressure filter to regulator (HOSE, 3/4" ID x 17" long including FITTINGS)
49	9 409 278 272 989 9 409 528	CONNECTOR, 1NPT TD-9BP 6525 to 16347 FERRULE NUT	61	120 062	BUSHING, filter reducer pipe TD-9BP 10702 up
49	9 410 708 296 247 R1 9 409 528 272 989	UNION, 1" short swivel TD-9BP 16348 and up "O" RING NUT FERRULE	62	293 350 R91 347 521 R91	UNION, 3/8NPT x 90° adapter ADAPTER, safety filter to oil cooler inlet TD-9BP 10702 to 15422

-139-
TRANSMISSION
(Used on Power Shift Tractors)

REF. NO.	PART NUMBER	DESCRIPTION	REF. NO.	PART NUMBER	DESCRIPTION
TRANSMISSION PIPING - Continued					
62	255 678 C1	NIPPLE, safety filter to oil cooler inlet TD-9BP 15423 up	319 709 R1	HOSE, 1/2" ID bulk (X)	
			219 679	NIPPLE, 1 x 4-1/2" (used on units equipped with a thermo by-pass valve) TD-9BP 6525 to 10701	
63	651 569 C1	CLAMP, cooler hose TD-9BP 15423 up	313 337 R91	"O" RING, safety and suction filter (3.250 x 3.500 x .125") (optional with 354 836 R1) (2)	
	24 839 R1	SCREW, 3/8 x 3/4" hex-hd cap			
	103 341	WASHER, 13/32 x 13/16 x 16 ga			
64	255 678 C1	NIPPLE, cooler inlet and outlet elbow (2) TD-9BP 15423 up	354 836 R1	"O" RING, safety and suction filter (3.250 x 3.500 x .125") (optional with 313 337 R91) (2)	
65	619 787 C2	COOLER, oil (mount ahead of radiator) SCREW, 3/8 x 7/8" hex-hd cap (4) WASHER, 3/8" lock (4) WASHER, 13/32 x 13/16" x 16 ga (4)			
	25 496 R1				
	115 093				
	103 341				
	338 784 R91	ADAPTER, 90° swivel (used on units equipped with a thermo by-pass valve) TD-9BP 6525 to 10701			
	345 811 R91	BAFFLE w/SEAL, 345 810 R1, dust (mounted on top of lower cooler) TD-9BP 9809 to 15422			
	160 834 R91	CLAMP, hose (2)			
	301 819 R1	CLAMP (3) TD-9BP 6525 to 15422			
	24 839 R1	SCREW, 3/8 x 3/4" hex-hd cap (3)			
	330 929 R1	CLIP, oil cooler outlet hose (mounted to front safety filter bolt) TD-9BP 10702 up			
	321 029 R91	ELEMENT, safety and suction filter (used with FILTER, 333 734 R91) (2)			
	346 821 R91	ELEMENT, safety and suction filter (used with FILTER, 610 794 C91) (2)			
	325 040 R1	GASKET, regulator valve			
	325 041 R1	GASKET, hydraulic valve spacer			
	317 623 R1	GROMMET (2) TD-9BP 6525 to 15422			
	318 497 R1	GROMMET, 1-3/4" ID, oil cooler HOSE TD-9BP 15423 up			

(X) - Order Cut Length Required.

-140-
TRANSMISSION
 (Used on Power Shift Tractors)

REF. NO.	PART NUMBER	DESCRIPTION	REF. NO.	PART NUMBER	DESCRIPTION
----------	-------------	-------------	----------	-------------	-------------

TRANSMISSION PIPING
 TD-9BP 16367 and up

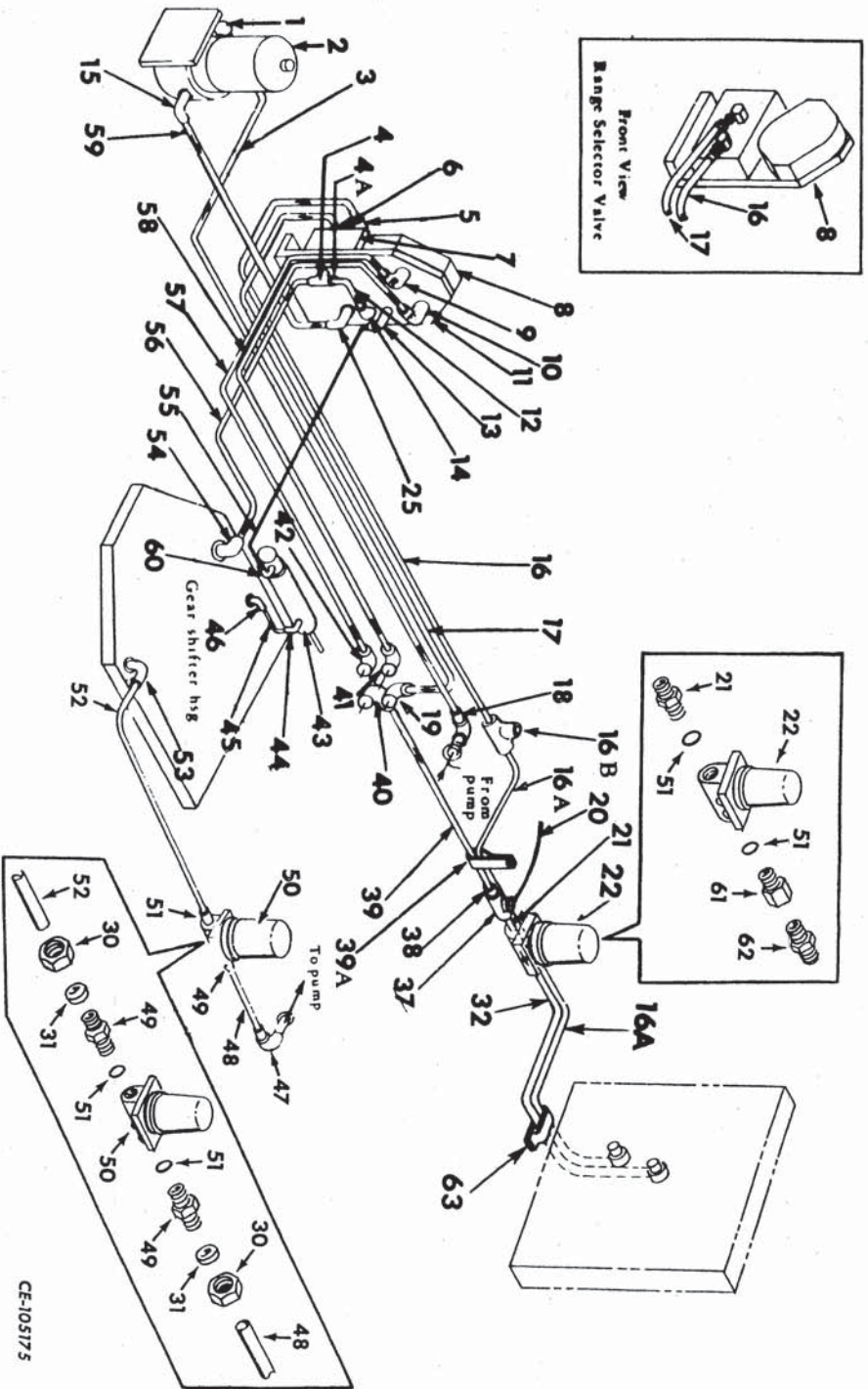

1	297 581 R91	ELBOW, 90° adapter	6	346 505 R91	UNION, 90° adapter
2		FILTER, pressure (for components see list of parts under details of "Pressure Filter")	7		VALVE ASSY, main regulator (for components see list of parts under details of "Main Regulator Valve")
	25 522 R1	NUT, 3/8" (4)		24 916 R1	SCREW, 3/8 x 4-3/4" hex-hd cap (11)
	140 483 H	SCREW, 3/8 x 1-1/4" hex-hd cap (4)		25 522 R1	NUT, 3/8" (11)
	115 093	WASHER, 3/8" lock (4)		115 093	WASHER, 3/8" lock (11)
	615 031 R1	WASHER, 3/8" (4)	8		VALVE ASSY, range selector (for components see list of parts under details of "Range Selector Valve")
3	338 621 R91	HOSE w/FITTINGS, pump to pressure filter (HOSE, 3/4" ID x 45" long w/FITTINGS)		103 025	NUT, 5/16NF (8)
				193 485	SCREW, 5/16NF x 4-1/2" hex-hd cap
4	338 335 R91	ADAPTER, 90° swivel (3/4 - 1/8NPT)		186 306	SCREW, 5/16NF x 5" hex-hd cap (2)
				116 120	WASHER, 5/16" lock (8)
4A	9 409 271	CONNECTOR, 1/8NPT	9	338 587 R91	UNION, adapter (3/8NPT x 90°)
	272 982	FERRULE		364 839 R1	"O" RING (.468 x .624 x .078")
	9 409 521	NUT			
5	297 581 R91	ELBOW, 90° adapter			
	144 056	REDUCER, 1-3/4NPT			

-141-
TRANSMISSION
(Used on Power Shift Tractors)

REF. NO.	PART NUMBER	DESCRIPTION	REF. NO.	PART NUMBER	DESCRIPTION
TRANSMISSION PIPING - Continued					
TD-9BP 16367 and up					
10	338 587 R91 364 839 R1	UNION, adapter (3/8NPT x 90°) "O" RING (.468 x .624 x .078")	37	179 626	TEE, reducing (1-1/2 - 1/2")
11	331 669 R1 25 526 R1 116 121	BRACKET, regulator and selector valve NUT, 1/2" (3) WASHER, 1/2" lock (3)	38	336 234 R91	ORIFICE, converter outlet (1/4")
12	334 740 R1	TUBE, regulator to tee	39	343 564 R91	HOSE w/two FITTINGS, converter to safety filter (HOSE, 5/8" ID x 27" long including FITTINGS)
13	338 587 R91 364 839 R1	UNION, adapter (3/8NPT x 90°) (2) "O" RING (.468 x .614 x .078")	39A	326 078 R1	CLAMP, hose
14	9 409 323 272 982 9 409 521	ELBOW, 1/8NPT FERRULE NUT	40	338 783 R91 570 828 R1	UNION, adapter (1/2NPT x 90°) "O" RING (.644 x .818 x .087")
15	444 377	ELBOW, 3/4NPT street (optional with 454 112)	41	338 587 R91 364 839 R1	UNION, adapter (3/8NPT x 90°) "O" RING (.468 x .624 x .078")
15	454 112	ELBOW, 3/4NPT street (optional with 444 377)	42	338 587 R91 364 839 R1	UNION, adapter (3/8NPT x 90°) "O" RING (.468 x .624 x .078")
16	347 935 R91	HOSE w/FITTINGS, oil cooler outlet (rear) (HOSE, 5/8" ID x 56" long including FITTINGS)	43		CYLINDER, decelerator (illustrated and listed with "Engine Controls")
16A	619 788 C1	HOSEw/two FITTINGS, oil cooler outlet front (HOSE, 1/2" ID x 68" long w/FITTINGS)	44	333 712 R1 272 984 9 409 523	ELBOW, 1/8NPT FERRULE NUT
16B	347 516 R91	TEE, thermo by-pass hose swivel	45	330 809 R1	TUBE, decelerator to sump
17	343 563 R91	HOSE w/two FITTINGS, regulator to converter (HOSE, 5/8" ID x 41" long including FITTINGS)	46	9 409 325 272 984 9 409 523	ELBOW, 1/4NPT FERRULE NUT
18	338 586 R91	ADAPTER, union (3/4NPT)	47	9 409 343 272 989 9 409 528	ELBOW, 1NPT FERRULE NUT
19	338 596 R91 570 838 R1	UNION, 90° adapter "O" RING (.644 x 818 x .087")	48	330 790 R1	TUBE, filter to pump
20		CABLE, converter temperature (Part of converter temperature gauge)	49	9 410 708	UNION, 1" short swivel
21	9 409 278	CONNECTOR, 1" tube safety filter inlet	50		FILTER ASSY, suction (For components see list of parts under details of SAFETY and SUCTION FILTERS)
22		FILTER ASSY, safety (For components, see list of parts under details of SAFETY and SUCTION FILTERS)	51	296 247 R1	"O" RING
23	336 009 R91 368 269 R1	UNION, adapter (3/4NPT x 90°) "O" RING (.924 x 1.166 x 1.16")	52	330 789 R1	TUBE, sump to filter
29	444 044	ELBOW, 90° street (2)	53	9 409 330 272 989 9 409 528	ELBOW, 1NPT FERRULE NUT
30	9 409 528	NUT, tube	54	297 581 R91	ELBOW, 90° adapter
31	272 989	FERRULE	55	338 622 R91	HOSE w/two FITTINGS, regulator to decelerator (HOSE, 3/8" ID x 25" long including FITTINGS)
			56	702 200 C1	HOSE w/two FITTINGS, regulator to sump (HOSE, 3/4" ID x 17" long including FITTINGS)

TRANSMISSION

(Used on Power Shift Tractors)

REF. NO.	PART NUMBER	DESCRIPTION	REF. NO.	PART NUMBER	DESCRIPTION
TRANSMISSION PIPING - Continued					
TD-9BP 16367 and up					
57	338 624 R91	HOSE w/FITTINGS, reverse selector to manifold (HOSE, 1/2 x 40" long w/FITTINGS)	325 030 R1	SPACER, hydraulic valve	
			291 572 R91	UNION, 90° adapter (3/4NPPT)	
58	338 623 R91	HOSE w/Fittings, forward selector to manifold (HOSE, 1/2 x 44" long w/FITTINGS)	331 775 R1	PAD, hydraulic hose clamp (2)	
			444 661	PLUG, 3/8" sq-soc pipe (used on units equipped with a thermo by-pass valve) TD-9BP 6525 to 10701	
59	702 200 C1	HOSE w/two FITTINGS, pressure filter to regulator (HOSE, 3/4" x 17" long including FITTINGS)	345 810 R1	SEAL, dust baffle	
			325 030 R1	SPACER, hydraulic valve	
60	293 350 R91	UNION, 3/8NPPT x 90° adapter	346 822 R1	SPRING, safety and suction filter (used with FILTER, 610794 C91) (2)	
61	659 076 C1	ADAPTER, filter reducer	291 572 R91	UNION, 90° adapter (3/4NPPT)	
62	255 678 C1	NIPPLE, safety filter to oil cooler inlet	291 572 R91	UNION, 90° adapter (used on units equipped with a thermo by-pass valve) TD-9BP 6525 to 10701	
63	651 569 C1 24 839 R1 103 341	CLAMP, cooler hose SCREW, 3/8 x 3/4" hex-hd cap WASHER, 13/32 x 13/16 x 16 ga (4)	346 505 R91	UNION, 45° adapter (used on units equipped with a thermo by-pass valve) TD-9BP 6525 to 10701	
64	255 678 C1	NIPPLE, cooler inlet and outlet elbow (2)			
65	619 787 C2 25 496 R1 115 093	COOLER, oil (mount ahead of radiator) SCREW, 3/8 x 7/8" hex-hd cap (4) WASHER, 13/32 x 13/16" x 16 ga (4)			
	160 834 R91	CLAMP, hose (2)			
	330 929 R1	CLIP, oil cooler outlet hose (mounted to front safety filter bolt)			
	325 040 R1	GASKET, regulator valve			
	325 041 R1	GASKET, hydraulic valve spacer			
	318 497 R1	GROMMET, 1-3/4" ID, oil cooler HOSE			
	331 775 R1	PAD, hydraulic hose clamp (2)			
	345 810 R1	SEAL, dust baffle			
	325 030 R1	SPACER, hydraulic valve			
	291 572 R91	UNION, 90° adapter (3/4NPPT)			
	331 775 R1	PAD, hydraulic hose clamp (2)			
	444 661	PLUG, 3/8" sq-soc pipe (used on units equipped with a thermo by-pass valve) TD-9BP 6525 to 10701			
	345 810 R1	SEAL, dust baffle			

TRANSMISSION

(Used on Power Shift Tractors)

REF. NO.	PART NUMBER	DESCRIPTION	REF. NO.	PART NUMBER	DESCRIPTION
2	700 394 C1	GATE, gear selector hand lever (together with SWITCH, 700 395 C91, BRACKET 700 393 C1, and two BOLT, 12 935 R1 will work for GATE, 330 799 R13, 604 852 C91 or 612 711 C91)			
	25 522 R1	NUT, 3/8" (3)			
	25 496 R1	SCREW, 3/8 x 7/8" hex-hd cap (3)			
	115 093	WASHER, 3/8" lock (3)			
	106 263	WASHER, 7/16 x 1" x 14 ga (3)			
3	264 055 R2	BALL, gear selector hand lever			
4	331 963 R91	GUARD, gear selector hand lever			
5	330 804 R1	SHEET, gear selector housing side LH			
	25 768 R1	SCREW, 3/8 x 5/8" hex-hd cap (6)			
	115 093	WASHER, 3/8" lock (6)			
6	330 802 R11	HOUSING, gear selector hand lever			
7	700 393 C1	BRACKET, starting switch mounting (used only with SWITCH, 700 395 C91) (*)			
	12 935 R1	BOLT (2)			
8	330 803 R11	PLATE, pressure filter mounting			
	24 840 R1	SCREW, 3/8 x 1" hex-hd cap (2)			
	25 768 R1	SCREW, 3/8 x 5/8" hex-hd cap (2)			
	115 093	WASHER, 3/8" lock (4)			

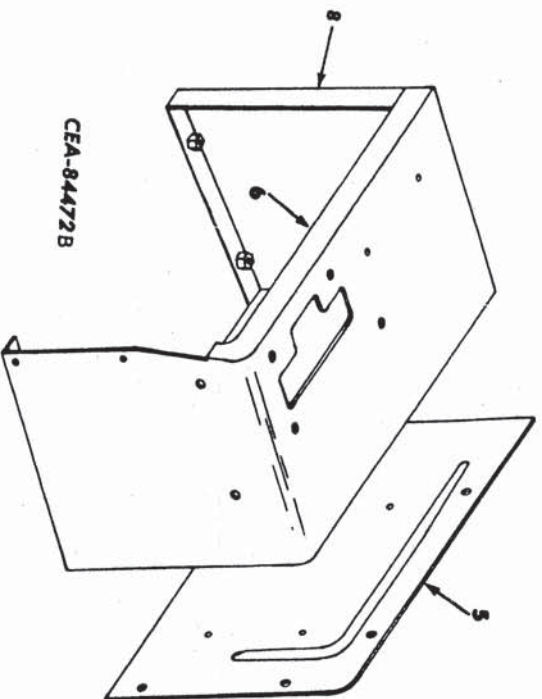
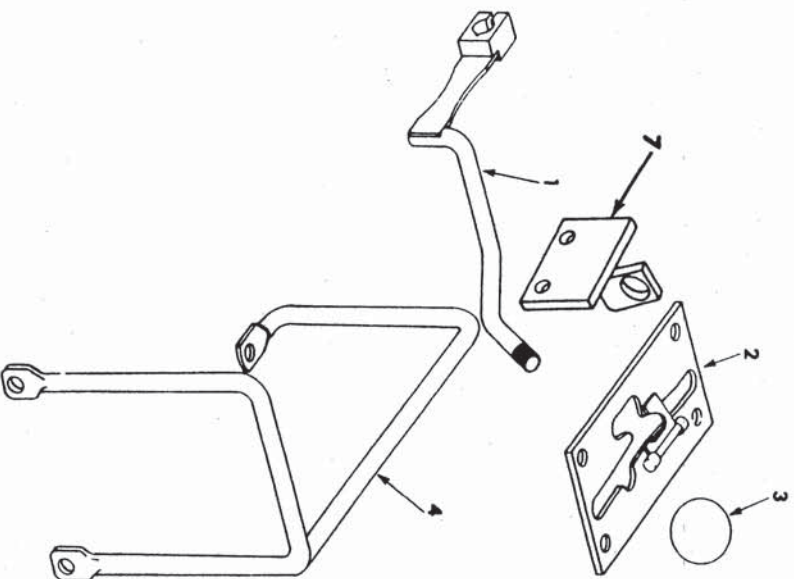

1	330 796 R12	LEVER, gear selector hand
	25 522 R1	NUT, 3/8"
	24 843 R1	SCREW, 3/8 x 2" hex-hd cap
	115 093	WASHER, 3/8" lock

(*) - Also listed with "Electric Starting and Lighting."

-144-
TRANSMISSION
(Used on Power Shift Tractors)

REF. PART NO. NUMBER DESCRIPTION

TRANSMISSION FRONT COVER, OIL PUMP AND RELATED PARTS

REF. PART NO. NUMBER DESCRIPTION

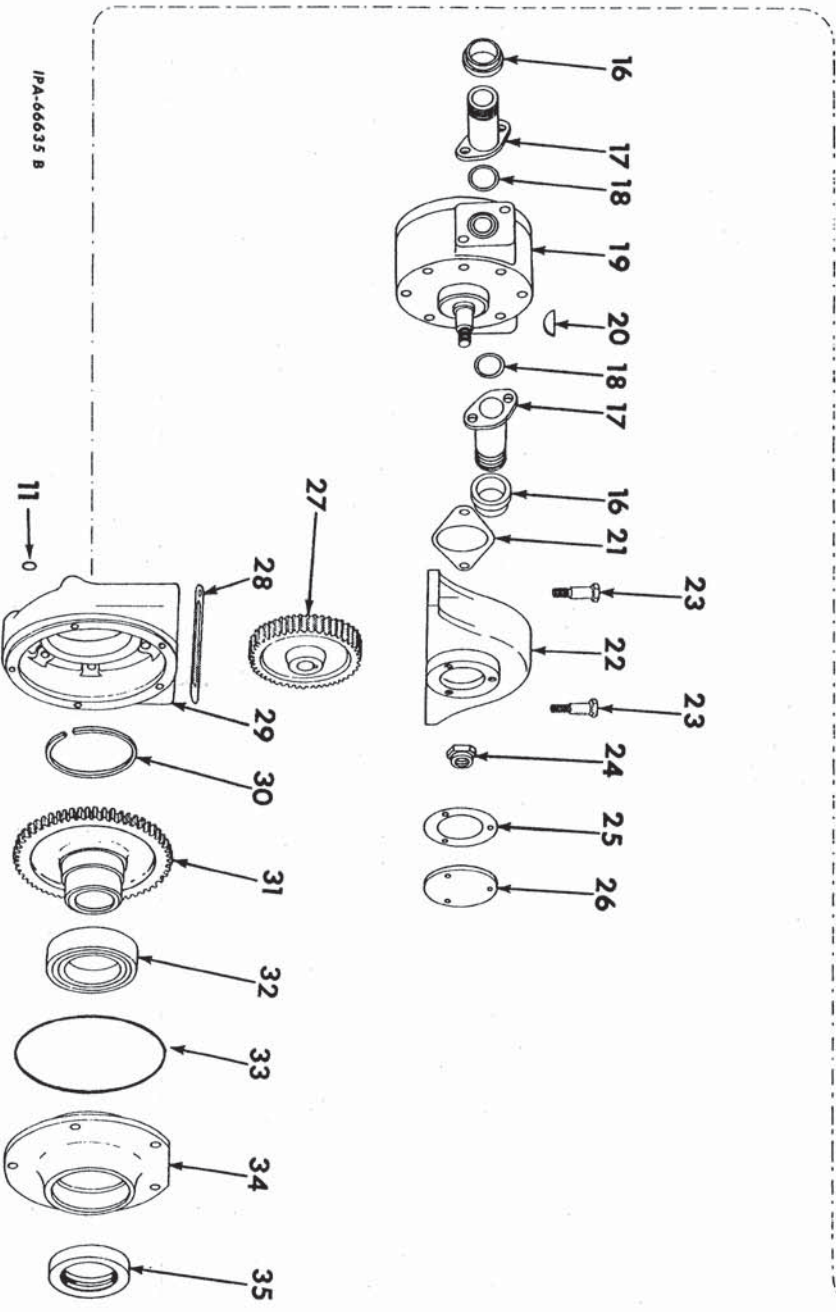
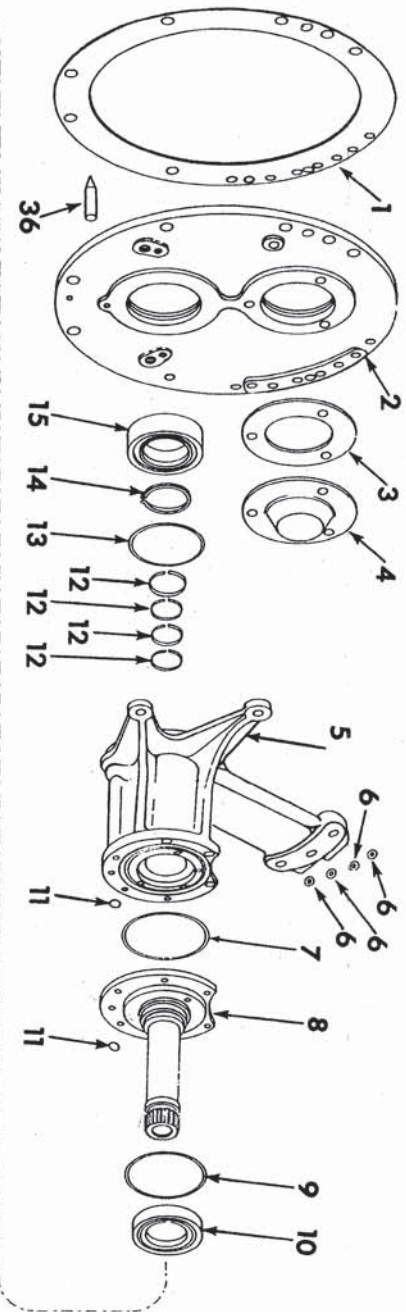

IPA-6635 B

1	331 461 R1	GASKET, transmission front cover	4	338 165 R1	RETAINER, transmission counter-shaft bearing
2	331 463 R11	COVER, w/two PIN, 316 079 R1 transmission front	5	297 330 R1	SCREW, 3/8 x 1" hex-hd cap (3)
	274 863 R1	SCREW, 7/16 x 1-1/8" hex-hd cap (7)		331 460 R11	SUPPORT w/PIN, 141 275 and PLUG, 126 045, pump drive housing
3	327 925 R1	GASKET, transmission countershaft front bearing retainer		274 864 R1	SCREW, 1/2 x 1-3/8" hex-hd cap (3)
				24 855 R1	SCREW, 7/16 x 3" hex-hd cap (3)
				115 314	WASHER, 7/16" lock (3)

-145-
TRANSMISSION
(Used on Power Shift Tractors)

REF. NO.	PART NUMBER	DESCRIPTION	REF. NO.	PART NUMBER	DESCRIPTION
TRANSMISSION FRONT COVER, OIL PUMP AND RELATED PARTS - Continued					
6	252 739 R1	"O" RING (1/2 x 11/16 x 3/32") (4)	28	327 923 R1	GASKET, pump mounting housing
7	259 246 R1	"O" RING, converter stator support quill (3-7/8 x 4-1/8")	29	327 963 R2	HOUSING, pump drive (together w/ "O" RING, 264 681 R1 will work for 327 963 R1)
8	331 462 R1 313 756 R1	QUILL, converter stator support SCREW, 3/8 x 1-1/4" hex-hd cap (6)	30	327 420 R1	RING, pump drive gear sealing
9	468 339 R1	"O" RING, converter stator support quill (4 x 4-1/4 x 1/8")	31	327 953 R1	GEAR, pump drive (33 T) TD-9BP 6525 to 9905
10	ST-572	BEARING, input drive	31	604 845 C1	GEAR, pump drive (33 T) TD-9BP 9906 up
11	355 967 R1	"O" RING (3/8 x 1/2 x 1/16") (3)	32	65 490 D	BEARING, pump drive gear front
12	325 059 R1	RING, input shaft sealing (4)	33	264 681 R1	"O" RING (6-1/2 x 6-3/4 x 1/8") TD-9BP 9906 up
13	610 411 C1	"O" RING, pump drive housing support (3-1/2 x 3-3/4 x 1/8")	33	327 928 R1	GASKET, pump drive housing cover TD-9BP 6525 to 9905
14	466 191 R1	RING, input shaft front bearing snap	34	327 957 R2 25 496 R1 115 093	COVER, pump drive housing SCREW, 3/8 x 7/8" hex-hd cap (5) WASHER, 3/8" lock (5)
15	327 428 R92	BEARING, input shaft front	35	327 424 R92	SEAL, pump drive housing TD-9BP 6525 to 9905 (Order the following parts - 1 SEAL 643 247 C91 1 SLEEVE 709 612 C1 1 DRAWING CZG 2355)
16	330 851 R1	BUSHING, pump inlet and outlet pipe (2)	35	643 247 C91	SEAL, pump drive housing TD-9BP 6525 to 9905
17	330 850 R11 24 840 R1 115 093	PIPE, pump inlet and outlet (2) SCREW, 3/8 x 1" hex-hd cap (4) WASHER, 3/8" lock (4)	35	709 612 C1	SLEEVE, seal (used w/SEAL, 643 247 C91)
18	708 560 R1	"O" RING (1-5/16 x 1/8") (2)	35	606 293 C91	SEAL, pump drive housing TD-9BP 9906 up
19	327 421 R91	PUMP, converter supply (for components see list of parts under details of "Converter Supply Pump")	36	341 763 R1	PIN, transmission baffle guide (tur- nished as part of PACKAGE, 341 762 R91) (2) TD-9BP 6525 to 8013
20	124 549	KEY, 3/16 x 3/4" (Woodruff No. 911)	36	316 079 R1	PIN, transmission baffle guide (2) TD-9BP 8014 up
21	327 945 R1	GASKET, pump	36	141 275	PIN, pump drive housing support dowel
22	327 964 R1	HOUSING, pump mounting	36	45 132 D	PIN, front cover dowel
23	327 924 R2	BOLT, pump housing dowel (2) WASHER, 1/2" external tooth lock (2)	36	444 783	PLUG, pump drive housing support pipe (3/8")
24	19 263 R1	NUT, 5/8NF (Esna)			
25	327 922 R1	GASKET, pump mounting housing cover			
26	327 921 R1 25 228 R1 116 120	COVER, pump mounting housing SCREW, 5/16 x 3/4" hex-hd cap (3) WASHER, 5/16" lock (3)			
27	327 961 R1	GEAR, pump driven (46 T)			

-146-
TRANSMISSION
(Used on Power Shift Tractors)

REF. NO.	PART NUMBER	DESCRIPTION	REF. NO.	PART NUMBER	DESCRIPTION
----------	-------------	-------------	----------	-------------	-------------

CONVERTER SUPPLY PUMP
(Webster)

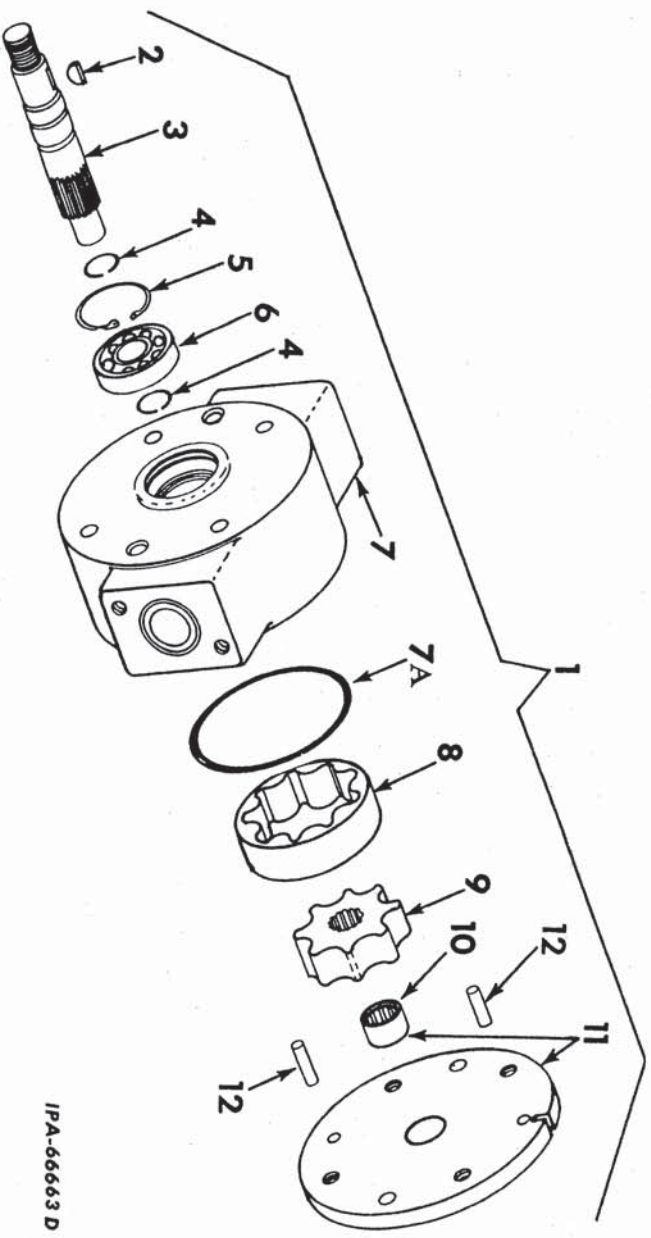

1	327 421 R91	PUMP, converter supply	7A	343 700 R1	"O" RING (4 x 4-3/16 x 3/32")
2	124 549	KEY, pump drive gear (Woodruff) (3/16 x 3/4")	8	333 827 R1	GEAR, outer
3	333 825 R2	SHAFT, drive	9	333 826 R1	GEAR, inner
4	454 331 R1	RING, shaft retaining (2)	10	276 578 R91	BEARING, needle
5	272 842 R1	RING, bearing retainer	11	333 822 R91	COVER w/BEARING, 276 578 R91, pump housing end
6	333 829 R91	BEARING, ball	12	343 691 R1	PIN, cover mounting dowel (2)
7	333 824 R1 333 830 R1	HOUSING, pump SCREW, counterbore (5/16 x 2") (4)			

-147-
TRANSMISSION
 (Used on Power Shift Tractors)

REF. NO.	PART NUMBER	DESCRIPTION	REF. NO.	PART NUMBER	DESCRIPTION
----------	-------------	-------------	----------	-------------	-------------

CLUTCH PACK AND RELATED PARTS
 (Rockford)

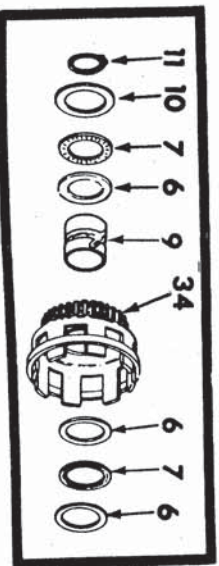
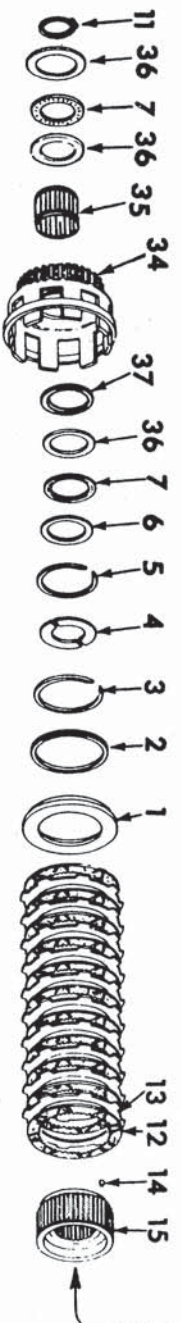
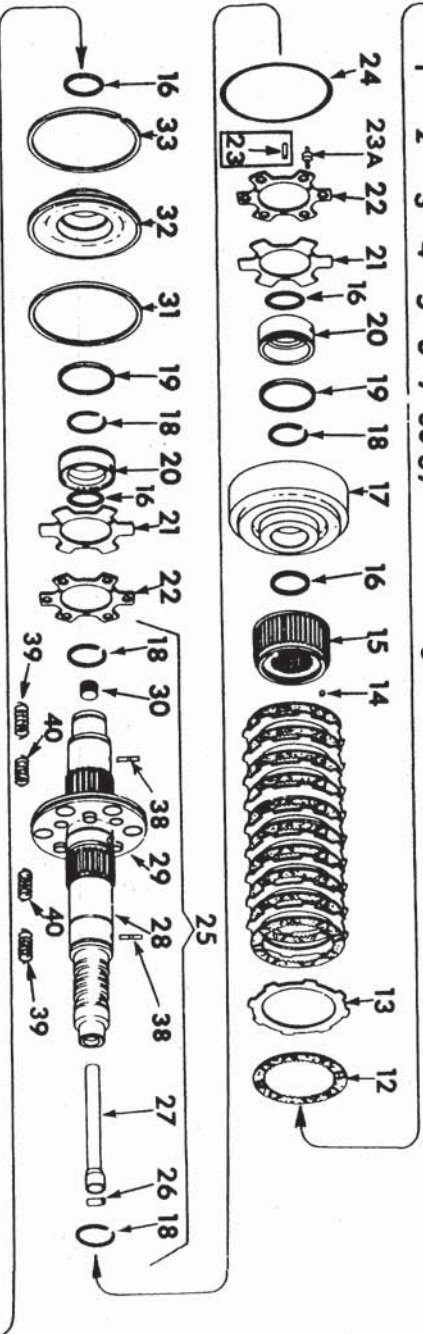
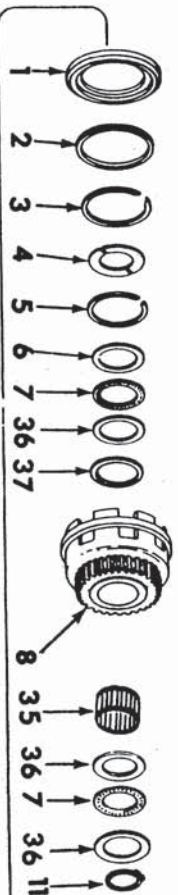
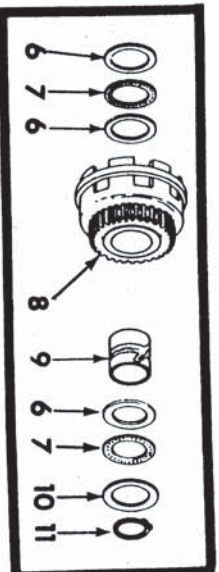

IPA-66642F

1	324 242 R 1	PLATE, clutch backing (used w/HUB, 346 647 R91) (2)	2	267 367 C 1	RING, snap (INT) (part of HUB ASSY, 627 401 C91) (2)
1	627 365 C 1	PLATE, backing (part of HUB ASSY, 627 401 C91) (2)	3	333 857 R 2	RING, snap (EXT) (used w/HUB, 346 647 R91) (2)
1	324 245 R 1	RING, snap (INT) (used w/HUB, 346 647 R91) (2)	3	627 366 C 1	RING, snap (EXT) (part of HUB ASSY, 627 401 C91) (2)

-148-
TRANSMISSION
 (Used on Power Shift Tractors)

REF. NO.	PART NUMBER	DESCRIPTION	REF. NO.	PART NUMBER	DESCRIPTION
CLUTCH PACK AND RELATED PARTS - Continued (Rockford)					
4	324 231 R1	RETAINER, clutch hub (4)	20	324 221 R1	PISTON, accelerating (order two PISTON, 610 481 C1)
5	324 232 R1	RING, snap (internal) (2)	20	610 481 C1	PISTON, accelerating (used with CLUTCH PACK 610 484 C91 and 610 752 C92) (2)
6	584 269 R1	SPACER, washer (6) TD-9BP 6525 to 12648 (2) TD-9BP 12649 up	20	627 093 C1	PISTON, accelerating (used with CLUTCH PACK 625 777 C91) (Order 1 HOUSING 627 669 C1, 1 PISTON, 627 668 C1, 2 PISTON, 627 667 C1, and 3 PIN, 627 666 C1) (2)
7	584 268 R91	BEARING, needle thrust (4)	20	627 667 C2	PISTON, accelerating (used with CLUTCH PACK 625 777 C92) (2)
8	333 852 R91	GEAR w/BUSHING, 610 008 C1, clutch second speed drive TD-9BP 6525 to 12648	21	610 751 C1	VALVE, disc (2)
8	610 827 C91	GEAR, clutch second speed drive TD-9BP 12469 up	22	610 760 C1	DISC, reinforcing (used with CLUTCH PACK, 610 464 C91 and 610 752 C92)
9	610 008 C1	BUSHING, first and second drive clutch gear (2) TD-9BP 6525 to 12648	22	625 205 C1	DISC, reinforcing (used with CLUTCH PACK, 327 422 R92 and 625 777 C92)
10	333 853 R1	SPACER, washer (2) TD-9BP 6525 to 12648	23	324 218 R1	PIN, dowel (used with CLUTCH PACK, 327 422 R92) (3)
11	287 049 R1	RING, external snap (2)	23A	610 755 C1	PIN, dowel (used with CLUTCH PACK, 610 464 C91 and 610 752 C92) (for CLUTCH PACK, 625 777 C91 order 1 HOUSING, 627 669 C1, 1 PISTON, 627 668 C1, 2 PISTON, 627 667 C1, and 3 PIN, 627 666 C1) (3)
12	324 240 R1	PLATE, internal splined (order 22 plate 702 959 C1) (see NOTE)	23A	627 666 C2	PIN, dowel (used with CLUTCH PACK, 625 777 C92) (3)
12	702 959 C1	PLATE, internal splined (22 plates, 702 959 C1 will work for plates, 324 240 R1) (see NOTE) (22)	24	324 227 R1	"O" RING
13	324 241 R1	plate, external plined (20)	25	333 854 R92	SHAFT ASSY, clutch (order KIT, 630 110 C1)
14	324 244 R1	PIN, dowel (used w/HUB 346 647 R91) (2)	25	610 809 C91	SHAFT ASSY, clutch (order KIT, 630 110 C1)
15	346 647 R91	HUB, clutch (order HUB ASSY, 627 401 C91) (2)	25	610 825 C91	SHAFT ASSY, clutch (order KIT, 630 110 C1)
15	627 400 C1	HUB, clutch (part of HUB ASSY, 627 401 C91) (2)	25	627 091 C91	SHAFT ASSY, clutch (Composed of - 1 PIN 606 102 C1 2 PIN 17 164 R1 1 PLATE 627 092 C1 1 PLUG 347 553 R1 2 RING 324 222 R1 1 SHAFT)
16	627 969 C1	"O" RING (piston hook type) (2, used with CLUTCH PACK, 610 464 C91 and 610 752 C92, 4, used with CLUTCH PACK, 625 777 C92)	25	610 825 C91	SHAFT ASSY, clutch (Order the following - 2 DISC 625 205 C1 2 PISTON 627 667 C1 1 SHAFT 627 091 C91 6 SPRING 625 206 C1 6 SPRING 625 821 C1)
17	324 228 R2	HOUSING, piston (for CLUTCH PACK 610 464 C91 and 610 752 C92 order HOUSING 627 669 C1) (for CLUTCH PACK 625 777 C91 order 1 HOUSING 627 669 C1, 1 PISTON 627 668 C1, 2 PISTON, 627 667 C1, and 3 PIN 627 666 C1)	25	627 091 C91	SHAFT ASSY, clutch (Composed of - 1 PIN 606 102 C1 2 PIN 17 164 R1 1 PLATE 627 092 C1 1 PLUG 347 553 R1 2 RING 324 222 R1 1 SHAFT)
17	627 669 C2	HOUSING, piston			
18	324 222 R1	RING, snap (external) (4)			
19	324 223 R1	"O" RING (piston hook type) (2)			

§ - Not Furnished Separately

TRANSMISSION

(Used on Power Shift Tractors)

REF. NO.	PART NUMBER	DESCRIPTION	REF. NO.	PART NUMBER	DESCRIPTION
CLUTCH PACK AND RELATED PARTS - Continued (Rockford)					
26	606 102 C1	PIN, dowel	627 401 C91	HUB ASSY (2) (Composed of -	627 400 C1 627 365 C1 627 366 C1 627 367 C1)
27		TUBE, clutch shaft (not furnished separately)	610 464 C91	PACK ASSY, final clutch (will work for 327 422 R92) TD-9BP 6525 to 12648	
28		SHAFT (not furnished separately)		(Consists of -	
29	346 596 R91 610 877 C91) TD-9BP 6525 to 11305	PLATE, separator (order PACKAGE, TD-9BP 6525 to 11305		4 BEARING 2 DISC 1 GEAR ASSY 1 GEAR ASSY 1 HOUSING 2 HUB ASSY 2 "O" RING 4 "O" RING 1 "O" RING 3 PIN 2 PISTON 1 PISTON 22 PLATE 20 PLATE 4 RETAINER	584 268 R91 610 760 C1 333 851 R91 333 852 R91 627 669 C1 627 401 C91 324 223 R1 627 969 C1 324 226 R1 324 227 R1 610 755 C1 610 481 C1 627 668 C1 702 959 C1 324 241 R1 324 241 R1 324 231 R1 287 049 R1 324 232 R1 324 232 R1 347 297 R1
29	610 478 C1	PLATE, separator TD-9BP 11306 to 15338		2 "O" RING 4 "O" RING 1 "O" RING 3 PIN 2 PISTON 1 PISTON 22 PLATE 20 PLATE 4 RETAINER	627 401 C91 324 223 R1 627 969 C1 324 226 R1 324 227 R1 610 755 C1 610 481 C1 627 668 C1 702 959 C1 324 241 R1 324 241 R1 324 231 R1 287 049 R1 324 232 R1 324 232 R1 347 297 R1
29	627 092 C1	PLATE, separator TD-9BP 15339 up		2 RING 4 RING 2 RING 1 RING 1 SHAFT ASSY 2 SPACER 6 SPACER 2 VALVE	610 755 C1 610 481 C1 627 668 C1 702 959 C1 324 241 R1 324 241 R1 324 231 R1 287 049 R1 324 232 R1 324 232 R1 347 297 R1
30	324 236 R1	PLUG, 3/8" pipe TD-9BP 6525 to 8625		2 PISTON 1 PISTON 22 PLATE 20 PLATE 4 RETAINER	610 481 C1 627 668 C1 702 959 C1 324 241 R1 324 241 R1 324 231 R1 287 049 R1 324 232 R1 324 232 R1 347 297 R1
30	347 552 R1	PLUG, 1/2" pipe TD-9BP 8626 up		2 RING 4 RING 2 RING 1 RING 1 SHAFT ASSY 2 SPACER 6 SPACER 2 VALVE	610 755 C1 610 481 C1 627 668 C1 702 959 C1 324 241 R1 324 241 R1 324 231 R1 287 049 R1 324 232 R1 324 232 R1 347 297 R1
31	324 226 R1	"O" RING (lathe cut)		2 RING 4 RING 2 RING 1 RING 1 SHAFT ASSY 2 SPACER 6 SPACER 2 VALVE	610 755 C1 610 481 C1 627 668 C1 702 959 C1 324 241 R1 324 241 R1 324 231 R1 287 049 R1 324 232 R1 324 232 R1 347 297 R1
32	324 225 R2	PISTON, clutch (for CLUTCH PACK, 610 464 C91 and 610 752 C92, order PISTON, 627 668 C1) (for CLUTCH PACK, 625 777 C91, order 1 HOUSING, 627 669 C1, 1 PISTON, 627 668 C1, 2 PISTON, 627 667 C1, and 3 PIN, 627 666 C1	610 752 C92	PACK ASSY, final clutch (order PACK ASSY, 625 777 C92) TD-9BP 12649 to 15338	
32	627 668 C2	PISTON, clutch		(Consists of -	
33	347 297 R1	RING, snap (internal)		4 BEARING 2 BEARING 2 DISC 1 GEAR ASSY 1 GEAR ASSY 1 HOUSING 2 HUB ASSY 2 "O" RING 4 "O" RING 1 "O" RING 1 "O" RING 3 PIN 2 PISTON 1 PISTON 22 PLATE 20 PLATE 4 RETAINER	584 268 R91 610 828 C91 610 760 C1 610 826 C91 610 827 C91 627 669 C1 627 401 C91 324 223 R1 627 969 C1 324 226 R1 324 227 R1 610 755 C1 610 481 C1 627 668 C1 702 959 C1 324 241 R1 324 241 R1 324 231 R1 287 049 R1 324 232 R1 324 232 R1 347 297 R1
34	333 851 R91	GEAR w/BUSHING, 610 008 C1, clutch first speed drive TD-9BP 6525 to 12648		1 GEAR ASSY 1 GEAR ASSY 1 HOUSING 2 HUB ASSY 2 "O" RING 4 "O" RING 1 "O" RING 1 "O" RING 3 PIN 2 PISTON 1 PISTON 22 PLATE 20 PLATE 4 RETAINER	610 826 C91 610 827 C91 627 669 C1 627 401 C91 324 223 R1 627 969 C1 324 226 R1 324 227 R1 610 755 C1 610 481 C1 627 668 C1 702 959 C1 324 241 R1 324 241 R1 324 231 R1 287 049 R1 324 232 R1 324 232 R1 347 297 R1
34	610 826 C91	GEAR, clutch first speed drive TD-9BP 12649 up		1 GEAR ASSY 1 HOUSING 2 HUB ASSY 2 "O" RING 4 "O" RING 1 "O" RING 1 "O" RING 3 PIN 2 PISTON 1 PISTON 22 PLATE 20 PLATE 4 RETAINER	610 826 C91 610 827 C91 627 669 C1 627 401 C91 324 223 R1 627 969 C1 324 226 R1 324 227 R1 610 755 C1 610 481 C1 627 668 C1 702 959 C1 324 241 R1 324 241 R1 324 231 R1 287 049 R1 324 232 R1 324 232 R1 347 297 R1
35	610 828 C91	BEARING, roller, first and second drive clutch gear (2) TD-9BP 12649 up		2 HUB ASSY 2 "O" RING 4 "O" RING 1 "O" RING 1 "O" RING 3 PIN 2 PISTON 1 PISTON 22 PLATE 20 PLATE 4 RETAINER	610 828 C91 610 827 C91 627 669 C1 324 226 R1 324 227 R1 610 755 C1 610 481 C1 627 668 C1 702 959 C1 324 241 R1 324 241 R1 324 231 R1 287 049 R1 324 232 R1 324 232 R1 347 297 R1
36	610 769 C1	WASHER, thrust (6) TD-9BP 12649 up		2 PISTON 1 PISTON 22 PLATE 20 PLATE 4 RETAINER	610 769 C1 610 481 C1 627 668 C1 702 959 C1 324 241 R1 324 241 R1 324 231 R1 287 049 R1 324 232 R1 324 232 R1 347 297 R1
37	610 829 C1	SPACER, bearing (2) TD-9BP 12649 up		4 RING 2 RING 4 RING 4 RING 1 RING 1 SHAFT ASSY 2 SPACER 2 SPACER 2 VALVE 6 WASHER	610 829 C1 610 829 C1 610 825 C91 610 829 C1 584 269 R1 610 751 C1 610 769 C1)
38	17 164 R1	PIN, spring		1 RING 1 RING 1 RING 1 RING 1 RING 1 SHAFT ASSY 2 SPACER 2 SPACER 2 VALVE 6 WASHER	610 829 C1 610 829 C1 610 825 C91 610 829 C1 584 269 R1 610 751 C1 610 769 C1)
39	625 206 C1	SPRING, comp (6) TD-9BP 15339 up		1 RING 1 RING 1 RING 1 RING 1 RING 1 SHAFT ASSY 2 SPACER 2 SPACER 2 VALVE 6 WASHER	610 829 C1 610 829 C1 610 825 C91 610 829 C1 584 269 R1 610 751 C1 610 769 C1)
40	625 821 C1	SPRING, comp (6) TD-9BP 15339 up		1 RING 1 RING 1 RING 1 RING 1 RING 1 SHAFT ASSY 2 SPACER 2 SPACER 2 VALVE 6 WASHER	610 829 C1 610 829 C1 610 825 C91 610 829 C1 584 269 R1 610 751 C1 610 769 C1)

s - Not Furnished Separately

TRANSMISSION

(Used on Power Shift Tractors)

REF. NO.	PART NUMBER	DESCRIPTION	REF. NO.	PART NUMBER	DESCRIPTION
----------	-------------	-------------	----------	-------------	-------------

CLUTCH PACK AND RELATED PARTS - Continued
(Rockford)

625 777 C92	PACK ASSY, final clutch				
	TD-9BP 15339 up				
	(Consists of -				
4	BEARING	584 268 R91			
2	BEARING	610 828 R91			
2	DISC	625 205 C1			
1	GEAR ASSY	610 826 C91			
1	GEAR ASSY	610 827 C91			
1	HOUSING	627 669 C2			
2	HUB ASSY	627 401 C91			
2	"O" RING	324 223 R1			
4	"O" RING	627 969 C1			
1	"O" RING	324 226 R1			
1	"O" RING	324 227 R1			
3	PIN	627 666 C1			
2	PISTON	627 667 C2			
1	PISTON	627 668 C2			
22	PLATE	702 959 C1			
20	PLATE	324 241 R1			
4	RETAINER	324 231 R1			
2	RING	287 049 R1			
4	RING	324 222 R1			
2	RING	324 232 R1			
1	RING	347 297 R1			
1	SHAFT ASSY	627 091 C91			
2	SPACER	610 829 C1			
2	SPACER	584 269 R1			
6	SPRING	625 206 C1			
6	SPRING	625 821 C1			
2	VALVE	610 751 C1			
6	WASHER	610 769 C1)			

630 110 C1	KIT, clutch shaft field service				
	TD-9BP 6525 to 12648				
	(Consists of -				
2	DISC	625 205 C1			
1	HOUSING	627 669 C1			
3	PIN	627 666 C1			
2	PIN	17 169 R1			
2	PISTON	627 667 C1			
1	PISTON	627 668 C1			
1	RING	324 226 R1			
1	RING	324 227 R1			
2	RING	324 223 R1			
4	RING	627 969 C1			
1	RING	347 297 R1			
2	RING	324 222 R1			
1	SHAFT ASSY				
6	SPRING	625 206 C1			
6	SPRING	625 821 C1			
2	VALVE	610 751 C1)			

610 877 C91	PACKAGE, separator plate field ser-				
	vice				
	TD-9BP 6525 to 11305				
	(Consists of -				
2	DISC	610 760 C1			
3	PIN	610 755 C1			
1	PLATE	610 478 C1			
2	PISTON	610 481 C1			
1	RING	324 226 R1			
1	RING	324 227 R1			
2	VALVE	610 751 C1)			

§ - Not Furnished Separately