

CLUTCH

ENGINE OVER-CENTER CLUTCH 12"
(Hand Operated) (Rockford Drilling Machine)

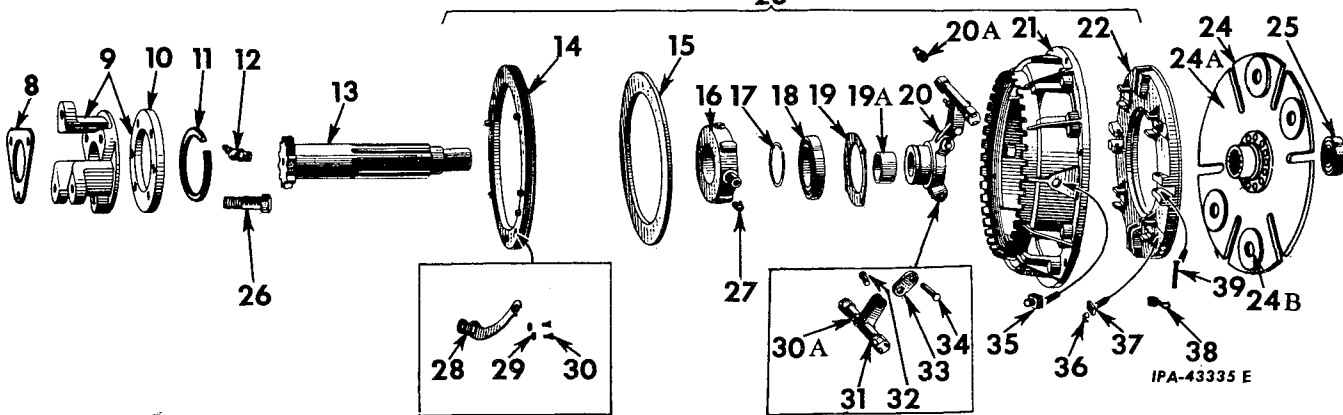
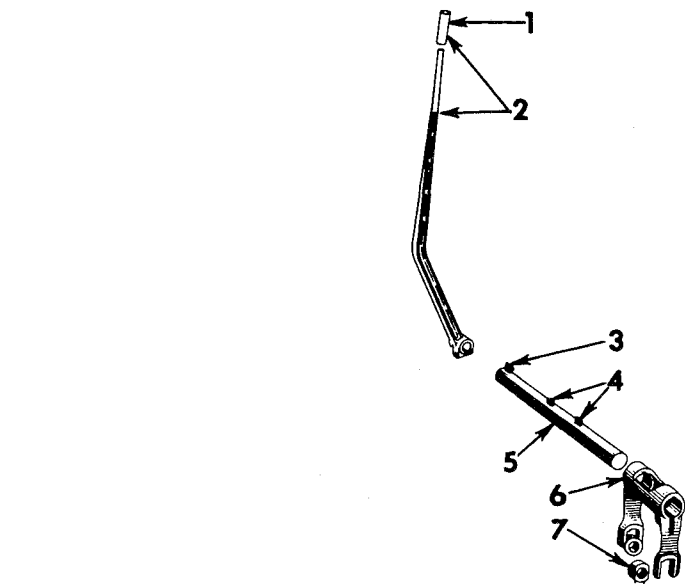

REF. NO.	I. H. PART NUMBER	DESCRIPTION
1	41 597 DA	HANDLE, engine clutch hand lever
2	305 278 R11	LEVER w/HANDLE, 41 597 DA, engine clutch hand(*)
2	275 227 R11	LEVER w/HANDLE, 41 597 DA, engine clutch hand 1/2NF NUT 1/2NF x 2-1/2" hex-hd. cap SCREW 1/2" lock WASHER
3	103 909	KEY, No. 18, 1/4 x 1-1/8" engine clutch hand lever (Woodruff)
4	103 462	KEY, No. 18, 3/16 x 1" engine clutch hand lever (Woodruff) (2)
5	53 513 D	SHAFT, engine clutch release(*)
5	275 347 R1	SHAFT, engine clutch release
6	8 247 DB	FORK, engine clutch release 3/8NF x 1-1/2" hex-hd. cap SCREW (2) 3/8" lock WASHER (2)

CLUTCH

ENGINE OVER-CENTER CLUTCH 12"
(Hand Operated) (Rockford Drilling Machine)

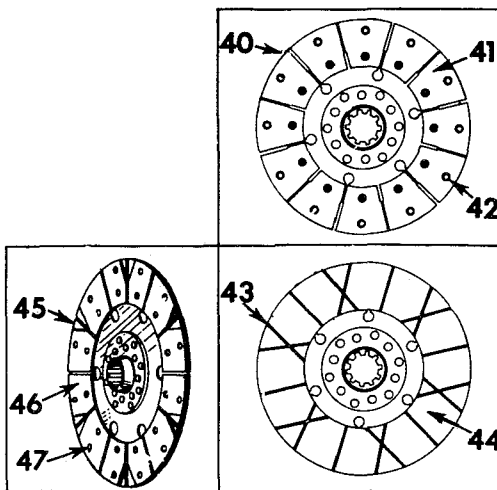

REF. NO.	I. H. PART NUMBER	DESCRIPTION
7	51 227 DB	BUSHING, engine clutch release pin (2)
8	259 688 R1	PLATE, engine clutch shaft end 5/16NF x 1/2" hex-hd. cap SCREW (3) 5/16" lock WASHER (3)
9	266 457 R11	COUPLING w/FACING and RIVET, 21 407 H, engine clutch RIVET, engine clutch brake facing (6)
10	259 689 R1	FACING, engine clutch brake disc
11	266 458 R1	RING, engine clutch coupling snap
12	127 743	FITTING, engine clutch pilot bearing lubrication
13	266 456 R1	SHAFT, engine clutch
14	57 252 DB	RING, adjusting (CL-4817-3)
15	42 236 D	PLATE, adjusting ring (CL-3563)

(*) - Used Only on Units With Low Seat Attachment.



CLUTCH

REF. NO.	I.H. PART NUMBER	DESCRIPTION
ENGINE OVER-CENTER CLUTCH 12" - CONTINUED (Hand Operated) (Rockford Drilling Machine)		
16	55 232 DA	CARRIER, release bearing (CL-4649)
17	29 780 D	RING, snap (CL-3302)
18	ST 312	BEARING, ball
19	31 242 DA	PLATE, bearing (CL-3401-4) 5/16 x 5/8" hex-hd. cap SCREW w/lock WASHER (CL-9232) (4)
19A	55 741 D	BUSHING (CL-3559)
20	55 725 DCXA	SLEEVE w/two BUSHINGS, 55 741 D and FITTING, 271 282 (CL-4839-2)
20A	109 459	FITTING, sleeve lubrication
21	42 231 DX	PLATE w/four STUDS, 26 036 D, back (UCL-3565)
22	324 737 R1	PLATE, pressure (together with 273 169 R91 will work for 273 168 R91) (CL-3564-2)
23	55 687 DH	COVER ASSEMBLY, less driven clutch member (UCLA-33-3565) (Composed of - 1 BEARING ST 312 1 CAMSHAFT 273 167 R93 1 CARRIER 55 232 DA 2 LINK 43 207 D 1 LOCK 273 264 R1 4 PIN 26 032 D 2 PACKAGE 267 679 R91 2 PACKAGE 267 680 R91 1 PLATE 31 242 DA 1 PLATE 42 231 DX 1 PLATE 42 236 D 1 PLATE 324 737 R1 1 RING 29 780 D 1 RING 57 252 DB 1 SCREW 61 115 D 1 SLEEVE 55 725 DCXA 4 SPRING 317 833 R1 4 WASHER 267 689 R1 4 WASHER 615 029 R1 1/2 x 1-1/4" hex-hd. cap SCREW (6) 1/2" lock WASHER (6)
24	324 997 R91	MEMBER w/eight FACING and four RIVET, 338 360 R1
24A	324 998 R91	PACKAGE, clutch facing field service (cerametallic) (consists of two FACING w/RIVET, 338 360 R1) (UCL-11415-90- CR2) (4)
24B	338 360 R1	RIVET, clutch facing (CL-10858-1) (4)
25	ST 208 B	BEARING, clutch pilot ball
26	54 969 D	BOLT, engine clutch coupling dowel (3) 7/16NF NUT (3) 7/16" lock WASHER (3)
27	109 462	FITTING, engine clutch release bearing lubrication
28	273 264 R1	LOCK, adjusting (CL-10123)
29		NUT, 3/8" adjusting lock screw (light) (CL-1608)
30	61 115 D	SCREW, adjusting lock (CL-5215)
30A	109 460	FITTING, camshaft lubrication (2)
31	273 167 R93	CAMSHAFT (set of two) (w/two FITTINGS, 109 460) (together with 324 737 R1 and 273 169 R91 will work for 273 167 R92) (UCLB-4336-34)



CLUTCH

REF. NO.	I.H. PART NUMBER	DESCRIPTION
ENGINE OVER-CENTER CLUTCH 12" - CONTINUED (Hand Operated) (Rockford Drilling Machine)		
32	267 680 R91	PACKAGE, connecting link pin (short) field service (consists of PIN (short), WASHER, 615 029 R1 and WASHER, 267 689 R1 for 3/8" dia. pin) (UCL-9315-C) (2)
	615 029 R1	WASHER, 3/8 x 3/4" x No. 16 ga. (CL- 4347) (2)
	267 689 R1	"X" WASHER (CL-9318) (2)
33	43 207 D	LINK, connecting (CL-4339-1) (2)
34	267 679 R91	PACKAGE, connecting link pin (long) field service (consists of PIN (long), WASHER, 615 029 R1 and WASHER, 267 689 R1 for 3/8" dia. pin) (UCL-9314-1C) (2)
35	26 036 D	STUD, drive (CL-3011) (4)
36		WASHER, 1/4" external-tooth lock (CL-3468) (4)
37	273 169 R91	CAMBLOCK SET (consists of four CAMBLOCKS, with four SCREWS, 261 106 R1) (UCL-3478-2-54)
38	317 833 R1	SPRING, return (11324) (4)
39	26 032 D	PIN, return spring (CL-3030) (4) 1/16 x 1/2" cotter PIN (CL-3923) (4)
40	313 370 R92	MEMBER w/bi-metallic FACING, driven clutch (UCL-44-3832-1)
41	313 527 R92	PACKAGE, clutch facing field service (bi- metallic) (consists of two clutch FACING and twenty-six RIVET, 96 189 R1) (CL-11284-81-CR-2)
42	96 189 R1	RIVET, clutch facing (used with PACKAGE 313 527 R92) (CL-6058-1) (26)
43	277 423 R91	MEMBER w/asbestos metallic FACING, driven clutch (UCL-29-3832-CR1)
44	277 424 R91	PACKAGE, clutch facing field service (asbestos metallic) (consists of two clutch FACING and twenty-six RIVET, 28 755 D) (UCL-6826-14CR-2)
45	303 764 R91	MEMBER w/two FACING and twenty-six RIVET, 96 189 R1 driven (UCL-43-3832-1)
46	313 525 R92	PACKAGE, clutch facing field service (feramic) (consists of two FACING and twenty-six RIVET, 96 189 R1) (UCL-11284- 63-CR-2)
47	96 189 R1	RIVET, tubular clutch facing (CL-6058-1) (26)
	322 753 R91	ATTACHMENT, asbestos metallic driven member (consists of MEMBER, 277 423 R91 and PAMPHLET, 1 014 738 R1) (See NOTES 1 and 3)
	331 203 R91	ATTACHMENT, bi-metallic driven member (Consists of MEMBER w/bi-metallic FACING, 313 370 R92) (See NOTES 1 and 3)
	301 819 R1	CLAMP, hose
	308 882 R1	CLAMP, hose 3/8" NUT 3/8 x 1-1/4" hex-hd cap SCREW 3/8" lock WASHER 7/16 x 1-3/8 x .083" WASHER
	28 755 D	RIVET, clutch facing (used with PACKAGE, 277 424 R91) (CL-1525) (26)
		NOTE 1 - Factory Application - Order On Machine Order Form. NOTE 3 - Field Application - Order Through Regular Service Parts Channels.



STEERING SYSTEM

STEERING CLUTCH RELEASE SHAFT AND MECHANISM



STEERING SYSTEM

STEERING CLUTCH RELEASE SHAFT AND MECHANISM - CONTINUED

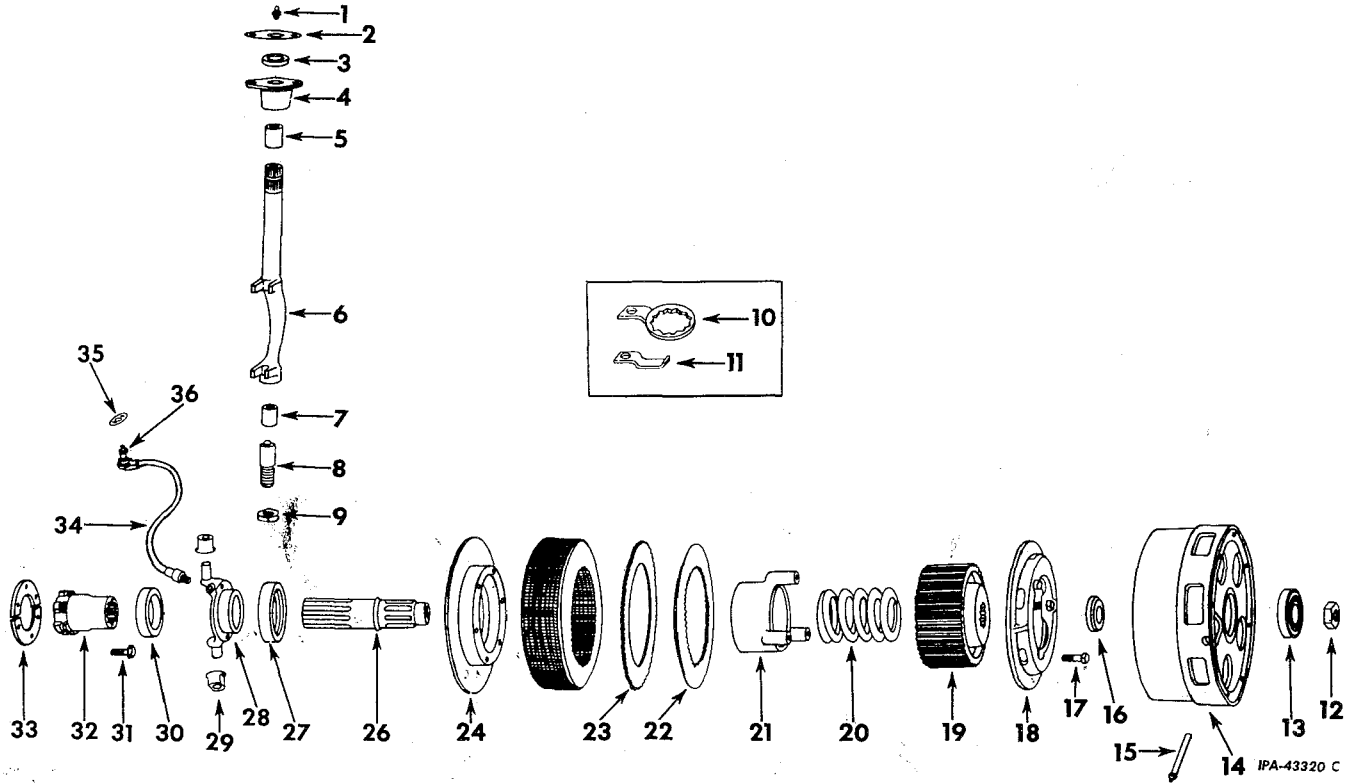

REF. NO.	I.H. PART NUMBER	DESCRIPTION
1	109 461	FITTING, steering clutch release fork lubrication
2	46 040 D	RETAINER, steering clutch release shaft bearing felt (2) 7/16 x 1-1/4" hex-hd. cap SCREW (4) 7/16" lock WASHER (4)
3	46 038 D	FELT, steering clutch release shaft bearing (2)
4	6 376 DAX	BEARING w/BUSHING, 53 597 D, steering clutch release shaft (2)
5	53 597 D	BUSHING, steering clutch release shaft (2)
6	55 956 DD	SHAFT and FORK w/BUSHING, 55 955 DA steering clutch release (2)
7	55 955 DA	BUSHING, steering clutch release fork pivot (2)
8	55 954 DA	PIVOT, steering clutch release fork (2)
9	47 726 D	NUT, steering clutch release fork pivot lock (2)

REF. NO.	I.H. PART NUMBER	DESCRIPTION
10	60 096 D	LOCK, steering clutch release fork pivot nut (2)
11	60 095 D	LOCK, steering clutch release fork pivot (2) 1/2 x 1" hex-hd. cap SCREW (2) 1/2" lock WASHER (2)
12	258 278 R1	NUT, steering clutch bearing retainer pilot (2)
13	ST 333	BEARING, steering clutch pilot ball (2)
14	8 154 DB	DRUM, steering clutch (See NOTE) (2) 3/8NF x 7/8" hex-hd. cap SCREW (16) 3/8" external-tooth lock WASHER (16)
15	51 433 D	FITTING, steering clutch pilot bearing lubrication (2)

NOTE: Do not use a 8 154 DA Drum on one side and a 8 154 DB Drum on the other side. If necessary order two 8 154 DB Drums, if 8 154 DA Drums are no longer available. This recommendation is being made so that an equal adjustment and wear pattern will be apparent on both drums after operation.



STEERING SYSTEM

REF. NO.	I. H. PART NUMBER	DESCRIPTION
STEERING CLUTCH, RELEASE SHAFT AND MECHANISM - CONTINUED		
16	51 430 DX	SLINGER w/SPACER, steering clutch pilot bearing oil (2)
17	54 969 D	BOLT, steering clutch pressure plate dowel (6) 7/16" lock WASHER (6)
18	8 155 DB	PLATE, steering clutch pressure (2)
19	8 153 DE	HUB, steering clutch (59 T) (2)
20	54 759 DA	SPRING, steering clutch pressure (2)
21	8 156 DB	RETAINER, steering clutch pressure spring (2)
22	320 394 R91	DISC, steering clutch friction (bi-metallic) (used with ATTACHMENT, 320 399 R91) (26)
22	43 729 DB	DISC, steering clutch friction (not bi-metallic) (not used with ATTACHMENT, 320 399 R91) (24)
23	43 728 D	DISC, steering clutch driving (†) (22)
24	6 659 DA	PLATE, steering clutch hub (2)
26	258 276 R3	SHAFT, steering clutch (2)
27	55 670 D	BEARING, steering clutch release thrust ball (2)
28	8 157 DAX	COLLAR w/PLUG, 103 883, steering clutch release (2)
	103 883	PLUG, 1/8" slotted-hdls. pipe (2)
29	42 298 DB	BUSHING, steering clutch release pin (4)
30	313 912 R92	OIL SEAL, steering clutch shaft coupling (will work for 279 495 R92 and 310 526 R91) (*) (2)
31	260 612 R1	BOLT, steering clutch shaft coupling retainer (12)
32	322 969 R11	COUPLING w/PLUG, 322 970 R1, steering clutch shaft (6 T) (2)
33	254 960 R1	RETAINER, steering clutch shaft (4)
34	52 244 DX	TUBE w/COUPLING and BRACKET, steering clutch release bearing grease (2)
	13 243 R1	BOLT, 1/4 x 3/4" mach. (4) 1/4" NUT (4) 1/4" lock WASHER (4)
35	282 233 R1	GASKET, steering clutch release bearing tube (2)
36	126 121	FITTING, steering clutch release bearing lubrication (2)
	320 399 R91	ATTACHMENT, bi-metallic steering clutch (consists of twenty six DISC, 320 394 R91 and two DISC, 43 728 D) (for TD-6 only) (See NOTES 1 and 3)
	105 404	NIPPLE, steering clutch release collar (2)
	172 598	PLUG, 2-1/4 expansion (steering clutch shaft coupling) (used with COUPLING, 254 959 R11) (2)



STEERING SYSTEM

REF. NO.	I. H. PART NUMBER	DESCRIPTION
STEERING CLUTCH, RELEASE SHAFT AND MECHANISM - CONTINUED		
	322 970 R1	PLUG, steering clutch shaft coupling (used with COUPLING, 322 969 R11) (2)
		WIRE, locking (16 ga. x 8" long) (steering clutch shaft coupling bolt) (order 278 027 R91) (6)
	278 027 R91	WIRE, locking bulk (16 ga.) (customer must specify length required) (X)
		(X) - As Required
		(†) - Twenty Four Required When Used With ATTACHMENT, 320 399 R91
		(*) - Also Listed And Illustrated With ("Steering System Drive Bevel Gear")
		NOTE 1 - Factory Application - Order On Machine Order Form.
		NOTE 3 - Field Application - Order Through Regular Service Parts Channels.