

CLUTCH

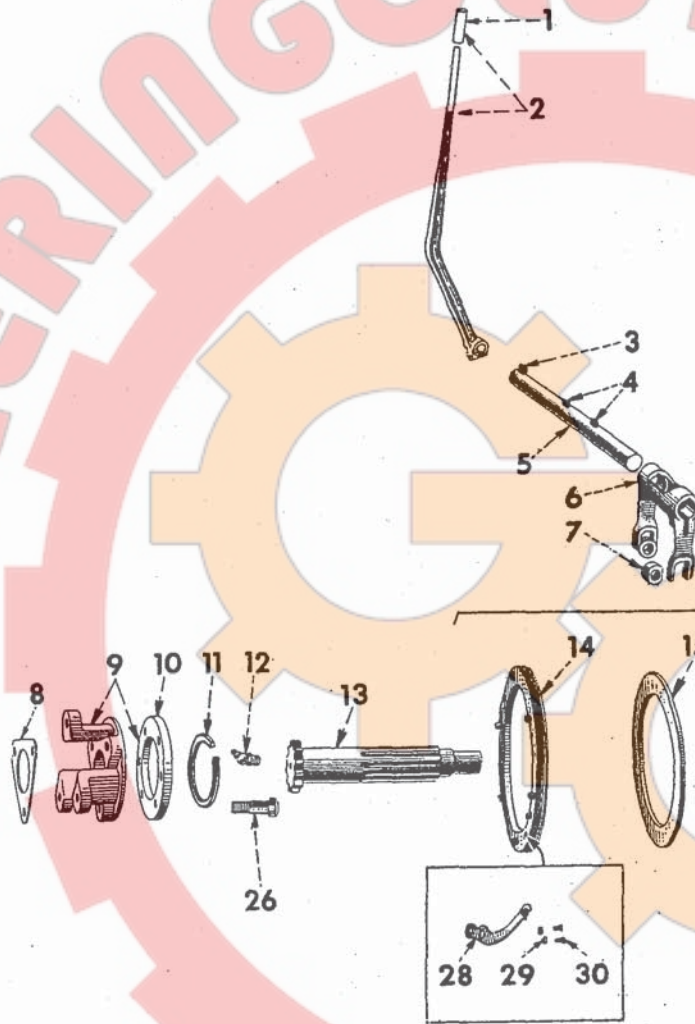

REF. NO.	PART NUMBER	DESCRIPTION
----------	-------------	-------------

ENGINE OVER-CENTER CLUTCH 12"
(Hand Operated) (Rockford Drilling Machine) (T-61 and TD-61)



CLUTCH



REF. NO.	PART NUMBER	DESCRIPTION
----------	-------------	-------------

ENGINE OVER-CENTER CLUTCH 12"
(Hand Operated) (Rockford Drilling Machine) (T-61 and TD-61) - Continued

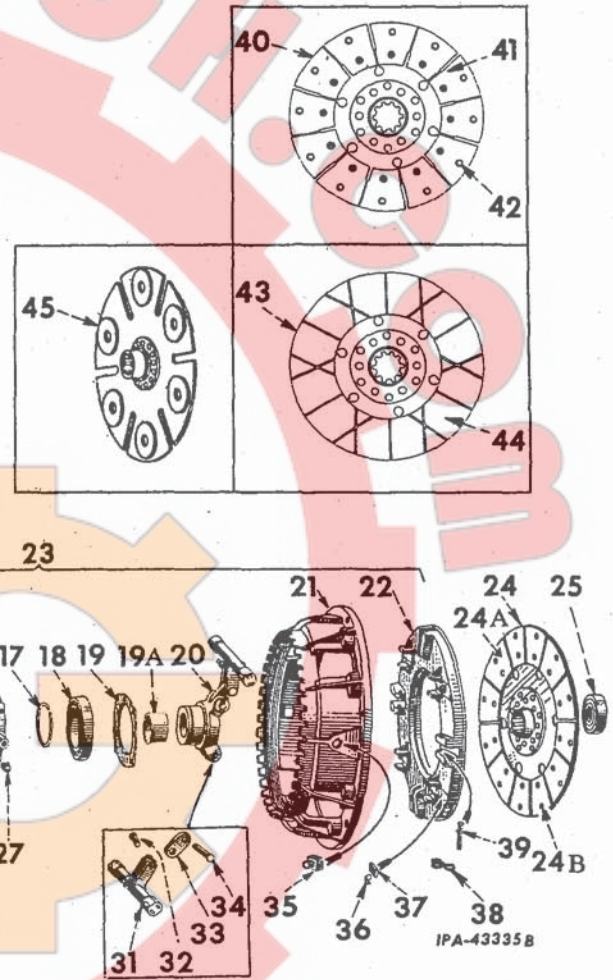

- | | | |
|---|-------------|--|
| 1 | 41 597 DA | HANDLE, engine clutch hand lever |
| 2 | 275 227 R11 | LEVER w/HANDLE, 41 597 DA, engine clutch hand
1/2NF NUT
1/2NF x 2-1/2" hex-hd. cap SCREW
1/2" lock WASHER |
| 3 | 103 909 | KEY, No. 18, 1/4 x 1-1/8" engine clutch hand lever (Woodruff) |
| 4 | 103 462 | KEY, No. 18, 3/16 x 1" engine clutch hand lever (Woodruff) (2) |
| 5 | 275 347 R1 | SHAFT, engine clutch release |
| 6 | 8 247 DA | FORK, engine clutch release
3/8NF x 1-1/2" hex-hd. cap SCREW (2)
3/8" lock WASHER (2) |
| 7 | 51 227 D | BUSHING, engine clutch release pin (2) |

- | | | |
|----|-------------------------|---|
| 3 | 259 688 R1 | PLATE, engine clutch shaft end
5/16NF x 1/2" hex-hd. cap SCREW (3)
5/16" lock WASHER (3) |
| 9 | 266 457 R11
21 407 H | COUPLING w/FACING and RIVET, 21 407 H, engine clutch
RIVET, engine clutch brake facing (6) |
| 10 | 259 689 R11 | PACKAGE, engine clutch brake facing field service (consists of FACING and six RIVETS, 21 407 H) |
| 11 | 266 458 R1 | RING, engine clutch coupling snap |
| 12 | 18 275 R91 | FITTING, engine clutch pilot bearing lubrication (Alemite No. 1623B) |
| 13 | 266 456 R1 | SHAFT, engine clutch |
| 14 | 57 252 DB | RING, adjusting (CL-4817-3) |
| 15 | 42 236 D | PLATE, adjusting ring (CL-3563) |

CLUTCH



REF. NO.	PART NUMBER	DESCRIPTION
----------	-------------	-------------

ENGINE OVER-CENTER CLUTCH 12"
(Hand Operated) (Rockford Drilling Machine) (T-61
and TD-61) - Continued

CLUTCH



REF. NO.	PART NUMBER	DESCRIPTION
----------	-------------	-------------

ENGINE OVER-CENTER CLUTCH 12"
(Hand Operated) (Rockford Drilling Machine) (T-61
and TD-61) - Continued

16	55 232 DA	CARRIER, release bearing (CL-4649)
17	29 780 D	RING, snap (CL-3302)
18	ST 312	BEARING, ball
19	31 242 DA	PLATE, bearing (CL-3401-4) 5/16 x 5/8" hex-hd. cap SCREW w/lock WASHER (CL-2932) (4)
19A	55 741 D	BUSHING (CL-3559)
20	55 725 DCXA	SLEEVE w/two BUSHINGS, 55 741 D and FITTING, 271 282 (CL-4839-2)
21	42 231 DX	PLATE w/four STUDS, 26 036 D, back (UCL-3565)
22	273 168 R91	PLATE w/CAMBLOCK, 273 169 R91, pressur (UCL-1-3564)
23	55 687 DG	COVER ASSEMBLY, less driven clutch member (UCLA-27-3565) (Composed of - 1 BEARING ST 312 1 CAMSHAFT 273 167 R92 1 CARRIER 55 232 DA 2 LINK 43 207 D 1 LOCK 273 264 R1 4 PIN 26 032 D 2 PACKAGE 267 679 R91 2 PACKAGE 267 680 R91 1 PLATE 31 242 DA 1 PLATE 42 231 DX 1 PLATE 42 236 D 1 PLATE 273 168 R91 1 RING 29 780 D 1 RING 57 252 DB 1 SCREW 61 115 D 1 SLEEVE 55 725 DCXA 4 SPRING 38 514 D 4 WASHER 267 689 R1 4 WASHER 615 029 R1) 1/2 x 1-1/2" hex-hd. cap SCREW (6) 1/2" lock WASHER (6)
24	303 764 R91	MEMBER w/two sintered metal FACING, 303 765 R1 and twenty-four RIVET, 96 189 R1 (UCL-35-38322-1)
24A	303 765 R1	FACING, sintered metal clutch (CL-10928-63) (2)
24B	96 189 R1	RIVET, tubular clutch facing (CL-6058-1) (24)
25	ST 208 B	BEARING, clutch pilot ball (used with T-61)
25	ST 544	BEARING, clutch pilot ball (used with TD-61)
26	54 969 D	BOLT, engine clutch coupling dowel (3) 7/16NF NUT (3) 7/16" lock WASHER (3)
27	271 417	FITTING, engine clutch release bearing lubrication (optional with 271 285)
27	271 285	FITTING, engine clutch release bearing lubrication (optional with 271 417)
28	273 264 R1	LOCK, adjusting (CL-10123)
29		NUT, 3/8" adjusting lock screw (light) (CL-1608)

30	61 115 D	SCREW, adjusting lock (CL-5215)
31	273 167 R92	CAMSHAFT (set of two) (w/two FITTINGS, 271 284) (UCL-7-4337-7-52)
32	267 680 R91	PACKAGE, connecting link pin (short) field service (consists of PIN (short), WASHER, 615 029 R1 and WASHER, 267 689 R1 for 3/8" dia. pin) (UCL-9315-C) (2)
	615 029 R1	WASHER, 3/8 x 3/4" x No. 16 ga. (CL- 4347) (2)
	267 689 R1	"X" WASHER (CL-9318) (2)
33	43 207 D	LINK, connecting (CL-4339-1) (2)
34	267 679 R91	PACKAGE, connecting link pin (long) field service (consists of PIN (long), WASHER, 615 029 R1 and WASHER, 267 689 R1 for 3/8" dia. pin) (UCL-9314-1C) (2)
35	26 036 D	STUD, drive (CL-3011) (4)
36		WASHER, 1/4" external-tooth lock (CL-3468) (4)
37	273 169 R91	CAMBLOCK SET (consists of four CAMBLOCKS, with four SCREWS, 261 106 R1) (UCL-3478-2-54)
38	38 514 D	SPRING, return (CL-3558) (4)
39	26 032 D	PIN, return spring (CL-3030) (4) 1/16 x 1/2" cotter PIN (CL-3923) (4)
40	277 415 R91	MEMBER w/bi-metallic FACING, driven clutch (UCL-28-3832-1)
41	277 416 R91	PACKAGE, clutch facing field service (bi-metallic) (consists of two clutch FACING and twenty-six RIVET, 277 682 R1) (CL-10682-13-CR2)
42	277 682 R1	RIVET, clutch facing (used with PACKAGE 277 416 R91) (CL-6058) (26)
43	277 423 R91	MEMBER w/asbestos metallic FACING, driven clutch (UCL-29-3832-CR1)
44	277 424 R91	PACKAGE, clutch facing field service (asbestos metallic) (consists of two clutch FACING and twenty-six RIVET, 28 755 D) (UCL-6826-14CR-2)
45	273 259 R91	MEMBER, driven clutch, w/ceramic FACING (UCL-14-3832-1)
	271 282	FITTING, lubrication (Alemite 1611B) (used with sleeve) (optional with 271 414) (CL-7926)
	271 414	FITTING, lubrication (Lincoln 105100) (used with sleeve) (optional with 271 282) (CL-7926)
	271 284	FITTING, lubrication (Alemite 1612-B) (used with camshaft) (optional with 271 416) (CL-10251) (2)
	271 416	FITTING, lubrication (Lincoln 105300) (used with camshaft) (optional with 271 284) (CL-10251) (2)
	28 755 D	RIVET, clutch facing (used with PACKAGE, 277 424 R91) (CL-1525) (26)