



# CRAWLER TRACTORS STEERING AND BRAKE MECHANISM



REF. NO.	PART NUMBER	DESCRIPTION
----------	-------------	-------------

REF. NO.	PART NUMBER	DESCRIPTION
----------	-------------	-------------

## STEERING CLUTCH AND HOUSING

## STEERING CLUTCH AND HOUSING - Cont

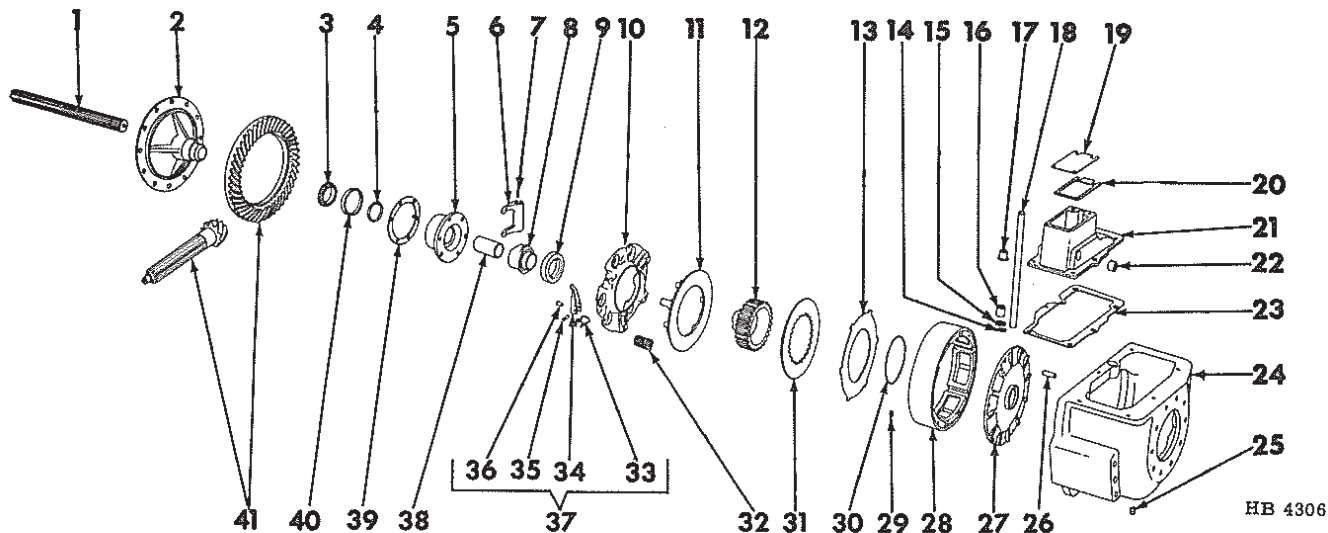

1	635 390 R1	SHAFT, bevel gear and hub spline
2	635 383 R2 3042 127 R1 114 607	HUB, bevel gear 7/16-NF x 1-1/8" special BOLT (12) 7/16" external tooth lock WASHER (12)
3	567 846 R91	CONE, bevel gear bearing (2)
4	567 845 R1	CUP, bevel gear bearing (2)
5	636 415 R91	OIL SEAL, bevel gear bearing (2)
6	635 382 R1	FORK, steering clutch release (2) 3/8 x 1-1/8" hexagon BOLT (4) 3/8" lock WASHER (4)
7	635 098 R1	KEY, release fork (2)
8	635 377 R1	SLEEVE, clutch release bearing (2)
9	359 957 R91	BEARING, clutch release (2)
10	352 744 R91 7 911 T 635 401 R1	PLATE, clutch back (2)(Includes SEATS, 7911 T) Lever adjusting screw SEAT (6) 5/16 x 3-1/2" hexagon BOLT (12) 21/64 x 9/16 x 22 gauge special WASHER (use as required) 5/16" hex. NUT (12) 5/16" lock WASHER (12)

10	635 557 R91	CLUTCH ASSEMBLY, steering (2)
Cont		composed of:
	1	Package 353 246 R91
	1	Plate 351 448 R1
	1	Plate 352 744 R91
	6	Spring 635 561 R1
11	351 448 R1	PLATE, clutch pressure (2)
12	635 376 R1	HUB, steering clutch driving (2)(tractors prior to serial No. 3545)
12	636 416 R1	HUB, steering clutch driving (2)(tractors with serial No. 3545 and up)
13	635 384 R1	PLATE, steering clutch driven (2) / 2
14	154 665 R1	RING, release shaft retaining (2)
15		WASHER, 25/32 x 1-1/4 x 16 gauge plain (2)
16	635 057 R1	BUSHING, clutch release shaft lower (2)
17		BUSHING, release shaft upper (2)(on tractors prior to serial No. 3673 order 1-636 681 R1, Boot and 1-636 682 R1, Bushing)
17	636 682 R1	BUSHING, release shaft upper (2)(tractors with serial No. 3673 and up)
18	635 387 R1	SHAFT, clutch release left
18	635 388 R1	SHAFT, clutch release right

\* Not Serviced Separately



# CRAWLER TRACTORS STEERING AND BRAKE MECHANISM



REF. NO.	PART NUMBER	DESCRIPTION
STEERING CLUTCH AND HOUSING - Cont		
19	635 049 R1	PLATE, housing inspection (2) 1/4 x 1/2" hexagon BOLT (2) 1/4" lock WASHER (4)
20	635 680 R2	GASKET, inspection plate (2)
21	635 009 R11	COVER, steering clutch housing left (Includes BUSHINGS, 635 060 R1) 3/8 x 1" hexagon BOLT (6) 3/8" lock WASHER (6)
21	635 010 R11	COVER, steering clutch housing right (Includes BUSHINGS, 635 060 R1) 3/8 x 1" hexagon BOLT (6) 3/8" lock WASHER (6)
22	635 060 R1	BUSHING, clutch housing cover (2)
23	635 679 R1	GASKET, clutch housing (2)
24	635 001 R12	HOUSING ASSEMBLY, steering clutch left composed of: 1 Bushing 636 682 R1 1 Bushing 635 057 R1 1 Boot 636 681 R1 * 1 Housing 2 Pin 141 287 1 Pin 108 635 1 Plug 172 548 1 Plug 636 052 R1
	635 041 R1	5/8 x 2" special hexagon BOLT 1/2 x 2" hexagon BOLT (4) 1/2 x 2-3/4" hexagon BOLT 1/2" lock WASHER (5)
	178 625	5/8" internal-tooth lock WASHER
24	635 002 R12	HOUSING ASSEMBLY, steering clutch right composed of: 1 Bushing 636 682 R1 1 Bushing 635 057 R1 1 Boot 636 681 R1 * 1 Housing 2 Pin 141 287 1 Pin 108 635 1 Plug 172 548 1 Plug 636 052 R1
	635 041 R1	5/8 x 2" special hexagon BOLT 1/2 x 2" hexagon BOLT (4) 1/2 x 2-3/4" hexagon BOLT 1/2" lock WASHER (5)
	178 625	5/8" internal-tooth lock WASHER
25	636 052 R1	PLUG, steering clutch housing drain (2) 1/8 x 1-1/8" cotter PIN (2)
26	141 287	PIN, 1/2 x 1-1/2" dowel (2)
27	635 381 R2	BASE, steering clutch (2) 5/16 x 3-1/2" hexagon BOLT (12)
	635 401 R1	21/64 x 9/16 x 22 gauge special WASHER (use as required) 5/16" hex. NUT (12) 5/16" lock WASHER (12)
28	635 375 R1	DRUM, steering clutch (2)
29	635 401 R1	WASHER, 21/64 x 9/16 x 22 gauge (2)

REF. NO.	PART NUMBER	DESCRIPTION
STEERING CLUTCH AND HOUSING - Cont		
30	635 394 R1	WIRE, clutch driving hub (2)
31	635 385 R1	DISC, steering clutch friction (14)
32	635 561 R1	SPRING, clutch pressure (6)
33	51 461 D	SPRING, clutch release lever (3)
34	353 243 R91	LEVER, clutch release (3)(Includes NUT, 114 494 and SCREW, 352 745 R1)
35	51 460 D	PIN, release lever (3) 3/32 x 1/2" cotter PIN (3)
36	352 745 R1	SCREW, clutch release lever adjusting (3) 3/8"-NF hex. jam NUT (3)
37	353 246 R91	PACKAGE, release lever service composed of: 3 Lever 353 243 R91 3 Pin 51 460 D 3 Pin 103 372 3 Spring 51 461 D
38	635 386 R1	GUIDE, steering clutch release bearing (2)
39	636 718 R91	RETAINER, bevel gear bearing (2)(Includes GUIDE, 635 386 R1) 3/8 x 1-1/8" hexagon BOLT (12) 3/8" lock WASHER (12)
40	635 395 R1	SHIM, .003" bearing retainer (as required)
40	635 396 R1	SHIM, .005" bearing retainer (as required)
40	635 397 R1	SHIM, .010" bevel gear bearing retainer (as required)
41	704 026 R92	SHAFT and GEAR, transmission (to be serviced as a unit)
	636 681 R1	BOOT, upper release shaft bushing weatherproofing (2)(tractors with serial No. 3673 and up)(not illustrated)

\* Not Serviced Separately