

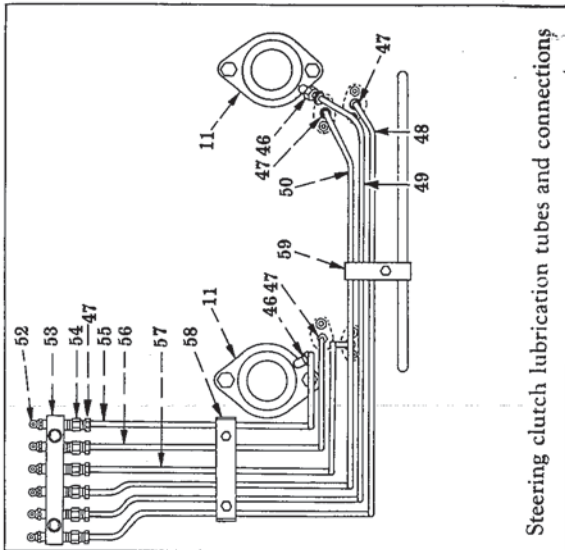

STEERING SYSTEM

STEERING CLUTCH RELEASE SHAFT AND MECHANISM



Steering clutch lubrication tubes and connections

This assembly is made up of 11 driving discs (Ref. No. 32) and 12 friction discs (Ref. No. 33)

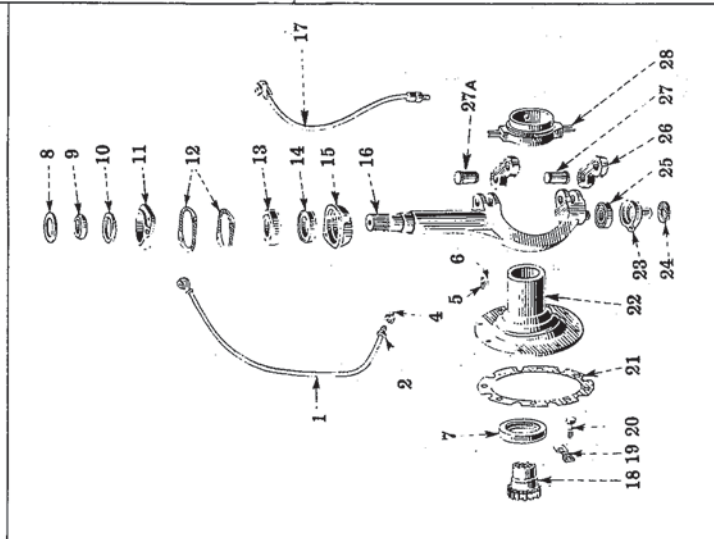

STEERING SYSTEM

STEERING CLUTCH RELEASE SHAFT AND MECHANISM - CONTINUED

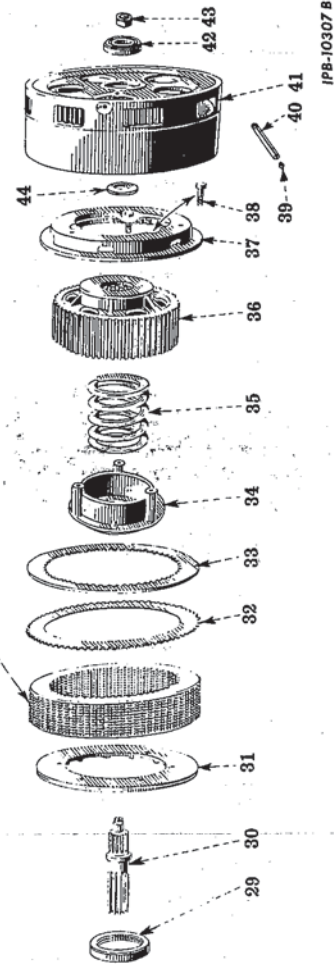

IPB-10307 B

STEERING SYSTEM

REF. NO.	I. H. PART NUMBER	DESCRIPTION
STEERING CLUTCH RELEASE SHAFT AND MECHANISM - CONTINUED		
1	272 449 R92	TUBE w/NUT, 369 989 R1 steering clutch release fork lower bearing lower grease (2)
	13 329 R1	BOLT, machine, 1/4 x 5/8" (4) 1/4" jam, NUT (4) 1/4" internal-tooth, lock WASHER (4)
2	369 989 R1	NUT, steering clutch release fork lower bearing grease tube connector (2)
4	35 252 D	CONNECTOR, steering clutch release fork lower bearing grease tube (2)
5	56 013 DX	KEY w/PIN, 56 006 D steering clutch release collar (2)
6	56 006 D	PIN, steering clutch release collar key (2)
7	313 914 R91	OIL SEAL, steering clutch shaft coupling (will work for 310 513 R91 and 310 527 R91) (2)
8	272 322 R1	RETAINER, steering clutch release fork upper bearing felt (2)
9	56 010 D	SPACER, steering clutch release lever (2)
10	56 008 D	FELT, steering clutch release fork upper bearing (2)
11	8 680 DX	RETAINER w/PLUG, 103 883 steering clutch release fork upper bearing (2) 7/16 x 1-1/2" hex-hd. cap SCREW (4) 7/16" lock WASHER (4)
12	56 009 D	GASKET, steering clutch release fork upper bearing retainer (2)
12	56 009 D	GASKET, steering clutch release fork upper bearing cage (2)
13	ST 205 A	BEARING, steering clutch release fork upper (2)
14	264 694 R91	OIL SEAL, steering clutch release fork upper bearing (optional with 42 177 D) (2)
14	42 177 D	OIL SEAL, steering clutch release fork upper bearing (optional with 264 694 R91) (2)
15	8 682 D	CAGE, steering clutch release fork upper bearing (2)
16	56 020 D	FORK, steering clutch release (2)
17	57 103 DX	TUBE, steering clutch release bearing, lower grease w/COUPLING and BRACKET (2)
	13 239 R1	BOLT, 1/4 x 5/8" machine (4) 1/4" jam, NUT (4) 1/4" internal-tooth, lock WASHER (4)
18	251 388 R21	COUPLING, steering clutch shaft, (6 T) (2)
19	251 319 R1	RETAINER, steering clutch shaft coupling (4)
20	260 618 R1	BOLT, steering clutch shaft coupling retainer (12)
21	271 881 R1	GASKET, drive bevel gear bearing cage cap (2)
22	279 963 R21	CAP w/PIN, 273 562 R1, drive bevel gear bearing cage (2) 1/2 x 1-1/8" hex-hd. cap SCREW (16) 1/2" external-tooth, lock WASHER (16)
23	56 016 D	PIVOT, steering clutch release fork lower bearing (2)



STEERING SYSTEM

REF. NO.	I. H. PART NUMBER	DESCRIPTION
STEERING CLUTCH RELEASE SHAFT AND MECHANISM - CONTINUED		
24	21 585 D	RETAINER, steering clutch release fork lower bearing pivot (2) 1/2NF x 1-1/4" hex-hd. cap SCREW (2) 1/2" lock WASHER (2)
25	ST 554	BEARING, steering clutch release lower fork (2)
26	56 005 D	LINK, steering clutch release collar shifter (4)
27	303 995 R1	PIN, steering clutch release collar lower shifter link (2)
	148 152	SPRING, retainer, 1/2" (16)
27A	279 139 R1	PIN, steering clutch release collar upper shifter link (2)
28	56 018 DA	COLLAR, LH and RH steering clutch release (2)
	105 404	NIPPLE, 1/8" close (2)
29	53 233 DA	BEARING, steering clutch thrust (2)
30	256 785 R3	SHAFT, steering clutch (2)
31	5 715 D	PLATE, steering clutch hub (2) 1/2 x 1-1/4" hex-hd. cap SCREW (12) 1/2" lock WASHER (12)
32	40 882 D	DISC, steering clutch steel (77 teeth) (TD-150 501 to 3500) (steering clutch field improvement PACKAGE, 318 823 R91, also available) (24)
32	318 820 R1	DISC, steering clutch steel (77 teeth) (TD-150 3501 up) (also part of steering clutch field improvement PACKAGE, 318 823 R91) (22)
33	40 883 DC	DISC, steering clutch friction (58 teeth) (Raybestos) (TD-150 501 to 3500) (steering clutch field improvement PACKAGE, 318 823 R91, also available) (26)
33	58 957 D	DISC, steering clutch friction (58 teeth) (bi-metallic) (TD-150 501 to 3500) (steering clutch field improvement PACKAGE, 318 823 R91 also available) (26)
33	318 821 R1	DISC, steering clutch friction (58 teeth) (sintered bronze) (TD-150 3501 up) (also part of steering clutch field improvement PACKAGE, 318 823 R91) (24)
34	6 973 DB	RETAINER, steering clutch pressure spring (2)
35	54 491 DC	SPRING, steering clutch pressure (2)
36	8 352 DC	HUB, steering clutch (2)
37	5 711 DC	PLATE, steering clutch pressure (2)
38	54 968 D	BOLT, steering clutch pressure plate dowel (6) 1/2" lock WASHER (6)
39	18 541 R91	FITTING, steering clutch pilot bearing lubrication (Alemite 1631 B) (2)
40	54 652 D	PIPE, steering clutch pilot bearing lubricator
41	8 519 DA	DRUM, steering clutch (2) 1/2NF x 1-1/8" hex-hd. cap SCREW (16) 1/2" external-tooth lock WASHER (16)
42	ST 333	BEARING, steering clutch pilot (2)
43	256 790 R1	NUT, steering clutch pilot bearing retainer (2)
44	50 096 DA	SPACER, steering clutch pilot bearing (2)

STEERING SYSTEM

REF. NO.	I. H. PART NUMBER	DESCRIPTION
STEERING CLUTCH RELEASE SHAFT AND MECHANISM - CONTINUED		
46	29 901 D	CONNECTION, steering clutch lubrication tube (in bearing retainer) (6)
47	29 898 D	NUT, coupling, steering clutch lubrication tube (in grease tube bracket) (12)
48	279 448 R2	TUBE, RH steering clutch release fork lower bearing upper grease
49	279 447 R2	TUBE, RH steering clutch release fork upper bearing grease
50	279 446 R2	TUBE, RH steering clutch release bearing upper grease
52	138 322 H	FITTING, steering clutch grease tube junction block lubrication (Alemite 1610 B) (optional with 109 461) (4)
52	109 461	FITTING, steering clutch grease tube junction block lubrication (Lincoln 5090) (optional with 138 322 H) (4)
53	275 138 R1	BLOCK, steering clutch grease tube junction 1/4 x 1-1/8" hex-hd. cap SCREW (2) 1/4" lock WASHER (2)
54	29 901 D	CONNECTION, steering clutch lubrication tube (in junction block) (6)
55	279 443 R2	TUBE, LH steering clutch release fork upper bearing grease
56	279 444 R2	TUBE, LH steering clutch release bearing upper grease
57	279 445 R2	TUBE, LH steering clutch release fork lower bearing upper grease

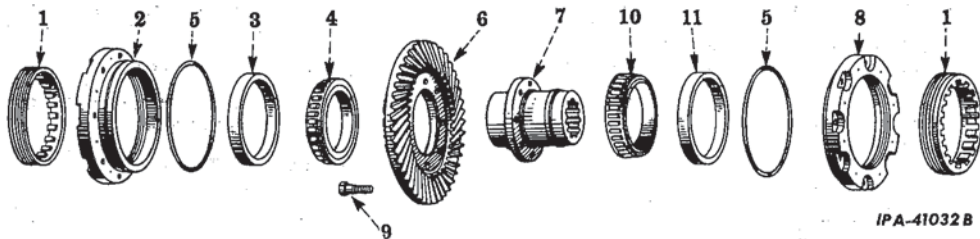
DRIVE BEVEL GEAR



REF. NO.	I. H. PART NUMBER	DESCRIPTION
1	271 812 R1	ADJUSTER, drive bevel gear bearing (2)
2	271 878 R1	CAGE, drive bevel gear bearing 9/16" NF NUT (4) 9/16 x 2 x 7/8" hex-hd. cap SCREW (4) 9/16" external-tooth, lock WASHER (8)
3	271 842 R1	CUP, drive bevel gear tapered bearing (2)
4	271 841 R91	CONE, drive bevel gear tapered bearing (2)
5	271 879 R1	RING, drive bevel gear bearing cage sealing (2)
6	320 548 R1	GEAR, drive bevel (40 T) (TD-151-4001 Up)
6	279 896 R1	GEAR, drive bevel (45 T) (TD-150-501 to 4000)
7	279 962 R1	HUB, drive bevel gear

STEERING SYSTEM

REF. NO.	I. H. PART NUMBER	DESCRIPTION
STEERING CLUTCH RELEASE SHAFT AND MECHANISM - CONTINUED		
58	279 449 R1	CLAMP, grease tube to vent tube (2) 1/4" NUT 1/4 x 3/4" rd-hd. slt. machine SCREW 1/4" lock WASHER
59	279 606 R1	BRACKET, upper grease tube
59	279 607 R1	BRACKET, lower grease tube 1/4 x 5/8" rd-hd. slt. machine SCREW (2) 1/4" lock WASHER (2)
126	121	FITTING, steering clutch release bearing lubrication (optional with 271 281) (2)
271	281	FITTING, steering clutch release bearing lubrication (optional with 126 121) (2)
318	823 R91	PACKAGE, steering clutch field service (consists of twenty-two DISC, 318 820 R1 and twenty-four DISC, 318 821 R1)
273	502 R1	PIN, bevel gear bearing adjuster lock (2)
103	883	PLUG, pipe (slt-hdls., 1/8")
172	802	PLUG, steering clutch shaft coupling (2-3/4") (2)
		WIRE, steering clutch shaft coupling retainer bolt locking, (16 ga. x 9" long) (order 278 027 R1) (6)
278	027 R1	WIRE, locking bulk (16 ga.) (customer must specify length required) (X)
X - As required		

DRIVE BEVEL GEAR - CONTINUED

REF. NO.	I. H. PART NUMBER	DESCRIPTION
8	271 878 R1	CAGE, drive bevel gear bearing 9/16" NF NUT (4) 9/16 x 2 x 7/8" hex-hd. cap SCREW (4) 9/16" external-tooth, lock WASHER (8)
9	279 964 R2	BOLT, drive bevel gear dowel (6)
10	271 841 R91	CONE, drive bevel gear tapered bearing
11	271 842 R1	CUP, drive bevel gear tapered bearing
	279 992 R1	BOLT, drive bevel gear bearing cage (16)
	32 454 D	NUT, drive bevel gear dowel bolt (6)
322	195 R91	PINION and SHAFT bevel, 320 549 R11 w/ GEAR, 320 548 R1 (match pair) (see transmission) (will work for 279 897 R1)