

DRIVE TRAIN

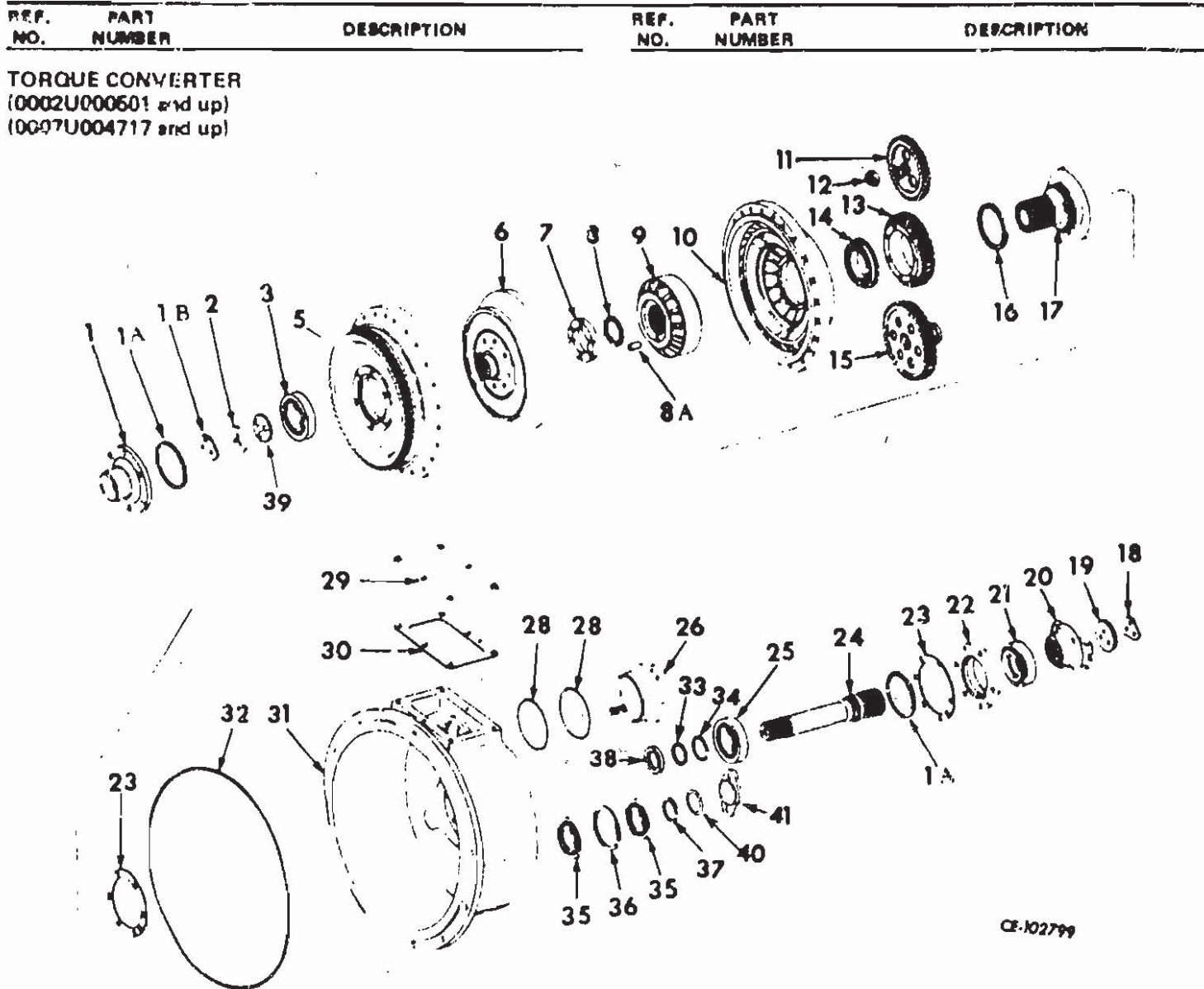

CE-102799

REF. NO.	PART NUMBER	DESCRIPTION	REF. NO.	PART NUMBER	DESCRIPTION
	658 100 C92	CONVERTER ASSY., torque	2	324 088 R1	WASHER, flange retainer
	25 545 R1	SCREW, hex-hd cap (12)	3	ST-296	BEARING, turbine hub
	870 325 R1	WASHER, lock (12)	5	627 868 C1	HOUSING, converter drive
		(Consists of:	6	627 869 C1	TURBINE
1	627 870 C3	HUB, input drive	7	324 085 R2	SPACER, converter
	179 839	SCREW, hex-hd cap (6)	8	641 207 R1	RING, snap
	103 321	WASHER, lock (6)	8A	17 132 R1	PIN, spring
1A	199 348 H2	SHIM, impeller hub or shaft bearing retainer (.005") (x)	9	327 129 R92	STATOR w/PIN, 17 132 R1 and RING, 641 207 R1
1A	199 351 H2	SHIM, impeller hub or shaft bearing retainer (.010") (x)	10	625 857 C1	IMPELLER, converter
1A	199 352 H2	SHIM, impeller hub or shaft bearing retainer (.020") (x)		24 494 R1	WASHER, flat (7)
1A	627 872 C1	SHIM, impeller hub or shaft bearing retainer (.050") (x)		27 261 R1	SCREW, 7/16" hex-hd cap (7)
1B	610 256 C1	PLATE, output flange locking		9 409 225	SCREW, 5/16" hex-hd cap (24)
	454 869	SCREW, hex-hd cap (3)			

DRIVE TRAIN

REF. NO.	PART NUMBER	DESCRIPTION	REF. NO.	PART NUMBER	DESCRIPTION
TORQUE CONVERTER – Continued (0002U000501 and up) (0007U004717 and up)					
11	603 633 C1	GEAR, input pump drive	39	210 877 H1	SHIM, flange retainer washer (.030") (x)
12	19 263 R1	NUT, elastic stop (Input pump drive gear retaining)	40	22 414 R1	"O" RING, pump drive cover (5 x 5-1/4 x 1/8") (Not used w/ Hydraulic Control Unit)
13	627 882 C1	GEAR, accessory drive	41	326 650 R11	COVER, equipment pump drive (Not used w/Hydraulic Control Unit)
14	324 109 R91	BEARING, impeller hub		604 743 C91	PACKAGE, torque converter gasket field service (Consists of the following GASKETS and RINGS -
15	343 686 R1	GEAR, accessory driven		324 069 R1	GASKET, output shaft bearing retainer (2)
16	324 062 R2	RING, ground sleeve hub seal		324 082 R2	GASKET, pump inspection cover
17	324 061 R1	HUB, ground sleeve (39T)		321 988 R1	RING, torque converter to flywheel housing sealing
18	324 071 R2 454 869	PLATE, output flange locking SCREW, hex-hd cap (3)		324 062 R2	RING, hub sealing
19	324 072 R2	WASHER, flange retainer		156 283 H1	RING, output shaft sealing (Piston hook type)
20	197 976 H1	FLANGE, output		336 970 R1	RING, input pump sealing (2)
21	333 996 R92	SEAL, output shaft bearing		343 927 R1	RING, power take-off cover sealing
22	627 867 C1 179 846 103 321	RETAINER, output shaft bearing SCREW, hex-hd cap (6) WASHER, lock (8)		338 972 R1	SHIM, impeller hub (.005") (3)
23	324 069 R1	GASKET, output shaft bearing retainer (2)		347 089 R1	SHIM, impeller hub (.010") (3)
24	627 880 C1	SHAFT, turbine output		347 090 R1	SHIM, impeller hub (.020") (3)
25	ST-295	BEARING, output shaft ball		637 467 C91	KIT, input pump seal repair (For repair of PUMP, 637 409 C91)
26	637 409 C91 179 842 103 321	PUMP, input SCREW, hex-hd cap (2) WASHER, lock (2)			
28	336 970 R1	"O" RING, input pump (4.359 x 4.637 x 139") (2)			
29	625 854 C1 179 879 103 323	COVER, pump inspection SCREW, hex-hd cap (6) WASHER, lock (6)			
30	627 396 C1	GASKET, pump inspection cover			
31	627 871 C1	HOUSING, converter			
32	321 988 R1	"O" RING, torque converter to flywheel housing (19.725 x 20.145 x .210") (Not part of "Converter Assembly")			
33	156 283 H1	RING, output shaft piston hook type seal			
34	24 985 R1	RING, output shaft external snap			
35	ST-201	BEARING, driven gear (2)			
36	197 971 H1	RING, driven gear snap			
37	631 255 R1	RING, turbine hub snap			
38	889 615 C1	SPACER			