

TC-42

CHASSIS

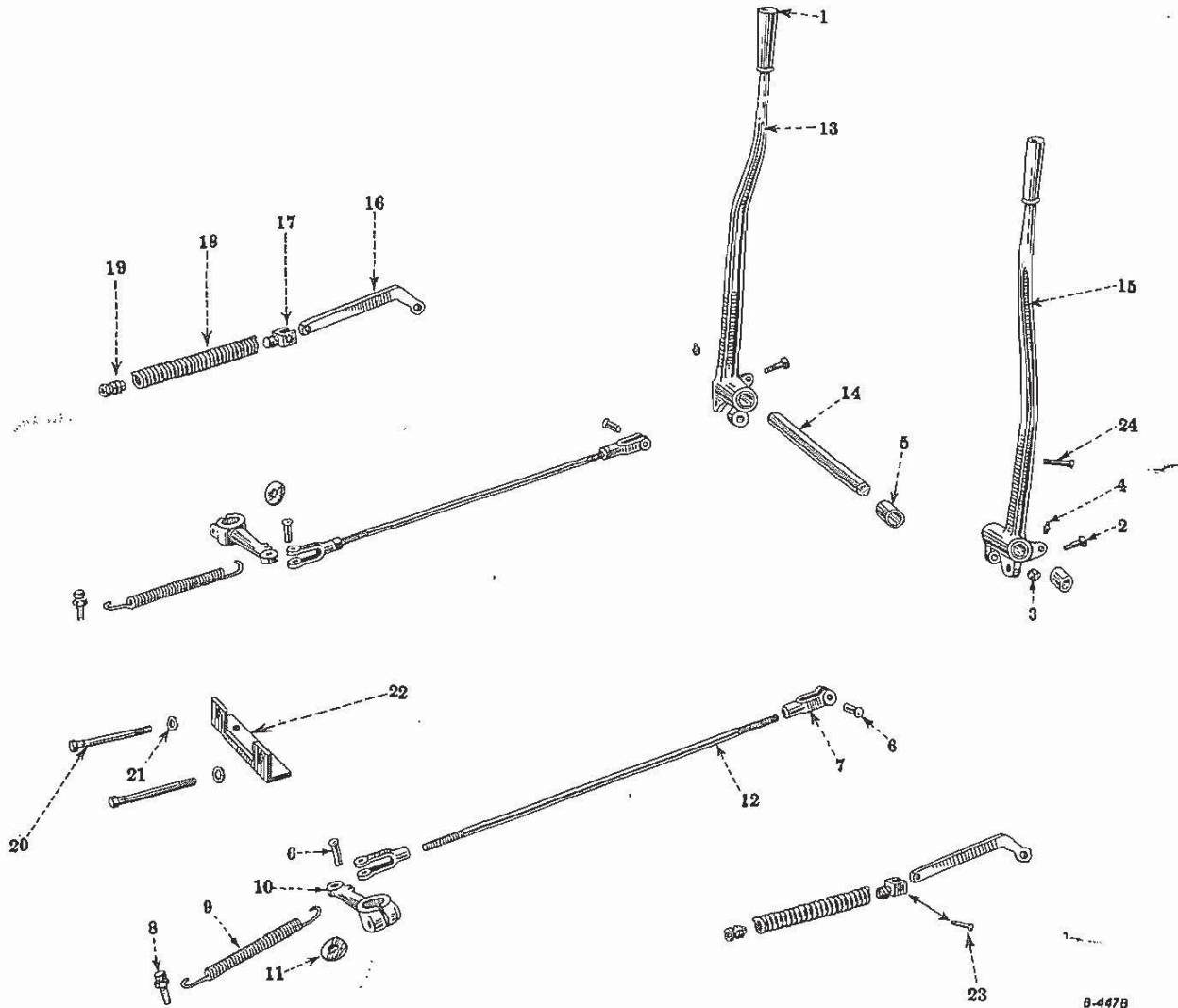

FINAL DRIVE-STEERING CLUTCH CONTROLS



B-447B

REF. NO.	PART NUMBER	DESCRIPTION	SERIAL NUMBER	NO. REQ'D
1	41 597 DA	STEERING CLUTCH HAND LEVER HANDLE		2
2	55 377 D	STEERING CLUTCH HAND LEVER ADJUSTING SCREW		2
3	220 068	HEX. NUT, 1/2" N.C.		2
4	109 354	STEERING CLUTCH HAND LEVER LUBRICATOR (ALEHITE 1613) (OPTIONAL WITH 109 462)		2
4	109 462	STEERING CLUTCH HAND LEVER LUBRICATOR (LINCOLN 5400) (OPTIONAL WITH 109 354)		2
5	42 175 D	STEERING CLUTCH HAND LEVER BUSHING		4
6	103 498	STEERING CLUTCH OPERATING ROD YOKE PIN (WILL WORK FOR 15 041 H)		4
	103 373	COTTER PIN, 3/32 x 3/4"		4
7	63 228 D	STEERING CLUTCH OPERATING ROD YOKE (LEFT HAND THREAD)		2
7	63 229 D	STEERING CLUTCH OPERATING ROD YOKE (RIGHT HAND THREAD)		2



REF. NO.	PART NUMBER	DESCRIPTION	SERIAL NUMBER	NO. REQ'D
FINAL DRIVE-STEERING CLUTCH CONTROLS-Continued				
8	41 768 D	STEERING CLUTCH RELEASE LEVER RETURN SPRING ANCHOR		1
	103 323	LOCK WASHER, 1/2"		2
9	57 288 D	STEERING CLUTCH RELEASE LEVER RETURN SPRING		2
10	8 679 DA	STEERING CLUTCH RELEASE LEVER		2
	181 381	CAP SCREW, 3/8 x 2-1/2" N.F., HEX. HEAD		2
	103 026	HEX. NUT, 3/8" N.F.		2
	103 321	LOCK WASHER, 3/8"		2
11	45 794 D	STEERING CLUTCH RELEASE LEVER RETAINER WASHER		2
	181 429	CAP SCREW, 1/2 x 1-1/4" N.F., HEX. HEAD		2
	103 323	LOCK WASHER, 1/2"		2
12	63 230 DX	STEERING CLUTCH OPERATING ROD WITH NUT		2
	220 068	HEX. NUT, 1/2" N.C.		2
	12 454 R1	HEX. NUT, 1/2" N.C. (LEFT HAND THREAD)		2
13	257 617 R22	STEERING CLUTCH HAND LEVER, LEFT HAND, COMPLETE		1
		(COMPOSED OF -		
		1 HANDLE 41 597 DA 1 LEVER \$257 617 R2		
		2 BUSHING 42 175 D 1 PIN 257 620 R1		
		3 BOLT 53 377 D 1 NUT 220 068)		
14	56 012 D	STEERING CLUTCH HAND LEVER SHAFT		1
	179 826	CAP SCREW, 5/16 x 2" N.C., HEX. HEAD		1
	103 320	LOCK WASHER, 5/16"		1
15	257 618 R22	STEERING CLUTCH HAND LEVER, RIGHT HAND, COMPLETE		1
		(COMPOSED OF -		
		1 HANDLE 41 597 DA 1 LEVER \$257 618 R2		
		2 BUSHING 42 175 D 1 PIN 257 620 R1		
	1 BOLT 55 377 D 1 NUT 220 068)			
16	257 619 R2	STEERING CLUTCH HAND LEVER BOOSTER SPRING LINK		2
17	257 622 R1	STEERING CLUTCH HAND LEVER BOOSTER SPRING YOKE		2
18	257 621 R1	STEERING CLUTCH HAND LEVER BOOSTER SPRING		2
19	257 623 R1	STEERING CLUTCH HAND LEVER BOOSTER SPRING ADJUSTING NUT		2
20	257 624 R2	STEERING CLUTCH HAND LEVER BOOSTER SPRING ADJUSTING BOLT		2
21	257 625 R1	STEERING CLUTCH HAND LEVER BOOSTER SPRING ADJUSTING BOLT WASHER		2
22	257 626 R1	STEERING CLUTCH HAND LEVER BOOSTER SPRING ANCHOR		1
23	103 498	STEERING CLUTCH HAND LEVER BOOSTER SPRING LINK PIN, REAR		2
		(WILL WORK FOR 15 041 H)		
	108 630	COTTER PIN, 1/8 x 7/8"		2
24	257 620 R1	STEERING CLUTCH HAND LEVER BOOSTER SPRING LINK PIN, FRONT		2
	147 587	WASHER, 23/32" I.D. x 1-3/8" O.D. x NO. 13 GA.		2
	103 385	COTTER PIN, 1/8 x 1"		2
	257 620 R1	STEERING CLUTCH BOOSTER LINK PIN		1
§ NOT SERVICED SEPARATELY				

C

C

C



TC-42

CHASSIS

FINAL DRIVE-STEERING CLUTCH-RELEASE SHAFT AND MECHANISM

This assembly is made up of 12 driving discs (Ref. No. 37) and 13 friction discs (Ref. No. 38)

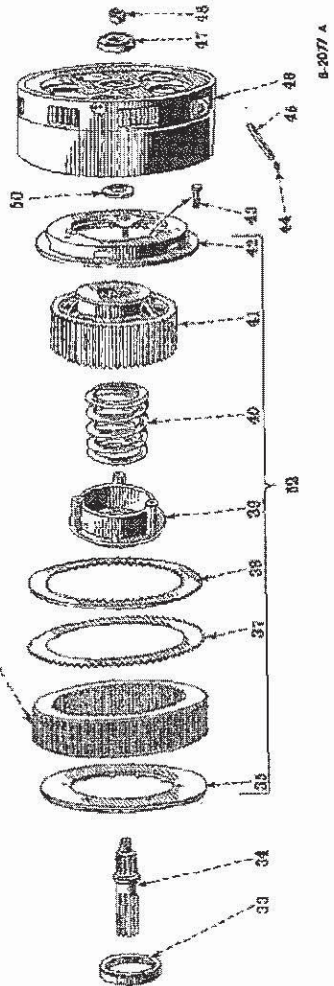

B-2077 A

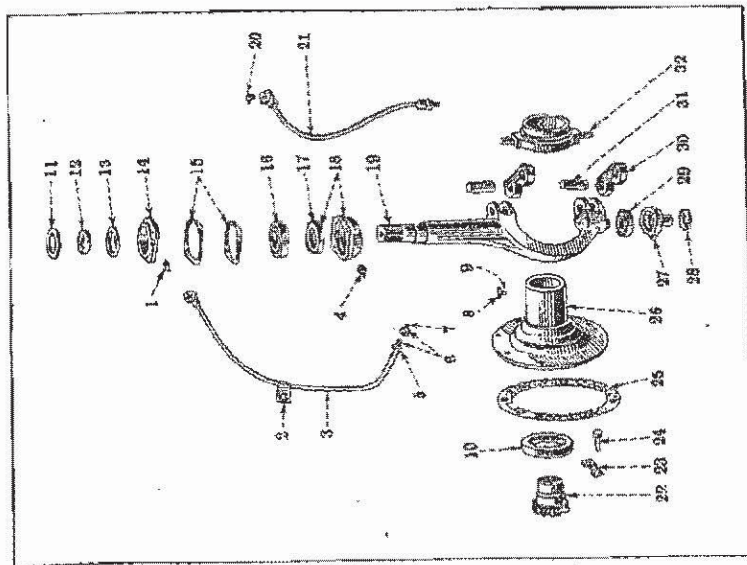



TC-42

CHASSIS

REF. NO.	PART NUMBER	DESCRIPTION.	SERIAL NUMBER	NO. REQ'D
FINAL DRIVE—STEERING CLUTCH RELEASE SHAFT AND MECHANISM				
1	109 461	STEERING CLUTCH RELEASE FORK UPPER BEARING LUBRICATOR, L.H. (LINCOLN .5000) (OPTIONAL WITH 119 512)		2
1	119 512	STEERING CLUTCH RELEASE FORK UPPER BEARING LUBRICATOR (ALEMITE .1610) (OPTIONAL WITH 109 461)		2
2	30 665 D	STEERING CLUTCH RELEASE FORK LOWER BEARING GREASE TUBE CLAMP		2
3	56 019 DX	STEERING CLUTCH RELEASE FORK LOWER BEARING GREASE TUBE WITH BRACKET		2
	13 243 RI	MACHINE BOLT, 1/4 x 3/4"		4
	220 064	HEX. NUT, 1/4" N.C.		4
	103 319	LOCK WASHER, 1/4"		4
4	109 352	STEERING CLUTCH RELEASE FORK LOWER BEARING LUBRICATOR (ALEMITE 1607) (OPTIONAL WITH 126 121)		2
4	126 121	STEERING CLUTCH RELEASE FORK LOWER BEARING LUBRICATOR (LINCOLN 5003) (OPTIONAL WITH 109 352)		2
5	29 899 D	STEERING CLUTCH RELEASE FORK LOWER BEARING GREASE TUBE CONNECTOR NUT		2
6	35 252 DX	STEERING CLUTCH RELEASE FORK LOWER BEARING GREASE TUBE CONNECTOR WITH NUT, 29 899 D		2
7	35 252 D	STEERING CLUTCH RELEASE FORK LOWER BEARING GREASE TUBE CONNECTOR		2
8	56 013 DX	STEERING CLUTCH RELEASE COLLAR KEY WITH PIN, 56 006 D		2
9	56 006 D	STEERING CLUTCH RELEASE COLLAR KEY PIN		2
10	50 104 D	STEERING CLUTCH SHAFT COUPLING OIL SEAL		2
11	56 017 D	STEERING CLUTCH RELEASE FORK UPPER BEARING FELT RETAINER		2
12	56 010 D	STEERING CLUTCH RELEASE LEVER SPACER		2
13	56 008 D	STEERING CLUTCH RELEASE FORK UPPER BEARING FELT		2
14	8 680 DX	STEERING CLUTCH RELEASE FORK UPPER BEARING RETAINER		2
	179 862	CAP SCREW, 7/16 x 1-1/2" N.C., HEX. HEAD		4
	103 322	LOCK WASHER, 7/16"		4
15	56 009 D	STEERING CLUTCH RELEASE FORK UPPER BEARING RETAINER GASKET		2
15	56 009 D	STEERING CLUTCH RELEASE FORK UPPER BEARING CAGE GASKET		2
16	ST 205 A	STEERING CLUTCH RELEASE FORK UPPER BEARING		2
17	21 969 D	STEERING CLUTCH RELEASE FORK UPPER BEARING OIL SEAL		2
18	8 682 DX	STEERING CLUTCH RELEASE FORK UPPER BEARING CAGE WITH OIL SEAL, 21 969 D		2
19	56 020 D	STEERING CLUTCH RELEASE FORK		2



TC-42

CHASSIS

REF. NO.	PART NUMBER	DESCRIPTION	SERIAL NUMBER	NO. REQ'D
FINAL DRIVE-STEERING CLUTCH RELEASE SHAFT AND MECHANISM-Continued				
20	126 121	STEERING CLUTCH RELEASE BEARING LUBRICATOR (OPTIONAL WITH 109 352)		2
20	109 352	STEERING CLUTCH RELEASE BEARING LUBRICATOR (OPTIONAL WITH 126 121)		2
21	51 431 DX	STEERING CLUTCH RELEASE BEARING GREASE TUBE WITH COUPLING AND BRACKET		2
	13 243 RI	MACHINE BOLT, 1/4 x 3/4"		4
	220 064	HEX. NUT, 1/4" N.C.		4
	103 319	LOCK WASHER, 1/4"		4
22	251 388 RII	STEERING CLUTCH SHAFT COUPLING, 6 TEETH		2
23	251 319 RI	STEERING CLUTCH SHAFT COUPLING RETAINER		6
24	50 822 D	STEERING CLUTCH SHAFT COUPLING BOLT (ORDER 260 661 R91)	TDF 26001 TO 27311	12
24	260 618 RI	STEERING CLUTCH SHAFT COUPLING RETAINER BOLT	TDF 27312 UP	12
25	49 848 D	DRIVE BEVEL GEAR BEARING CAGE CAP GASKET		2
26	8 685 DX	DRIVE BEVEL GEAR BEARING CAGE CAP WITH OIL SEAL, 50 104 D		2
	179 907	CAPSCREW, 9/16 x 1-5/8" N.C., HEX. HEAD		12
	103 029	HEX. NUT, 9/16" N.F.		4
	103 324	LOCK WASHER, 9/16"		16
27	56 016 D	STEERING CLUTCH RELEASE FORK LOWER BEARING PIVOT		2
28	21 585 D	STEERING CLUTCH RELEASE FORK LOWER BEARING PIVOT RETAINER		2
	181 429	CAP SCREW, 1/2 x 1-1/4" N.F., HEX. HEAD		2
	103 323	LOCK WASHER, 1/2"		2
29	ST 554	STEERING CLUTCH RELEASE FORK BEARING, LOWER		2
30	56 005 D	STEERING CLUTCH RELEASE COLLAR SHIFTER LINK		4
31	56 007 D	STEERING CLUTCH RELEASE COLLAR SHIFTER LINK PIN		4
	103 386	COTTER PIN, 1/8 x 1-1/4"		8
32	56 018 D	STEERING CLUTCH RELEASE COLLAR, LEFT HAND AND RIGHT HAND		2
		HEADLESS PIPE PLUG, 1/8"		2
	105 404	CLOSE NIPPLE, 1/8"		2
33	53 233 DA	STEERING CLUTCH RELEASE THRUST BEARING		2
34	256 785 RI	STEERING CLUTCH SHAFT		2



TC-42

CHASSIS

REF. NO.	PART NUMBER	DESCRIPTION	SERIAL NUMBER	NO. REQ'D
FINAL DRIVE-STEERING CLUTCH				
35	5 715 D	STEERING CLUTCH HUB PLATE		2
	179 883	CAP SCREW, 1/2 x 1-1/4" N.C., HEX. HEAD		12
	103 323	LOCK WASHER, 1/2"		12
37	40 882 D	STEERING CLUTCH DRIVING DISC, 77 EXTERNAL TEETH (28 USED WITH 61 904 D)		24
38	40 883 DC	STEERING CLUTCH FRICTION DISC, 58 INTERNAL TEETH (STANDARD)		26
38	58 957 D	STEERING CLUTCH (BI-METALLIC) FRICTION DISC, 58 TEETH (SPECIAL) (USED WITH 61 904 D)		30
39	6 973 D	STEERING CLUTCH PRESSURE SPRING RETAINER		2
40	54 491 DB	STEERING CLUTCH PRESSURE SPRING		2
41	8.352 DB	STEERING CLUTCH HUB		2
42	6 974 DB	STEERING CLUTCH PRESSURE PLATE		2
43	54 968 D	STEERING CLUTCH PRESSURE PLATE DOWEL BOLT		6
	103 323	LOCK WASHER, 1/2"		6
44	109 368	STEERING CLUTCH PILOT BEARING LUBRICATOR (ALENITE 1631) (OPTIONAL WITH Q 3 618)		2
44	Q 3.618	STEERING CLUTCH PILOT BEARING LUBRICATOR (LINCOLN 5060) (OPTIONAL WITH 109 368)		2
45	54 652 D	STEERING CLUTCH PILOT BEARING LUBRICATOR PIPE		2
46	8 519 D	STEERING CLUTCH DRUM		2
	181 428	CAP SCREW, 1/2 x 1-1/8" N.F., HEX. HEAD		16
	103 323	LOCK WASHER, 1/2"		16
47	ST 333	STEERING CLUTCH PILOT BEARING		2
48	256 790 R1	STEERING CLUTCH PILOT BEARING RETAINER NUT		2
50	50 096 DA	STEERING CLUTCH PILOT BEARING SPACER		2
52	52 343 DB	STEERING CLUTCH, COMPLETE (STANDARD) (COMPOSED OF -		2
		1 PLATE 5 715 D		
		1 RETAINER 6 973 D		
		1 PLATE 6 974 DB		
		1 HUB 8 352 DB		
		12 DISC 40 882 D		
		13 DISC 40 883 DC		
		1 SPRING 54 491 DB		
		9 WASHER 103 323		
		3 SCREW 181 428		
		6 SCREW 181 429		



CHASSIS

FINAL DRIVE-STEERING BRAKES AND CONTROL
(TDF 26001 to 37654)

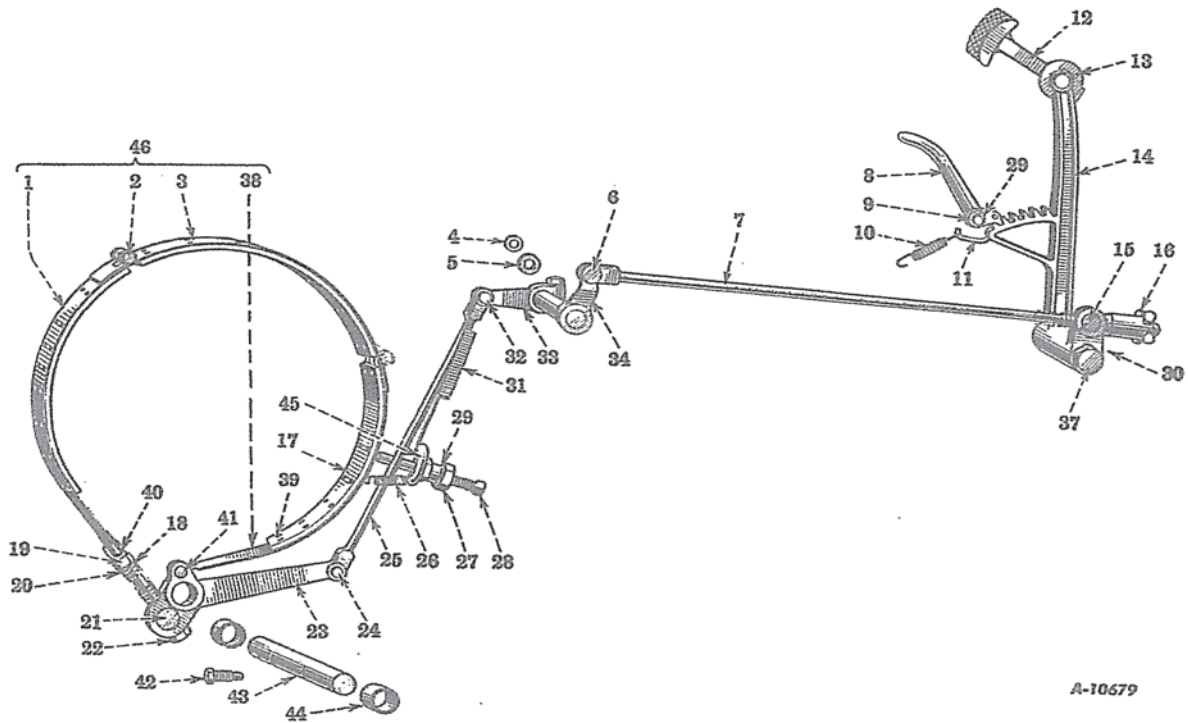

A-10679

REF. NO.	PART NUMBER	DESCRIPTION	SERIAL NUMBER	NO. REQ'D
1	60 265 DXA	STEERING BRAKE BAND, REAR, COMPLETE		2
		(COMPOSED OF -		
		1 LINING 49 961 DA		
		1 BAND §68 534 D		
		13 RIVET 21 407 H		
		3 RIVET 61 175 V)		
2	60 266 D	STEERING BRAKE BAND JOINT PIN		4
	103 386	COTTER PIN, 1/8 x 1-1/4"		4
3	60 264 DXA	STEERING BRAKE BAND, CENTER, COMPLETE		2
		(COMPOSED OF -		
		1 LINING 49 961 DA		
		1 BAND §60 264 D		
		14 RIVET 21 407 H		
		2 RIVET 61 175 V)		
4	20 841 D	STEERING BRAKE LEVER KEY, INNER		2
5	41 519 D	STEERING BRAKE LEVER DIRT SEAL, OUTER		2
6	15 041 H	STEERING BRAKE OUTER ROD END PIN		2
	103 384	COTTER PIN, 1/8 x 3/4"		2
7	41 512 DA	STEERING BRAKE OUTER ROD.		2
8	5 818 D	STEERING BRAKE RATCHET PAWL		2
9	41 523 D	STEERING BRAKE RATCHET PAWL STUD		2
	103 323	LOCK WASHER, 1/2"		2
	108 630	COTTER PIN, 1/8 x 7/8"		2
		§ NOT SERVICED SEPARATELY.		



TC-42

CHASSIS

REF. NO.	PART NUMBER	DESCRIPTION	SERIAL NUMBER	NO. REQ'D
FINAL DRIVE—STEERING BRAKES AND CONTROL—Continued (TDF 26001 to 37654)				
10	41 935 D	STEERING BRAKE RATCHET PAWL SPRING		2
	179 816	CAP SCREW, 5/16 x 3/4" N.C., HEX. HEAD		2
	218 437	HEX. JAN, NUT, 5/16" N.C.		2
11	41 521 D	STEERING BRAKE RATCHET PAWL LINK, L.H.		1
11	41 522 D	STEERING BRAKE RATCHET PAWL LINK, R.H.		1
	103 361	COTTER PIN, 1/16 x 1/2"		2
12	5 815 D	STEERING BRAKE PEDAL PAD AND ROD		2
13	41 524 D	STEERING BRAKE PEDAL PAD AND ROD SWIVEL		2
	103 031	HEX. NUT, 3/4" N.F.		2
	103 326	LOCK WASHER, 3/4"		2
14	6 915 DA	STEERING BRAKE PEDAL, L.H.		1
14	6 916 DA	STEERING BRAKE PEDAL, R.H.		1
15	41 508 D	STEERING BRAKE OUTER ROD PIVOT PIN		2
16	5 812 D	STEERING BRAKE OUTER ROD ADJUSTING KNOB		2
17	49 961 DA	STEERING BRAKE BAND LINING (ORDER 68 631 D)		6
17	68 631 D	STEERING BRAKE BAND LINING WITH RIVETS (WOVEN) (CONSISTS OF SET OF TWO LININGS, 259 871 R91 AND ONE LINING, 259 872 R91) (WILL WORK FOR 49 961 DA) (OPTIONAL WITH 68 643 D)		1
17	259 871 R91	STEERING BRAKE BAND WOVEN LINING PACKAGE (FRONT OR REAR) WITH THIRTEEN RIVETS, 21 407 H AND THREE RIVETS, 61 175 V		2
17	259 872 R91	STEERING BRAKE BAND WOVEN LINING PACKAGE (CENTER) WITH FOURTEEN RIVETS, 21 407 H AND TWO RIVETS, 61 175 V		1
17	68 643 D	STEERING BRAKE BAND MOULDED LINING SERVICE PACKAGE (CONSISTS OF SET OF TWO LININGS, 262 665 R91 AND ONE LINING, 262 666 R91) (OPTIONAL WITH 68 631 D)		1
17	262 665 R91	STEERING BRAKE BAND MOULDED LINING SERVICE PACKAGE (FRONT OR REAR) WITH 10 RIVETS, 21 407 H AND 2 RIVETS, 61 175 V		2
17	262 666 R91	STEERING BRAKE BAND MOULDED LINING SERVICE PACKAGE (CENTER) WITH 14 RIVETS, 21 407 H		1
18	41 496 D	STEERING BRAKE BAND RELEASE SPRING WASHER		2
19	103 030	FOLLOWS REFERENCE NO. 22		2
20	41 497 D	STEERING BRAKE BAND RELEASE SPRING		2
21	41 501 D	STEERING BRAKE BAND ADJUSTING PIN		2
22	41 499 D	STEERING BRAKE BAND ADJUSTING BOLT		2
	103 030	HEX. NUT, 5/8" N.F.		2
23	6 912 DAX	STEERING BRAKE PIVOT LEVER WITH 2 BUSHINGS, 41 493 D		2
24	103 498	STEERING BRAKE INNER ROD END PIN, LOWER		2
	103 384	COTTER PIN, 1/8 x 3/4"		2
25	49 966 D	STEERING BRAKE ROD, INNER		2
26	56 475 D	STEERING BRAKE BAND ANCHOR SPRING		4
26	56 476 DA	STEERING BRAKE BAND ANCHOR SPRING HOOK		2
26	56 478 DA	STEERING BRAKE BAND ANCHOR SPRING, 56 475 D AND 2 HOOKS, 56 476 D		2
27	220 080	FOLLOWS REFERENCE NO. 28		



TC-42

CHASSIS

REF. NO.	PART NUMBER	DESCRIPTION	SERIAL NUMBER	NO. REQ'D
FINAL DRIVE-STEERING BRAKES AND CONTROL-Continued (TDF 26001 to 37654)				
28	41 495 D	STEERING BRAKE BAND SET SCREW		2
	220 080	HEX. NUT, 5/8" N.C.		2
29	41 509 D	STEERING BRAKE RATCHET PAWL STUD WASHER		2
29	103 323	FOLLOWS REFERENCE NO. 9		
29	121 326	FOLLOWS REFERENCE NO. 45		
30	109 350	STEERING BRAKE PEDAL SHAFT LUBRICATOR (ALEHITE 1612) (OPTIONAL WITH 109 460)		2
30	109 460	STEERING BRAKE PEDAL SHAFT LUBRICATOR (LINCOLN 5300) (OPTIONAL WITH 109 350)		2
31	49 970 DA	STEERING BRAKE RELEASE SPRING		2
32	41 999 D	STEERING BRAKE ROD INNER PIN, UPPER		2
	103 384	COTTER PIN, 1/8 x 3/4"		2
33	5 813 DB	STEERING BRAKE LEVER, INNER		2
	179 886	CAP SCREW, 1/2 x 1-5/8" N.C., HEX. HEAD		2
	103 323	LOCK WASHER, 1/2"		2
34	49 964 D	STEERING BRAKE LEVER, OUTER, L.H. WITH SHAFT (ORDER 266 474 R91)	TDF 26001 TO 36589	1
34	49 965 D	STEERING BRAKE LEVER, OUTER, R.H. WITH SHAFT (ORDER 266 474 R91)	TDF 26001 TO 36589	1
34	49 964 DA	STEERING BRAKE LEVER, OUTER, L.H. WITH SHAFT	TDF 36590 UP	1
34	49 965 DA	STEERING BRAKE LEVER, OUTER, R.H. WITH SHAFT	TDF 36590 UP	1
37	49 978 D	STEERING BRAKE PEDAL SHAFT		2
38	60 263 DXA	STEERING BRAKE BAND, FRONT, COMPLETE		
		(COMPOSED OF -		
		1 LINING 49 961 DA		
		13 RIVET 21 407 H		
		1 BAND 68 533 D		
		3 RIVET 61 175 V		
39	21 407 H	STEERING BRAKE BAND LINING RIVET, .186 x 7/16" (SHORT) (PLAIN-BRASS TUBULAR)		80
39	61 175 V	STEERING BRAKE BAND LINING RIVET, .186 x 5/8" (LONG) (PLAIN-BRASS TUBULAR)		16
40	41 498 D	STEERING BRAKE BAND ADJUSTING BOLT SPACER		2
41	49 963 D	STEERING BRAKE BAND PIVOT JOINT PIN		2
	103 409	COTTER PIN, 3/16 x 1-1/2"		2
42	41 491 D	STEERING BRAKE PIVOT SHAFT STUD		2
	103 323	LOCK WASHER, 1/2"		2
43	49 962 D	STEERING BRAKE PIVOT SHAFT (USED WITH MAIN FRAME 6 900 DHX ONLY)		
43	269 589 RI	STEERING BRAKE PIVOT SHAFT WITH SPACER, 269 581 RI (USED WITH SERVICE PACKAGE 269 590 R91)		2
	139 879	SET SCREW, 1/2-13 x 1"-1/4 N.C.		4
44	41 493 D	STEERING BRAKE PIVOT LEVER BUSHING		2
45	43 664 DB	STEERING BRAKE ANCHOR SPRING ANCHOR		2
	218 445	HEX. JAM NUT, 1" N.C.		2
	121 326	LOCK WASHER, 1"		2
46	60 267 DA	STEERING BRAKE BAND, COMPLETE		
		(COMPOSED OF -		
		1 BAND 60 263 DXA		
		1 BAND 60 264 DXA		
		1 BAND 60 265 DXA		
		1 PIN 60 266 D		
		1 PIN 103 386		
§ NOT SERVICED SEPARATELY				



TC-42

CHASSIS

PART NUMBER	DESCRIPTION	SERIAL NUMBER	NO. REQ'D
FINAL DRIVE-STEERING BRAKES AND CONTROL - Continued (TDF 26001 to 37654)			
109 461	STEERING BRAKE OUTER LEVER LUBRICATOR FITTING (LINCOLN) (OPTIONAL WITH 119 512)	TDF 36590 UP	2
119 512	STEERING BRAKE OUTER LEVER SHAFT LUBRICATOR FITTING (ALEMITE) (OPTIONAL WITH 109 461)	TDF 36590 UP	2
266 474 R91	STEERING BRAKE LEVER, OUTER (L.H.) SERVICE PACKAGE (WILL WORK FOR 49 964 D) (CONSISTS OF - 1 FITTING 109 461 1 PLUG 41 600 D 1 LEVER 49 964 DA)	TDF 26001 TO 36589	1
266 475 R91	STEERING BRAKE LEVER, OUTER (R.H.) SERVICE PACKAGE (WILL WORK FOR 49 965 D) (CONSISTS OF - 1 FITTING 109 461 1 PLUG 41 600 D 1 LEVER 49 965 DA)	TDF 26001 TO 36589	1
269 581 R1	STEERING BRAKE PIVOT SHAFT SPACER (USED WITH SERVICE PACKAGE, 269 590 R91)		4
269 335 R91	STEERING BRAKE FIELD IMPROVEMENT PACKAGE (FOR BOTH SIDES OF TRACTOR) (COMPOSED OF - 1/4 STEERING BRAKE BAND HINGE PIN 269 173 R1 1/4 STEERING BRAKE BAND HINGE PIN RETAINING RING 269 174 R1 1/4 STEERING BRAKE BAND SPREADER 269 175 R1 2 STEERING BRAKE BAND, FRONT WITH (3) LININGS AND (18) RIVETS, 269 164 R1 269 215 R91 2 STEERING BRAKE BAND, CENTER WITH (3) LININGS AND (18) RIVETS, 269 164 R1 269 218 R91 2 STEERING BRAKE BAND, REAR WITH (3) LININGS AND (18) RIVETS, 269 164 R91 269 224 R91 2 STEERING BRAKE BAND, COMPLETE 269 225 R91 (CONSISTS OF - 2 BAND 269 215 R91 2 BAND 269 218 R91 2 BAND 269 224 R91 1/4 PIN 269 173 R1 1/4 RETAINING RING 269 174 R1 1/4 SPREADER 269 175 R1 1/4 STEERING BRAKE BAND ANCHOR SPRING 269 177 R1 8 STEERING BRAKE BAND ANCHOR SPRING HOOK 269 178 R1 2 STEERING BRAKE BAND ADJUSTING CLEVIS 269 179 R1 2 SET SCREW, 3/8-16 x 2-1/4" Sq. Hd. 114 489 2 HEX. JAM NUT, 3/8-16" 114 503 2 STEERING BRAKE BAND ADJUSTING CLEVIS PIN 269 180 R1 2 STEERING BRAKE BAND ADJUSTING CLEVIS PIN RETAINING RING 269 181 R1		1

§ - NOT SERVICED SEPARATELY



TC-42

CHASSIS

PART NUMBER	DESCRIPTION	SERIAL NUMBER	NO. REQ'D
FINAL DRIVE-STEERING BRAKES AND CONTROL -Continued (TDF 26001 to 37654)			
269 335 R91	STEERING BRAKE FIELD IMPROVEMENT PACKAGE (FOR BOTH SIDES OF TRACTOR) - CONTINUED		1
	(COMPOSED OF - CONTINUED		
2	STEERING BRAKE BAND RELEASE SPRING	269 182 R1	
2	STEERING BRAKE BAND ADJUSTING NUT	269 183 R1	
2	STEERING BRAKE PIVOT JOINT PIN, LOWER	269 184 R1	
2	STEERING BRAKE PIVOT JOINT PIN, UPPER	269 185 R1	
2	STEERING BRAKE PIVOT JOINT UPPER PIN RETAINING RING	269 181 R1	
2	STEERING BRAKE PIVOT LEVER	269 186 R1	
1	STEERING BRAKE ANCHOR BRACKET, L.H.	269 227 R1	
4	HEX. HEAD BOLT, 1/2-13 x 1-1/2"	179 885	
4	LOCK WASHER, 1/2"	115 551	
1	STEERING BRAKE ANCHOR BRACKET, R.H.	269 228 R1	
4	HEX. HEAD BOLT, 1/2-13 x 1-1/2"	179 885	
4	LOCK WASHER, 1/2"	115 551	
2	STEERING BRAKE ROD, INNER	269 229 R11	
2	STEERING BRAKE ROD, INNER END PIN, LOWER	269 190 R1	
2	STEERING BRAKE ROD, INNER END PIN, UPPER	269 191 R1	
4	STEERING BRAKE ROD, INNER END PIN, RETAINING RING	269 192 R1	
2	STEERING BRAKE RELEASE SPRING	49 970 DA	
2	STEERING BRAKE ROD, OUTER	269 193 R11	
2	3/4" ADJUSTABLE ROD END CLEVIS	144 247	
2	HEX. JAM NUT, 3/4-16	219 753	
2	STEERING BRAKE ROD OUTER END PIN	269 194 R1	
2	STEERING BRAKE ROD OUTER END PIN RETAINING RING	269 192 R1	
2	STEERING BRAKE ROD OUTER ADJUSTABLE CLEVIS END PIN	269 195 R1	
2	STEERING BRAKE ROD OUTER ADJUSTABLE CLEVIS END PIN RETAINING RING	269 181 R1	
1	STEERING BRAKE PEDAL, L.H.	269 230 R1	
1	STEERING BRAKE PEDAL, R.H.	269 231 R1	
2	STEERING BRAKE PEDAL SHAFT LUBRICATOR FITTING	109 460	OR
2	STEERING BRAKE PEDAL SHAFT LUBRICATOR FITTING	109 350	
2	STEERING BRAKE PEDAL SHAFT	269 232 R1	
1	STEERING BRAKE PEDAL SHAFT SUPPORT, L.H.	269 199 R91	
2	HEX. HEAD BOLT, 3/8-16 x 1"	179 839	
2	LOCK WASHER, 3/8"	103 321	
1	STEERING BRAKE PEDAL SHAFT SUPPORT, R.H.	269 200 R91	
2	HEX. HEAD BOLT, 3/8-16 x 1"	179 839	
2	LOCK WASHER, 3/8"	103 321	
4	STEERING BRAKE PEDAL SHAFT SUPPORT SHIM-LIGHT	269 203 R1	
2	STEERING BRAKE PEDAL SHAFT SUPPORT SHIM-HEAVY	269 204 R1	
4	STEERING BRAKE ANCHOR BRACKET DOWEL	269 206 R1	
1	STEERING BRAKE INSPECTION COVER, L.H.	269 235 R1	
1	PIPE PLUG, 3/8"	143 952	
7	HEX. HEAD BOLT, 1/2-13 x 1-1/2"	179 885	
7	LOCK WASHER, 1/2"	103 323	
1	STEERING BRAKE INSPECTION COVER, R.H.	269 236 R1	
1	PIPE PLUG, 3/8"	143 952	
7	HEX. HEAD BOLT, 1/2-13 x 1-1/2"	179 885	
7	LOCK WASHER, 1/2"	103 323	



TC-42

CHASSIS

FINAL DRIVE-STEERING BRAKES AND CONTROL (TDF 37655 up)

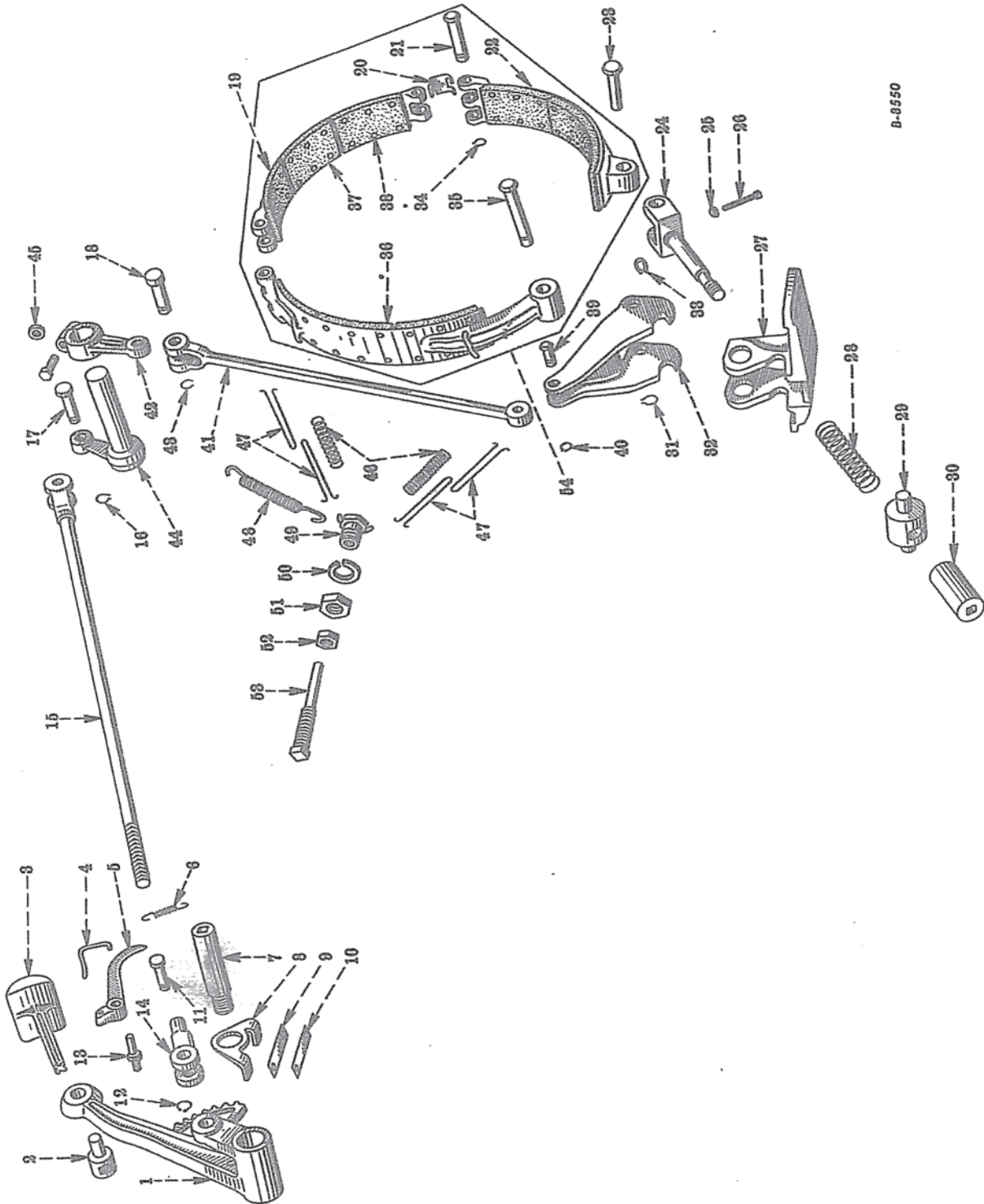

D-8550



TC-42

CHASSIS

REF. NO.	PART NUMBER	DESCRIPTION	SERIAL NUMBER	NO. REQ'D
FINAL DRIVE-STEERING BRAKES AND CONTROL (TDF 37655 up)				
1	269 230 RI	STEERING BRAKE PEDAL, L.H.		1
1	269 231 RI	STEERING BRAKE PEDAL, R.H.		1
2	41 524 D	STEERING BRAKE PEDAL PAD AND ROD SWIVEL		2
	103 031	HEX. NUT, 3/4 N.F.		2
	103 326	LOCK WASHER, 3/4"		2
3	5 815 D	STEERING BRAKE PEDAL PAD AND ROD		2
4	41 521 D	STEERING BRAKE RATCHET PAWL LINK, L.H.		1
	103 361	COTTER PIN, 1/16 x 1/2"		2
4	41 522 D	STEERING BRAKE RATCHET PAWL LINK, R.H.		1
	103 361	COTTER PIN, 1/16 x 1/2"		2
5	5 818 D	STEERING BRAKE RATCHET PAWL		2
6	41 935 D	STEERING BRAKE RATCHET PAWL SPRING		2
	179 816	CAP SCREW, 5/16 x 3/4" N.C., HEX. HEAD		2
	218 437	HEX. JAM, NUT, 5/16" N.C.		2
7	269 232 RI	STEERING BRAKE PEDAL SHAFT		2
8	269 233 RI	STEERING BRAKE PEDAL SHAFT SUPPORT		2
	179 839	CAP SCREW, 3/8-16 N.C., HEX. HEAD		4
	103 321	LOCK WASHER, 3/8"		4
9	269 203 RI	STEERING BRAKE PEDAL SHAFT SUPPORT SHIM (LIGHT)		4
10	269 204 RI	STEERING BRAKE PEDAL SHAFT SUPPORT SHIM (HEAVY)		2
11	269 195 RI	STEERING BRAKE ROD OUTER ADJUSTABLE CLEVIS END PIN		2
12	269 181 RI	STEERING BRAKE ROD OUTER ADJUSTABLE CLEVIS END PIN RETAINING RING		2
13	41 523 D	STEERING BRAKE RATCHET PAWL STUD		2
	103 323	LOCK WASHER, 1/2"		2
	108 630	COTTER PIN, 1/8 x 7/8"		2
14	144 247	FOLLOWS REFERENCE NO. 15		
15	269 193 R11	STEERING BRAKE ROD, OUTER		2
	144 247	ADJUSTABLE ROD END CLEVIS, 3/4"		2
	219 753	HEX. JAM, NUT, 3/4-16 N.F.		2
16	269 192 RI	STEERING BRAKE ROD INNER PIN RETAINING RING		4
17	269 194 RI	STEERING BRAKE ROD OUTER END PIN		2
18	269 191 RI	STEERING BRAKE ROD, INNER, END PIN, UPPER		2



CHASSIS

REF. NO.	PART NUMBER	DESCRIPTION	SERIAL NUMBER	NO. REQ'D
FINAL DRIVE-STEERING BRAKES AND CONTROL—Continued (TDF 37655 up)				
19	269 218 R9I	STEERING BRAKE BAND, CENTER WITH 18 RIVETS, 269 164 RI		1
20	269 175 R2	STEERING BRAKE BAND SPREADER		2
21	269 173 RI	STEERING BRAKE BAND HINGE PIN		2
22	269 224 R9I	STEERING BRAKE BAND, REAR WITH 18 RIVETS, 269 164 RI		1
23	269 180 RI	STEERING BRAKE BAND ADJUSTING CLEVIS PIN		2
24	269 179 RI	STEERING BRAKE BAND ADJUSTING CLEVIS		2
25	114 503	HEX. JAM, NUT, 3/8-16 N.C.		2
26	114 489	SET SCREW, 3/8-16 x 2-1/4", SQUARE HEAD		2
27	269 227 RI	STEERING BRAKE ANCHOR BRACKET, L.H.		1
	179 883	CAP SCREW, 1/2-13 x 1-1/4" HEX. HEAD		4
	115 551	LOCK WASHER, 1/2", INTERNAL-TOOTH		4
27	269 228 RI	STEERING BRAKE ANCHOR BRACKET, R.H.		1
	179 883	CAP SCREW, 1/2-13 x 1-1/4", HEX. HEAD		4
	115 551	LOCK WASHER, 1/2", INTERNAL-TOOTH		4
28	269 182 RI	STEERING BRAKE BAND RELEASE SPRING		2
29	269 184 RI	STEERING BRAKE PIVOT JOINT PIN, LOWER		2
30	269 183 RI	STEERING BRAKE BAND ADJUSTING NUT		2
31	269 181 RI	STEERING BRAKE PIVOT JOINT PIN UPPER RETAINING RING		2
32	269 186 RI	STEERING BRAKE PIVOT LEVER		2
33	269 181 RI	STEERING BRAKE BAND ADJUSTING CLEVIS PIN RETAINING RING		2
34	269 174 RI	STEERING BRAKE BAND HINGE PIN RETAINING NUT		2
35	269 185 RI	STEERING BRAKE PIVOT JOINT PIN, UPPER		2
36	269 215 R9I	STEERING BRAKE BAND, FRONT WITH 18 RIVETS, 269 164 RI		1
37	269 226 R9I	STEERING BRAKE BAND LINING (SET OF 9 PIECES WITH 54 RIVETS 269 164 RI) (WILL WORK FOR 269 216 RI)		2
38	269 164 RI	STEERING BRAKE BAND LINING RIVET		54
39	269 190 RI	STEERING BRAKE ROD, INNER, END PIN, LOWER		2
40	269 192 RI	STEERING BRAKE ROD OUTER END PIN RETAINING RING		2
41	269 229 RI	STEERING BRAKE ROD, INNER		2
42	5 813 DB	STEERING BRAKE, LEVER, INNER		2
	179 886	CAP SCREW, 1-1/2 x 1-5/8" N.C., HEX. HEAD		2
	103 323	LOCK WASHER, 1/2", MEDIUM		2
43	269 192 RI	STEERING BRAKE ROD OUTER END PIN RETAINING RING		2



TC-42

CHASSIS

REF. NO.	PART NUMBER	DESCRIPTION	SERIAL NUMBER	NO. REQ'D
FINAL DRIVE-STEERING BRAKES AND CONTROL—Continued (TDF 37655 up)				
44	49 964 DA	STEERING BRAKE LEVER, OUTER, L.H.		1
	Q 1 565	WASHER, 1-1/32" I.D. x 1-3/4" O.D. x No. 9 GA.		1
45	20 841 D	STEERING BRAKE LEVER, INNER, KEY		2
46	269 177 RI	STEERING BRAKE BAND ANCHOR SPRING		4
47	269 178 RI	STEERING BRAKE BAND ANCHOR SPRING HOOK		8
48	49 970 DA	STEERING BRAKE RELEASE SPRING		2
49	43 664 DC	STEERING BRAKE RETURN SPRING ANCHOR		2
50	121 326	LOCK WASHER, 1"		2
51	218 445	HEX. JAM, NUT, 1" N.C.		2
52	220 080	FOLLOWS REFERENCE No. 53		
53	53 505 D	STEERING BRAKE BAND SET SCREW		2
	220 080	HEX. NUT, 5/8" N.C.		2
54	269 225 R91	STEERING BRAKE BAND, COMPLETE		2
		(COMPOSED OF -		
		2 PIN 269 173 RI		
		2 RING 269 174 RI		
		2 SPREADER 269 175 RI		
		1 BAND 269 215 R91		
		1 BAND 269 218 R91		
		1 BAND 269 224 R91)		