

INTRODUCTION

This catalog contains a list of service parts for the following crawler tractors and loaders:

CRAWLER TRACTORS AND LOADERS

T-6 (62 Series)	Manual Shift
TD-6 (62 Series)	
TD-6 (62 Series)	Agricultural * Sideboom** Sideboom**
T-6 (62 Series)	
TD-6 (62 Series)	

LOADERS

T-6 (62 Series)	Loader***
TD-6 (62 Series)	Loader***

- * The agricultural tractor is a manual shift tractor and the parts will be identified as for an Agr. Crawler Tractor.
- ** The sideboom tractor is a manual shift tractor and the parts will be identified as for a sideboom crawler tractor.
- *** The loader is a manual shift tractor and the parts will be identified as for a loader.

The T-6 (62 Series) Crawler tractor, T-6 (62 Series) Sideboom and the T-6 (62 Series) Loader have a six-cylinder 3-9/16 x 4.390 carbureted engine.

The TD-6 (62 Series) Crawl Tractor, TD-6 (62 Series) Agricultural tractor, TD-6 (62 Series) Sideboom tractor and TD-6 (62 Series) Loader have a six-cylinder 3-11/16 x 4.390 diesel engine.

Following is brief summary of the system used in compiling this catalog. It is to your advantage to carefully study this summary.

This catalog is printed in a double column page format, and is divided into four sections-- Introductory Pages, Indexes to Units, Illustrations and Parts Lists, and Numerical Index.

(1) INDEXES. Two types of indexes are used. The index to units alphabetically lists all of the units by page number. The numerical index at the back of the catalog lists part numbers (excluding standard fasteners) giving the page number where the part is listed.

NOTE - Refer frequently the Index to Units to save time in finding the proper unit.

(2) ILLUSTRATIONS. Parts in this catalog are illustrated by the "exploded view" method. Individual parts in each illustration are shown

where they belong in relation to one another. Reference numbers only are shown in each illustration. These numbers correspond with numbers in the Reference Number column in the accompanying list of parts. Parts in illustrations without reference numbers are the same as duplicate parts with reference numbers.

CAUTION: Reference numbers should not be used when ordering parts. Always use IH part numbers or description when ordering.

(3) METHOD OF LISTING. The parts list of each classification is divided into units. Parts are listed in order according to reference number shown in the illustration, followed by a full description based upon the "noun first" method -- i. e., the noun name of the part is listed first then the modifying descriptive information which serves to specifically identify the item. For example: SHAFT w/two PLUGS ASSEMBLY, valve lever. Parts not shown in illustrations appear at end of list in alphabetical sequence by noun name. Parts listed will work on all units covered in this catalog unless a serial number or other qualifying designation is given for purpose of identification.

Throughout this catalog the term "Front" indicates the radiator end. Whenever the terms "Right" or "Left" are used it should be understood to mean from a rear position looking toward the radiator end.

MANUFACTURERS PART NUMBERS ARE LISTED IN BRACKETS FOLLOWING THE DESCRIPTION OF THE PART.

(4) NUMBER REQUIRED. In this new double-column catalog format the single "No. Req'd." column is eliminated and the quantity used of each item is shown in parenthesis (4) following the description of the item. Where no quantity is indicated it should be understood to mean that only one (1) is required.

In many parts lists it is possible to include more than one assembly or attachment. The assemblies or attachments are listed at the beginning of the parts lists with the letters A, B, C, etc., preceding the part number of the assembly or attachment. The number required information is shown in parenthesis following the description of the parts. When letters (A, B, C, etc.,) are shown without a quantity it should be understood to mean only one (1) is required. Parts without letters after the description indicate the part is used for all assemblies or attachments listed in the heading.

INTRODUCTION - Continued

(5) ASSEMBLIES AND ATTACHMENTS. Wherever possible the component parts of assemblies or attachments are shown in the "exploded views" by use of boxes, brackets or arrows. Component parts of assemblies or attachments are listed by one of the following methods.

- (a) The listings are fully covered by descriptions for simple assemblies and attachments.
- (b) When four or more parts are contained in the assemblies or attachments the listing of components immediately follows the description with the wording "(Composed of-)."
- (c) Assemblies or attachments consisting of many parts shows the assembly or attachment number at the beginning of the unit list, followed by the listing of the components.

Exceptions to the above methods are explained by footnotes in the text.

Individual parts of an assembly which are not available for service are marked with a symbol §. In some instances, such parts are listed with a notation giving the information which is to be used for ordering.

(6) MISCELLANEOUS PARTS. Standard bolts, screws, nuts, etc. --- are not identified by a reference number. These parts are known as COMMON HARDWARE items and appear in abbreviated nomenclature and are shown indented under the major items with which they are used. They should be ordered as listed, since they are not component parts of the pieces they attach. Hardware parts identified with part numbers have been designed for a specific usage. Standard hardware parts should not be substituted for them.

WARNING: Attaching parts especially made for their location should never be substituted with regular standard parts.

The following rules are established to govern the listing of attaching parts:

The part number for Common Hardware items is eliminated. However, Design Hardware items will continue to be listed by part number and description.

All Carriage, Machine and Plow BOLTS; NUTS; Cap, Machine and Set SCREWS, will be considered furnished with National Course Thread unless otherwise specified. The number of threads per inch will be eliminated.

All NUTS will be considered "hex." unless otherwise specified.

All WASHERS will be considered "Plain" unless otherwise specified. The "ID", "OD" and "No." identity will be eliminated. The inside dimension will be listed first, followed by the outside diameter and the thickness.

All lock WASHERS will be considered "Medium" type unless specified as "Light" or "Heavy."

All cotter PINS will be considered "Extended-Prong" type unless otherwise specified.

All groove PINS will be considered "Standard Groove" unless otherwise specified.

All common RIVETS will be considered "Annealed" unless otherwise specified.

All countersunk-head tubular RIVETS will be considered "Copper-Plated Steel" unless otherwise specified.

All oval-head tubular RIVETS will be considered "Brass."

Standard bolts used in International Harvester Products are manufactured under standards known as Unified National Coarse Thread (U. N. C. and Unified National Fine Thread (U. N. F.) with the number of threads per inch for various diameters as follows:

Diameter of Bolt	No. of Threads per inch (U. N. C.)	No. of Threads per inch (U. N. F.)
1/4"	20	28
5/16"	18	24
3/8"	16	24
7/16"	14	20
1/2"	13	20
9/16"	12	18
5/8"	11	18
3/4"	10	16
7/8"	9	14
1"	8	14
1-1/8"	7	12
1-1/4"	7	12
1-3/8"	6	12
1-1/2"	6	12

(7) ABBREVIATIONS. The abbreviations used in this catalog are explained in the list of abbreviations on page 5.

INTRODUCTION - Continued

(8) SERIAL NUMBERS.

(A) CRAWLER TRACTORS.

Following is a list of starting serial numbers for these units.

<u>Crawler Tractors</u>	<u>Engine Starting Serial Number</u>	<u>Basic Engine Starting Serial Number</u>	<u>Chassis Starting Serial Number</u>
T-6 (62 Series) Manual Shift	C-263 10005	None	T-62 501
TD-6 (62 Series) Manual Shift	TD-62M 501	BSD-282 501	TD-62 501
TD-6 (62 Series) Agr.	TD-62AM 2938	BSD-282 501	TD-62A 3064
T-6 (62 Series) Sideboom	SC-263 10005	None	T-62S 501
TD-6 (62 Series) Sideboom	TD-62SM 501	BSD-282 501	TD-62S 501

(B) LOADERS

Following is a list of starting serial numbers for these units.

<u>Loaders</u>	<u>Engine Starting Serial Number</u>	<u>Basic Engine Starting Serial Number</u>	<u>Chassis Starting Serial Number</u>
T-6 (62 Series)	LC-263 10005	None	T-62L 501
TD-6 (62 Series)	TD-62LM 501	BSD-282 501	TD-62L 501

Serial numbers for carbureted engines are stamped on a pad on the left side of the engine just to the rear of the lubricating oil filter. Serial numbers for diesel engines and basic engines, TD-62M or BSD-282 below 1168, are stamped on a pad on the left side of the engine to the front and above oil cooler mounting pad.

Serial numbers for diesel engines and basic engines, TD-62M or BSD-282 above 1168, are stamped on the right side of the engine to the front and above the fuel injection pump.

Serial numbers for chassis (or crawler tractors) are stamped on the name plate on the dash.

The chassis serial numbers for these tractors run consecutively regardless of the tractor model, however, no attempt is made to have the engine and chassis serial numbers correspond.

Customers should be urged to supply the engine and chassis serial numbers, including model prefix and suffix letters when ordering parts.

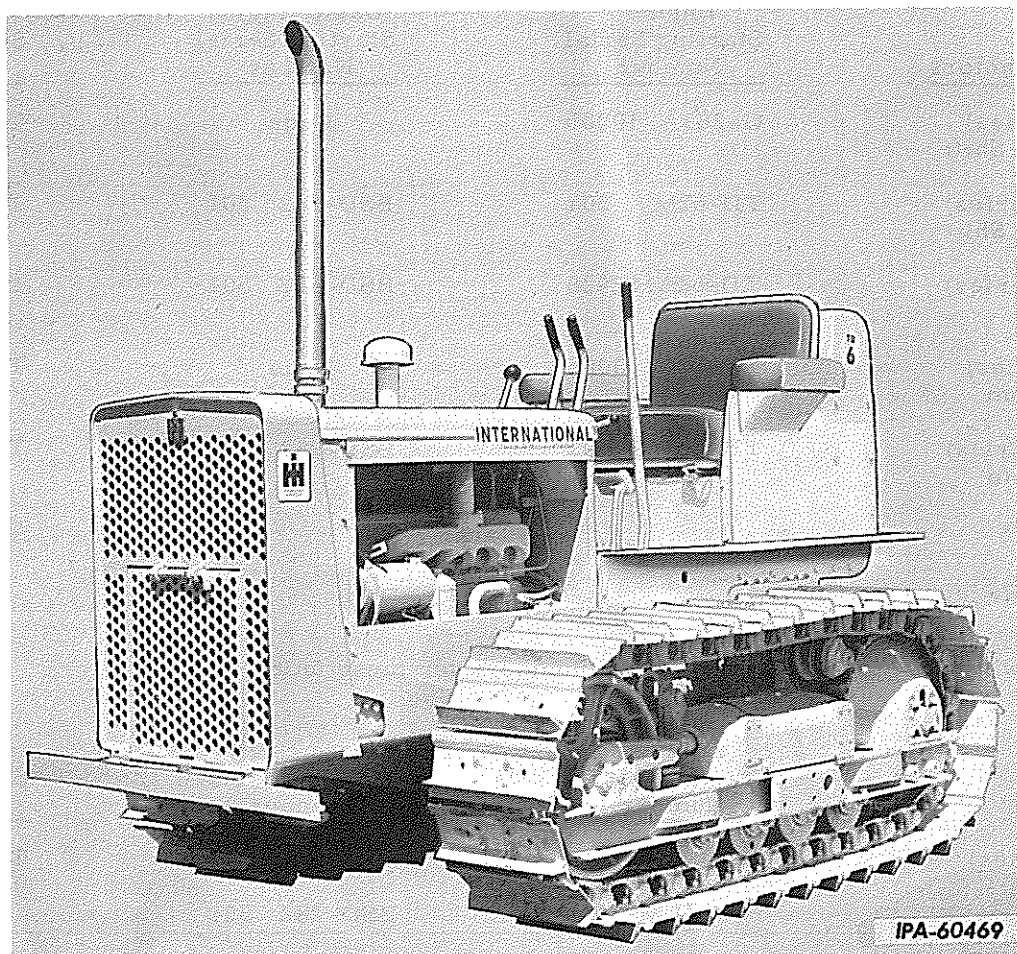

TD-6 (62 Series) equipped with Radiator Guard Attachment

LIST OF ABBREVIATIONS

A period after the abbreviation is used only when the abbreviation form spells a common English word.

adj	adjustable	lb	pound, pounds
al	aluminum	lentil-hd	lentil head
ast	alloy steel	LH	left hand
amp	ampere, amperes	lkg	locking
anl	annealed	LP Gas	Liquefied Petroleum Gas
approx	approximately	lub	lubrication
assy	assembly	mach.	machine
att	attachment	med	medium
bd-hd	binding head	MI	malleable iron
b-hd	button head	NC	National Coarse (thread)
brg	bearing	NF	National Fine (thread)
brs	brass	ni	nickel
brz	bronze	ni-pltd-stl	nickel plated steel
cd-pltd	cadmium plated	No.	number
cd-pltd-stl	cadmium plated steel	NPT	National pipe thread
C-Z	cadmium or zinc plated	OC	outside circumference
cr-pltd	chromium plated	OD	outside diameter
cr-pltd-stl	chromium plated steel	O/S	oversize
CI	cast iron	ov-hd	oval head
csk	countersunk	oz	ounce, ounces
csk-hd	countersunk head	parkerized-stl	parkerized steel
cl-rec-hd	clutch recess head	pkg	package
com	common	pltd	plated
cone-pt	cone point	pt	point
cont	continued	PTO	power take-off
cop	copper	rd-end	round end
cpl	copper plated	rd-hd	round head
cot.	cotter	rd-pt	round point
c-pin	cotter pin	reg	regular
crs	corrosion-resistant-steel (stainless)	RH	right hand
cr-rec-hd	cross recess head	RPM	revolutions per minute
cre	corrosion resisting	SAE	Society of Automotive Engineers
crg	carriage	sf	semi-finished
cup-pt	cup point	slt	slotted
cyl	cylinder, cylinders	slt-hd	slotted head
deg	degree	slt-bd-hd	slotted binding head
dia	diameter	slt-fil-hd	slotted fillister head
dld	drilled	slt-f-hd	slotted flat head
dld-f. c-pin	drilled for cotter pin	slt-hex-hd	slotted hexagon head
dld-f. lkg-wire	drilled for locking wire	slt-pan-hd	slotted pan head
dog-pt	dog point	slt-rd-hd	slotted round head
ext	external	slt-truss-hd	slotted truss head
f/	for	sq	square
fem	female	sq-hd	square head
fil-hd	fillister head	sq-nk	square neck
fin-nk	fin neck	std	standard
f-csk-hd	flat countersunk head	std-hd	standard head
f-fil-hd	flat fillister head	stl	steel
f-hd	flat head	str	straight
f-pt	flat point	T	teeth
flex.	flexible	tap.	tapping
ftd	fluted	thd	thread
ft	foot, feet	UNC	Unified Coarse (thread)
ga	gauge	UNF	Unified Fine (thread)
hd	head	U/S	undersize
hdls	headless	unfin	unfinished
hex.	hexagon	wb-hd	wagon box head
hex-hd	hexagon head	w/	with
hex-soc-hd	hexagon socket head	w/brz	with bronze
hp	horsepower	w/hex.	with hexagon
hv	heavy	w/o	without
hyd	hydraulic	zn	zinc
ID	inside diameter	zn-ct	zinc coated
in.	inch, inches	zn-pltd	zinc plated
int	internal		

INDEX TO UNITS

DESCRIPTION	Page	DESCRIPTION	Page
A		E - Continued	
Air Cleaner	30,31	Exhaust Manifold	16,29
Air Cleaner Pipe Extension	32	Exhaust Muffler	17,28
Air Pre-Cleaner	32		
Auxiliary, rear light	77,97	F	
B		Fan	
Basic Service Diesel Engine	19	Blower	53
Battery, support	80,100	Outboard	180
Belt, fan	50,51	Reversible	53
Belt, pulley	182	Suction	53
Brackets		Fan Adjuster	54
Headlight	78,98	Fan Housing	55,57
Rear Light	78,98	Fan Pulley	54
Auxiliary Rear Light	78,98	Fenders	165,166
Breakaway Coupling	160	Filter, fuel	47,48
C		Filter, lubricating oil	60,63
Cables, Spark Plug	71	Flywheel	18,27
Camshaft and Related Parts	11,27	Front Bumper	184
Carburetor	34	Front Idler	134
Channels, main frame	110	Front Idler Shield	135
Coil	71	Front Pull Hook	178
Connecting Rods	14,24	Fuel Filters	47,48
Counterweight	188	Fuel Pump	33
Crankcase	12,22	Fuel Injection Pump	
Crankcase Cover	13,23	Roosa-Master	40
Crankcase Gasket Set	203	International	42
Crankcase Oil Pan	59	Fuel Tank and Connections	36,38
Cranking Motor	84,106	G	
Crankshaft and Related Parts	15,26	Gasket Sets	
Cylinder Head	10,20	Cylinder Head	203
Cylinder Head Gasket Package	203	Crankcase	203
Cylinder Sleeve	14,24	Generator	82,103
D		Generator and Connections	80,102
Dash	172	Glow plug	46
Distributor	72	Governor	64
Drawbar	177	Guard	
Drive, bevel gear	119	Brush	77,97
E		Crankcase	178
Electric Starting and Lighting	66,69	Fan	54
	86,91	Radiator	184
Electrical Switches	66,69,78,	Tail Light	75,76,
	79,86,91,		95,96
	98,99	H	
Engine Basic (Diesel)	19	Headlight, rear light and	
Engine, replacement	9,19	auxiliary rear light	73 to 77,
Engine, Skeleton (Carbureted)	9		93 to 97
Engine Clutch	108	Hood	167,168
Engine Controls	174,175,	Hourmeter	81,101
	176	Hydraulic Blade Control Piping and	
Engine Oil Cooler	52	Related Parts	158
Engine Supports	18,27	Hydraulic Break-Away and Self-Sealing	
Equalizer Spring	113 to 115	Coupling	160
		Hydraulic Controls	145,146
		Hydraulic Pump	154,155

INDEX TO UNITS - Continued

DESCRIPTION	Page	DESCRIPTION	Page
H - Continued		P - Continued	
Hydraulic Pump Piping and Related Parts	151, 152	Pump, fuel injection	40, 42
Hydraulic Piping-Front Pump to Valve (For Loader)	164	Pump, hydraulic	154, 155
Hydraulic Quick Disconnect	162	Pump, lubricating oil	59
Hydraulic Remote Control	145	Pump, water	50, 51
Hydraulic Remote Control Adapter	159	R	
Hydraulic Single Circuit Auxiliary Piping	161	Radiator and Connections	55, 57
Hydraulic Valves	147 to 150	Radiator Grille	55, 57
I		Radiator Guard	184
Idler		Radiator Shutter and Controls	179
Front	133, 134	Rain Cap	17, 28
Track	128, 131	Rear Power Take-Off	185
Injector Nozzles	46	Replacement Engine	9, 19
Instruments and Panel	154	Return Fuel By-Pass	49
Intake Manifold	16, 29	Rocker Arms	20
L		S	
Lights, head, rear and auxiliary.	73 to 77 93 to 97	Seat and Supports	170
Lighting Switch	79, 99	Side Door	167
Lubricating Oil Cooler	52	Side Sheets	167
Lubricating Oil Filter	63, 64	Sleeves, Pistons	14, 24
Lubricating Oil Indicator	154	Spark Plug	71
Lubricating Oil Pump	62	Sprocket	141
Lubricators	170, 179	Sprocket Drive	141
M		Sprocket Drive Pinion	141
Master, switch lock	98	Sprocket Drive Pinion Shaft	141
Main Frame	112	Sprocket Drive Housing Shield	143
Main Frame Channels	110	Starting Motor (see cranking motor).	84, 106
Master Switch	98	Starting Switch	66, 69, 86, 91
Muffler, exhaust	17, 28, 169	Starting Crank	185
O		Steering Brakes	120
Odometer	180	Steering Clutch	
Oil Cooler	52	Controls	122
Oil Pan	59	Release Shaft	124
P		Skeleton engine	9
Packages - NOTE: Refer to major part desired.		Swivels	
Pipes, fuel injection	40, 42	Headlight	78, 98
Pistons	14, 24	Rear Light	78, 98
Pipe, exhaust	17, 28, 169	Auxiliary Rear Light	78, 98
Pivot Shaft	141	T	
Platform	171	Tail Light	75, 76, 95, 96
Power Take-Off	185, 187	Thermostat	51, 52
Pre-Combination Chamber	46	Thermostat Housing	52
Product Graphics	204	Tools	188, 199, 200
		Tool Box	201
		Track Chain	127, 131
		Track frame diagonal brace	126
		Track Frame	128, 131
		Track Frame guide and rollers	110
		Track Frame pivot shaft	141
		Track Idler	128, 131
		Track Roller	129, 131

INDEX TO UNITS - Continued

DESCRIPTION	Page	DESCRIPTION	Page
T - Continued		V - Continued	
Track Roller Shield.....	136	Valves, engine	10,20
Track Shoes	137	Vibration Damper	15,26
Track Spring	128,131	Voltage Regulator	83,105
Transmission	116	W	
V		Watchdog Fuel Filter	194 to 197
Valve Cover	10,20	Water Pump	50,51
Valve, hydraulic	146	Weather Cap	168
Valve Levers	10	Water, trap	189,190, 192

NUMERICAL INDEX 205

CARBURETED SKELETON AND REPLACEMENT SERVICE ENGINES

T-6 (62 SERIES)

SKELETON SERVICE ENGINE (See NOTE)

394 241 R91 ENGINE, skeleton service gasoline
 (Consists of
 Camshaft and Related Parts
 Connecting Rods and Pistons
 Crankcase
 Crankshaft and Related Parts

T-6 (62 SERIES)

REPLACEMENT SERVICE ENGINE (See NOTE)

373 409 R91 ENGINE, replacement service
 (Consists of all Engine Parts except
 the following:
 Cranking Motor
 Fan
 Generator
 Fan and Generator Belts
 Exhaust muffler, rain cap and
 Pipe Extension

NOTE: When ordering a Service Engine, give complete serial number (including letters and numerals) shown on crankcase of engine to be replaced.



CARBURETED ENGINE

CYLINDER HEAD, VALVE COVERS, VALVES AND VALVE LEVERS



CARBURETED ENGINE

CYLINDER HEAD, VALVE COVERS, VALVES AND VALVE LEVERS - CONTINUED

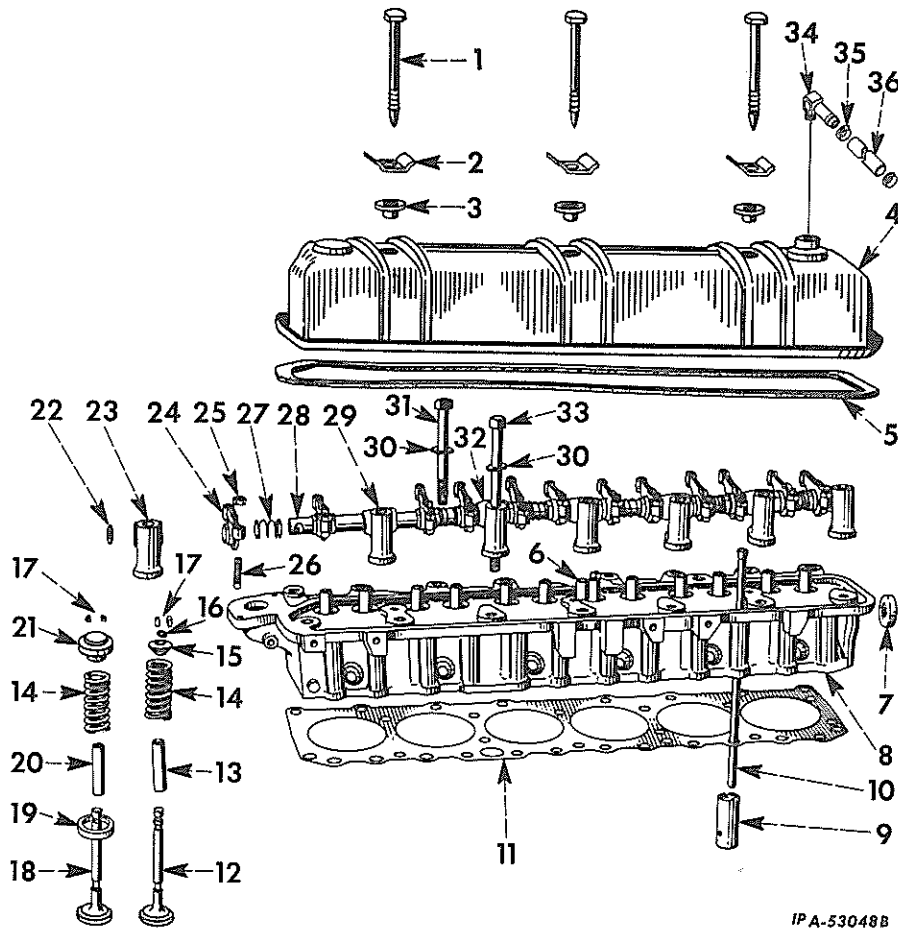

IPA-530488

REF. NO.	I. H. PART NUMBER	DESCRIPTION
1	168 144 R1	BOLT, valve cover (3)
2	370 208 R1	STIFFENER, valve cover (3)
3	164 420 R1	GROMMET, valve cover (3)
4	367 198 R11	COVER, valve
5	369 983 R1	GASKET, valve cover
6	69 500 R1	DOWEL, valve lever shaft intermediate No. 2, No. 4 and No. 6 bracket (3)
7	70 128 R1	PLUG, core hole
8	382 098 R92	HEAD w/VALVES ASSEMBLY, cylinder (Composed of - 12 DEFLECTORS 612 107 C1 1 HEAD w/GUIDES 383 665 R92 24 KEY 41 339 D 1 PLUG 70 128 R1 6 RETAINER 151 167 R3 6 ROTOCOIL 375 604 R91 12 SPRING 367 192 R1 6 VALVE 234 276 R1 6 VALVE 372 699 R2)

REF. NO.	I. H. PART NUMBER	DESCRIPTION
8	383 665 R92	HEAD w/GUIDES ASSEMBLY, cylinder (Composed of - § 1 HEAD 12 GUIDE 237 248 R1 1 PLUG 70 128 R1 6 SEAT 126 373 R1) 5/16 x 1/2" hex-hd cap SCREW (2)
9	75 524 R3	TAPPET, valve (12)
10	164 436 R91	ROD, valve push (12)
11	164 418 R2	GASKET, cylinder head
12	234 276 R1	VALVE, intake (together with DEFLECTOR, 612 107 C1 will work for 127 201 R1) (6)
13	237 248 R1	GUIDE, intake valve stem (6)
14	367 192 R1	SPRING, valve (12)
15	151 167 R3	RETAINER, valve spring (6)
16	111 024 R1	SEAL, intake valve stem (used with VALVE, 127 201 R1) (6)
16	612 107 C1	DEFLECTOR, intake and exhaust valve stem (used with VALVES, 234 276 R1 and 372 699 R2) (12)

§ - Not Furnished Separately.



CARBURETED ENGINE

REF. NO.	I.H. PART NUMBER	DESCRIPTION
CYLINDER HEAD, VALVE COVERS, VALVES AND VALVE LEVERS - CONTINUED		
17	41 339 D	KEY, valve spring retainer (24)
18	367 191 R2	VALVE, exhaust (optional with 372 699 R2) (6)
18	372 699 R2	VALVE, exhaust (optional with 367 191 R2) (6)
19	126 373 R1	SEAT, exhaust valve (6)
20	237 248 R1	GUIDE, exhaust valve stem (6)
21	375 604 R91	ROTOCOIL, exhaust valve (6)
22	109 544 R1	PLUG, rocker arm (2)
23	164 422 R1	BRACKET, valve lever shaft front and rear (2)
24	164 432 R91	LEVER w/SCREW, 16 067 DA and NUT, 133 093 R1, valve (12)
25	133 093 R1	NUT, valve lever adjusting screw (12)
26	16 067 DA	SCREW, valve lever adjusting (12)

CAMSHAFT AND RELATED PARTS

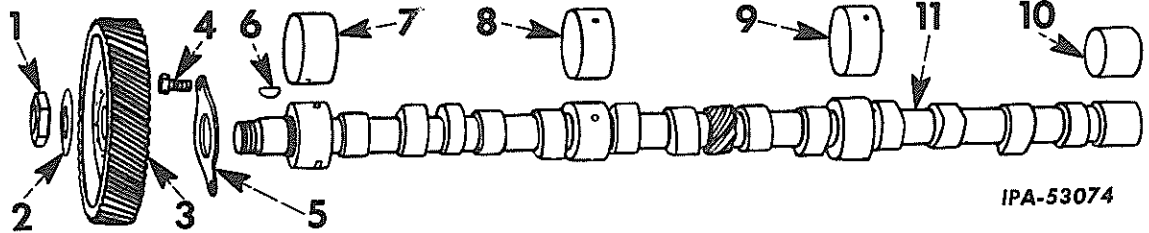

IPA-53074

REF. NO.	I.H. PART NUMBER	DESCRIPTION
1	16 026 DB	NUT, camshaft gear
2	16 025 D	LOCK, camshaft gear nut
3	367 240 R1	GEAR, camshaft
4	70 425 R1	BOLT, camshaft thrust plate (2)
5	35 650 HA	PLATE, camshaft thrust
6	127 559	KEY, 1/4 x 3/4" camshaft gear (Woodruff No. 91)



CARBURETED ENGINE

REF. NO.	I.H. PART NUMBER	DESCRIPTION
CYLINDER HEAD, VALVE COVERS, VALVES AND VALVE LEVERS - CONTINUED		
27	35 619 H	SPRING, valve lever (6)
28	76 953 R3	SHAFT, valve lever (2)
	17 244 R1	PIN, 5/16 x 1-1/4" roll (optional with 19 790 R1) (2)
	19 790 R1	PIN, 5/16 x 1-1/4" roll (optional with 17 244 R1) (2)
29	164 423 R11	BRACKET w/DOWEL, 69 500 R1, valve lever shaft intermediate No. 2, No. 4 and No. 6 (3)
30	58 516 H	WASHER, cylinder head bolt (15)
31	69 722 R1	BOLT, cylinder head (short) (8)
32	164 425 R1	BRACKET, valve lever shaft, intermediate No. 3 and No. 5 (2)
33	367 190 R1	BOLT, cylinder head (long) (7)
34	273 361 R1	ELBOW, air cleaner to valve cover hose
35	274 085 R91	CLAMP, air cleaner to valve cover hose (2)
36	278 687 R1	HOSE, 3/8 x 16 x 3/16" air cleaner to valve cover

CAMSHAFT AND RELATED PARTS - CONTINUED

REF. NO.	I.H. PART NUMBER	DESCRIPTION
7	70 259 R2	BEARING, camshaft (front) (will work for 367 514 R1)
8	70 260 R1	BEARING, camshaft (intermediate front)
9	70 261 R2	BEARING, camshaft (intermediate rear)
10	70 262 R1	BEARING, camshaft (rear)
11	367 229 R1	CAMSHAFT

CARBURETED ENGINE

CRANKCASE AND RELATED PARTS

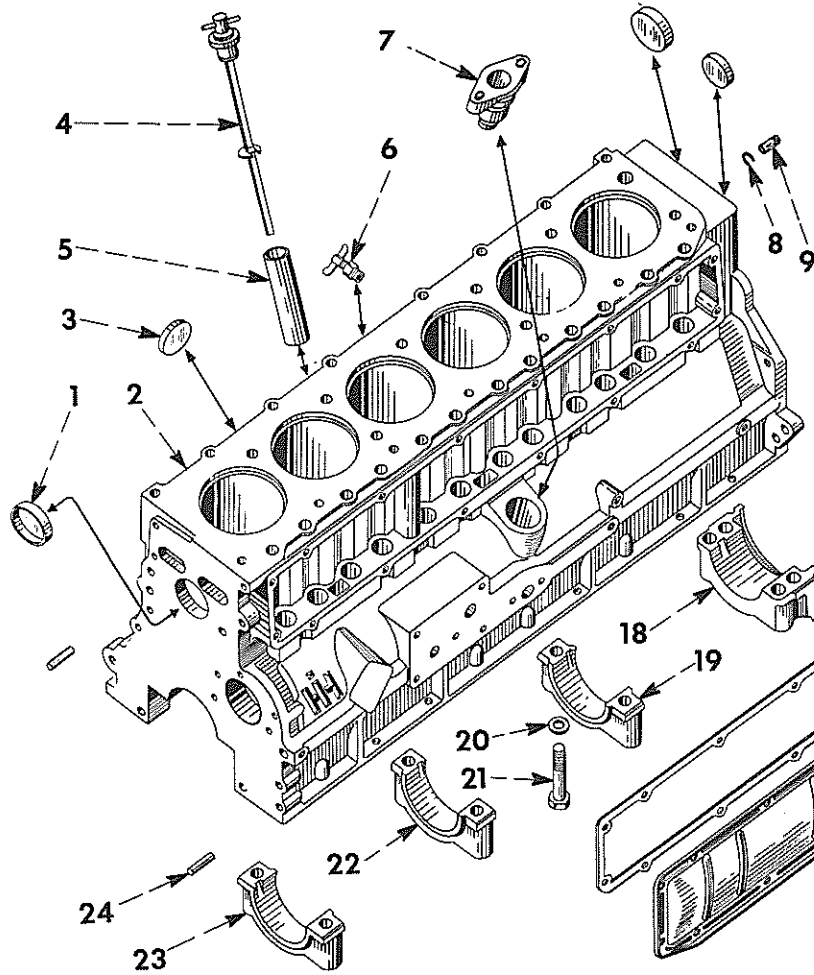

IPA-52494.A

CARBURETED ENGINE

CRANKCASE AND RELATED PARTS - CONTINUED

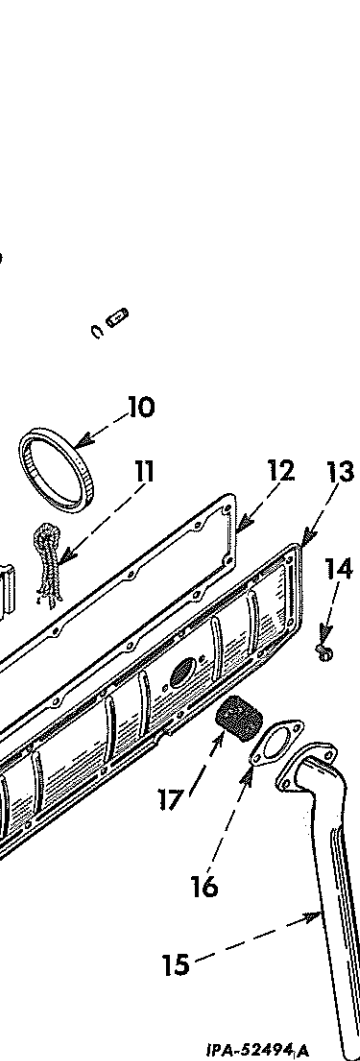

REF. NO.	I. H. PART NUMBER	DESCRIPTION
1	70 129 R1	PLUG, core hole (2)
2	367 512 R95	CRANKCASE ASSEMBLY (Composed of -
	1	ADAPTER 367 513 R1
	10	BOLT 70 133 R1
	1	BEARING 367 514 R1
	1	BEARING 70 260 R1
	1	BEARING 70 261 R1
	1	BEARING 70 262 R1
	§1	CAP
	§1	CAP
	§1	CAP
	§1	CAP
	1	COCK 141 615
	1	COVER 356 243 R1
	§1	CRANKCASE
	2	DOWEL 371 699 R2
	1	GASKET 128 868 H
	2	PIN 141 285
	6	PLUG 70 128 R1

REF. NO.	I. H. PART NUMBER	DESCRIPTION
2	367 512 R95	CRANKCASE ASSEMBLY - Continued (Composed of - Continued
	2	PLUG 70 129 R1
	1	TUBE 368 985 R2
	10	WASHER 58 516 H)
	444 783	PLUG, 3/8" sq-socket (cd or zn pltd) pipe (2)
	444 852	PLUG, 1/8" auto-hex-socket CI drain (optional with 444 853 and 444 854) (3)
	444 853	PLUG, 1/8" auto-hex-socket MI drain (optional with 444 852 and 444 854) (3)
	444 854	PLUG, 1/8" auto-hex-socket steel drain (optional with 444 852 and 444 853) (3)
3	70 128 R1	PLUG, core hole (6)
4	368 986 R91	GAUGE, oil level
5	368 985 R2	TUBE, oil filler
	§	- Not Furnished Separately.



CARBURETED ENGINE

REF. NO.	I.H. PART NUMBER	DESCRIPTION
----------	------------------	-------------

CRANKCASE AND RELATED PARTS - CONTINUED

6	141 615	COCK, 1/4" drain (type B) (optional with 103 647)
6	103 647	COCK, 1/4" drain (type C) (optional with 141 615)
7	367 513 R1	ADAPTER, distributor mounting
9	371 699 R2	DOWEL, engine rear support (2)
9	376 353 R1	DOWEL, engine rear support (.030 oversize) (2)
10	370 417 R91	SEAL, crankshaft rear oil
11	1 738 Y	PACKING, rear bearing cap (2)
12	369 982 R1	GASKET, valve push rod cover
13	69 734 R11	COVER, valve push rod
14	374 586 R91	SCREW w/WASHER, 1/4 x 1/2", slt-rd-hd. mach. (will work for 371 130 R91) (16)
15	373 463 R11 374 587 R91	PIPE, breather SCREW, 1/4 x 1/2" slt-rd-hd mach. w/WASHER (2)
16	369 981 R1	GASKET, breather pipe
17	369 442 R1	ELEMENT, breather pipe
18		CAP, crankshaft rear bearing (not furnished separately) (order Crankcase Assembly)
19		CAP, crankshaft intermediate rear bearing (not furnished separately) (order Crankcase Assembly)
20	58 516 H	WASHER, bearing cap bolt (10)
21	70 133 R1	BOLT, crankshaft bearing cap (10)
22		CAP, crankshaft intermediate front bearing (not furnished separately) (order Crankcase Assembly)
23		CAP, crankshaft front bearing (not furnished separately) (order Crankcase Assembly)
24	141 285	DOWEL, 1/2 x 1-1/4" crankcase front plate and cover (2)
	356 243 R1	COVER, fuel pump mounting pad
	612 293 C1	GASKET, pump mounting pad cover 1/2" NUT (4)
	19 992 R1	SCREW, 1/2 x 2-1/4" hex-hd cap (4) 5/16 x 5/8" hex-hd cap SCREW (2) 1/2" lock WASHER (4) 5/16" lock WASHER (2)



CARBURETED ENGINE

CRANKCASE FRONT COVER

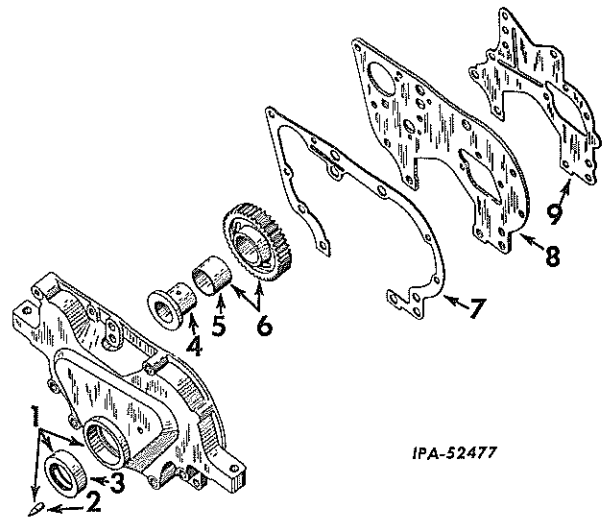

IPA-52477

REF. NO.	I.H. PART NUMBER	DESCRIPTION
1	372 499 R11	COVER w/POINTER, 367 572 R1 and SEAL, 357 672 R91, crankcase front 1/2 x 2-3/4" hex-hd cap SCREW (6) 1/2" lock WASHER (6)
2	367 572 R1	POINTER, timing
3	357 672 R91	OIL SEAL, crankshaft (used with DAMPER, 306 367 R91 or DAMPER, 338 951 R91)
3	317 549 R91	OIL SEAL, crankshaft (used with DAMPER, 338 951 R91)
4	367 580 R11 141 150	SHAFT w/PIN, 141 150, idler gear PIN, 3/16 x 7/16" dowel
5	367 578 R1	BUSHING, idler gear
6	367 577 R11	GEAR w/BUSHING, 367 578 R1, idler
7	367 574 R1	GASKET, crankcase front cover
8	367 524 R1	PLATE, crankcase front 3/8 x 7/8" hex-hd. cap SCREW (6) 3/8" lock WASHER (6)
9	367 570 R1	GASKET, crankcase front plate



CARBURETED ENGINE

CONNECTING RODS, SLEEVES AND PISTONS

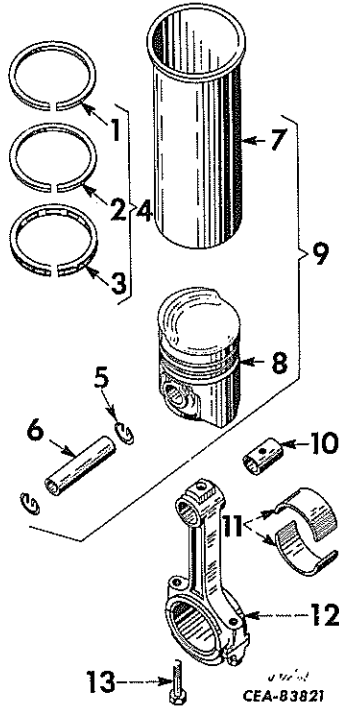

REF. NO.	I. H. PART NUMBER	DESCRIPTION
1	389 747 R1	RING, piston compression (top groove) (3/32" chrome thick wall) (6)
2	389 751 R1	RING, piston compression (second groove) (3/32" plain) (6)
3	388 355 R91	RING, piston oil regulating (third groove) (1/4" Perflon)
4	367 649 R92	RING SET, piston (replacement) (consists of six chrome compression rings, six plain compression and six oil regulating rings)
5	19 517 D	RING, piston pin retainer (12)
6	278 271 R1	PIN, piston (standard) (6)
6	70 015 R1	PIN, piston (.005" oversize) (6)
7		SLEEVE, cylinder (order sleeve assembly cylinder w/PISTON and RINGS) (6)
8		PISTON (order sleeve assembly cylinder w/PISTON and RINGS) (6)
9	367 640 R92	SLEEVE w/PISTON and RINGS ASSEMBLY, cylinder (standard altitude) (6) C-263-10005 to 56634 (Composed of - §1 PISTON 1 PIN 278 271 R1 2 RING 19 517 D 1 RING 389 747 R1 1 RING 389 751 R1 1 RING 388 355 R91 §1 SLEEVE)



CARBURETED ENGINE

CONNECTING RODS, SLEEVES AND PISTONS - CONTINUED

REF. NO.	I. H. PART NUMBER	DESCRIPTION
9	372 084 R92	SLEEVE w/PISTON and RINGS ASSEMBLY, high altitude cylinder (6) (part of accessory 371 833 R92) C-263-10005 to 56634
9	367 639 R92	SLEEVE SET, cylinder standard altitude (consists of six SLEEVES w/PISTONS and RINGS, 367 640 R91) C-263-10005 to 56634
9	378 603 R94	SLEEVE SET, cylinder (Standard Altitude) (Consists of six SLEEVES w/PISTON and RINGS 378 604 R94) C-263-56635 up
9	378 604 R94	SLEEVE w/PISTON and RINGS ASSEMBLY, cylinder (Standard Altitude) (6) C-263-56635 up
9	380 648 R94	SLEEVE SET, cylinder w/PISTONS and RINGS (high altitude) (Consists of six SLEEVES w/PISTONS and RINGS, 380 649 R94) C-263-56635 up
9	380 649 R94	SLEEVE, w/PISTON and RINGS ASSEMBLY, cylinder (high altitude) (6) C-263-56635 up
10	364 913 R1	BUSHING, piston pin (6)
11	367 408 R11	BEARING, connecting rod (2 halves) (standard) (6)
11	367 632 R11	BEARING, connecting rod (2 halves) (.002" undersize) (6)
11	367 631 R11	BEARING, connecting rod (2 halves) (.030" undersize) (6)
11	367 630 R91	BEARING SET, connecting rod (consists of six BEARINGS, 367 408 R11) (standard)
11	372 443 R91	BEARING SET, connecting rod (consists of six BEARINGS, 367 631 R11) (.030" undersize)
12	367 406 R11	ROD and CAP w/BUSHING, 364 913 R1 and two BOLT, 70 013 R1 connecting (6)
13	70 013 R1	BOLT, connecting rod (12)
	371 833 R92	ACCESSORY, high altitude cylinder sleeve w/PISTON and RINGS, 372 084 R92 (See NOTE)

NOTE - Field Application - Order Through Regular Service Parts Channels.
§ - Not Furnished Separately.



CARBURETED ENGINE

CRANKSHAFT, VIBRATION DAMPER AND RELATED PARTS

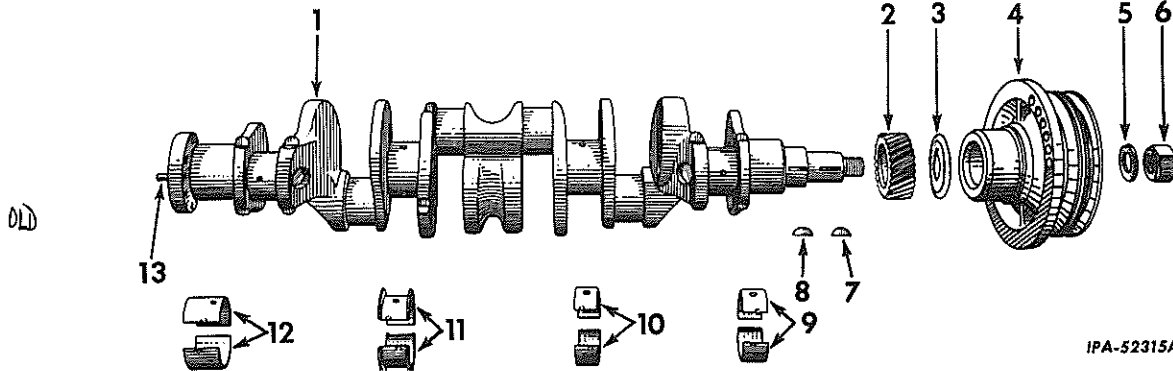

CARBURETED ENGINE

CRANKSHAFT, VIBRATION DAMPER AND RELATED PARTS - CONTINUED

REF. NO.	I.H. PART NUMBER	DESCRIPTION
1	367 269 R91	PACKAGE, crankshaft field service (standard size) (Consists of 1 BEARING 367 276 R91 1 BEARING 367 279 R91 1 BEARING 367 282 R91 1 BEARING 367 285 R91 6 BEARING 367 408 R11 §1 CRANKSHAFT 1 PIN 82 970 R1)
1	367 271 R91	PACKAGE, crankshaft field service (.030" undersize) (Consists of 1 BEARING 367 288 R91 1 BEARING 367 291 R91 1 BEARING 367 294 R91 1 BEARING 367 297 R91 6 BEARING 367 631 R11 §1 CRANKSHAFT 1 PIN 82 970 R1)
2	367 272 R1	GEAR, crankshaft
3	71 763 R2	SLINGER, crankshaft oil
4	338 951 R91	DAMPER, vibration (will work for DAMPER, 306 367 R91)
5	70 109 R1	WASHER, starting crank nut
6	23 174 V	NUT, crankshaft
7	117 984	KEY, 5/16 x 1-3/8" fan drive pulley (Woodruff No. 23)
8	103 462	KEY, 3/16 x 1" crankshaft gear (Woodruff No. 13)
9	367 276 R91	BEARING, crankshaft front (standard size) (two halves)
9	367 300 R91	BEARING, crankshaft front (.002" undersize) (two halves)
9	367 288 R91	BEARING, crankshaft front (.030" undersize) (two halves)
10	367 279 R91	BEARING, crankshaft intermediate front (standard size) (two halves)

REF. NO.	I.H. PART NUMBER	DESCRIPTION
10	367 303 R91	BEARING, crankshaft intermediate front (.002" undersize) (two halves)
10	367 291 R91	BEARING, crankshaft intermediate front (.030" undersize) (two halves)
11	367 282 R91	BEARING, crankshaft intermediate rear (standard size) (two halves)
11	367 306 R91	BEARING, crankshaft intermediate rear (.002" undersize) (two halves)
11	367 294 R91	BEARING, crankshaft intermediate rear (.030" undersize) (two halves)
12	367 285 R91	BEARING, crankshaft rear (standard size) (two halves)
12	367 309 R91	BEARING, crankshaft rear (.002" undersize) (two halves)
12	367 297 R91	BEARING, crankshaft rear (.030" undersize) (two halves)
13	82 970 R1	PIN, flywheel to crankshaft dowel
	367 408 R11	BEARING, connecting rod (standard) (illustrated with "Connecting Rod and Sleeve Sets") (6)
	367 631 R1	BEARING, connecting rod (.030" undersize) (illustrated with "Connecting Rod and Sleeve Sets") (6)
	367 275 R91	BEARING SET, crankshaft (standard) (Composed of - 1 BEARING 367 276 R91 1 BEARING 367 279 R91 1 BEARING 367 282 R91 1 BEARING 367 285 R91)
	372 444 R91	BEARING SET, crankshaft (.030" undersize) (Composed of - 1 BEARING 367 288 R91 1 BEARING 367 291 R91 1 BEARING 367 294 R91 1 BEARING 367 297 R91)

NOTE - Field Application - Order Through Regular Service Parts Channels.
§ - Not Furnished Separately.



CARBURETED ENGINE

INTAKE AND EXHAUST MANIFOLDS

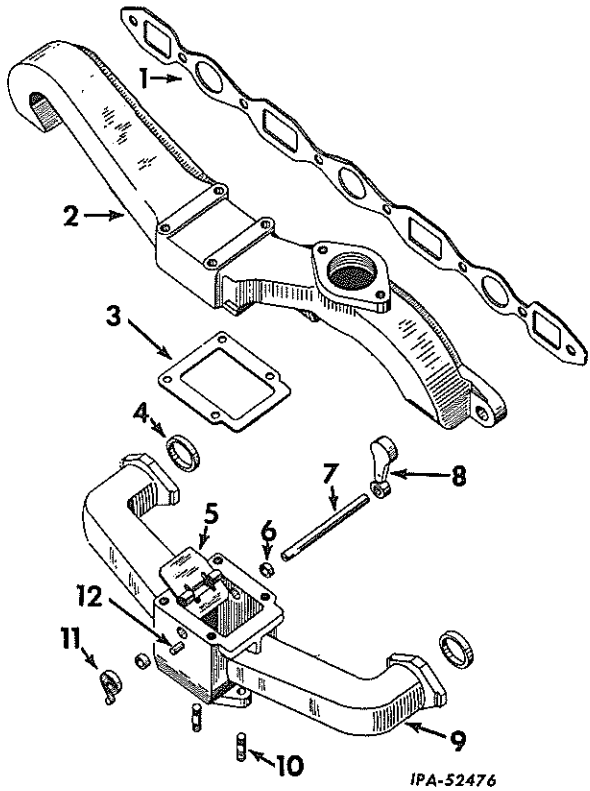

IPA-52476

REF. NO.	I.H. PART NUMBER	DESCRIPTION
1	173 192 R1	GASKET, intake and exhaust manifold
2	368 550 R11	MANIFOLD w/PLUG, 103 317, exhaust 3/16 x 1/2" taper groove PIN 3/8 x 3" hex-hd. cap SCREW (4) 3/8 x 1-1/4" hex-hd. cap SCREW (6) 3/8 x 1-1/2" hex-hd. cap SCREW (2) 13/32 x 7/8 x 7 ga. WASHER (8)
3	85 868 R1	GASKET, intake to exhaust manifold
4	98 573 HA	PILOT, intake manifold (2)
5	85 700 R1	VALVE, manifold heat control
6	69 443 R1	BUSHING, manifold heat control (2)
7	82 959 R1	SHAFT, manifold heat control valve
8	85 699 R1	WEIGHT, manifold heat control
9	367 261 R11	MANIFOLD ASSEMBLY, intake (Composed of - 2 BUSHING 69 443 R1 1 PLUG 444 571 1 PIN 141 159 1 SHAFT 82 959 R1 1 SPRING 82 958 R2 2 STUD 12 215 D 1 VALVE 85 700 R1 1 WEIGHT 85 699 R1)



CARBURETED ENGINE

REF. NO.	I.H. PART NUMBER	DESCRIPTION
----------	------------------	-------------

INTAKE AND EXHAUST MANIFOLDS - CONTINUED

10	12 215 D	STUD, carburetor (2)
11	82 958 R2	SPRING, thermostat heat control valve
12	141 159	PIN, 3/16 x 1" dowel
	444 571	PLUG, 1/8" sq-hd. cd or zn-pltd. pipe
	107 317	PLUG, exhaust manifold drain hole

§ - Not Furnished Separately.



CARBURETED ENGINE

EXHAUST MUFFLER, RAIN CAP AND PIPE EXTENSION (Not For Heavy Hood)

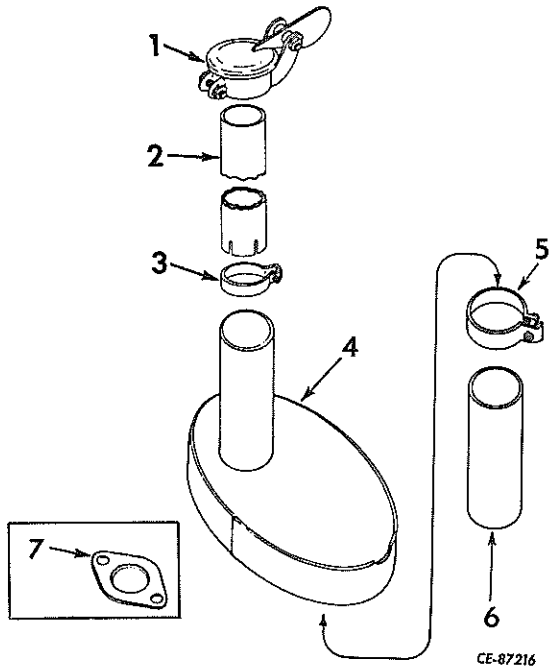

CE-87216

REF. NO.	I.H. PART NUMBER	DESCRIPTION
1	283 280 R91	CAP, exhaust rain (optional with 321 574 R91) (Regular) (Also part of ATTACHMENT, 314 410 R91)
1	321 574 R91	CAP, exhaust rain (optional with 273 280 R91) (Regular) (Also part of ATTACHMENT, 314 410 R91)
2	314 412 R1	PIPE, exhaust muffler extension (together with CAP, 283 280 R91 will work for PIPE, 276 224 R2) (Regular) (Also part of ATTACHMENT, 314 410 R91)
3	276 222 R91	CLAMP, exhaust extension pipe (not used with "Heavy Hood" or low seat attachment)
4	307 872 R91	MUFFLER, exhaust T-62 501 to 3237 T-62L 501 to 3237 T-62S 501 to 3237 (Order the following parts - 1 CLAMP 350 602 R1 1 MUFFLER 606 224 C91 1 NUT 3/8" 1 NIPPLE 251 342 R1 1 SCREW 3/8 x 1-1/4" hex-hd cap 1 WASHER 3/8" lock)
4	606 224 C91	MUFFLER, exhaust T-62 3238 up T-62L 3238 up T-62S 3238 up



CARBURETED ENGINE

EXHAUST MUFFLER, RAIN CAP AND PIPE EXTENSION - CONTINUED (Not For Heavy Hood)

REF. NO.	I.H. PART NUMBER	DESCRIPTION
5	350 602 R1	CLAMP, exhaust T-62 3238 up T-62L 3238 up T-62S 3238 up 3/8" NUT 3/8 x 1-1/4" SCREW, hex-hd cap 3/8" lock WASHER
6	251 342 R1	NIPPLE, exhaust 2 x 3-3/4" T-62 3238 up T-62L 3238 up T-62S 3238 up
7	369 282 R1	GASKET, exhaust muffler flange T-62 501 to 3237 T-62L 501 to 3237 T-62S 501 to 3237
	314 410 R91	ATTACHMENT, exhaust rain cap (See NOTE 3) (Consists of CAP, 283 280 R91 or CAP, 321 574 R91, CLAMP, 379 368 R91 and PIPE, 314 412 R1) T-62 501 to 3603 T-62L 501 to 3603 T-62S 501 to 3603

NOTE 3 - Field Application - Order Through Regular Service Parts Channels.



CARBURETED ENGINE

FLYWHEEL AND ENGINE SUPPORTS

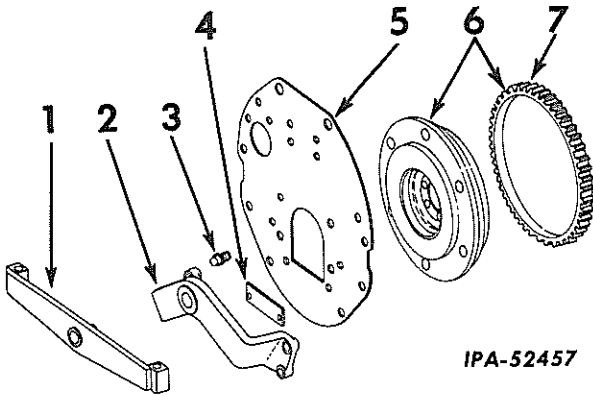

IPA-52457

REF. NO.	I. H. PART NUMBER	DESCRIPTION
1	306 647 R91	SUPPORT, front engine
2	306 646 R1	BRACKET, front engine support 5/8" NUT (4) 5/8 x 4-1/4" hex-hd. cap SCREW (4) 5/8" lock WASHER (4)
3	109 461	FITTING, lubrication (Lincoln 5000) (optional with 138 322 H)
3	138 322 H	FITTING, lubrication (Alemite 1610 B) (optional with 109 461)
4	367 225 R1	SEAL, rear engine support dust 5/16 x 5/8" hex-hd. cap SCREW (2) 11/32 x 11/16 x .065" plain WASHER (2)
5	373 485 R1 9 409 086 58 516 H	SUPPORT, rear engine SCREW, 1/2 x 1-1/4" (type AA) hex. lock cap (4) WASHER, 17/32 x 1 x .092" (4)
6	306 639 R11	FLYWHEEL w/ring GEAR, 47 874 DE
7	47 874 DE	GEAR, flywheel ring (149 T)
	601 558 C1	BOLT, 7/16NF x 3" hex. lock (6)
	48 384 D	SHIM, front engine support (heavy) (X)
	48 385 D	SHIM, front engine support (light) (X)

(X) - As Required.



MEMORANDA