

CHASSIS

FINAL DRIVE — STEERING CLUTCH RELEASE SHAFT AND MECHANISM

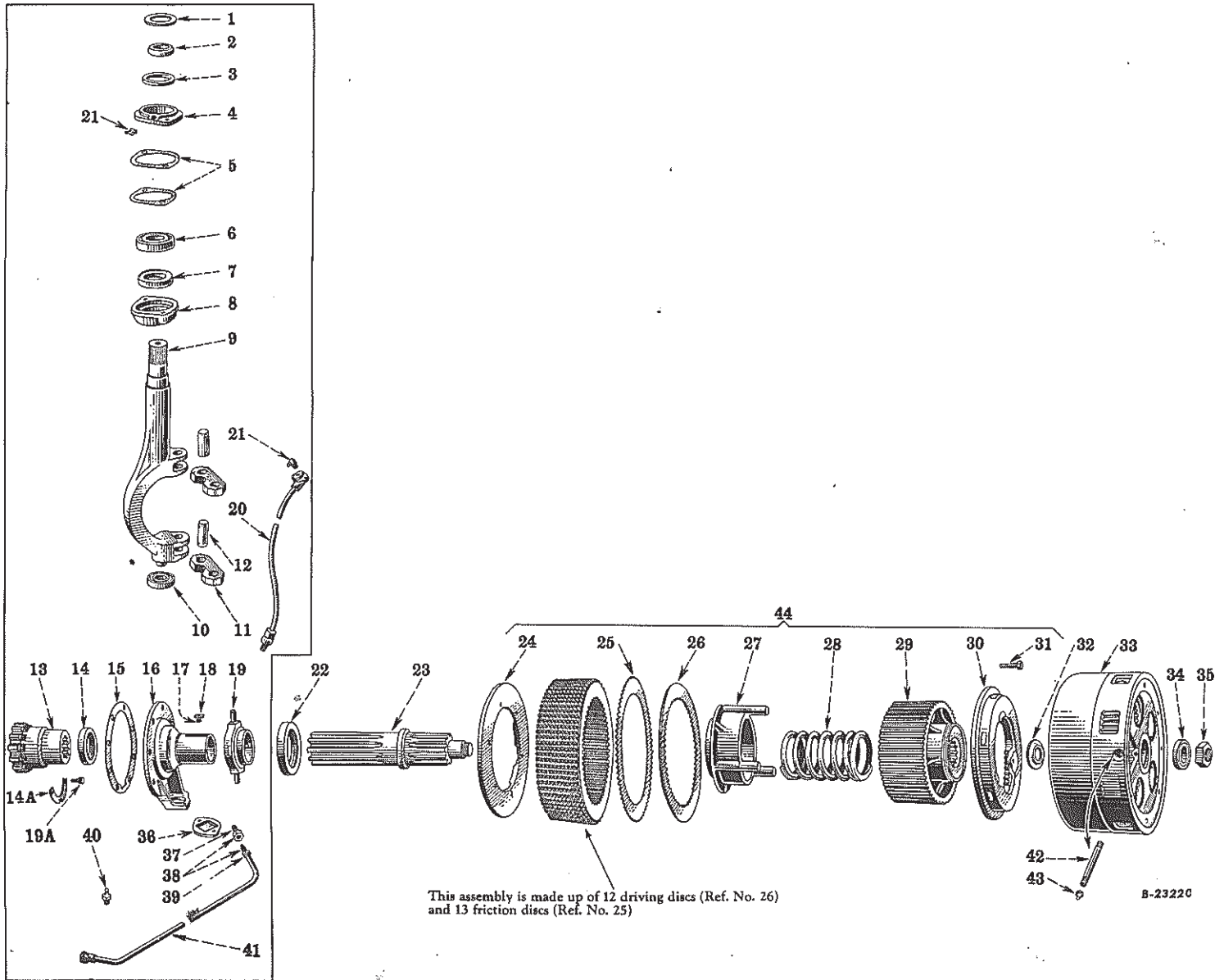

TC-43

-149-

CHASSIS



REF. NO.	I H PART NUMBER	DESCRIPTION	SERIAL NUMBER	NO. REQ'D
FINAL DRIVE - STEERING CLUTCH RELEASE SHAFT AND MECHANISM				
1	56 017 D	STEERING CLUTCH RELEASE FORK UPPER BEARING FELT RETAINER		2
2	56 010 D	STEERING CLUTCH RELEASE LEVER SPACER		2
3	56 008 D	STEERING CLUTCH RELEASE FORK UPPER BEARING FELT		2
4	8 680 DX	STEERING CLUTCH RELEASE FORK UPPER BEARING RETAINER WITH LUBRICATOR, 109 461 AND PLUG, 103 883		2
	103 322	LOCK WASHER, 7/16"		2
	179 862	CAP SCREW, 7/16 x 1-1/2" N.C. HEX HEAD		4
5	56 009 D	STEERING CLUTCH RELEASE FORK UPPER BEARING CAGE GASKET		4
6	ST 205 A	STEERING CLUTCH RELEASE FORK UPPER BALL BEARING		2
7	21 969 D	STEERING CLUTCH RELEASE FORK UPPER BEARING OIL SEAL		2
8	8 682 DX	STEERING CLUTCH RELEASE FORK UPPER BEARING CAGE WITH OIL SEAL, 21 969 D		2
9	57 099 D	STEERING CLUTCH RELEASE FORK		2
10	ST 516	STEERING CLUTCH RELEASE FORK LOWER BALL BEARING		2
11	56 005 D	STEERING CLUTCH RELEASE COLLAR SHIFTER LINK		2
12	56 007 D	STEERING CLUTCH RELEASE COLLAR SHIFTER LINK PIN		4
13	103 386	COTTER PIN, 1/8 x 1-1/4"		4
14	251 625 R11	STEERING CLUTCH SHAFT COUPLING, 12 TEETH, WITH EXPANSION PLUG, 172 604		8
14A	40 880 D	STEERING CLUTCH SHAFT COUPLING OIL SEAL		2
	251 626 R1	STEERING CLUTCH SHAFT COUPLING RETAINER		2
15	40 929 D	DRIVE BEVEL GEAR BEARING CAGE CAP GASKET		1
16	8 742 DAX	DRIVE BEVEL GEAR BEARING CAGE CAP, 8 742 DA, L.H. WITH OIL SEAL, 40 880 D		2
	103 030	HEX NUT, 5/8" N.F.		1
	103 325	LOCK WASHER, 5/8"		2
	179 929	CAP SCREW, 5/8 x 1-3/4" N.C. HEX HEAD		6
16	8 743 DAX	DRIVE BEVEL GEAR BEARING CAGE CAP, 8 743 DA, R.H. WITH OIL SEAL, 40 880 D		6
	103 030	HEX NUT, 5/8" N.C.		1
	103 325	LOCK WASHER, 5/8"		2
	179 929	CAP SCREW, 5/8 x 1-3/4" N.C. HEX HEAD		8
				6
17	56 006 D	STEERING CLUTCH RELEASE COLLAR KEY PIN		2
18	56 013 DX	STEERING CLUTCH RELEASE COLLAR KEY WITH PIN, 56 006 D		2
19	56 018 D	STEERING CLUTCH RELEASE COLLAR		2
19A	260 618 R1	STEERING CLUTCH SHAFT COUPLING RETAINER BOLT	TDR 22933 UP	2
	221 813	STEERING CLUTCH SHAFT COUPLING RETAINER BOLT (1/2 x 3-7/8" N.F.) (ORDER 260 661 P91)	TDR 22001 TO 22932	12
20	57 103 DX	STEERING CLUTCH RELEASE BEARING GREASE TUBE, COMPLETE		12
	13 243 R1	MACHINE BOLT, 1/4 x 3/4" N.C.		2
	103 319	LOCK WASHER, 1/4"		4
	220 064	HEX NUT, 1/4" N.C.		4
21	119 512	STEERING CLUTCH RELEASE FORK UPPER BEARING LUBRICATION FITTING (OPTIONAL WITH 109 461)		4
21	109 461	STEERING CLUTCH RELEASE FORK UPPER BEARING LUBRICATION FITTING (OPTIONAL WITH 119 512)		2
22	53 233 DA	STEERING CLUTCH RELEASE THRUST BEARING (ACTM)		2
23	251 624 R1	STEERING CLUTCH SHAFT		2

TC-43

CHASSIS

— 150 —



REF. NO.	I H PART NUMBER	DESCRIPTION	SERIAL NUMBER	NO. RECD.
----------	-----------------	-------------	---------------	-----------

FINAL DRIVE — STEERING CLUTCH RELEASE SHAFT AND MECHANISM - Continued

24	5 715 D	STEERING CLUTCH HUB PLATE		2
	103 323	LOCK WASHER, 1/2"		12
	179 887	CAP SCREW, 1/2 x 1-1/4" N.C. HEX HEAD		12
25	40 883 DC	STEERING CLUTCH FRICTION DISC, 58 TEETH (RAYBESTOS)		36
25	58 957 D	STEERING CLUTCH (BI-METALLIC) FRICTION DISC, 58 TEETH (SPECIAL) (USED WITH 61 903 D)		40
26	40 882 D	STEERING CLUTCH DRIVING DISC, 77 TEETH (STEEL) (38 USED WITH 61 903 D)		34
27	5 712 DB	STEERING CLUTCH PRESSURE SPRING RETAINER		2
28	68 462 D	STEERING CLUTCH PRESSURE SPRING		1
29	9 717 D	STEERING CLUTCH HUB		2
30	5 711 DC	STEERING CLUTCH PRESSURE PLATE		6
31	54 968 D	STEERING CLUTCH PRESSURE PLATE DOWEL BOLT		6
	103 323	LOCK WASHER, 1/2"		2
32	53 742 DA	STEERING CLUTCH PILOT BEARING SPACER		2
33	5 714 DD	STEERING CLUTCH DRUM		2
	103 325	LOCK WASHER, 5/8"		16
	181 477	CAP SCREW, 5/8 x 1-1/4" N.F. HEX HEAD		16
34	ST 333	STEERING CLUTCH PILOT BEARING		2
35	256 790 R1	STEERING CLUTCH PILOT BEARING RETAINER NUT		2
36	57 102 D	STEERING CLUTCH RELEASE FORK LOWER BEARING CAP		2
	103 320	LOCK WASHER, 5/16"		4
	113 916	SLOTTED BOLT, 5/16 x 1-1/4" N.C. FLAT HEAD		4
	220 065	HEX NUT, 5/16" N.C.		4
37	29 899 D	STEERING CLUTCH RELEASE FORK LOWER BEARING GREASE TUBE CONNECTOR NUT		2
38	35 252 DX	STEERING CLUTCH RELEASE FORK LOWER BEARING GREASE TUBE CONNECTOR, 35 252 D WITH NUT, 29 899 D		2
39	35 252 D	STEERING CLUTCH RELEASE FORK LOWER BEARING GREASE TUBE CONNECTOR		2
40	109 352	STEERING CLUTCH RELEASE BEARING LUBRICATION FITTING (ALENITE 1607) (OPTIONAL WITH 126 121)		2
40	126 121	STEERING CLUTCH RELEASE BEARING LUBRICATION FITTING (LINCOLN 5003) (OPTIONAL WITH 109 352)		2
41	57 101 DX	STEERING CLUTCH RELEASE FORK LOWER BEARING GREASE TUBE WITH CONNECTOR NUT, 35 252 D AND BRACKET		2
42	54 652 D	STEERING CLUTCH PILOT BEARING LUBRICATOR PIPE		2
43	109 368	STEERING CLUTCH PILOT BEARING LUBRICATION FITTING (OPTIONAL WITH Q 3 618)		2
3	Q 3 618	STEERING CLUTCH PILOT BEARING LUBRICATION FITTING (OPTIONAL WITH 109 368)		2

