

BEVEL GEAR AND STEERING CLUTCHES

BEVEL GEAR AND STEERING CLUTCHES

ITEM	PART NUMBER	QTY.	DESCRIPTION	PACKAGE NUMBER
1	057414	1	GEAR, driving, steering clutch shaft (44 bevel teeth)	
2	030547	12	CAPSCREW (1/2"NF x 2")	
3	038234	12	NUT, high, 1/2"NF	
4	035065	6	LOCK, nut	
5	050234	1	COLLAR, locking, bevel gear attaching bolts	
6	050231	2	SLEEVE, steering clutch shaft	
7	064530	1	SHAFT ASSEMBLY, steering clutch (Includes item 6)	
8	050445	2	CONE ASSEMBLY, steering clutch shaft bearing	
9	050444	2	CUP, steering clutch shaft bearing	
10	{ 050228	12	SHIM, adjusting, shaft bearing (.005" thick. Use as req'd)	
	{ 050229	12	SHIM, adjusting, shaft bearing (.007" thick. Use as req'd)	
	{ 050230	12	SHIM, adjusting, shaft bearing (.010" thick. Use as req'd)	
11	051292	2	RETAINER ASSEMBLY, shaft bearing (Includes item 13)	
12	{ 035190	6	CAPSCREW, 1/2"NC x 1-1/2"	
	{ 095779	4	CAPSCREW, 1/2"NC x 1-1/2" (Has nylon insert)	
	{ 904208	10	LOCKWASHER, 1/2"	
13	051291	2	PIN, wear, clutch shaft bearing retainer	
14	050443	2	SEAL, oil, steering clutch shaft	
15	059260	2	HOSE, lubricating, throwout bearing	
	901722	2	ELBOW, street, 90°, 1/4"NPT	
16	050233	2	WICK, lubricating, throwout bearing hose (8-1/4" long)	
17	050249	2	CAGE ASSEMBLY, throwout bearing (Includes item 18)	
	901652	2	PLUG, pipe, 1/4"NPT	
18	050227	4	BUSHING, pivot, throwout bearing (steel)	
19	050440	2	BEARING, ball, steering clutch throwout	
20	050215	2	HUB, steering clutch driving	
21	035236	20	CAPSCREW, 1/2"NC x 1-3/4"	
	904208	20	LOCKWASHER, 1/2"	
22	050223	2	SLEEVE, steering clutch throwout	
23	035793	2	PIN, clutch hub retaining washer (1/4" x 3/4")	
24	064520	2	WASHER ASSEMBLY, hub retaining (Includes item 23)	
25	050225	2	WASHER, locking, clutch hub retaining cap screw	
26	050226	2	CAPSCREW, clutch hub retaining (1"NF x 1-3/4")	
27	050244	2	CLUTCH ASSEMBLY, steering (Consists of items 28 thru 30)	
28	050214	2	PLATE, steering clutch throwout	
29	045066	16	SPACER, steering clutch throwout plate	
30	050236	16	SPRING, pressure, steering clutch	

(Continued)

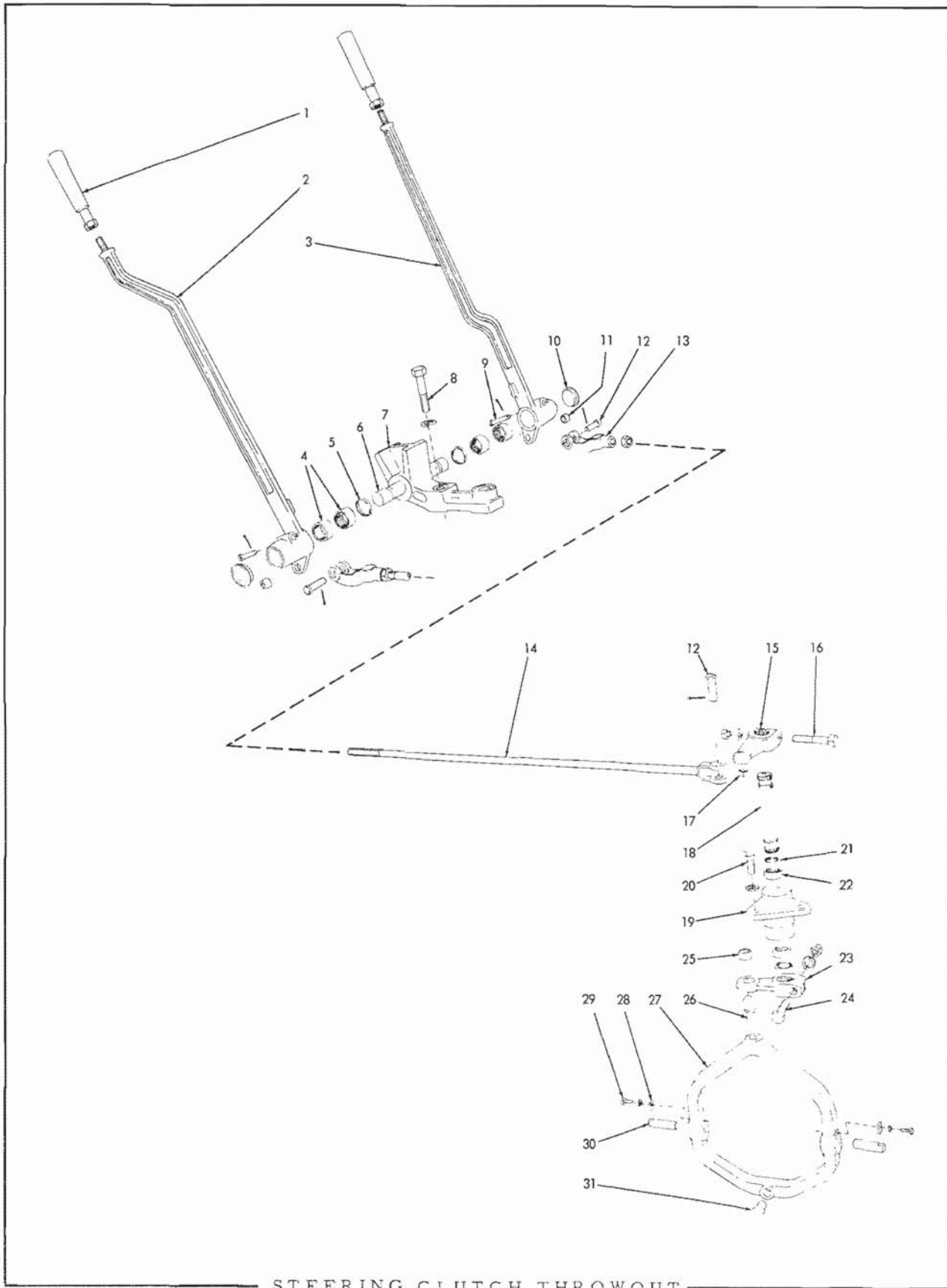

STEERING CLUTCH THROWOUT

BEVEL GEAR AND STEERING CLUTCHES (Continued)

ITEM	PART NUMBER	QTY.	DESCRIPTION	PACKAGE NUMBER
31	060649	2	HUB ASSEMBLY, steering clutch (Consists of 1 hub, 1 ring, 4 screws. Serviced only as a unit)	
32	044478	20	DISC, friction, steering clutch (Raybestos) <sup>1 → 13993</sup> (20) 0573757	
33	041781	20	DISC, friction, steering clutch (steel) (4) 0939967	
34	050218	2	PLATE, pressure, steering clutch	
35	049978	16	CAPSCREW, steering clutch throwout plate (drilled head, 1/2"NC x 3-1/2")	
36	023633	8	WIRE, locking (1/16" x 12")	
37	-----	-	DRUM, brake (See FINAL DRIVE PINION SHAFT)	

STEERING CLUTCH THROWOUT

1	078620	2	GRIP, operating lever
2	088925	1	LEVER ASSEMBLY, operating, left (Includes item 11)
3	088926	1	LEVER ASSEMBLY, operating, right (Includes item 11)
4	051513	4	BEARING, needle, operating lever
5	053926	2	SEAL, dust, operating lever
6	049994	1	SHAFT, pivot, operating levers
7	050287	1	BRACKET ASSEMBLY, operating lever (Includes item 6)
8	031990	2	CAPSCREW, 5/8"NC x 2-1/2"
	904209	2	LOCKWASHER, 5/8"
9	031854	2	PIN, retaining, operating lever
	900942	2	PIN, cotter, 3/32" x 5/8"
10	064942	2	COVER, operating lever
11	049988	2	BUSHING, operating lever (steel)
12	049993	4	PIN, control rod yoke
	900806	4	PIN, cotter, 1/8" x 1"
13	069684	2	YOKE, throwout rod
14	069673	2	ROD, control
	911043	2	NUT, 1/2"NF
15	050309	2	LEVER ASSEMBLY, intermediate, upper (Includes item 17)
16	035068	2	CAPSCREW, 1/2"NF x 2-1/4"
	904208	2	LOCKWASHER, 1/2"
	911043	2	NUT, 1/2"NF
17	049988	2	BUSHING, intermediate upper lever (steel)
18	050311	2	SHAFT, intermediate lever

(Continued)

## STEERING CLUTCH THROWOUT (Continued)

ITEM	PART NUMBER	QTY.	DESCRIPTION	PACKAGE NUMBER
19	050289	2	CAGE, intermediate shaft bearing	
20	035061	6	CAPSCREW, 1/2"NC x 1-1/4"	
	904208	6	LOCKWASHER, 1/2"	
21	053927	4	SEAL, dust, intermediate lever shaft	
22	050442	4	BEARING, needle, intermediate lever shaft	
23	050310	2	LEVER ASSEMBLY, intermediate, lower (Includes item 25)	
24	035068	2	CAPSCREW, 1/2"NF x 2-1/4"	
	904208	2	LOCKWASHER, 1/2"	
	911043	2	NUT, 1/2"NF	
25	050308	2	BUSHING, intermediate lower lever (steel)	
26	035878	2	BALL, throwout yoke	
27	050248	2	YOKE ASSEMBLY, throwout (Includes items 26 and 31)	
28	050221	4	BLOCK, trunnion pin locking	
29	047478	4	CAPSCREW, 1/4"NC x 5/8"	
	904204	4	LOCKWASHER, 1/4"	
30	050222	4	PIN, trunnion	
31	050220	2	PIN, wear, throwout yoke	

