

No. 60 SCRAPER



PARTS Catalog

SERIAL NUMBERS
2W5001 - UP

CATERPILLAR TRACTOR CO.



NO. 60 SCRAPER

HOW TO ORDER PARTS

Please be sure to furnish the quantity, part number and name of each part wanted. It is also important to give the serial number of the machine for which the parts are intended. Location of serial number plates may be determined by referring to the "Specifications" page of this parts catalog. It is suggested that you write the serial number of your machine in this space so that it will be readily available when you need it.

**THIS PARTS CATALOG FOR
MACHINE SERIAL NUMBER**

2W

To insure prompt delivery, please don't overlook furnishing the correct name of the consignee, also the street address, town, county and state to which the parts are to be shipped, and indicate whether shipment is to be made by freight, express, parcel post or by other means.

WHERE TO ORDER PARTS

Caterpillar dealers maintain over 400 stores in the United States, and similar establishments are located strategically in nearly all countries throughout the world. These organizations are backed by the extensive facilities and resources of Caterpillar Tractor Co.

Dealer personnel are factory trained in the stocking and issuing of parts, and large stocks are constantly maintained to insure prompt service. Contact your nearest Caterpillar dealer to make sure that he has your name and address, the correct serial number of your machine, and an accurate list of accessories and attachments. This record will facilitate the issuance of parts when you need them in a hurry.

WHAT THE CATERPILLAR DEALER CAN DO FOR YOU

Caterpillar dealers are in the business of making it economical and profitable for you to own and operate Caterpillar machinery. They are in constant touch with the factory for new developments in repair and maintenance methods, operating procedures, and parts requirements. Their parts stocks are active and up-to-date, including all parts normally required to protect your investment in Caterpillar machinery.

Nearly all Caterpillar dealers offer 24-hour emergency service. For quick reference, write the name and address of the local dealer on your desk pad or the front of your phone book.

ONLY CATERPILLAR PARTS GIVE CATERPILLAR PERFORMANCE

The same quality and craftsmanship that has made Caterpillar products famous throughout the world is built into all Caterpillar replacement parts.

REVISION PUBLISHED OCTOBER 1956

FRANÇAIS

REDACTION DES COMMANDES DE PIÈCES. Pour chaque pièce, indiquer la quantité, le numéro et la désignation. Le numéro de série de la machine à laquelle les pièces sont destinées est également indispensable. Nous vous conseillons d'inscrire le numéro de série de votre machine à la première page de ce catalogue, dans l'espace réservé à cet effet, de façon à le trouver facilement en toutes circonstances.

Pour obtenir une livraison rapide, nous vous prions d'indiquer très exactement le nom du destinataire et son adresse complète: rue, numéro, ville, département, en stipulant, par exemple: petite ou grande vitesse, colis postal, ou tout autre mode d'expédition.

PASSATION DES COMMANDES. Le réseau des Distributeurs Caterpillar couvre le monde entier avec ateliers et dépôts dans la plupart des grands centres. Toute cette organisation repose, en outre, sur l'expérience et les moyens techniques de la Caterpillar Tractor Co.

Les Distributeurs Caterpillar disposent d'un personnel formé à l'usine, parfaitement au courant de tous les problèmes que soulèvent le stockage et la distribution de pièces de rechange. On trouve toujours chez eux un assortiment complet de pièces, ce qui leur permet de servir rapidement les usagers. Mettez-vous en rapport avec le Distributeur Caterpillar le plus proche, assurez-vous qu'il connaît votre nom et votre adresse, le numéro de série de votre machine et les accessoires qui l'équipent. Ces renseignements lui seront utiles, surtout pour les dépannages urgents.

DISTRIBUTEURS CATERPILLAR. Les Distributeurs Caterpillar sont au service de l'usager pour lui faciliter la parfaite utilisation de son matériel. Par leurs rapports constants avec l'usine, ils sont toujours au courant des toutes dernières méthodes de réparation, d'entretien, d'emploi du matériel et de remplacement des pièces. Ils veillent, en particulier, à ce que leur stock de pièces réponde par sa composition aux besoins éventuels de tous les propriétaires de matériel Caterpillar, quel que soit l'âge de leur machine, pour réduire au strict minimum les arrêts toujours très coûteux.

Presque tous nos Distributeurs ont une permanence de jour et de nuit pour les appels urgents. Afin d'éviter toute perte de temps, ayez toujours à portée de la main le nom et l'adresse de votre Distributeur Caterpillar.

RIEN NE SAURAIT SE SUBSTITUER A LA PIÈCE AUTHENTIQUE CATERPILLAR. La qualité et la construction soignée qui ont fait la réputation mondiale du matériel Caterpillar se retrouvent dans toutes les pièces d'origine.

ITALIANO

MODO DI ORDINARE LE PARTI DI RICAMBIO. Vi preghiamo di indicare con precisione la quantità, il numero e la denominazione di ogni parte richiesta. È altresì importante precisare il numero di serie della macchina sulla quale dovrà essere montata la parte. Vi consigliamo di scrivere il numero di serie della Vostra macchina nello spazio predisposto a questo scopo nella prima pagina di questo catalogo parti.

Per assicurare la pronta consegna, vi preghiamo di non mancare di fornire il nome del destinatario, correttamente scritto, come pure l'indirizzo, cioè la strada, la città, la provincia e lo stato dove le parti dovranno essere spedite, indicando se la spedizione dovrà essere effettuata per ferrovia, per mare, per espresso, per pacco postale o per altro mezzo.

DOVE SI ORDINANO LE PARTI. I vari Distributori CATERPILLAR hanno organizzato oltre 400 depositi di parti di ricambio negli Stati Uniti e simili depositi si trovano convenientemente situati in quasi tutti i paesi del mondo. Questi depositi usufruiscono del vantaggio delle adeguate facilitazioni e delle forti risorse della CATERPILLAR TRACTOR CO. Il personale dei Distributori viene istruito nella fabbrica per il mantenimento degli assortimenti e per la consegna delle parti. I vari depositi continuano a rifornire per assicurare la pronta consegna. Mettetevi in comunicazione con il Distributore CATERPILLAR più vicino a Voi ed assicuratevi che egli abbia il vostro nome e l'indirizzo, l'esatto numero di serie della Vostra macchina ed una larga disponibilità di accessori vari. In questa maniera faciliterete la consegna delle parti quando ne avrete urgente necessità.

CIÒ CHE PUÒ FARE PER VOI IL DISTRIBUTORE CATERPILLAR. I Distributori CATERPILLAR hanno principalmente lo scopo di rendere economico e vantaggioso per Voi il possesso e l'uso dei macchinari CATERPILLAR. Essi sono costantemente in comunicazione con la fabbrica e perciò al corrente dei miglioramenti introdotti nei sistemi di riparazione, di manutenzione e di impiego delle macchine, nonché nella richiesta di parti di ricambio.

I loro assortimenti sono efficienti e continuamente aggiornati. Essi comprendono tutti i pezzi che normalmente sono richiesti per garantire il capitale da Voi impiegato in macchinari CATERPILLAR.

Quasi tutti i Distributori CATERPILLAR offrono giorno e notte servizio per casi urgenti.

Per rapidità di riferimento, segnate il nome e l'indirizzo del Vostro rivenditore locale sulla rubrica della Vostra scrivania o nella testata della vostra guida telefonica.

SOLTANTO LE PARTI CATERPILLAR GARANTISCONO LA FAMA DELLA MARCA CATERPILLAR. Le parti di ricambio CATERPILLAR vengono costruite con i materiali e con i sistemi di lavorazione che hanno reso famosi in tutto il mondo i prodotti CATERPILLAR.

DEUTSCH

WIE MAN ERSATZTEILE BESTELLT. Bitte übersehen Sie nicht, bei jedem Ersatzteilposten die Anzahl, Nummer und Bezeichnung genau anzugeben. Ebenso wichtig ist es, die Seriennummer der Maschine aufzuführen, auf die die Teile passen sollen. Wir möchten Ihnen empfehlen, diese Seriennummer in dem dafür vorgesehenen Reckthek auf der ersten Seite dieses Katalogs einzutragen, damit sie stets schnell zu finden ist.

Um alle Zeitverluste bei der Lieferung zu vermeiden, ist es ratsam, den vollen Namen, sowie den Staat, das Land, die Stadt, die Straße und die Hausnummer des jeweiligen Empfängers genau anzugeben, wobei am besten auch die Verschiffungsart (Fracht, Eilgut, Postpaket, usw.) ausdrücklich vorzuschreiben ist.

WO MAN ERSATZTEILE BESTELLT. In fast allen Ländern der Welt bestehen Caterpillar-Vertretungen. Diese Firmen stehen in enger Fühlung mit der Hauptfabrik, bei der sie in vielen Fragen Rat und weitgehende Unterstützung finden.

Zwecks prompter Belieferung der Kundschaft aus ihren gut eingerichteten Ersatzteillagern verfügen diese Vertretungen über ein zahlreiches Personal, das in der Fabrik Schulung im Lagern und Auslagern von Ersatzteilen erhalten hat. Es liegt in Ihrer Interesse, sich zu vergewissern, daß Ihre Anschrift, die Seriennummern und eine vollständige Beschreibung Ihrer Maschine, einschließlich allem Zubehör und Zusatzapparaten bei Ihrer zuständigen Vertretung vorliegen, so daß Rückfragen sich erübrigen, falls dringende Bestellungen beschleunigt bearbeitet werden müssen.

AUFGABE DER CATERPILLAR-VERTRETUNG. Es ist die Aufgabe der Caterpillar-Vertretung, dafür zu sorgen, daß es für Sie vorteilhaft und einträglich ist, unser Gerät zu erwerben und damit zu arbeiten. Durch ihre Verbindung mit der Zentrale kennt sie stets die neuesten Methoden, solche Maschinen zu benutzen, instand zu halten und zu reparieren, sowie die Einzelteile, die dazu erforderlich sind. Ihr modernes Lager entspricht dem vorausberechneten Bedarf ihrer Kundschaft, wobei besonderer Nachdruck auf die Teile gelegt wird, die sich erfahrungsgemäß schneller abnutzen. So ist sie in der Lage, diese Produktionsmittel in arbeitsfähigem Zustand zu erhalten und das in ihnen investierte Kapital vor Verlusten zu bewahren.

Bei fast allen Caterpillar-Vertretungen besteht ein Notdienst, Tag und Nacht. Um die Anschrift und Telefonnummer der nächsten Zweigstelle an der Hand zu haben, empfiehlt es sich, sie vorn auf Ihrem Adreß- oder Telefonbuch zu vermerken.

WIR WARNEN VOR NACHAHMUNGEN. Die Qualität und Werkerbeit, die den Welttruf der Caterpillar-Geräte begründet haben, findet man nur bei unseren Original-Ersatzteilen.

ESPAÑOL

COMO PEDIR PIEZAS DE REPUESTO. Es necesario indicar la cantidad, el número y el nombre de las piezas que se desean. Es también importante dar el número de serie de la máquina para la cual se desean las piezas. Se sugiere que usted anote este número de serie de su máquina en el espacio que se ha dejado en la primera página, de manera que lo tenga siempre a mano cuando lo necesite.

Para que el despacho se efectúe con prontitud, es necesario que se dé el nombre correcto del consignatario, así como la dirección, además de los nombres de la provincia, y departamento o estado a que han de enviarse las piezas. Asimismo, debe especificarse el medio a utilizarse, si debe ser hecho como carga, o por expreso, paquete postal o en otra forma.

DONDE PEDIR LAS PIEZAS. Hay más de 400 establecimientos de los Distribuidores CATERPILLAR en los Estados Unidos, y en casi todo el mundo, existen otros, similares, estratégicamente ubicados. Estos establecimientos están respaldados por las extensas facilidades y recursos de Caterpillar Tractor Co.

El personal de los Distribuidores ha recibido su entrenamiento en la fábrica, en el almacenamiento y despacho de partes. Mantienen, además, grandes existencias de partes para asegurar un servicio rápido. Póngase en contacto con su Distribuidor CATERPILLAR para asegurarse de que tiene su nombre y dirección, el número de serie correcto de su máquina y una lista exacta de partes y accesorios. Este registro facilitará el despacho de partes cuando usted las necesite con urgencia.

LO QUE EL DISTRIBUIDOR CATERPILLAR PUEDE HACER POR USTED. Los Distribuidores tienen como objetivo el hacer económico y provechoso para usted poseer y trabajar maquinaria CATERPILLAR. Ellos están en contacto permanente con la fábrica para tener los últimos adelantos en los métodos de reparación y mantenimiento, procedimientos de trabajo y requerimientos de partes. Sus existencias de partes tienen gran movimiento y están siempre al día, incluyendo todas las partes normalmente requeridas para proteger su inversión en maquinaria CATERPILLAR.

Casi todos los Distribuidores ofrecen servicio de emergencia de día y de noche. Para referencia rápida, escriba el nombre y dirección de su Distribuidor local en la carpeta de su escritorio o en la tapa de su libro de teléfono.

SOLO LAS PIEZAS CATERPILLAR DAN EL RESULTADO APETECIDO. Todas las piezas CATERPILLAR han sido fabricadas según el patrón de alta calidad y mano de obra que ha hecho famosos los productos CATERPILLAR.

PORTUGUÉS

COMO FAZER OS PEDIDOS DE PEÇAS. Ponha no pedido a quantidade, o número e o nome de cada peça desejada. É também preciso pôr-se o número de série da máquina para a qual a peça se destina. Escreva o número de série de sua máquina no espaço para o mesmo reservado na página No. 1, para tê-lo à mão quando o precisar.

Para garantir pronta remessa não deixe de pôr o nome correto do consignatário bem como da rua, cidade, estado e país para onde as peças devem ser despachadas, indicando se o despacho deve ser feito como carga regular, encomenda postal via marítima ou aérea (regular ou expresso) ou qualquer outro modo.

PARA ONDE DIRIGIR OS PEDIDOS DE PEÇAS. Os distribuidores "Caterpillar" mantêm mais de 400 estabelecimentos comerciais nos Estados Unidos e em localizações estrategicamente espalhadas por quase todos os países do mundo. Todas essas organizações contam com o apoio e cooperação de Caterpillar Tractor Co.

Os distribuidores mantêm, sempre, grande estoque de peças para servir os clientes com presteza. E seu pessoal, treinado na fábrica, sabe como lidar com peças. Comuniquese com o distribuidor "Caterpillar" mais próximo para se certificar se ele tem seu nome e endereço, o exato número de série de sua máquina e uma lista de seus equipamentos e acessórios. O registro desses dados facilitará a remessa de peças quando as pedir com urgência.

O QUE O DISTRIBUIDOR "CATERPILLAR" PODE FAZER PARA LHE SERVIR. Nossos distribuidores têm interesse em tornar econômica e lucrativa a posse e o uso de nossas máquinas. Mantendo constante contato com a fábrica, estão sempre bem informados sobre os métodos mais modernos empregados para manobrá-las, conservá-las e repará-las, bem como sobre tudo que se refere a peças de substituição. Têm em estoque, peças para qualquer máquina existente no território a seu cargo e em quantidade suficiente para evitar que as máquinas fiquem paradas.

Quase todos os distribuidores "Caterpillar" têm serviço mecânico de emergência aberto dia e noite. Para uma rápida referência, escreva o nome e o endereço do seu distribuidor no bloco de notas de sua escrivaninha ou na sua lista de telefone.

PEÇAS "CATERPILLAR" SÃO AS ÚNICAS RECOMENDÁVEIS. As peças "Caterpillar" são feitas conforme o padrão de alta qualidade e a técnica de fabricação que tornaram os produtos "Caterpillar" famosos em todo o mundo.

INDEX

Name	Page
Apron	24
Axle	6
Bowl	12
Cable Cutter	27
Cables	23
Ejector	25
Frame—Draft	10
Numerical Parts Index	30
Pole	6
Specifications	32
Tires & Flanges	26
Tools	28
Transfers	28
Wheel and Axle—Front	9
Wheel and Axle—Rear	22

INDEX ALPHABÉTIQUE

Désignation	Page
Benne	12
Câbles	23
Caractéristiques	32
Châssis oscillant	10
Cisaille à câble	27
Ejecteur	25
Essieu	6
Index Numérique des Pièces	30
Instructions sur décalcomanies	28
Outillage	28
Pneumatiques et cercles de retenue	26
Roue et essieu (arrière)	22
Roue et essieu (avant)	9
Tablier	24
Timon	6

INDICE

Nombre	Página
Bastidor de tiro	10
Cables	23
Caja	12
Calcomanías	28
Compuerta	24
Cortador de cable	27
Eje	6
Especificaciones	32
Eyector	25
Herramientas	28
Índice Numérico de Partes	30
Neumáticos y anillos	26
Rueda y eje delanteros	9
Rueda y eje traseros	22
Vara	6

ÍNDICE

Nomenclatura	Página
Armação tratora	10
Avental	24
Cabos	23
Caçamba	12
Corta-cabo	27
Decalcomanias	28
Eixo	6
Ejetor	25
Especificações	32
Ferramentas	28
Índice Numérico de Peças	30
Lança	6
Pneus e flanges	26
Roda e eixo dianteiros	9
Roda e eixo traseiros	22

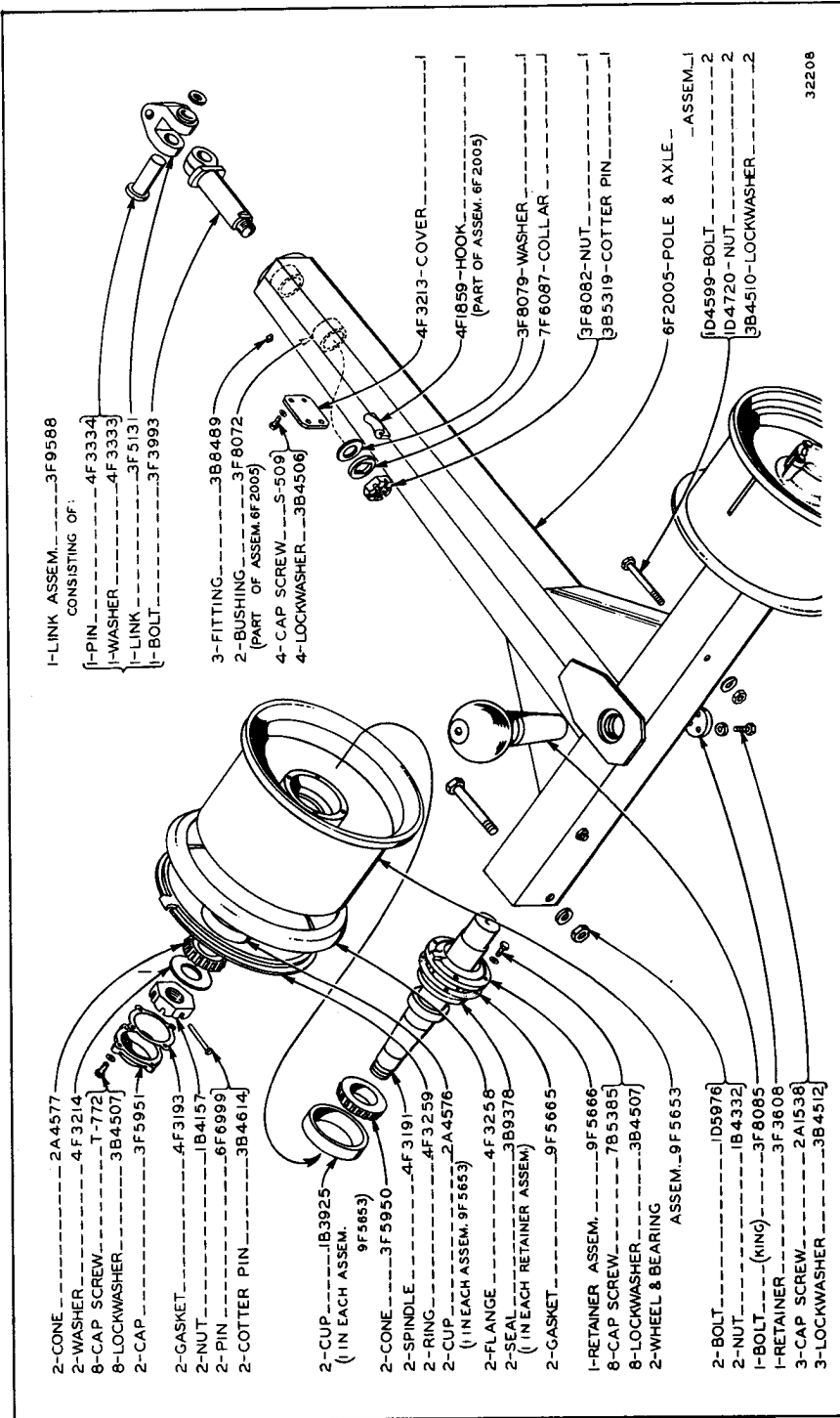

POLE AND AXLE
 Serial No. 2W5001 to 2W5259 inclusive

ALWAYS GIVE SERIAL NUMBER WHEN ORDERING PARTS

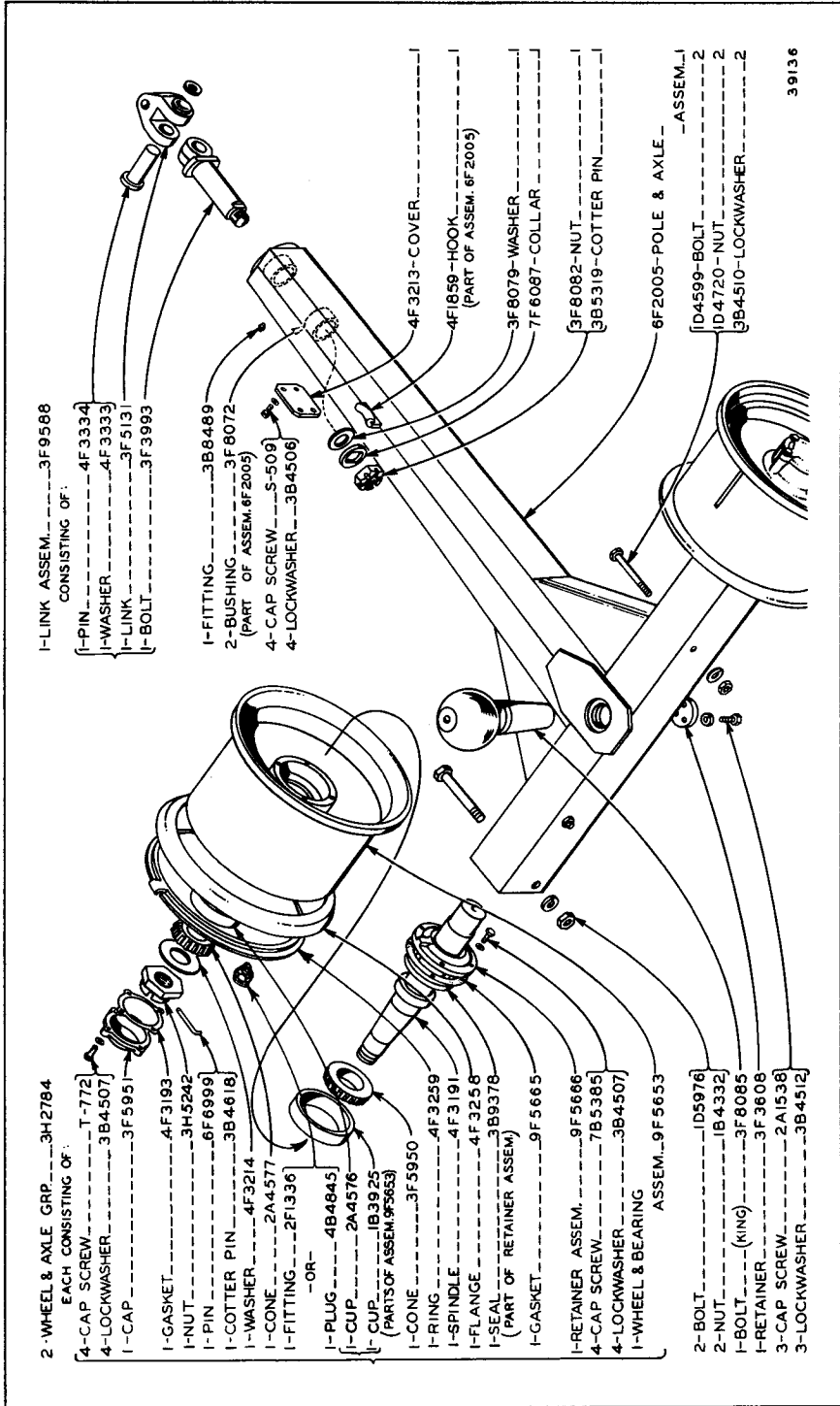

39136

POLE AND AXLE
Serial No. 2W5260 to 2W5443 inclusive

ONLY "CATERPILLAR" PARTS GIVE "CATERPILLAR" PERFORMANCE

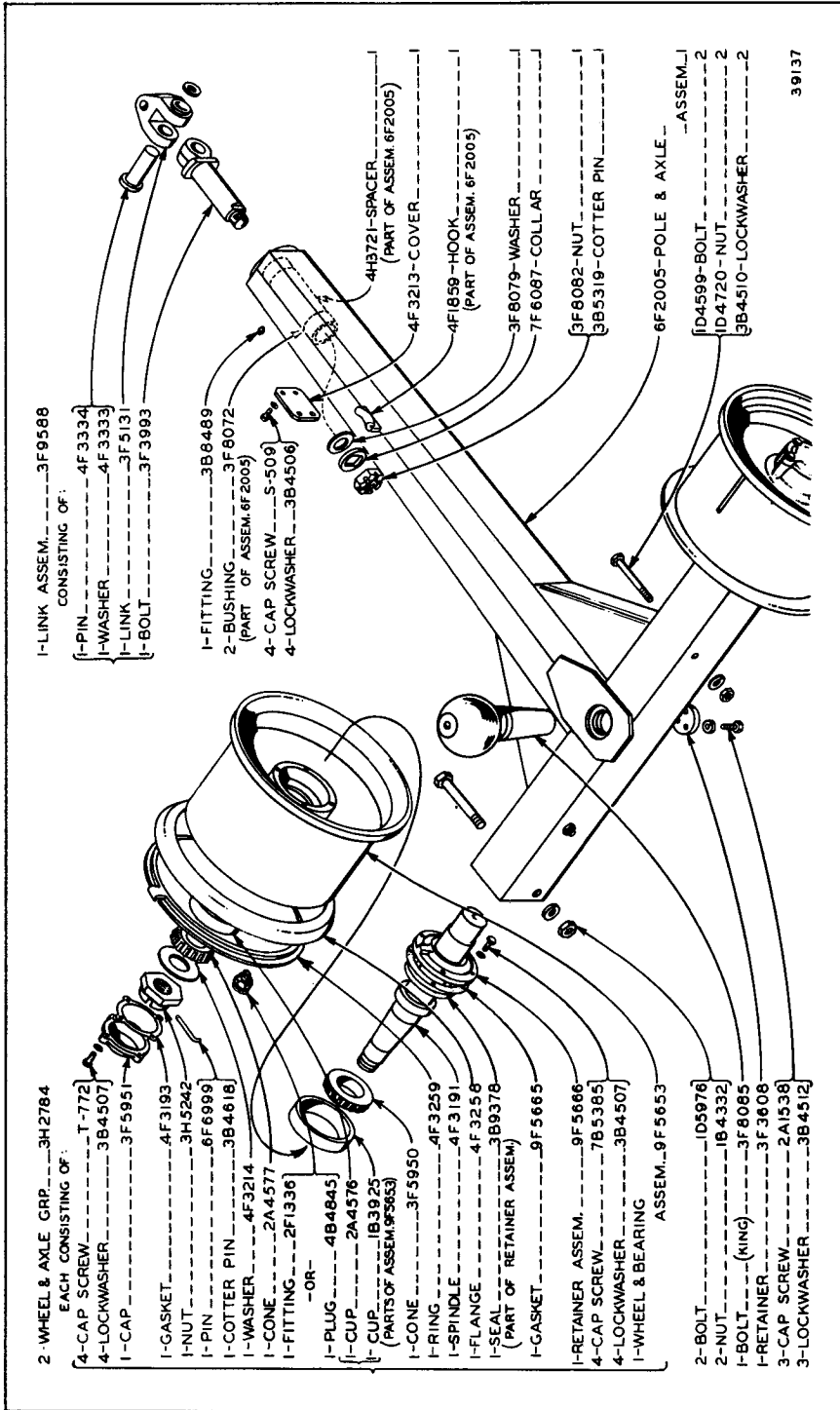

POLE AND AXLE
Serial No. 2W5444 to 2W5748 inclusive

ALWAYS GIVE SERIAL NUMBER WHEN ORDERING PARTS

NO. 60 SCRAPER - FORM 32383 - BETWEEN PAGES 8 & 9

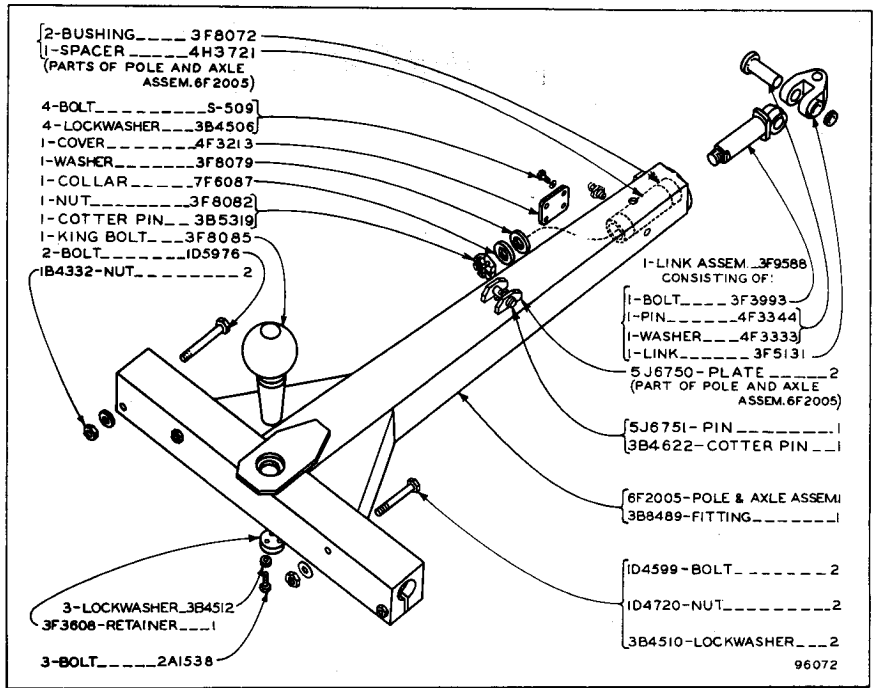

POLE AND AXLE
 Effective with Serial No. 2W6432

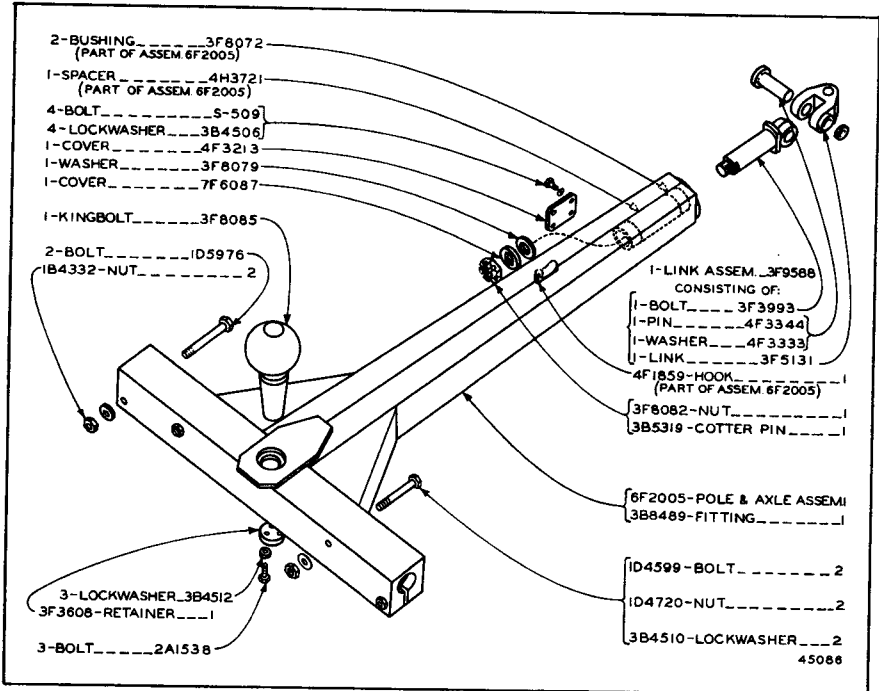

POLE AND AXLE
Effective with Serial No. 2W5749

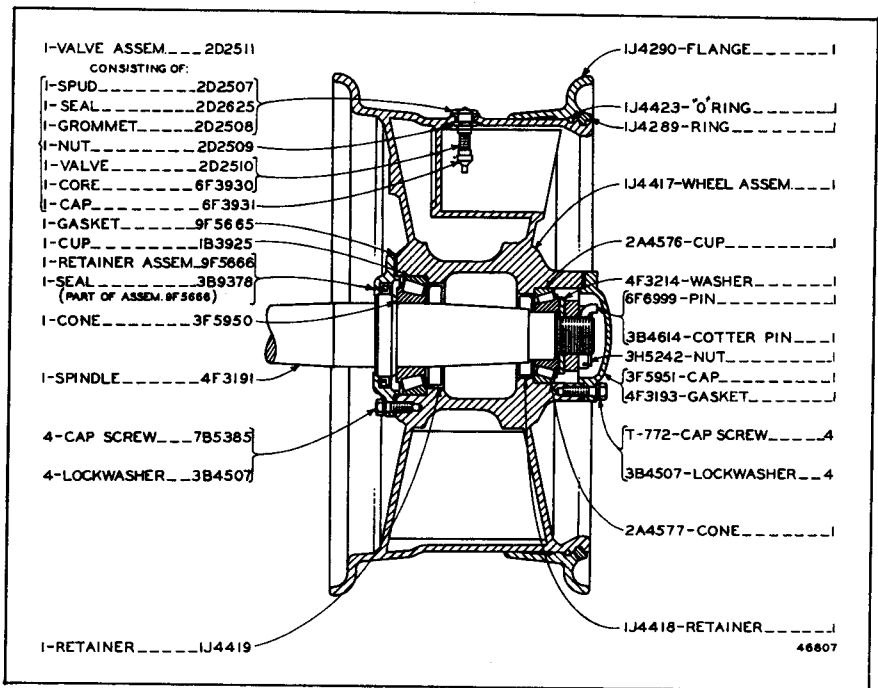

FRONT WHEEL AND AXLE (2 Groups Req'd.)
Effective with Serial No. 2W5749

ONLY "CATERPILLAR" PARTS GIVE "CATERPILLAR" PERFORMANCE

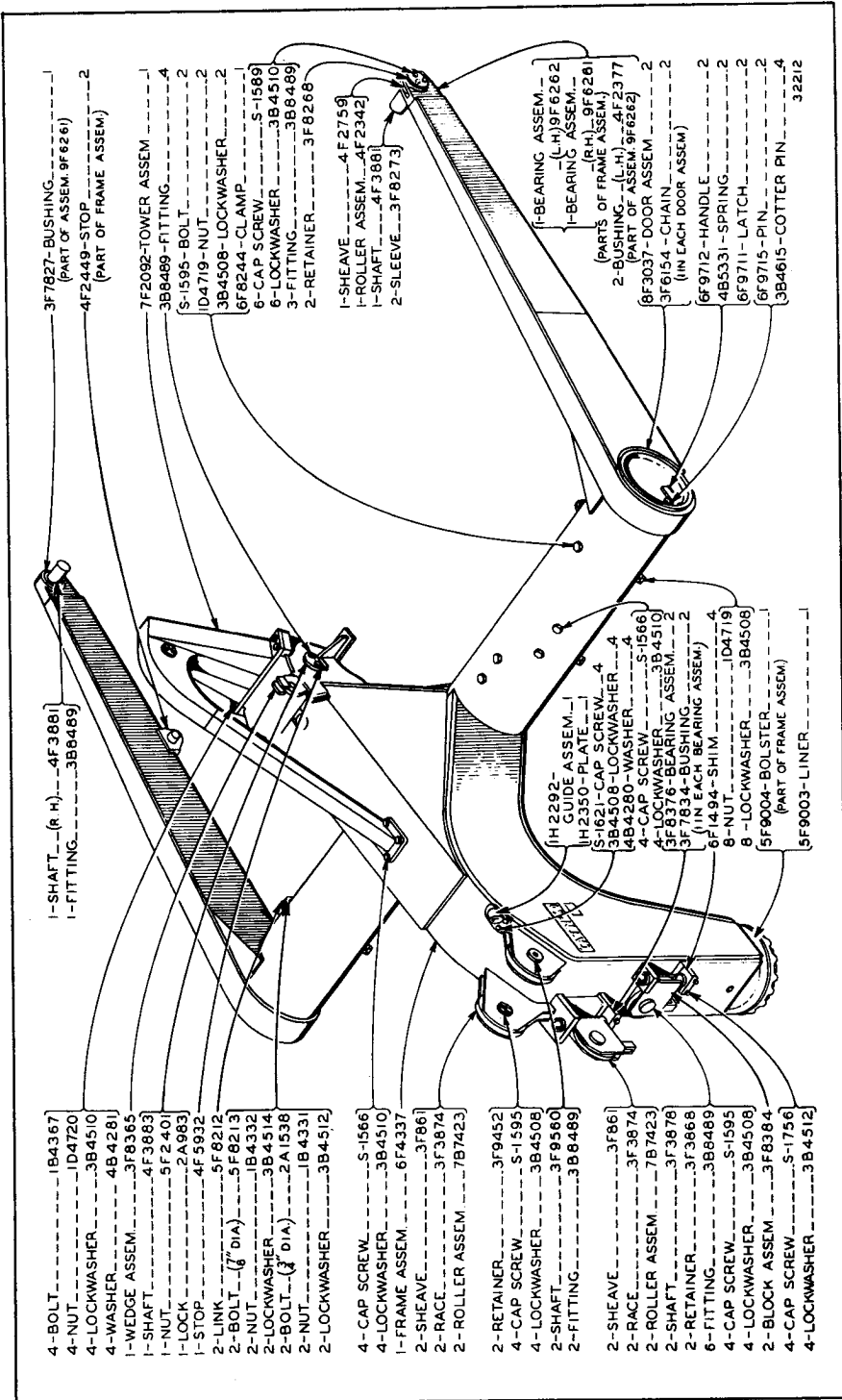

DRAFT FRAME—Part One

ALWAYS GIVE SERIAL NUMBER WHEN ORDERING PARTS

NO. 60 SCRAPER---FORM 32383---INSERT BETWEEN PAGES 10 & 11

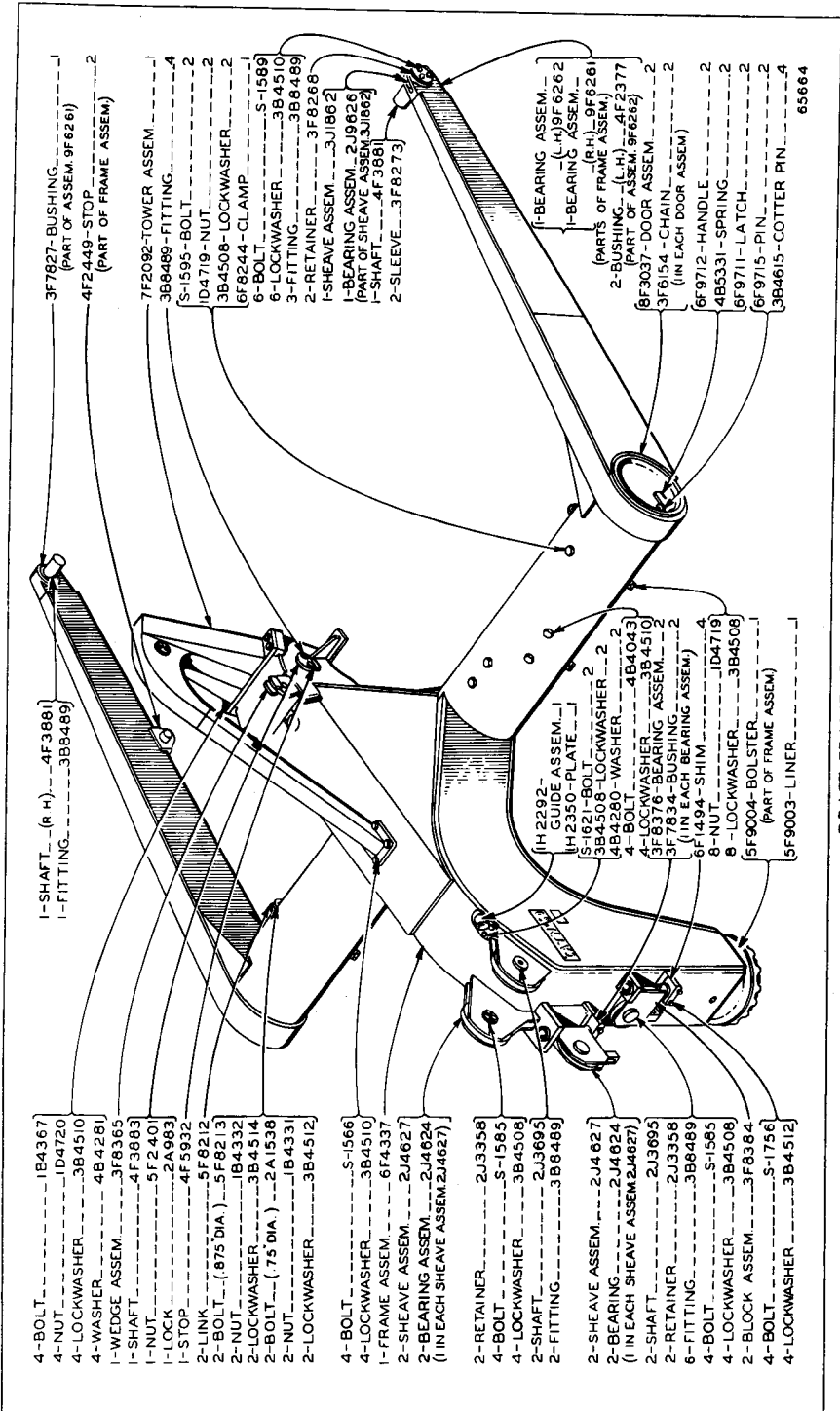

- 4-BOLT-----1B4367
- 4-NUT-----1D4720
- 4-LOCKWASHER-----3B4510
- 4-WASHER-----4B4281
- 1-WEDGE ASSEM.-----3F6365
- 1-SHAFT-----4F3883
- 1-NUT-----5F2401
- 1-LOCK-----2A983
- 1-STOP-----4F5932
- 2-LINK-----5F6212
- 2-BOLT--(.875 DIA.)-----5F8213
- 2-NUT-----1B4332
- 2-LOCKWASHER-----3B4514
- 2-BOLT--(.75 DIA.)-----2A1536
- 2-NUT-----1B4331
- 2-LOCKWASHER-----3B4512

- 4-BOLT-----S-1566
- 4-LOCKWASHER-----3B4510
- 1-FRAME ASSEM.-----6F4337
- 2-SHEAVE ASSEM.-----2J4627
- 2-BEARING ASSEM.-----2J4624
(1 IN EACH SHEAVE ASSEM.2J4627)

- 2-RETAINER-----2J3358
- 4-BOLT-----S-1566
- 4-LOCKWASHER-----3B4508
- 2-SHAFT-----2J3695
- 2-FITTING-----3B8489

- 2-SHEAVE ASSEM.-----2J4627
- 2-BEARING-----2J4624
(1 IN EACH SHEAVE ASSEM.2J4627)
- 2-SHAFT-----2J3695
- 2-RETAINER-----2J3358
- 6-FITTING-----3B8489
- 4-BOLT-----S-1585
- 4-LOCKWASHER-----3B4508
- 2-BLOCK ASSEM.-----3F8384
- 4-BOLT-----S-1756
- 4-LOCKWASHER-----3B4512

- 1-SHAFT--(R.H.)-----4F3881
- 1-FITTING-----3B8489
- 3F7827-BUSHING-----
(PART OF ASSEM.9F6261)
- 4F2449-STOP-----2
(PART OF FRAME ASSEM.)

- 7F2092-TOWER ASSEM
- 3B8489-FITTING-----4
- S-1595-BOLT-----2
- 1D4719-NUT-----2
- 3B4508-LOCKWASHER-----2
- 6F6244-CLAMP-----2
- 6-BOLT-----S-1589
- 6-LOCKWASHER-----3B4510
- 3-FITTING-----3B8489
- 2-RETAINER-----3F8268
- 1-SHEAVE ASSEM.-----3J1862
- 1-BEARING ASSEM.-----2J9626
(PART OF SHEAVE ASSEM.3J1862)
- 1-SHAFT-----4F3861
- 2-SLEEVE-----3F8273

- 1-BEARING ASSEM.-----
(L.H.)9F6262
- 1-BEARING ASSEM.-----
(R.H.)9F6261
- (PARTS OF FRAME ASSEM.)
- 2-BUSHING--(L.H.)-----4F2377
(PART OF ASSEM.9F6262)
- 3F6154-CHAIN-----2
(IN EACH DOOR ASSEM.)
- 6F9712-HANDLE-----2
- 4B5331-SPRING-----2
- 6F9711-LATCH-----2
- 6F9715-PIN-----2
- 3B4615-COTTER PIN-----4

DRAFT FRAME---Part One

Effective with Serial No. 2W6226

Additional parts are shown on reverse side of this insert. See Notice of Improved Parts No. 379

65664

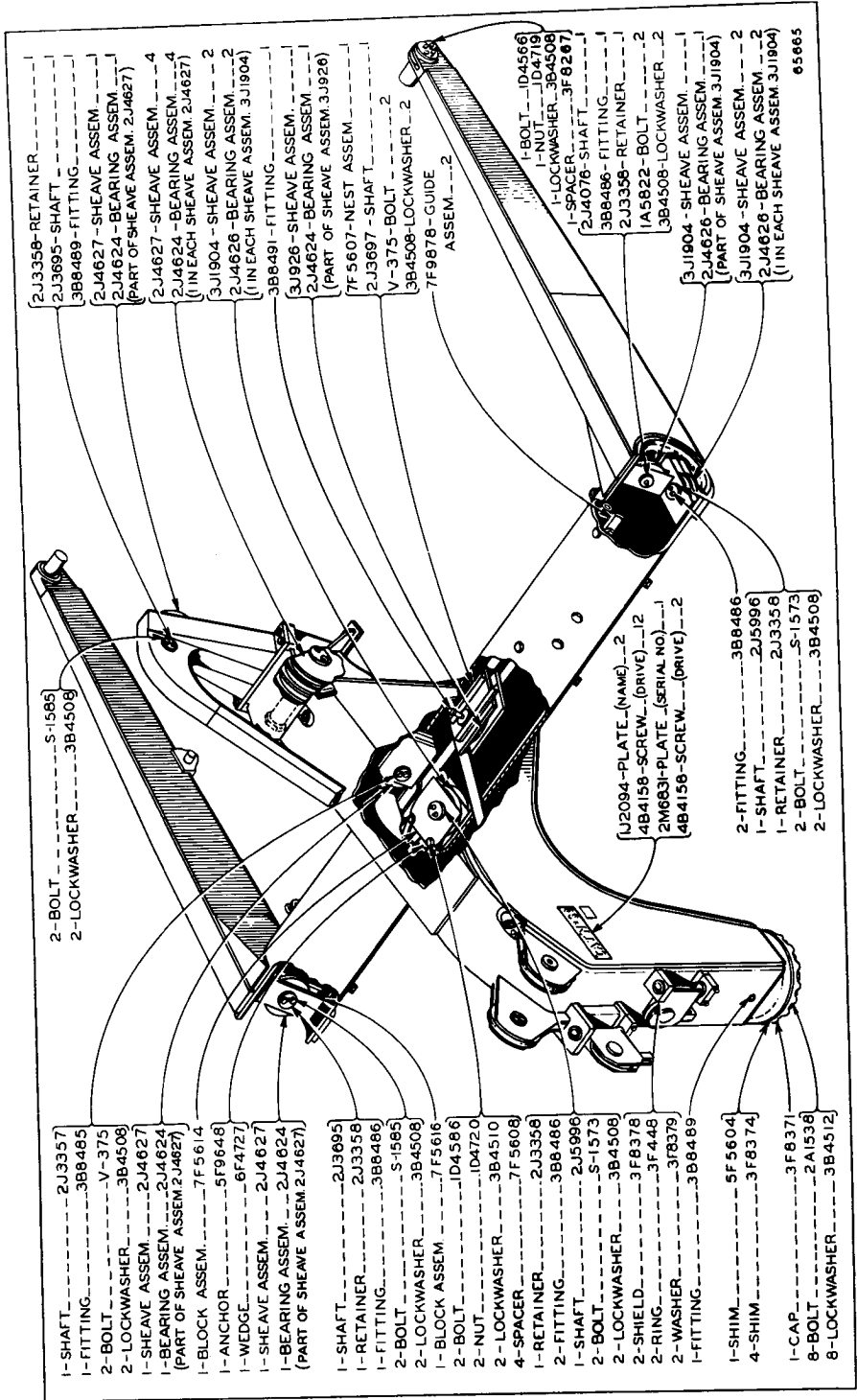

- 1-SHAFT.....2J3357
- 1-FITTING.....3B8485
- 2-BOLT.....V-375
- 2-LOCKWASHER.....3B4508
- 1-SHEAVE ASSEM.....2J4627
- 1-BEARING ASSEM.....2J4624
- (PART OF SHEAVE ASSEM 2J4627)
- 1-BLOCK ASSEM.....7F5614
- 1-ANCHOR.....5F9648
- 1-WEDGE.....6F4727
- 1-SHEAVE ASSEM.....2J4627
- 1-BEARING ASSEM.....2J4624
- (PART OF SHEAVE ASSEM 2J4627)
- 1-SHAFT.....2J3695
- 1-RETAINER.....2J3358
- 1-FITTING.....3B8486
- 2-BOLT.....S-1585
- 2-LOCKWASHER.....3B4508
- 1-BLOCK ASSEM.....7F5616
- 2-BOLT.....ID4566
- 2-NUT.....ID4720
- 2-LOCKWASHER.....3B4510
- 4-SPACER.....7F5608
- 1-RETAINER.....2J3358
- 2-FITTING.....3B8486
- 1-SHAFT.....2J5996
- 2-BOLT.....S-1573
- 2-LOCKWASHER.....3B4508
- 2-SHIELD.....3F8378
- 2-RING.....3F448
- 2-WASHER.....3F8379
- 1-FITTING.....3B8489
- 1-SHIM.....5F5604
- 4-SHIM.....3F8374
- 1-CAP.....3F8371
- 8-BOLT.....2A1536
- 8-LOCKWASHER.....3B4512
- 2-BOLT.....S-1585
- 2-LOCKWASHER.....3B4508
- 2-FITTING.....3B8486
- 1-SHAFT.....2J5996
- 1-RETAINER.....2J3358
- 2-BOLT.....S-1573
- 2-LOCKWASHER.....3B4508
- (J2094-PLATE_(NAME)_2
- 4B4158-SCREW_(DRIVE)_12
- 2M6831-PLATE_(SERIAL NO)_1
- 4B4158-SCREW_(DRIVE)_2
- 2-FITTING.....3B8486
- 1-RETAINER.....2J3358
- 2-BOLT.....S-1573
- 2-LOCKWASHER.....3B4508
- 2J3358-RETAINER
- IA5822-BOLT.....2
- 3B8486-FITTING
- 2J4076-SHAFT.....2
- 1-SPACER.....3F8287
- 1-LOCKWASHER.....3B4508
- 1-NUT.....ID4719
- 1-BOLT.....ID4566
- 3B4508-LOCKWASHER.....2
- 3J1904-SHEAVE ASSEM.....1
- 2J4626-BEARING ASSEM.....2
- (PART OF SHEAVE ASSEM 3J1904)
- 3J1904-SHEAVE ASSEM.....2
- 2J4626-BEARING ASSEM.....2
- (IN EACH SHEAVE ASSEM 3J1904)
- 3B8491-FITTING
- 3J926-SHEAVE ASSEM.....1
- 2J4624-BEARING ASSEM.....1
- (PART OF SHEAVE ASSEM 3J926)
- 7F5607-NEST ASSEM.....1
- 2J3697-SHAFT.....2
- V-375-BOLT
- 3B4508-LOCKWASHER.....2
- 7F9878-GUIDE ASSEM.....2
- 2J3358-RETAINER
- 3B8486-FITTING
- 2J4076-SHAFT.....2
- 1-LOCKWASHER.....3B4508
- 1-NUT.....ID4566
- 1-BOLT.....ID4719
- 3B4508-LOCKWASHER.....2
- 2J4626-BEARING ASSEM.....2
- (PART OF SHEAVE ASSEM 3J1904)
- 3J1904-SHEAVE ASSEM.....2
- 2J4626-BEARING ASSEM.....2
- (IN EACH SHEAVE ASSEM 3J1904)

DRAFT FRAME—Part Two
Effective with Serial No. 2W6226

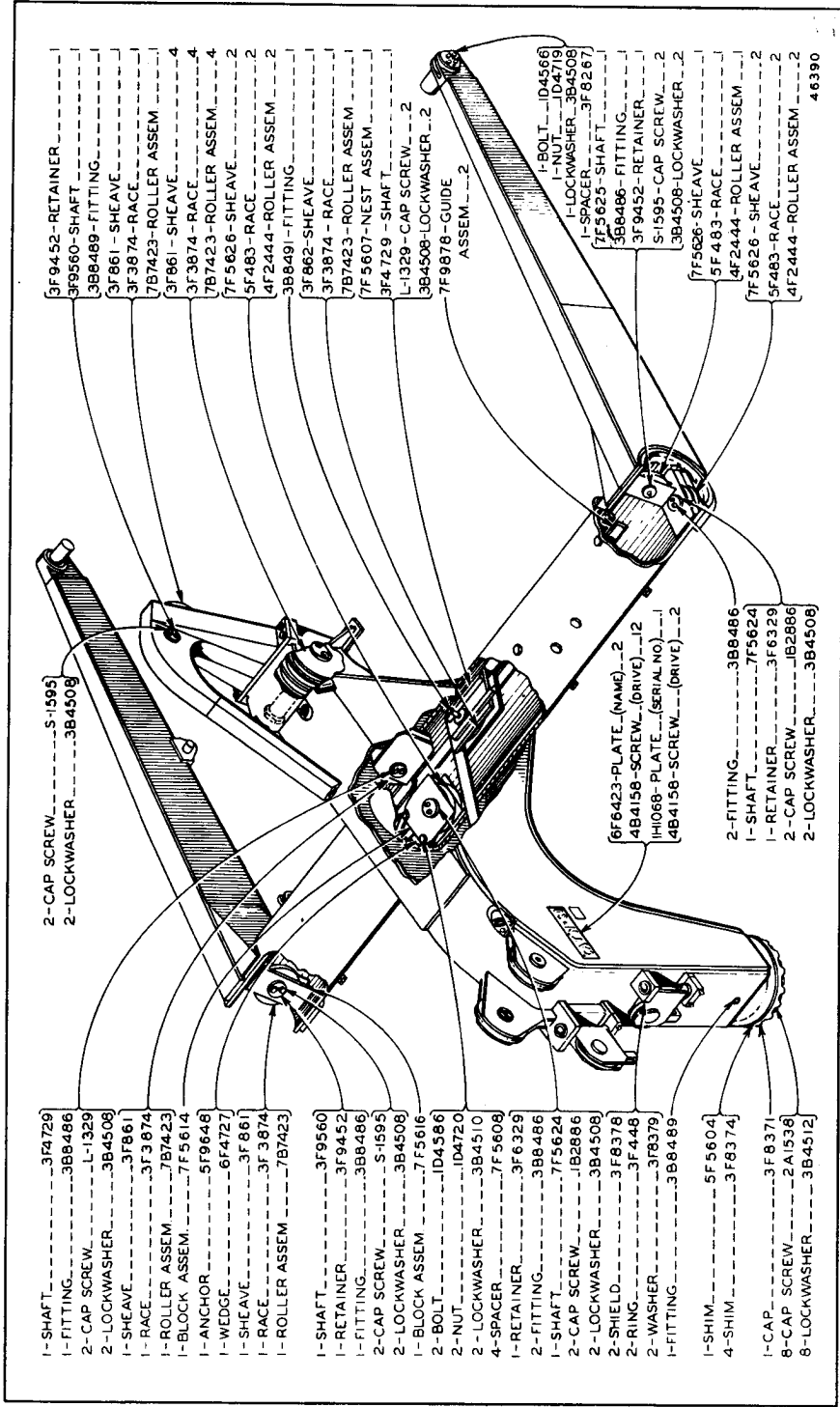

- 3F9452-RETAINER
- 3F9560-SHAFT
- 3B8489-FITTING
- 3F861-SHEAVE
- 3F3874-RACE
- 7B7423-ROLLER ASSEM
- 3F861-SHEAVE
- 3F3874-RACE
- 7B7423-ROLLER ASSEM
- 7F5626-SHEAVE
- 5F483-RACE
- 4F2444-ROLLER ASSEM
- 3B8491-FITTING
- 3F862-SHEAVE
- 3F3874-RACE
- 7B7423-ROLLER ASSEM
- 7F5607-NEST ASSEM
- 3F4729-SHAFT
- L1329-CAP SCREW
- 3B4508-LOCKWASHER
- 7F9878-GUIDE ASSEM
- 1-BOLT
- 1-NUT
- 1-LOCKWASHER
- 1-SPACER
- 7F5625-SHAFT
- 3B8486-FITTING
- 3F9452-RETAINER
- S1595-CAP SCREW
- 3B4508-LOCKWASHER
- 7F5626-SHEAVE
- 5F483-RACE
- 4F2444-ROLLER ASSEM

- 2-CAP SCREW
- 2-LOCKWASHER

- 6F6423-PLATE
- 4B4158-SCREW
- IH068-PLATE
- 4B4158-SCREW
- 2-FITTING
- 1-SHAFT
- 1-RETAINER
- 2-CAP SCREW
- 2-LOCKWASHER

- 1-SHAFT
- 1-FITTING
- 2-CAP SCREW
- 2-LOCKWASHER
- 1-SHEAVE
- 1-RACE
- 1-ROLLER ASSEM
- 1-BLOCK ASSEM
- 1-ANCHOR
- 1-WEDGE
- 1-SHEAVE
- 1-RACE
- 1-ROLLER ASSEM
- 1-SHAFT
- 1-RETAINER
- 1-FITTING
- 2-CAP SCREW
- 2-LOCKWASHER
- 1-BLOCK ASSEM
- 2-BOLT
- 2-NUT
- 2-LOCKWASHER
- 4-SPACER
- 1-RETAINER
- 2-FITTING
- 1-SHAFT
- 2-CAP SCREW
- 2-LOCKWASHER
- 2-SHIELD
- 2-RING
- 2-WASHER
- 1-FITTING
- 1-SHM
- 4-SHM
- 1-CAP SCREW
- 8-LOCKWASHER

DRAFT FRAME—Part Two

46390

ONLY "CATERPILLAR" PARTS GIVE "CATERPILLAR" PERFORMANCE

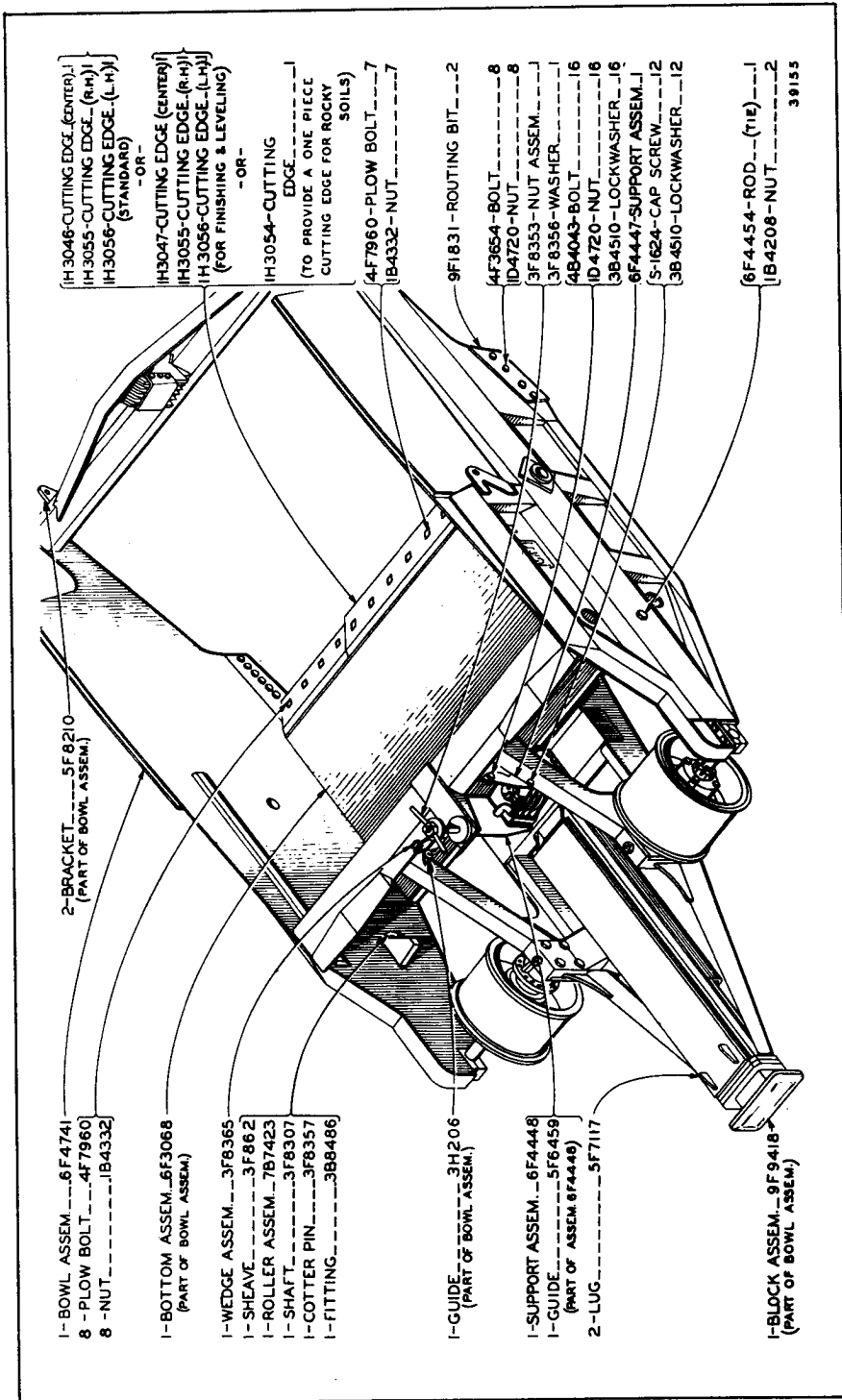

BOWL—Part One
 Serial No. 2W5001 to 2W5259 inclusive
 8F9440 Sideboard Group is available

ALWAYS GIVE SERIAL NUMBER WHEN ORDERING PARTS

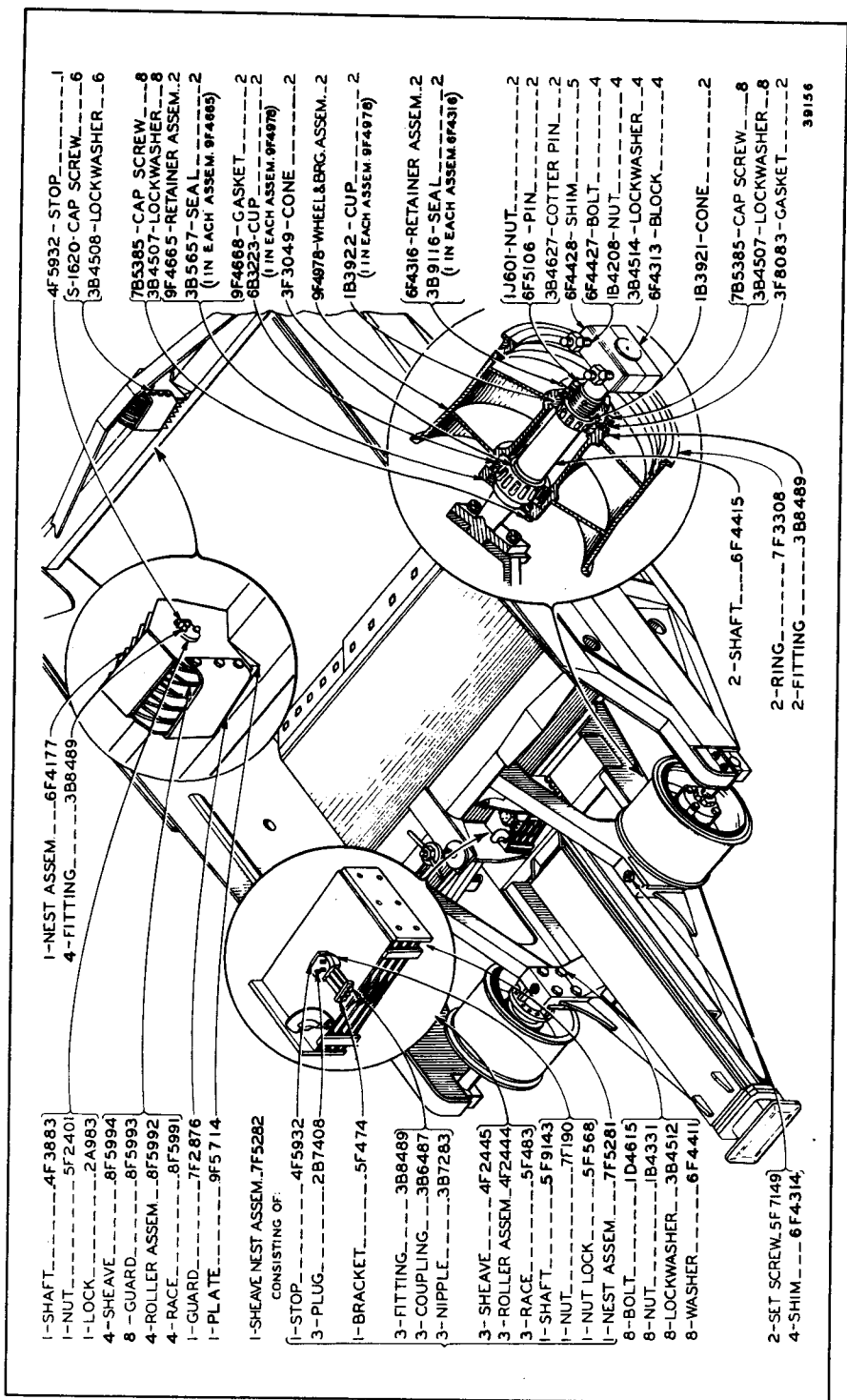

- 1-SHAFT.....4F3883
- 1-NUT.....5F2401
- 1-LOCK.....2A983
- 4-SHEAVE.....8F5994
- 8-GUARD.....8F5993
- 4-ROLLER ASSEM.....8F5992
- 4-RACE.....8F5991
- 1-GUARD.....7F2876
- 1-PLATE.....9F5714
- 1-SHEAVE NEST ASSEM.....7F5282
- CONSISTING OF:
- 1-STOP.....4F5932
- 3-PLUG.....2B7408
- 1-BRACKET.....5F474
- 3-FITTING.....3B8489
- 3-COUPLING.....3B8487
- 3-NIPPLE.....3B7283
- 3-SHEAVE.....4F2445
- 3-ROLLER ASSEM.....4F2444
- 3-RACE.....5F483
- 1-SHAFT.....5F9143
- 1-NUT.....7F190
- 1-NUT LOCK.....5F568
- 1-NEST ASSEM.....7F5281
- 8-BOLT.....1D4615
- 8-NUT.....1B4331
- 8-LOCKWASHER.....3B4512
- 8-WASHER.....6F4411
- 2-SET SCREW.....5F7149
- 4-SHM.....6F4314
- 1-NEST ASSEM.....6F4177
- 4-FITTING.....3B8489
- 4F5932-STOP.....1
- 5-1620-CAP SCREW.....6
- 3B4508-LOCKWASHER.....6
- 7B5385-CAP SCREW.....8
- 3B4507-LOCKWASHER.....8
- 9F4665-RETAINER ASSEM.....2
- 3B5657-SEAL.....2
- (1 IN EACH ASSEM. 9F4665)
- 9F4668-GASKET.....2
- 6B3223-CUP.....2
- (1 IN EACH ASSEM. 9F4978)
- 3F3049-CONE.....2
- 9F4978-WHEEL & BRG. ASSEM.....2
- 1B3922-CUP.....2
- (1 IN EACH ASSEM. 9F4978)
- 6F4316-RETAINER ASSEM.....2
- 3B9116-SEAL.....2
- (1 IN EACH ASSEM. 6F4316)
- 1J601-NUT.....2
- 6F5106-PIN.....2
- 3B4627-COTTER PIN.....2
- 6F4428-SHM.....5
- 6F4427-BOLT.....4
- 1B4208-NUT.....4
- 3B4514-LOCKWASHER.....4
- 6F4313-BLOCK.....4
- 1B3921-CONE.....2
- 7B5385-CAP SCREW.....8
- 3B4507-LOCKWASHER.....8
- 3F8083-GASKET.....2
- 39156
- 2-SHAFT.....6F4415
- 2-RING.....7F3308
- 2-FITTING.....3B8489

BOWL—Part Two
 Serial No. 2W5001 to 2W5259 inclusive
 8F9440 Sideboard Group is available

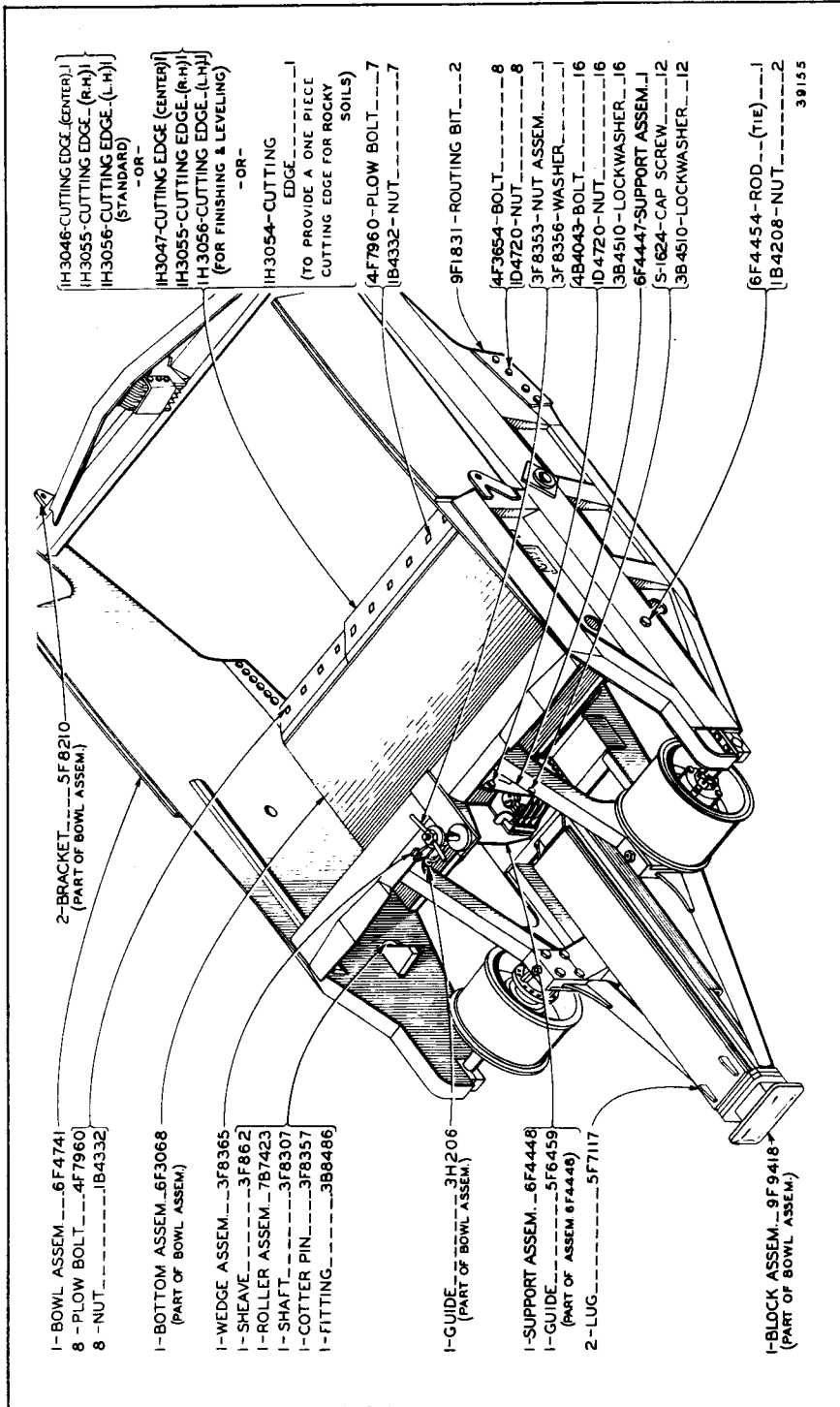

IH3046-CUTTING EDGE (CENTER)
 IH3055-CUTTING EDGE-(R.H.)
 IH3056-CUTTING EDGE-(L.H.)
 (STANDARD)
 -OR-
 IH3047-CUTTING EDGE (CENTER)
 IH3055-CUTTING EDGE-(R.H.)
 IH3056-CUTTING EDGE-(L.H.)
 (FOR FINISHING & LEVELING)

-OR-
 IH3054-CUTTING
 EDGE
 (TO PROVIDE A ONE PIECE
 CUTTING EDGE FOR ROCKY
 SOILS)
 4F7960- PLOW BOLT---7
 IB4332- NUT---7

9F1831-ROUTING BIT---2
 4F3654-BOLT---8
 ID4720-NUT---8
 3F8353-NUT ASSEM---J
 3F8356-WASHER---J
 4B4043-BOLT---16
 ID4720-NUT---16
 3B4510-LOCKWASHER---16
 6F4447-SUPPORT ASSEM---J
 S-624-CAP SCREW---12
 3B4510-LOCKWASHER---12

6F4454-ROD--(11E)---J
 IB4208-NUT---2
 39155

2-BRACKET---5F8210
 (PART OF BOWL ASSEM.)

1-BOWL ASSEM---6F4741
 8 - PLOW BOLT---4F7960
 8 - NUT---IB4332

1-BOTTOM ASSEM---6F3068
 (PART OF BOWL ASSEM.)
 1-WEDGE ASSEM---3F8365
 1-SHEAVE---3F862
 1-ROLLER ASSEM---7B7423
 1-SHAFT---3F8307
 1-COTTER PIN---3F8357
 1-FITTING---3B8486

1-GUIDE---3H206
 (PART OF BOWL ASSEM.)

1-SUPPORT ASSEM---6F4448
 1-GUIDE---5F6459
 (PART OF ASSEM 6F4448)
 2-LUG---5F7117

1-BLOCK ASSEM---9F9418
 (PART OF BOWL ASSEM.)

BOWL—Part One
 Serial No. 2W5260 to 2W5496 inclusive
 8F9440 Sideboard Group is available

ALWAYS GIVE SERIAL NUMBER WHEN ORDERING PARTS

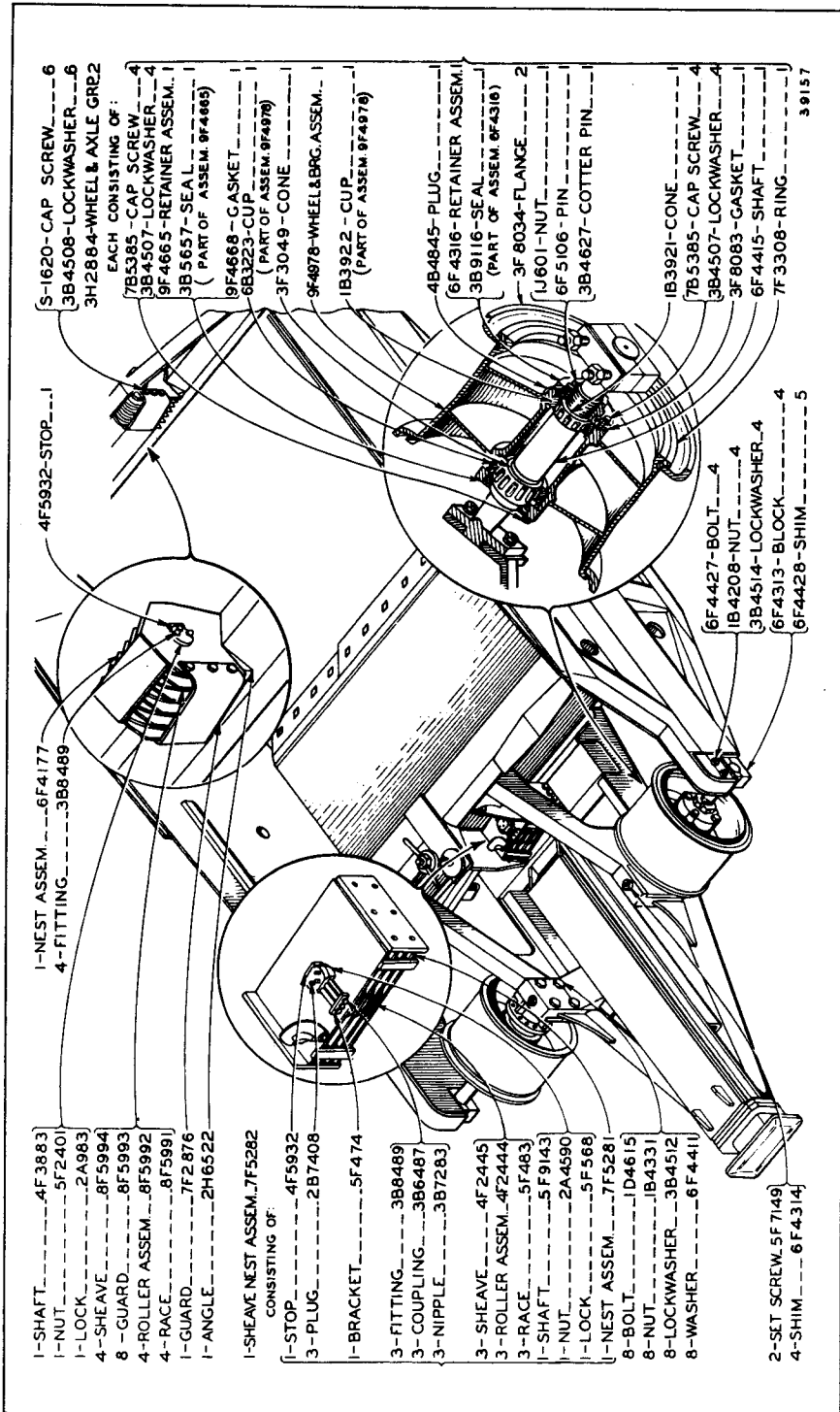

BOWL—Part Two
 Serial No. 2W5260 to 2W5496 inclusive
 8F9440 Sideboard Group is available

ONLY "CATERPILLAR" PARTS GIVE "CATERPILLAR" PERFORMANCE

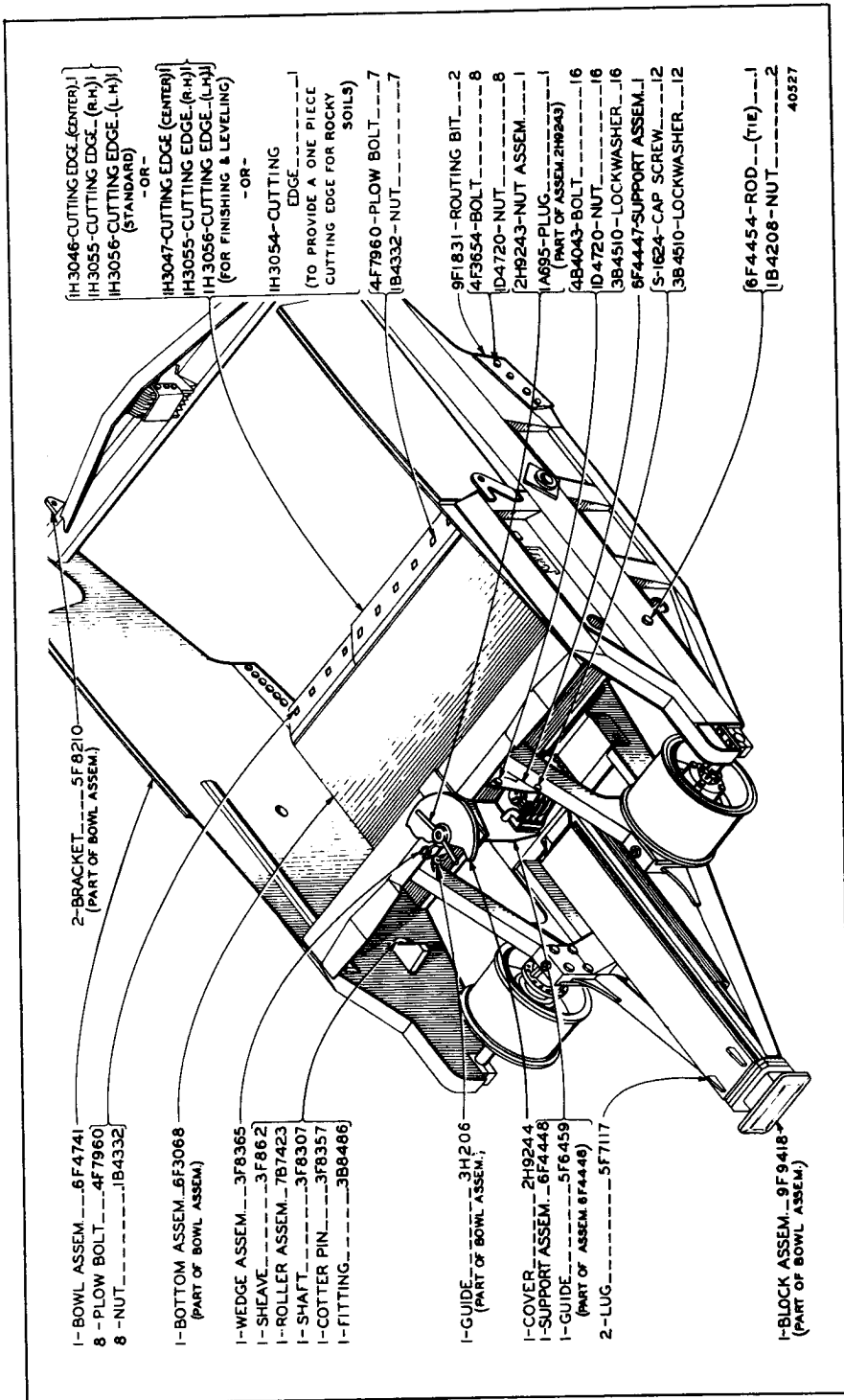

BOWL—Part One
 Serial No. 2W5497 to 2W5532 inclusive
 8F9440 Sideboard Group is available

ALWAYS GIVE SERIAL NUMBER WHEN ORDERING PARTS

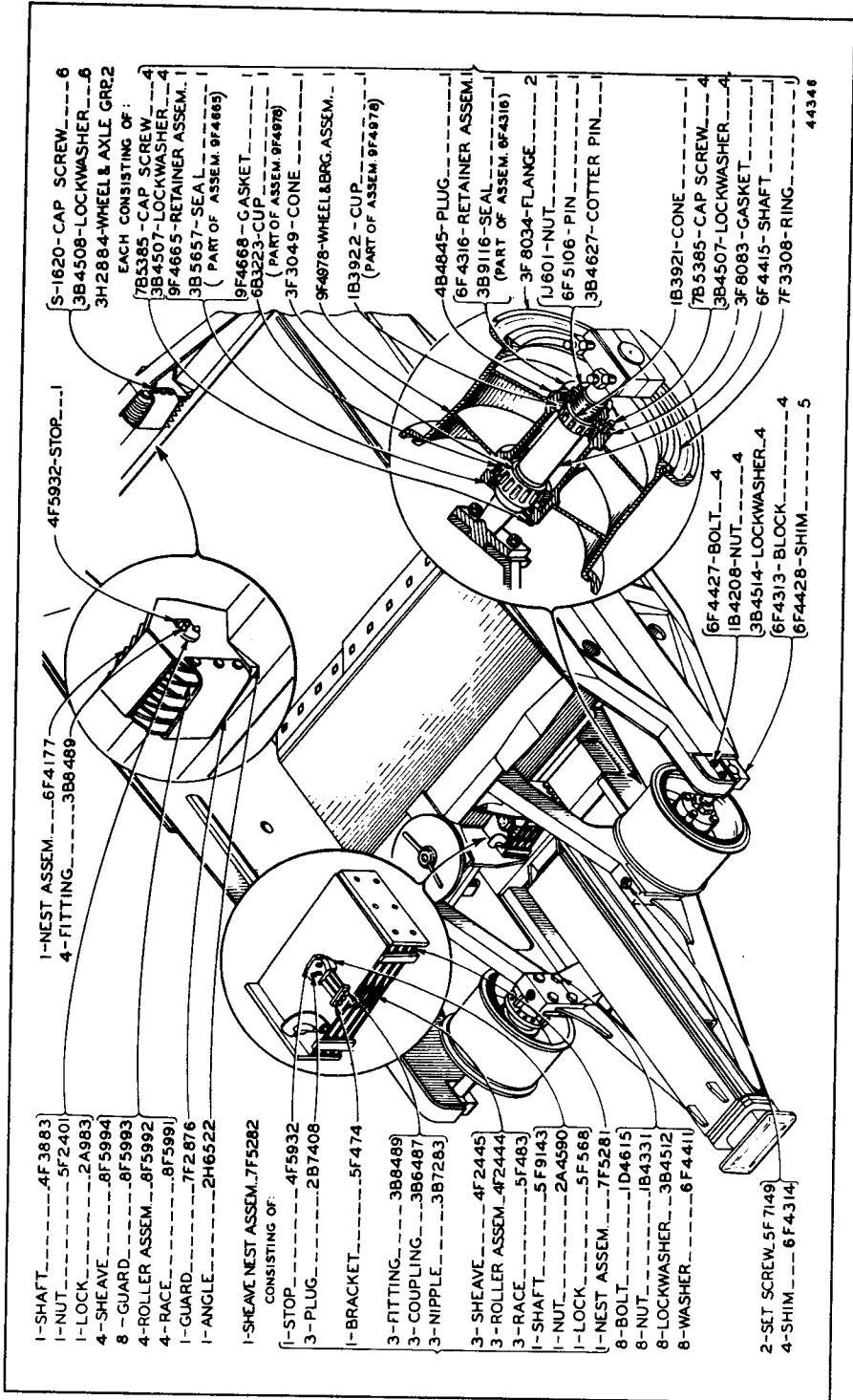

BOWL—Part Two
 Serial No. 2W5497 to 2W5532 inclusive
 8F9440 Sideboard Group is available

ONLY "CATERPILLAR" PARTS GIVE "CATERPILLAR" PERFORMANCE

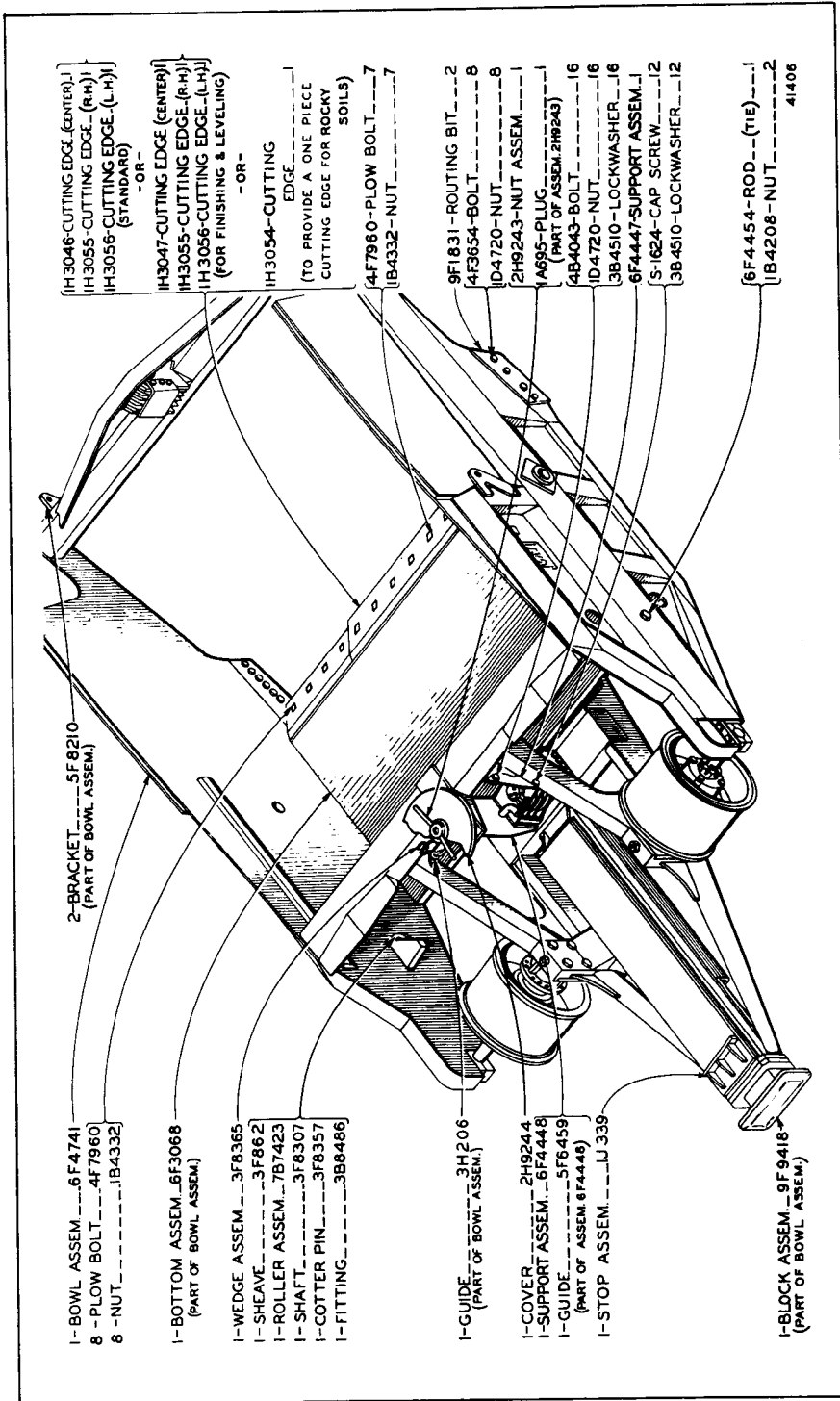

BOWL—Part One

Serial No. 2W5533 to 2W5748 inclusive
8F9440 Sideboard Group is available

ALWAYS GIVE SERIAL NUMBER WHEN ORDERING PARTS

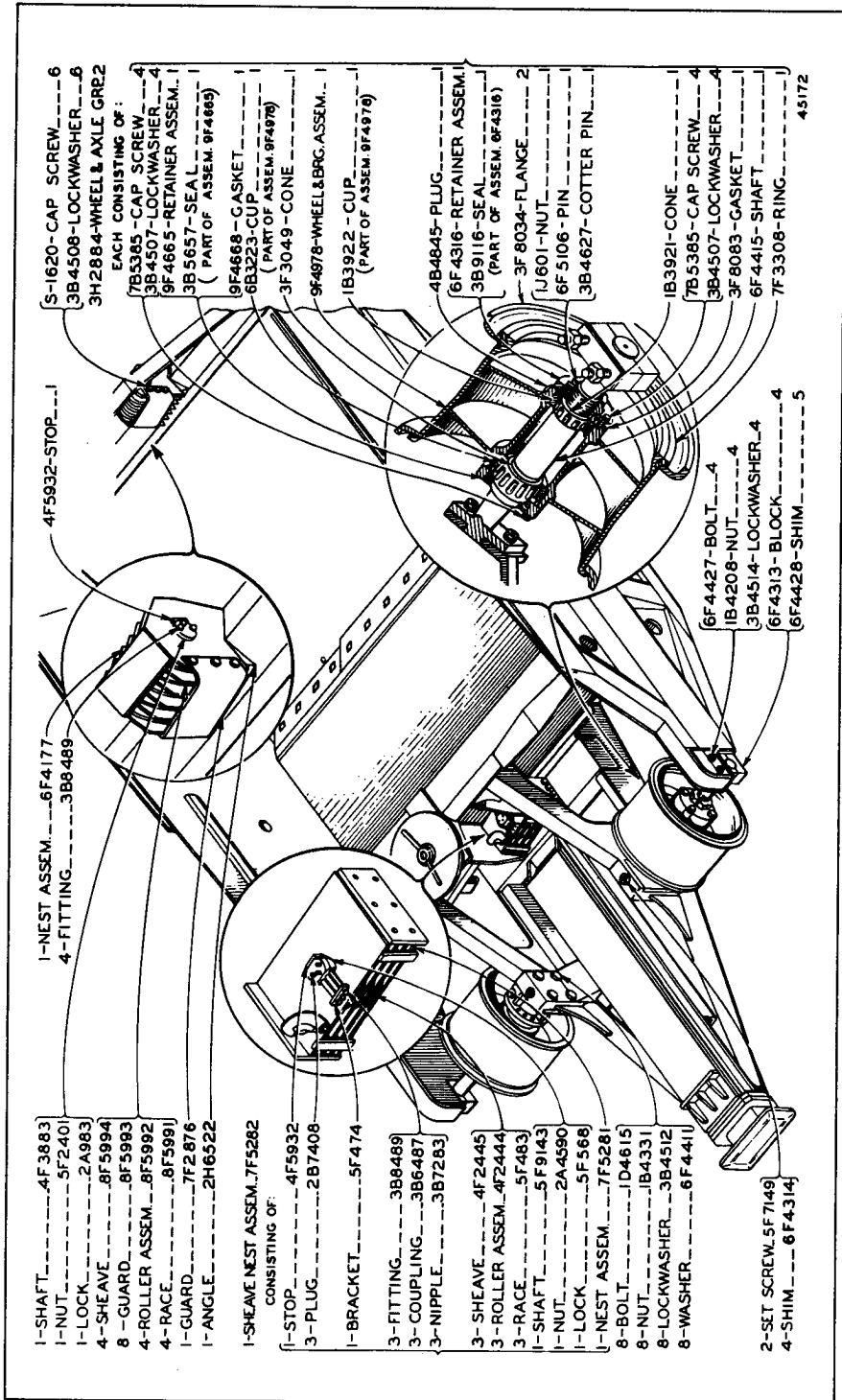

BOWL—Part Two
 Serial No. 2W5533 to 2W5748 inclusive
 8F9440 Sideboard Group is available

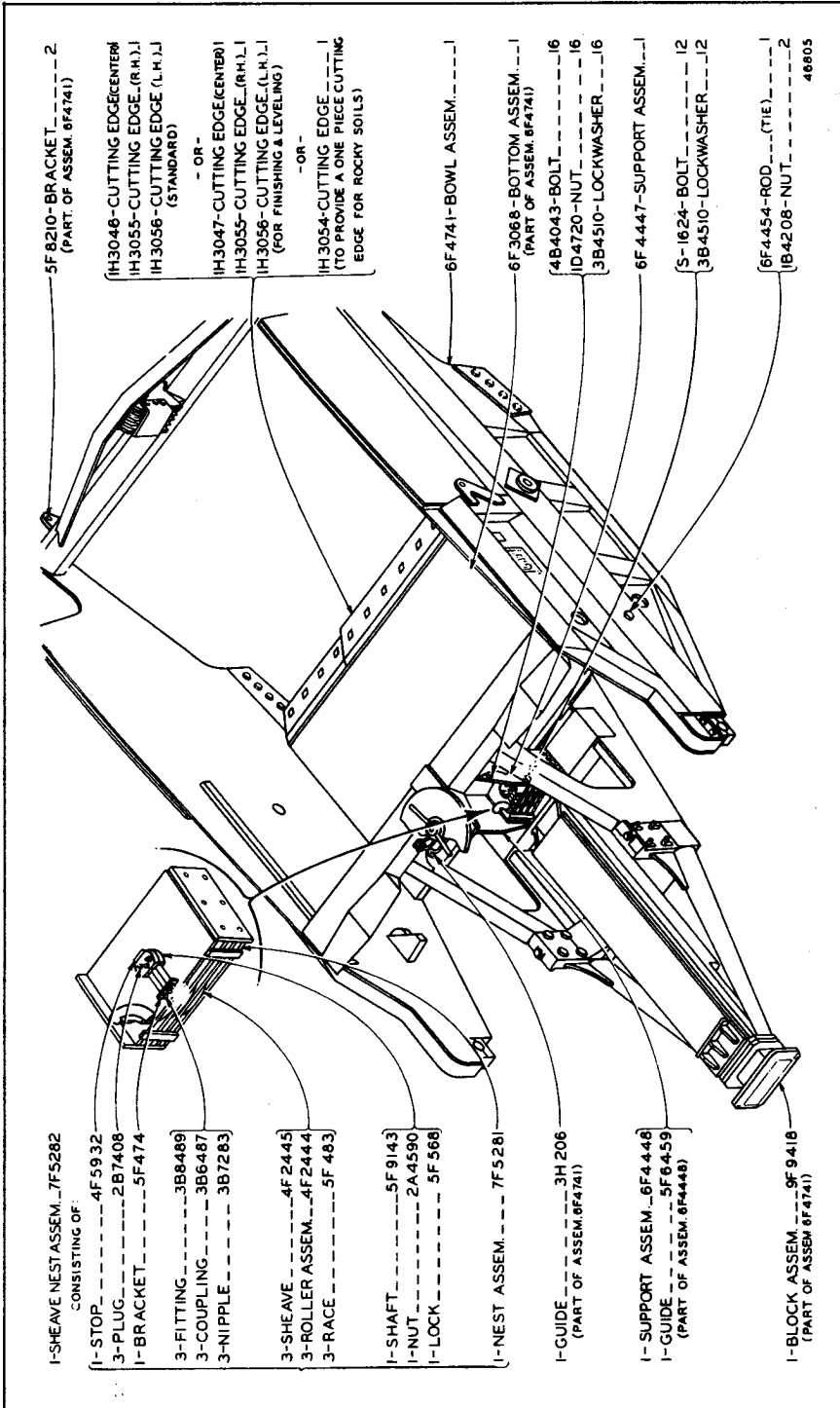

BOWL—Part One
Effective with Serial No. 2W5749
8F9440 Sideboard Group is available

ALWAYS GIVE SERIAL NUMBER WHEN ORDERING PARTS

PRINTED IN U.S.A.

NO. 60 SCRAPER—FORM 32383—INSERT BETWEEN PAGES 20 & 21

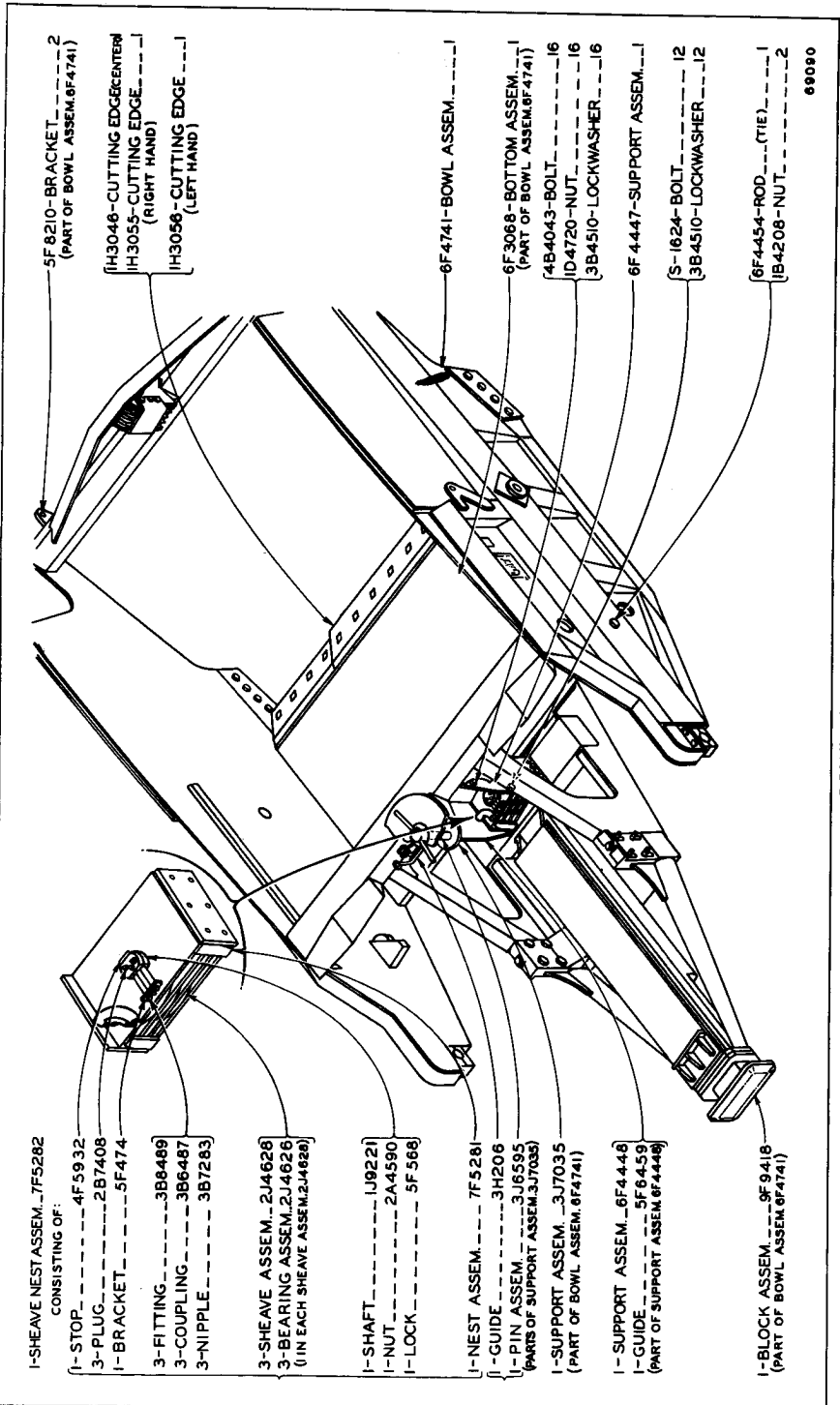

BOWL—Part One

Effective with Serial No. 2W6236

8F9440 Sideboard Group is available. Additional parts are shown on reverse side of this insert

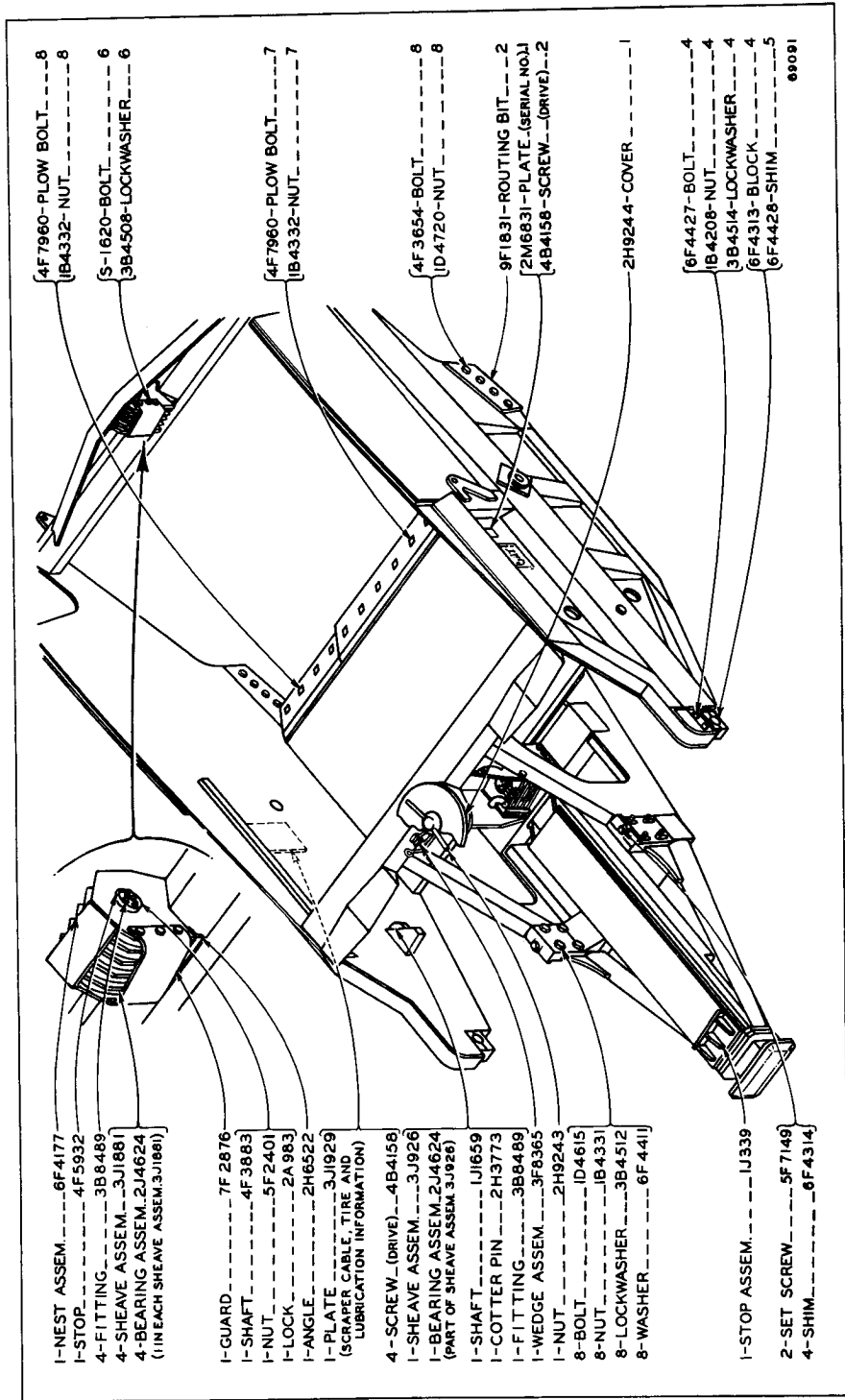

- 4F7960- PLOW BOLT.-----8
- IB4332- NUT.-----8
- S-1620-BOLT.-----6
- 3B4508-LOCKWASHER.-----6
- 4F7960- PLOW BOLT.-----7
- IB4332- NUT.-----7
- 4F3654- BOLT.-----8
- ID4720- NUT.-----8
- 9F1831- ROUTING BIT.-----2
- ZM6831- PLATE. (SERIAL NO.)
- 4B4158- SCREW. (DRIVE).-----2
- 2H9244- COVER.-----1
- 6F4427- BOLT.-----4
- IB4208- NUT.-----4
- 3B4514- LOCKWASHER.-----4
- 6F4313- BLOCK.-----4
- 6F4428- SHIM.-----5

69091

- 1- NEST ASSEM.-----6F4177
- 1- STOP.-----4F5932
- 4- FITTING.-----3B8489
- 4- SHEAVE ASSEM.-----3J1881
- 4- BEARING ASSEM. 2JA624
- (1 IN EACH SHEAVE ASSEM. 3J1881)
- 1- GUARD.-----7F2876
- 1- SHAFT.-----4F3883
- 1- NUT.-----5F2401
- 1- LOCK.-----2A983
- 1- ANGLE.-----2H6522
- 1- PLATE.-----3J1929
- (SCRAPER CABLE, TIRE AND LUBRICATION INFORMATION)
- 4- SCREW (DRIVE).-----4B4158
- 1- SHEAVE ASSEM.-----3J926
- 1- BEARING ASSEM. 2JA624
- (PART OF SHEAVE ASSEM. 3J926)
- 1- SHAFT.-----1J1659
- 1- COTTER PIN.-----2H3773
- 1- FITTING.-----3B8489
- 1- WEDGE ASSEM.-----3F8365
- 1- NUT.-----2H9243
- 8- BOLT.-----ID4615
- 8- NUT.-----IB4331
- 8- LOCKWASHER.-----3B4512
- 8- WASHER.-----6F4411
- 1- STOP ASSEM.-----1J339
- 2- SET SCREW.-----5F7149
- 4- SHIM.-----6F4314

BOWL—Part Two
Effective with Serial No. 2W6236

NO. 60 SCRAPER—FORM 32383—INSERT BETWEEN PAGES 20 & 21

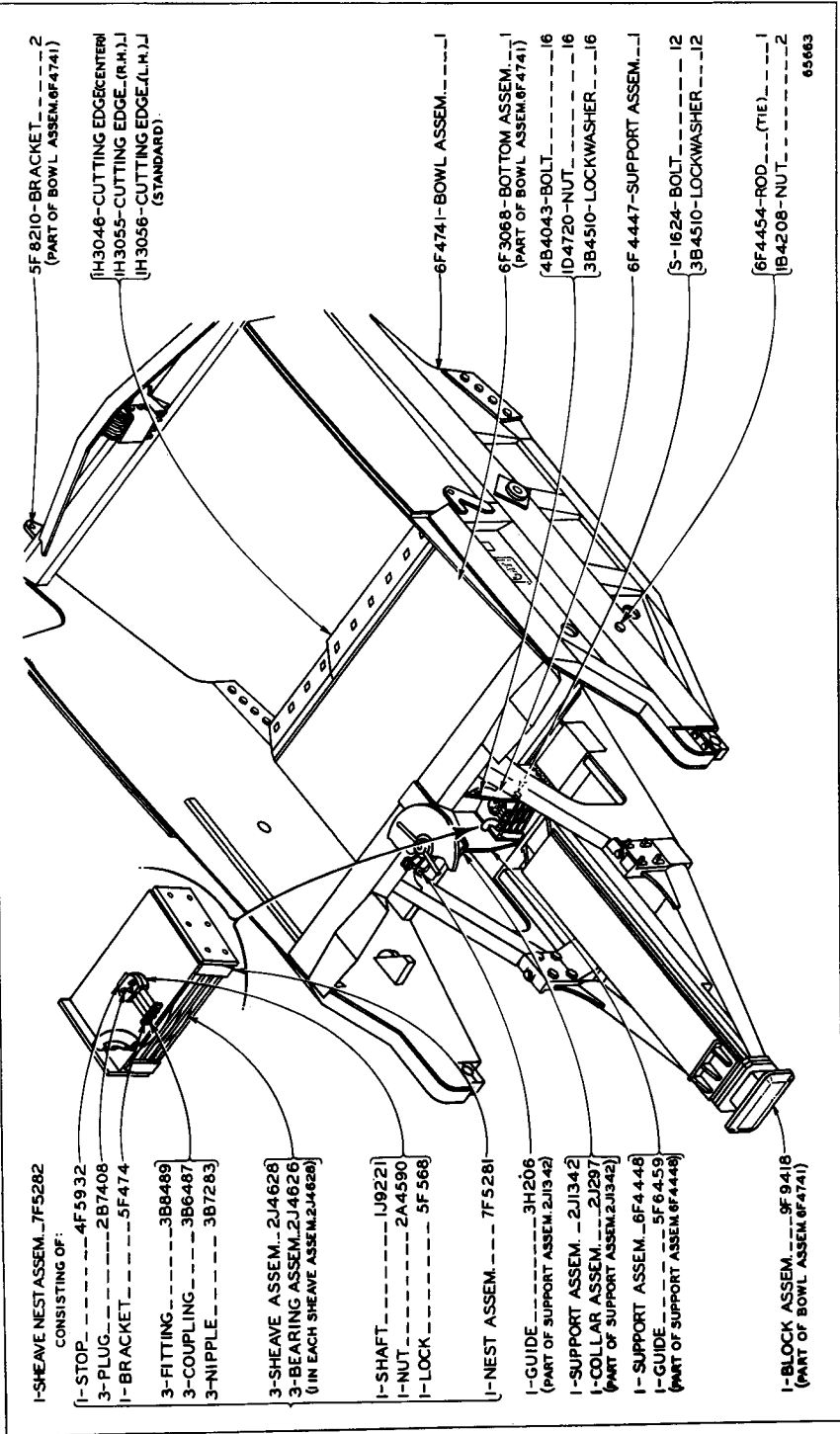

BOWL—Part One

Effective with Serial No. 2W6226

8F9440 Sideboard Group is available. Additional parts are shown on reverse side of this insert. See Notice of Improved Parts No. 379

65663

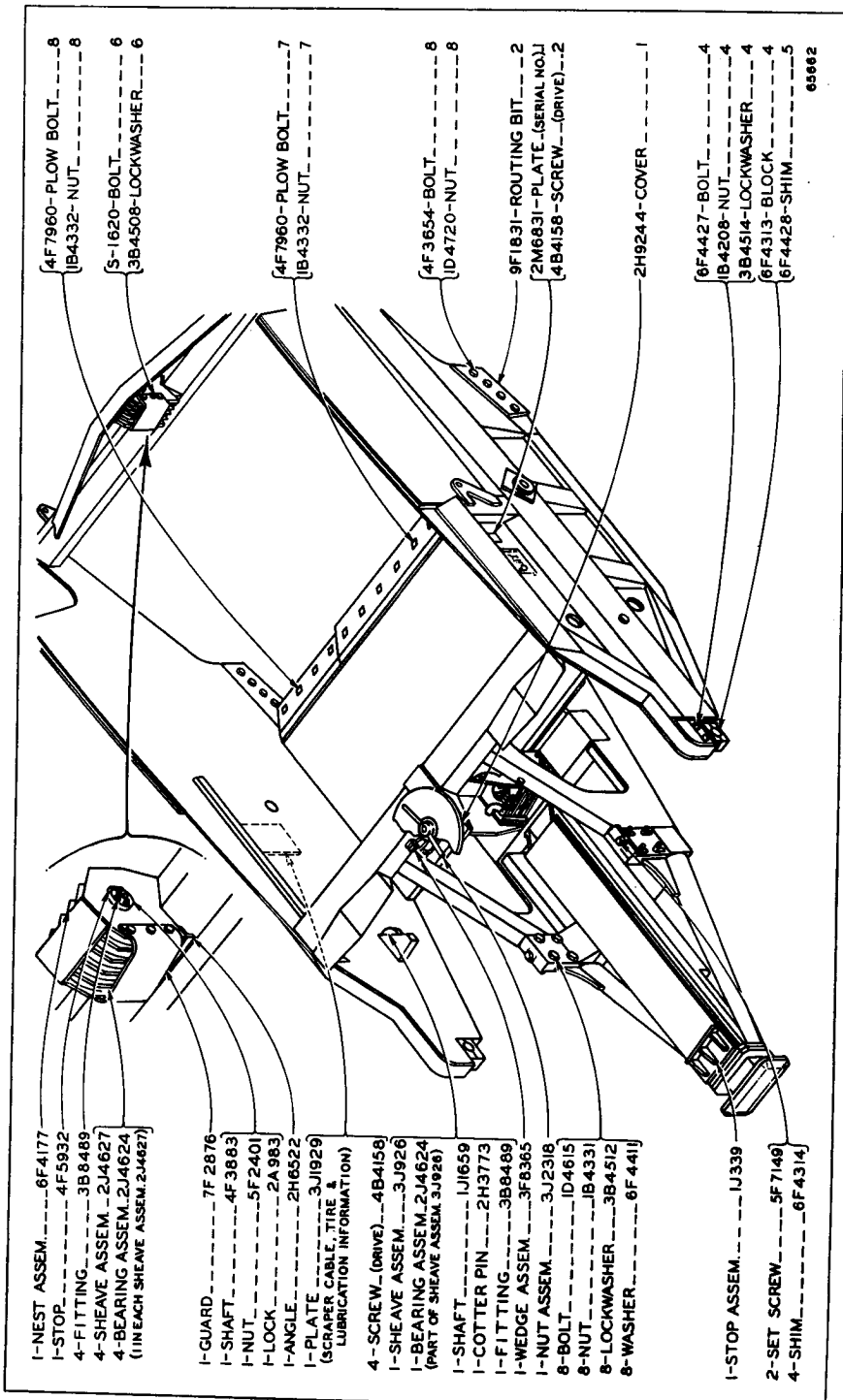

4F7960- PLOW BOLT...-8
 1B4332- NUT...-8
 S-1620-BOLT...-6
 3B4508-LOCKWASHER...-6

4F7960- PLOW BOLT...-7
 1B4332- NUT...-7

4F3654- BOLT...-8
 1D4720- NUT...-8

9F1631- ROUTING BIT...-2
 2M6831- PLATE (SERIAL NO.)
 4B4158- SCREW...-(DRIVE)...-2

2H9244- COVER...-1

6F4427- BOLT...-4
 1B4208- NUT...-4
 3B4514- LOCKWASHER...-4
 6F4313- BLOCK...-4
 6F4428- SHIM...-5
 65982

1- NEST ASSEM...-6F4177
 1- STOP...-4F5932
 4- FITTING...-3B6489
 4- SHEAVE ASSEM...-2J4627
 4- BEARING ASSEM...-2J4624
 (1 IN EACH SHEAVE ASSEM. 2J4627)

1- GUARD...-7F2876
 1- SHAFT...-4F3883
 1- NUT...-5F2401
 1- LOCK...-2A983
 1- ANGLE...-2H6522
 1- PLATE...-3J1929
 (SCRAPER CABLE, TIRE &
 LUBRICATION INFORMATION)

4- SCREW... (DRIVE)...-4B4158
 1- SHEAVE ASSEM...-3J926
 1- BEARING ASSEM...-2J4624
 (PART OF SHEAVE ASSEM. 3J926)
 1- SHAFT...-1J1659
 1- COTTER PIN...-2H3773
 1- FITTING...-3B8489
 1- WEDGE ASSEM...-3F8365
 1- NUT ASSEM...-3J2316
 8- BOLT...-1D4615
 8- NUT...-1B4331
 8- LOCKWASHER...-3B4512
 8- WASHER...-6F4411

1- STOP ASSEM...-1J339
 2- SET SCREW...-5F7149
 4- SHIM...-6F4314

BOWL—Part Two
 Effective with Serial No. 2W6226
 8F9440 Sideboard Group is available

NO. 60 SCRAPER—PARTS CATALOG—FORM 32383—INSERT BETWEEN PAGES 20 & 21

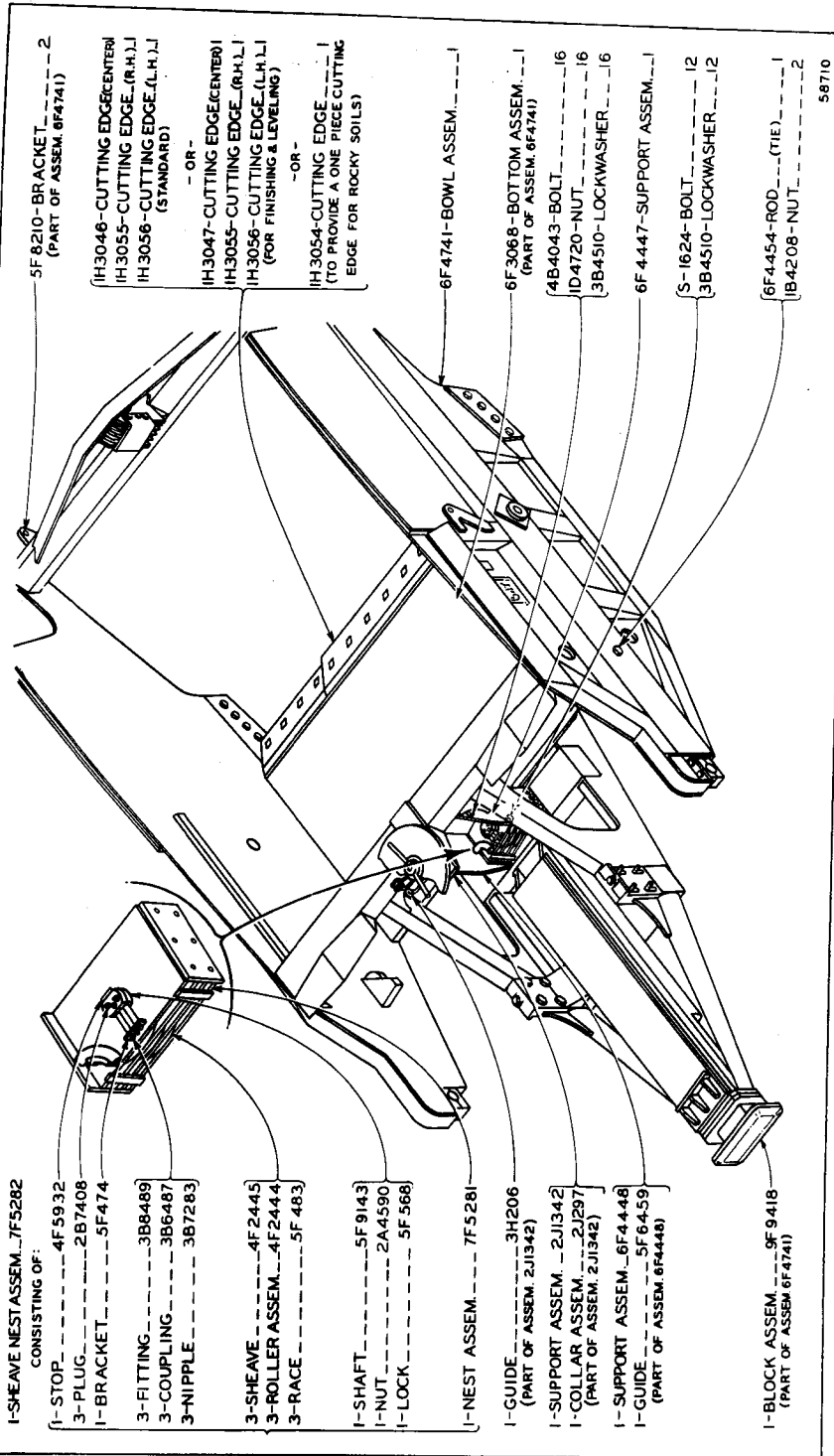

BOWL—Part One

Effective with Serial No. 2W6137

8F9440 Sideboard Group is available. Additional parts are shown on reverse side of this insert

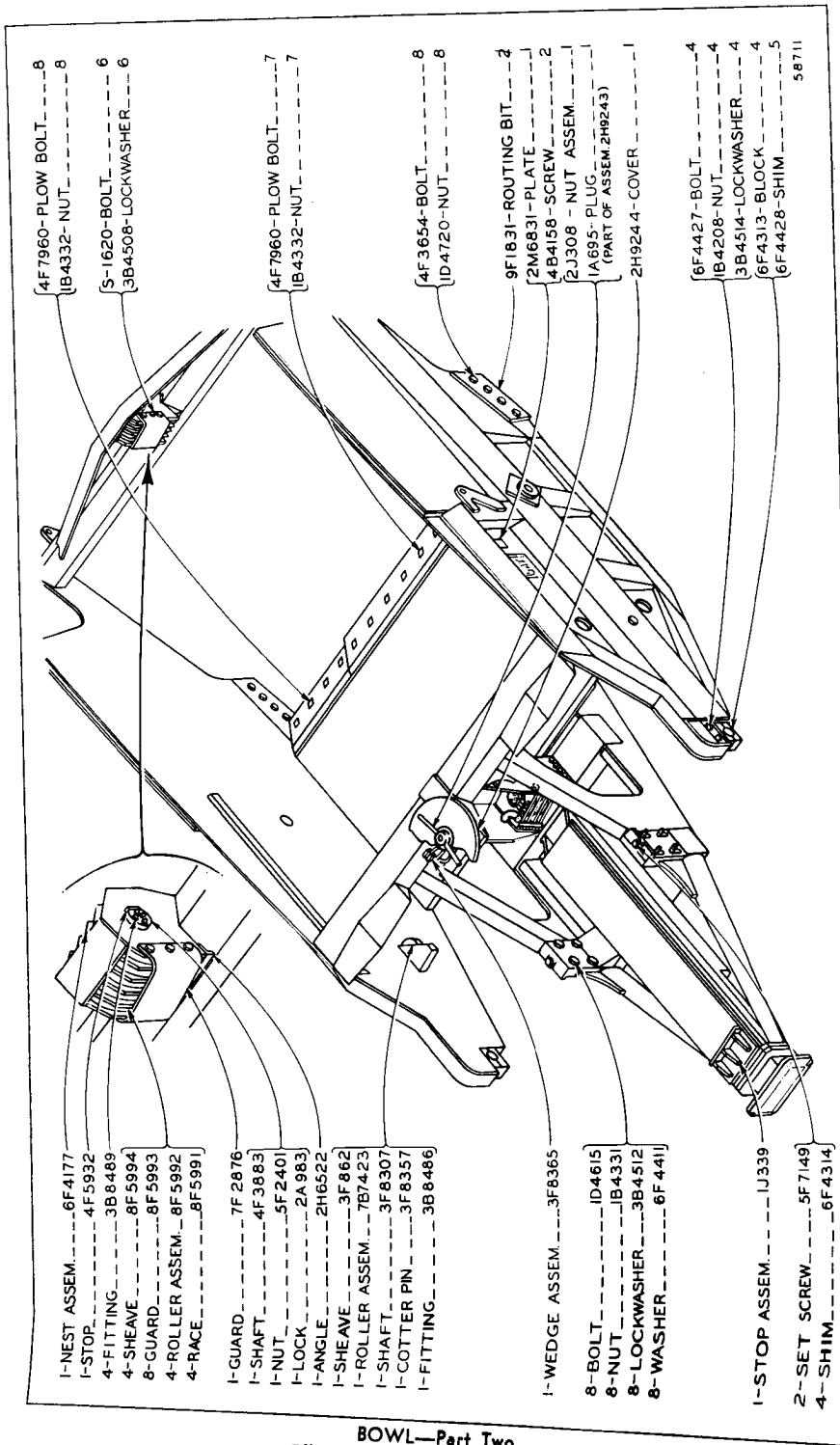

BOWL—Part Two
 Effective with Serial No. 2W6137
 8F9440 Sideboard Group is available

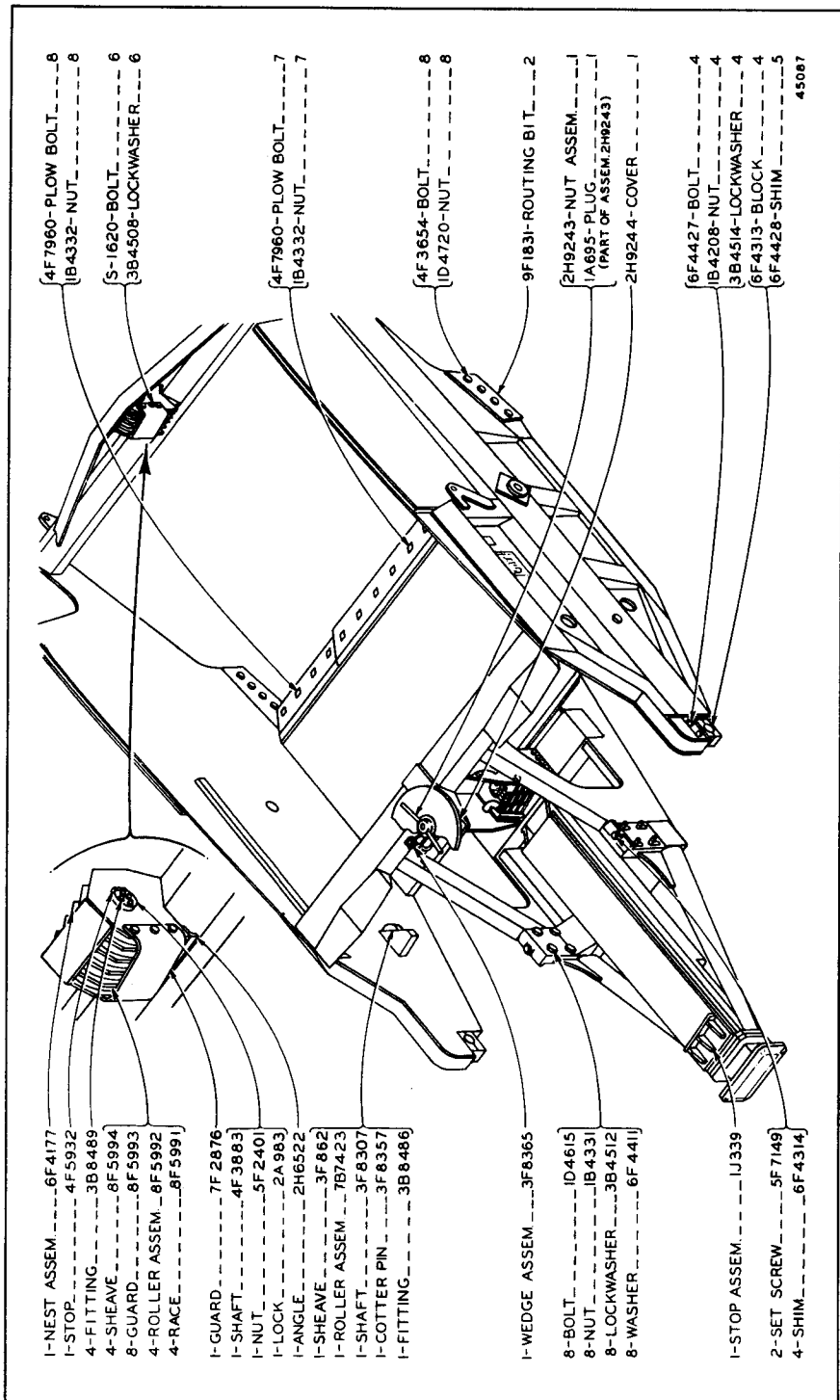

BOWL—Part Two
 Effective with Serial No. 2W5749
 8F9440 Sideboard Group is available

ONLY "CATERPILLAR" PARTS GIVE "CATERPILLAR" PERFORMANCE

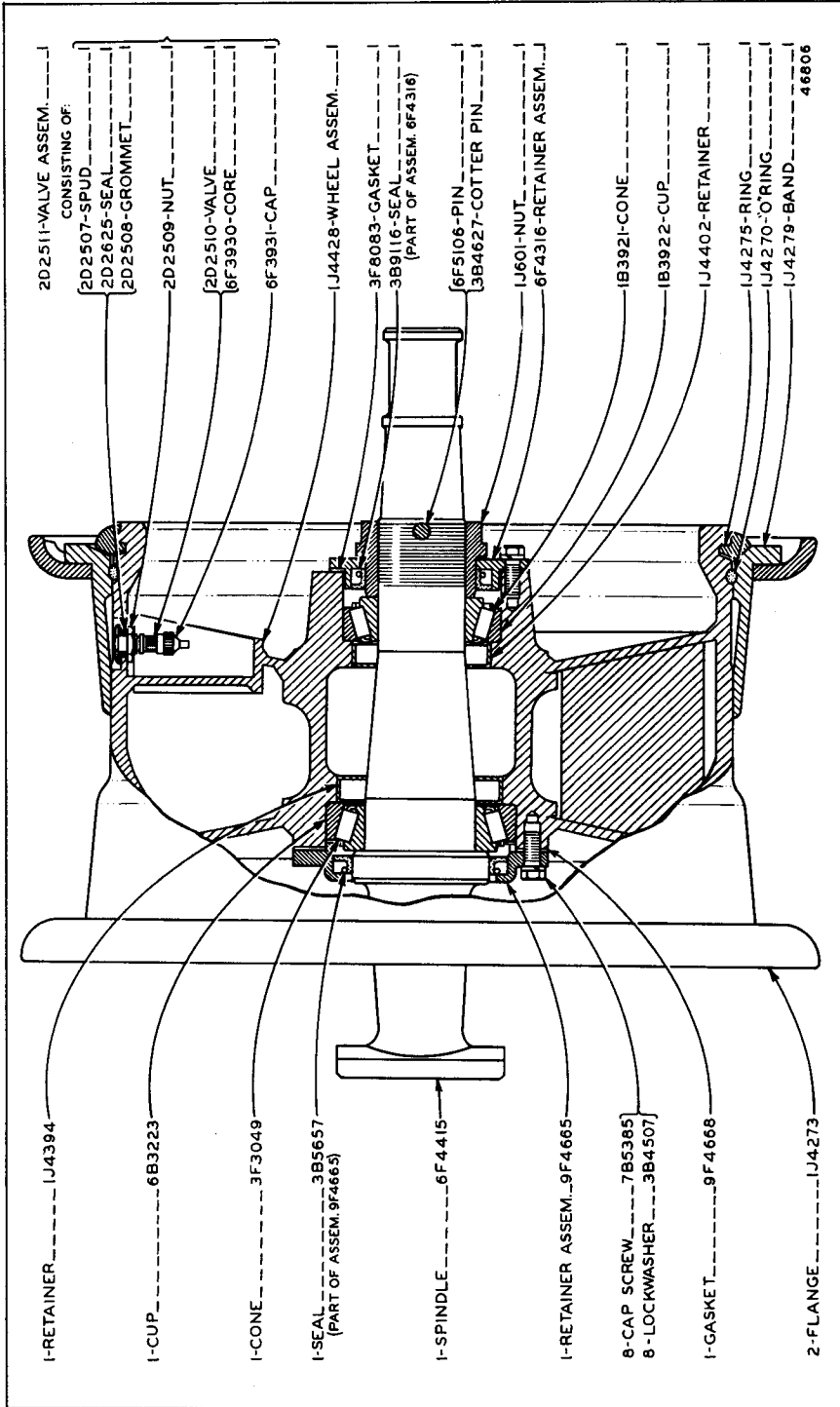

REAR WHEEL AND AXLE (2 required)
Effective with Serial No. 2W5749

ALWAYS GIVE SERIAL NUMBER WHEN ORDERING PARTS

PRINTED IN U.S.A.

NO. 60 SCRAPER—PARTS CATALOG—FORM 32383—INSERT BETWEEN PAGES 22 & 23

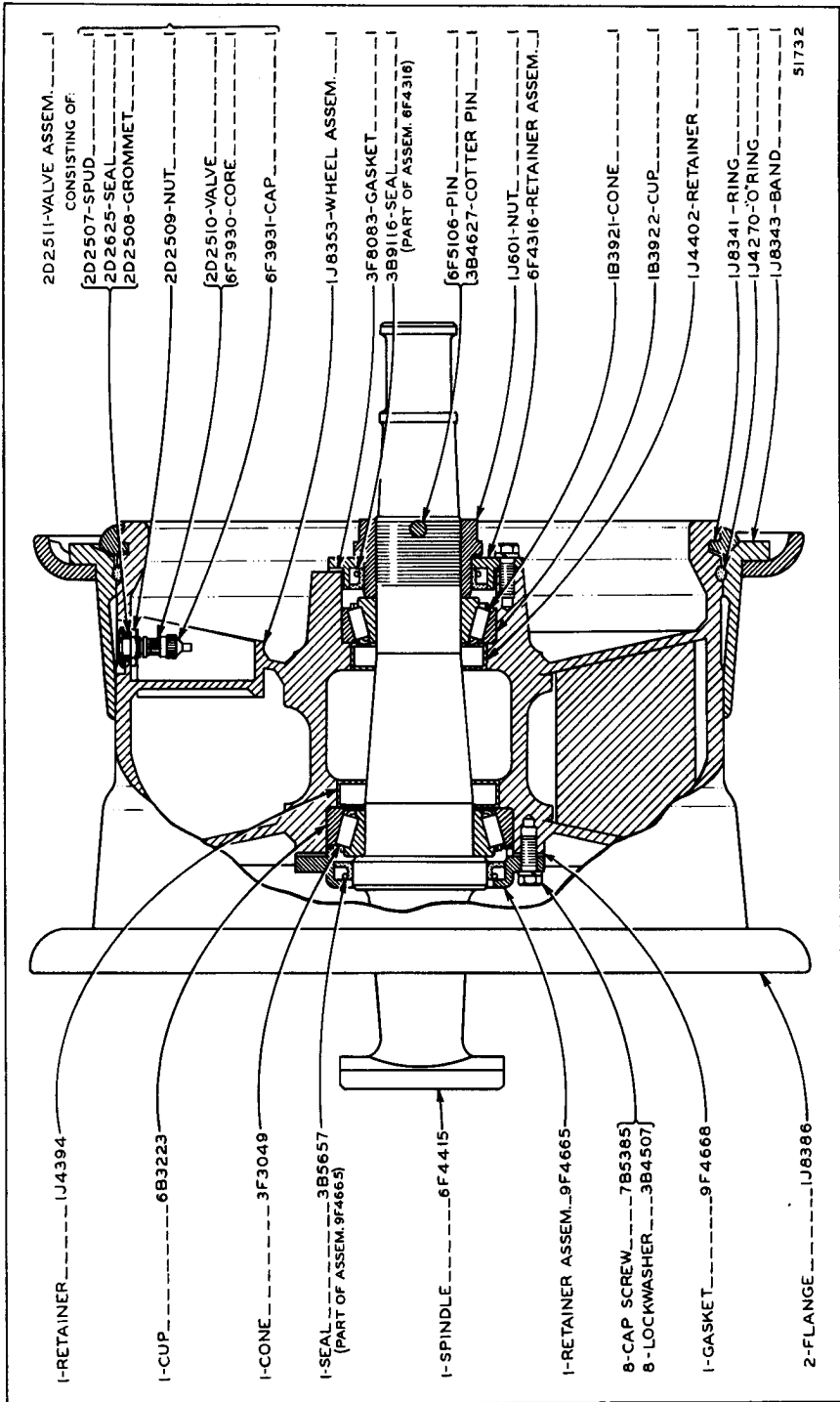

REAR WHEEL AND AXLE—11.25x21—Tubeless Tires—2 Groups Required

Effective with Serial No. 2W6017

See Notice of Improved Parts No. 333

ONLY "CATERPILLAR" PARTS GIVE "CATERPILLAR" PERFORMANCE

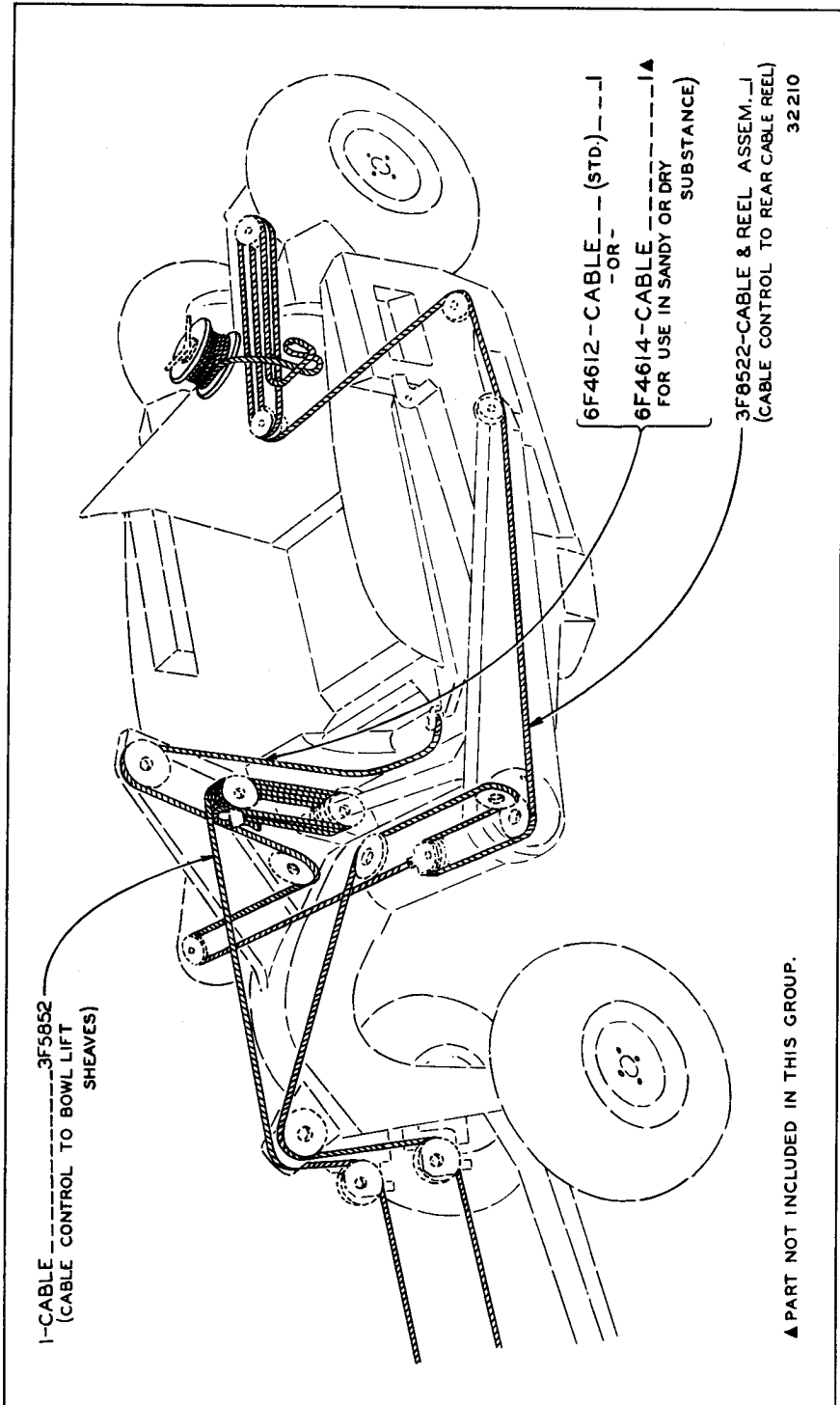

1-CABLE --- 3F5852
(CABLE CONTROL TO BOWL LIFT
SHEAVES)

6F4612-CABLE --- (STD.) --- J
-OR-
6F4614-CABLE --- J
FOR USE IN SANDY OR DRY
SUBSTANCE)

3F8522-CABLE & REEL ASSEM. J
(CABLE CONTROL TO REAR CABLE REEL)
32210

▲ PART NOT INCLUDED IN THIS GROUP.

CABLES

ONLY "CATERPILLAR" PARTS GIVE "CATERPILLAR" PERFORMANCE

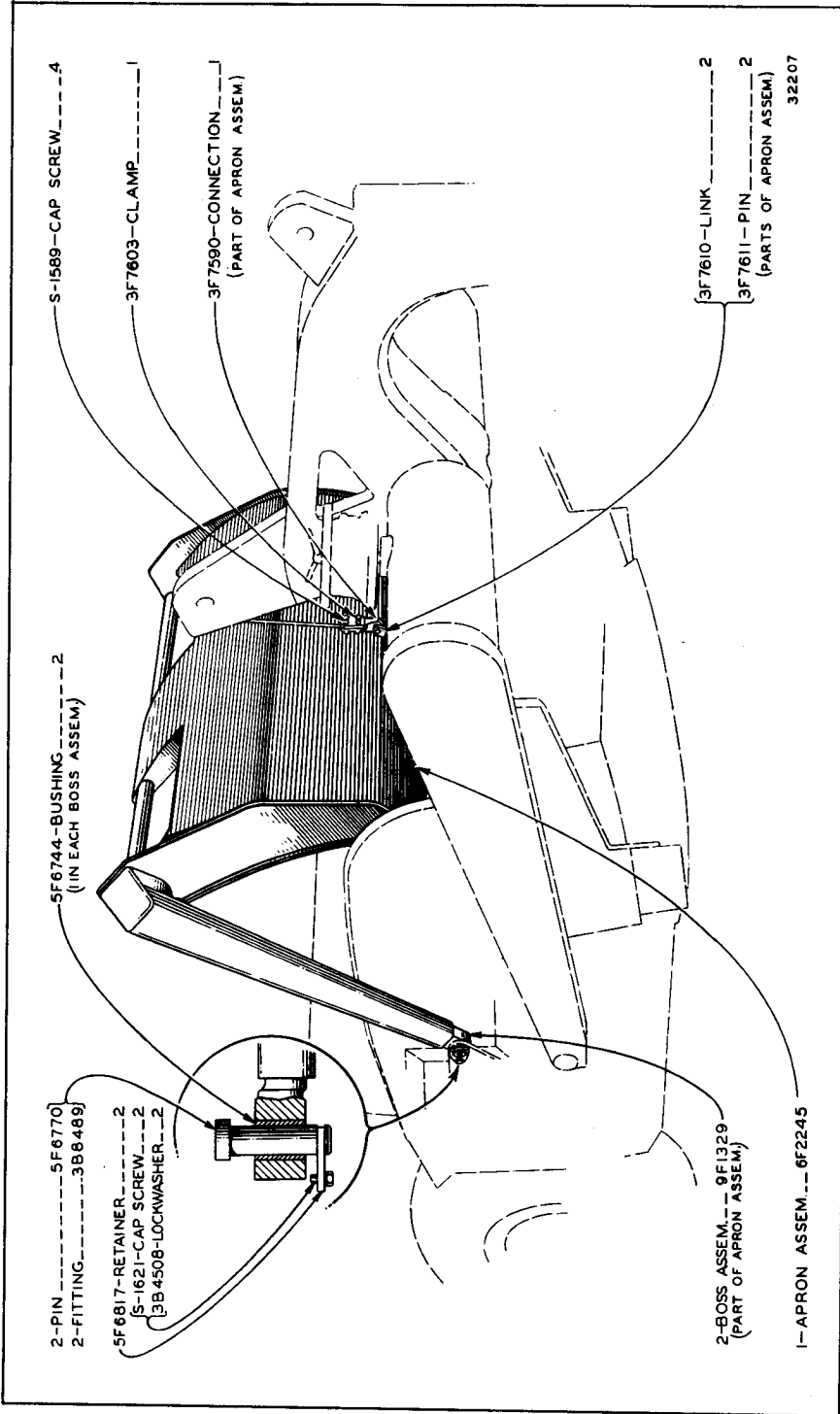

APRON

ALWAYS GIVE SERIAL NUMBER WHEN ORDERING PARTS

PRINTED IN U.S.A.

NO. 60 SCRAPER—FORM 32383—INSERT BETWEEN PAGES 24 & 25 AND CROSS OUT ILLUSTRATION 63834
 SHOWN ON INSERT NO. 155 DATED 5-61

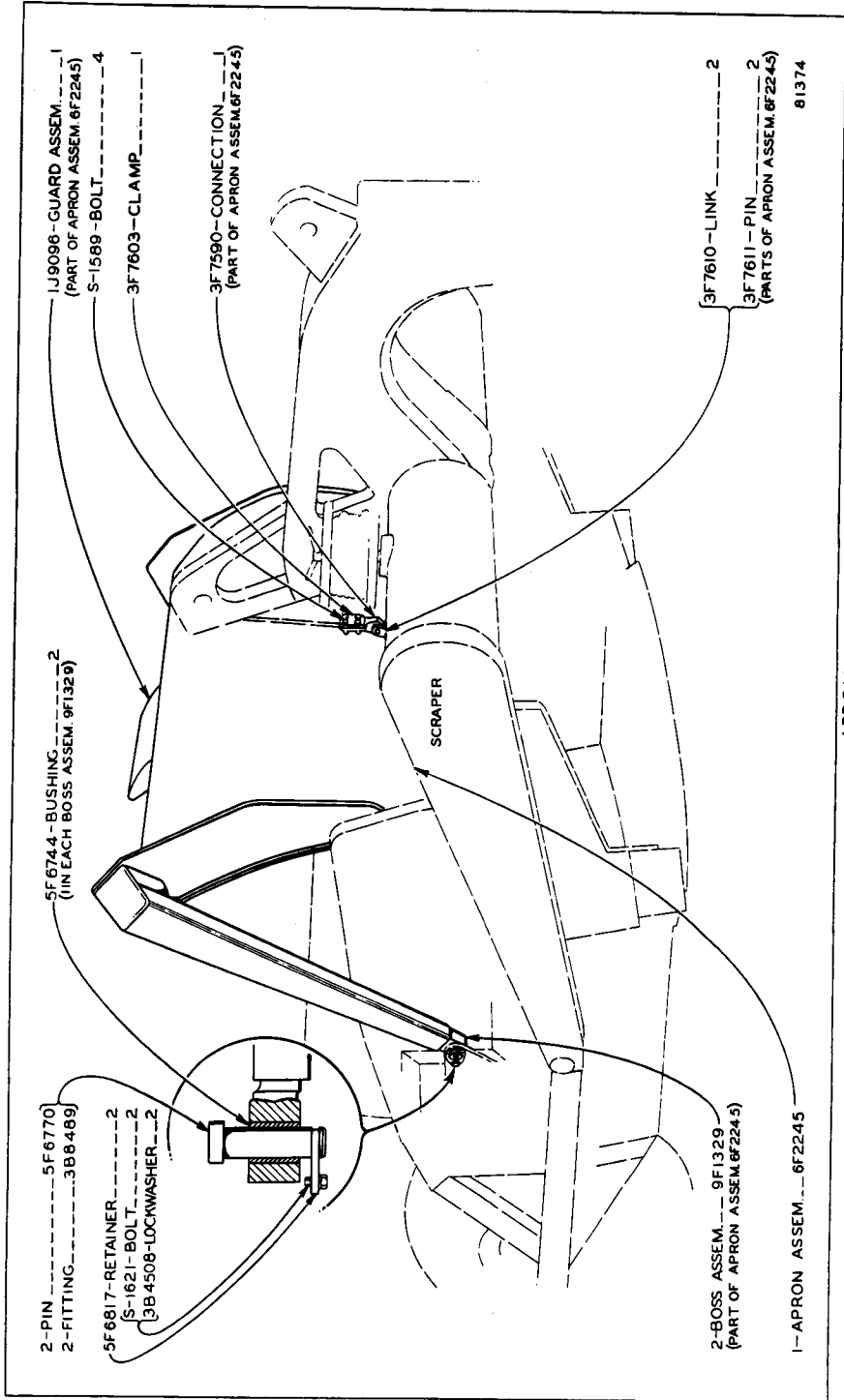

APRON
 Effective with Serial No. 2W6203

PRINTED IN U.S.A.

NO. 60 SCRAPER—FORM 32383—INSERT BETWEEN PAGES 24 & 25

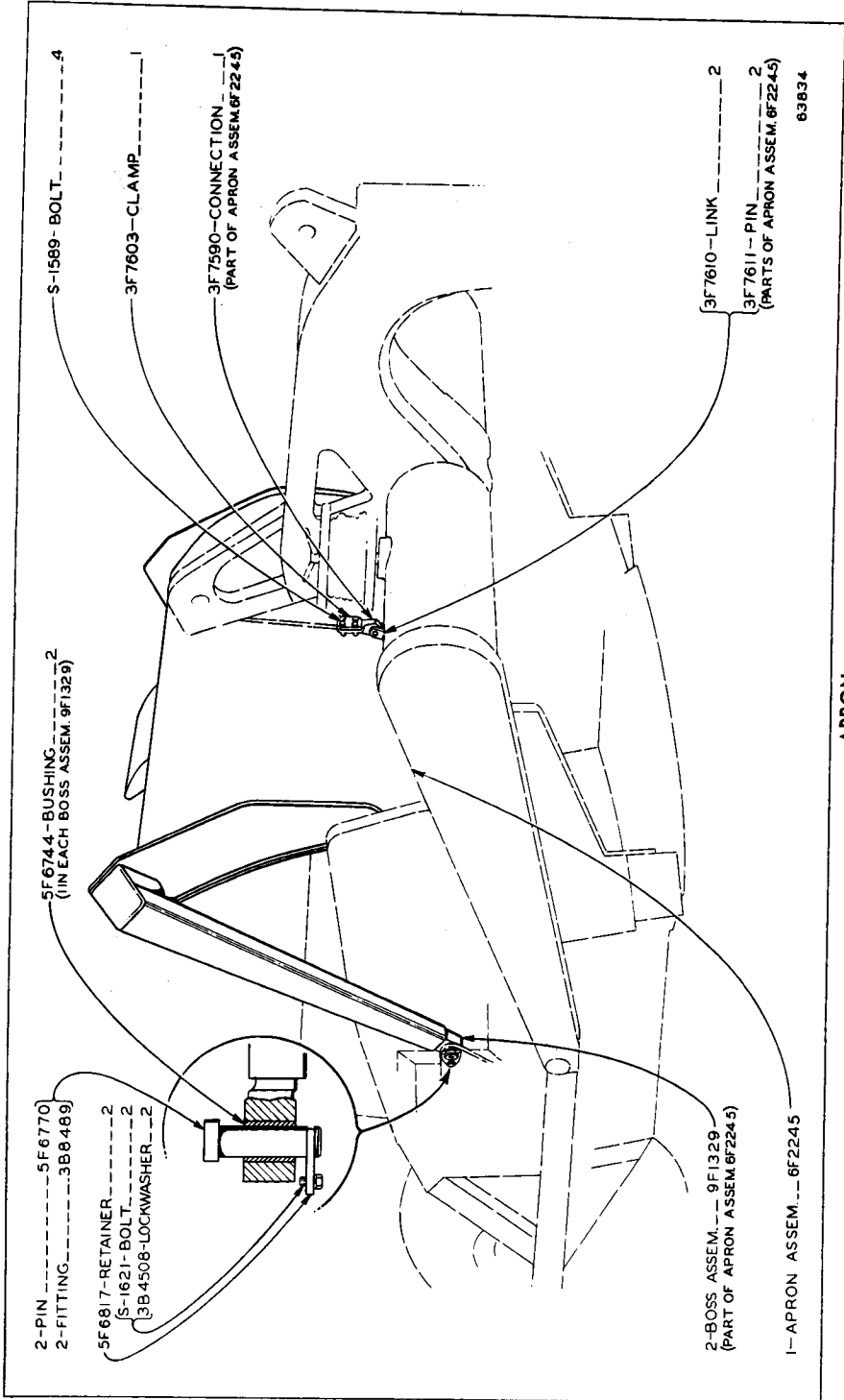

APRON Effective with Serial No. 2W6203

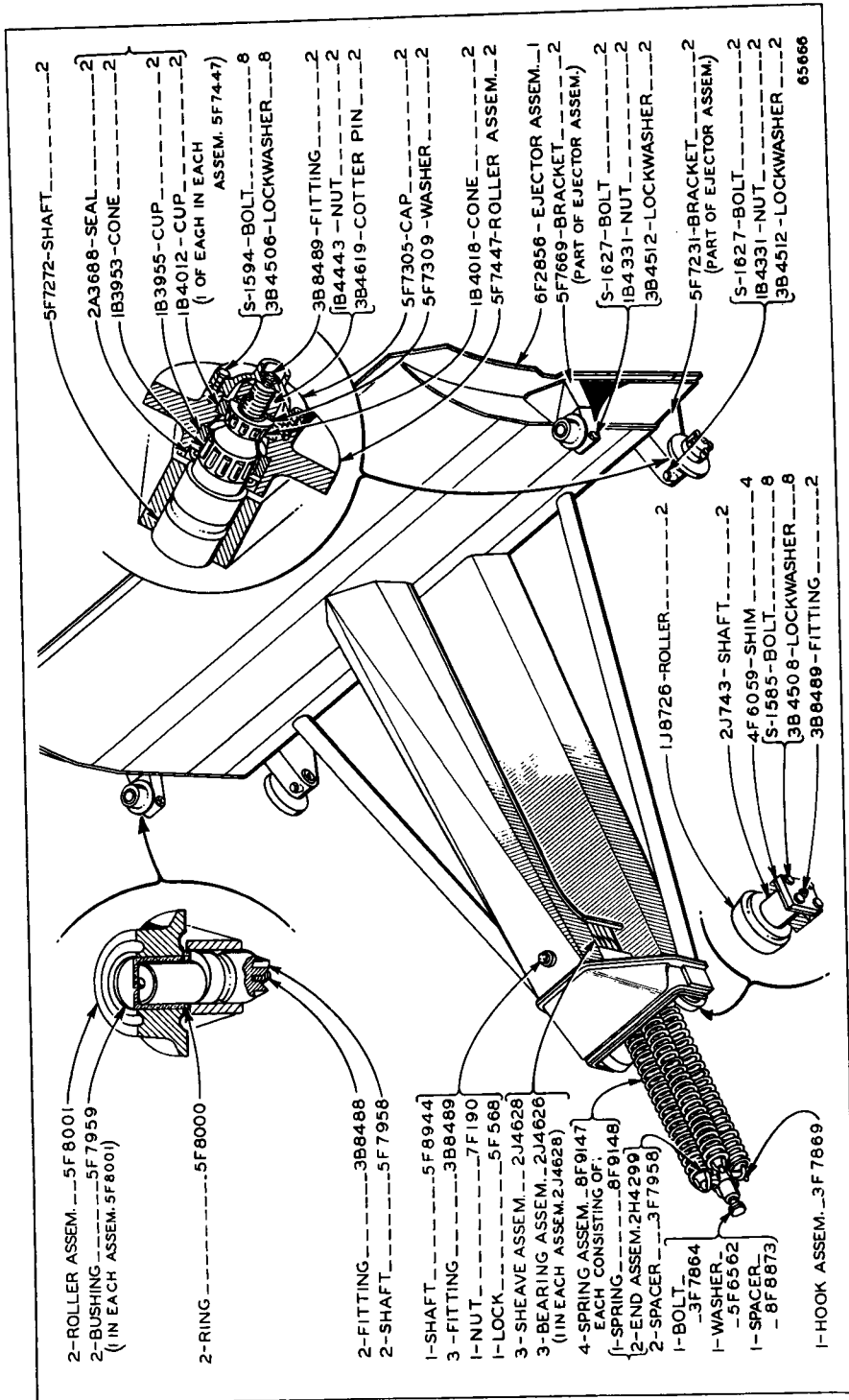

EJECTOR

Effective with Serial No. 2W6226
See Notice of Improved Parts No. 379

65666

SCRAPER—PARTS CATALOG—3228—INSERT 3 OF TEN PAGES

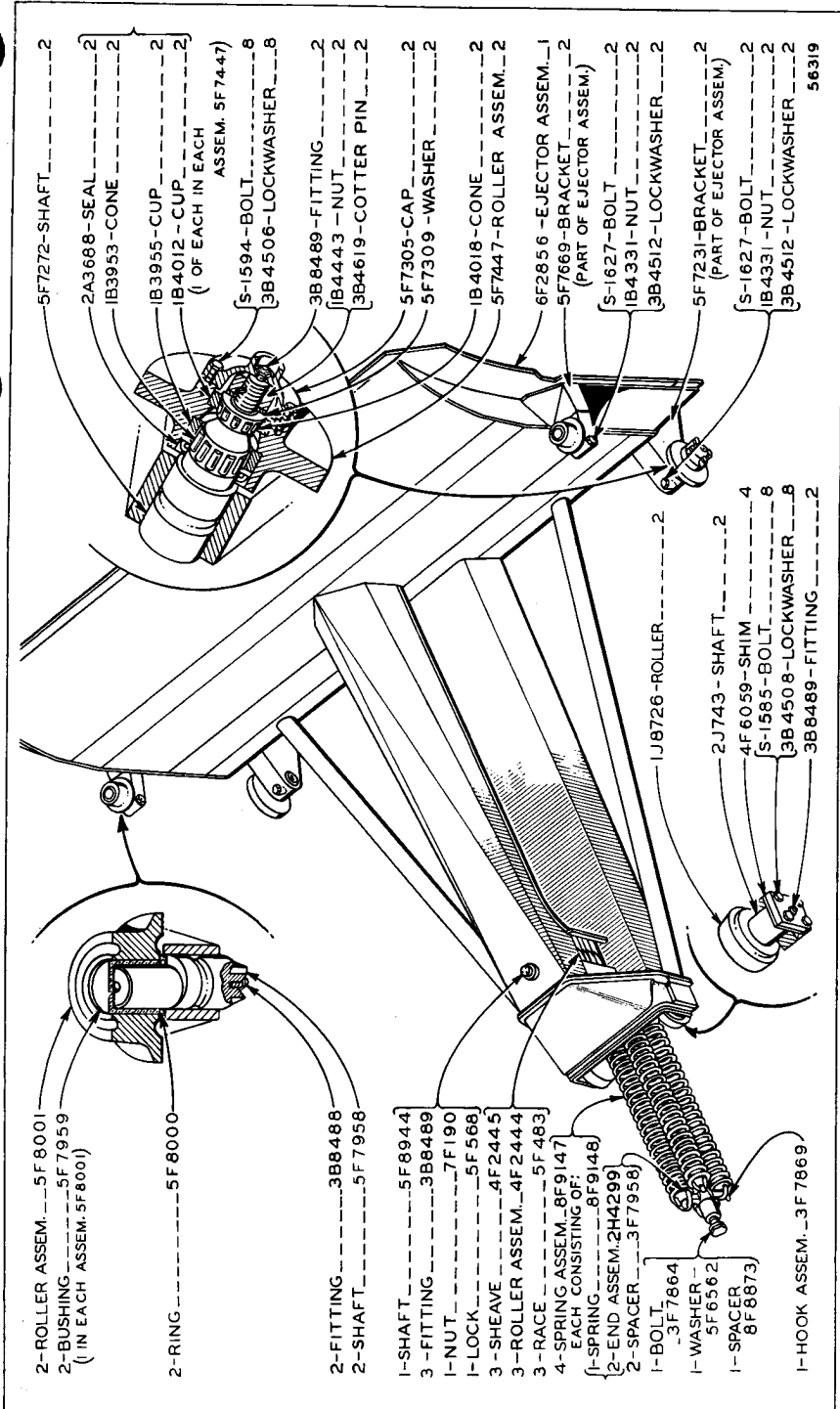

EJECTOR

Effective with Serial No. 2W6117

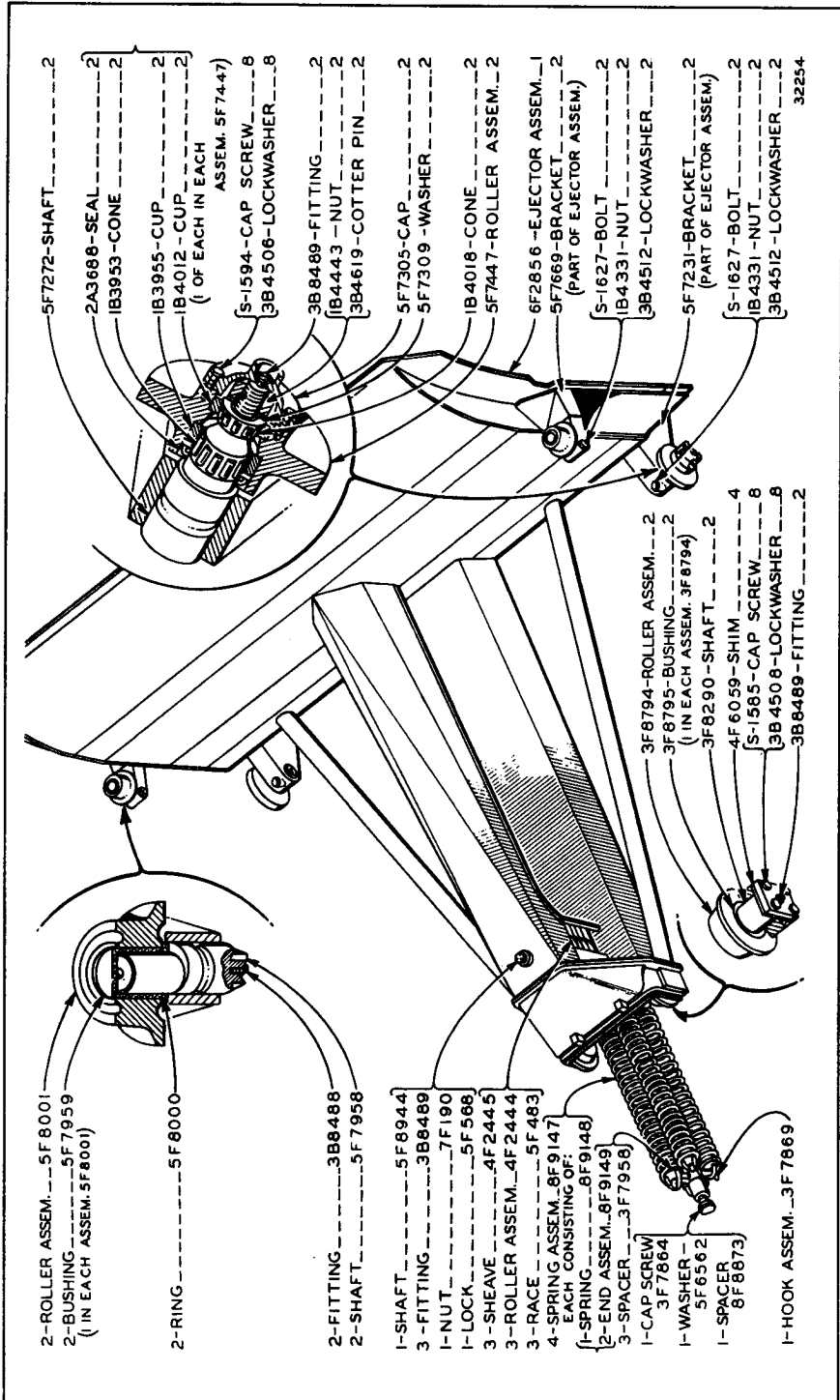

EJECTOR

ONLY "CATERPILLAR" PARTS GIVE "CATERPILLAR" PERFORMANCE

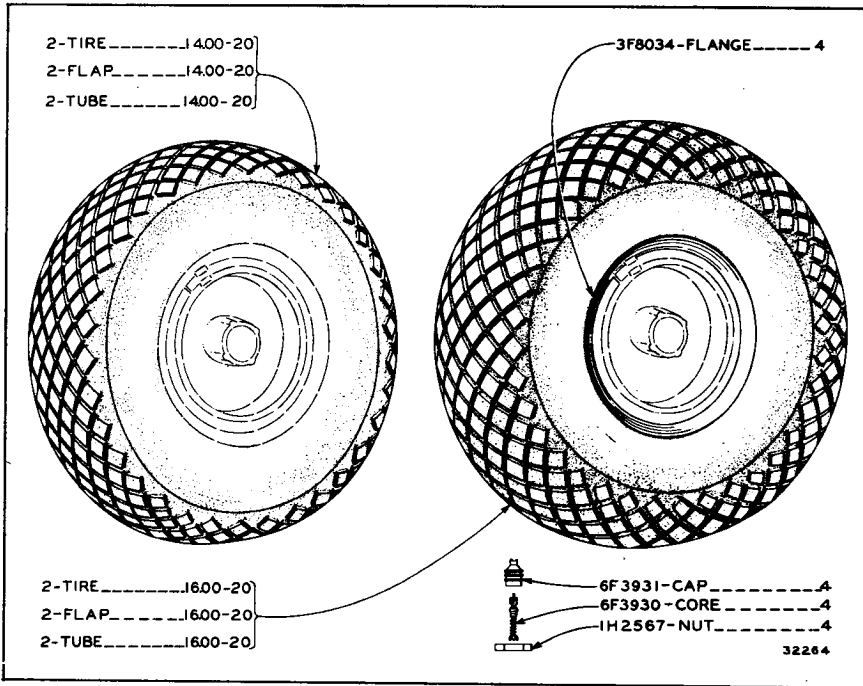

TIRES AND FLANGES—With Tubes
Serial No. 2W5001 to 2W5259 inclusive

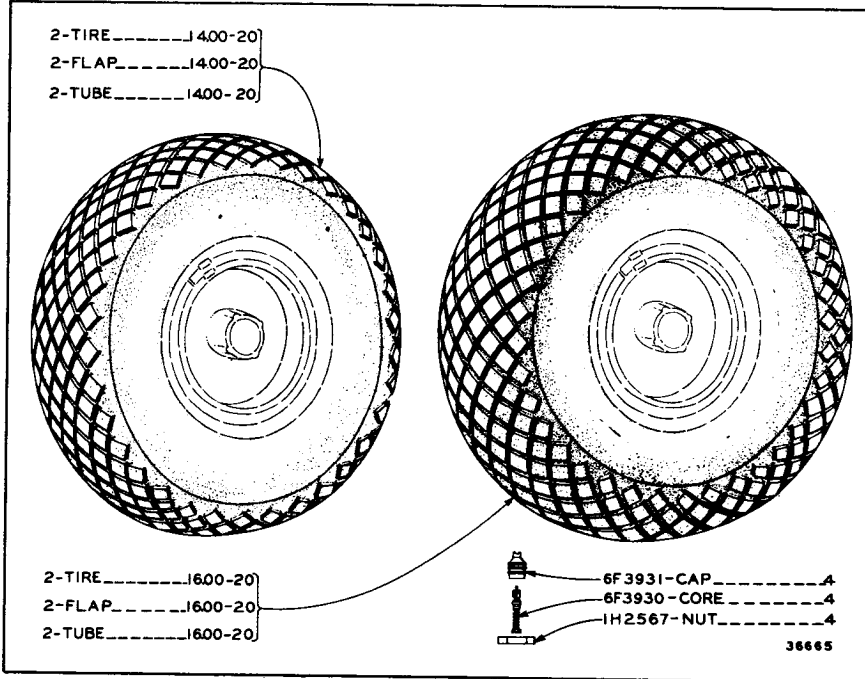

TIRES—With Tubes
Serial No. 2W5260 to 2W5748 inclusive

ALWAYS GIVE SERIAL NUMBER WHEN ORDERING PARTS

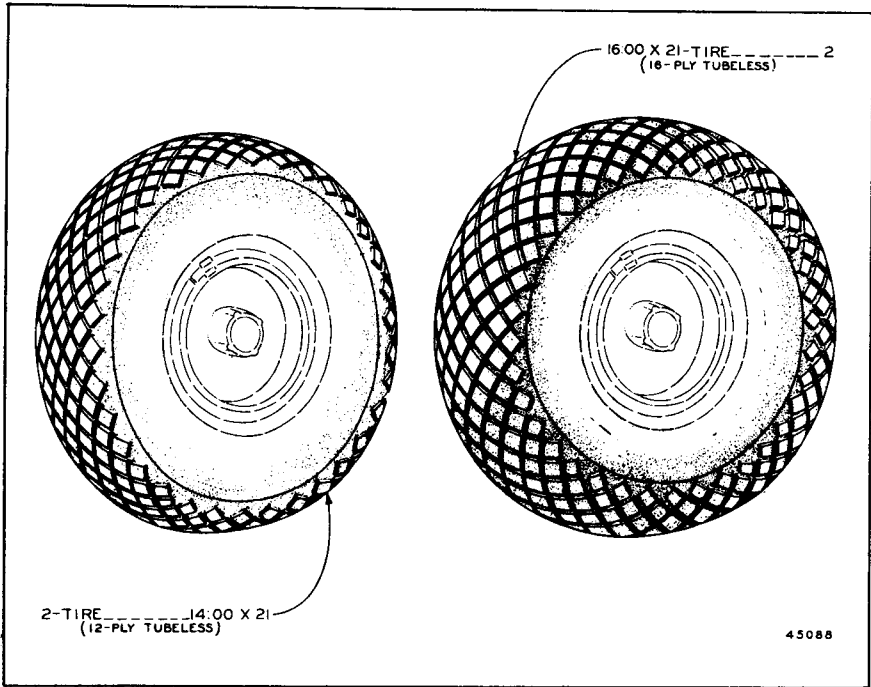

TIRES—Tubeless
Effective with Serial No. 2W5749

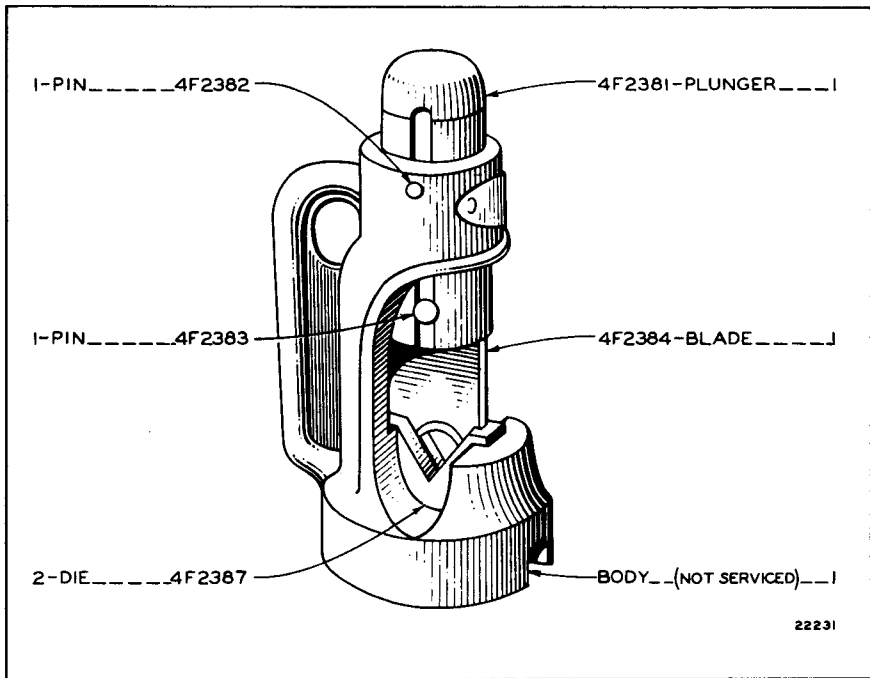

CABLE CUTTER

ONLY "CATERPILLAR" PARTS GIVE "CATERPILLAR" PERFORMANCE

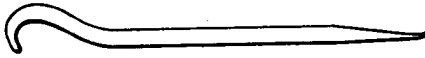

4 F5166
BAR-2
(PRY)



5F 9999
ADAPTER-1

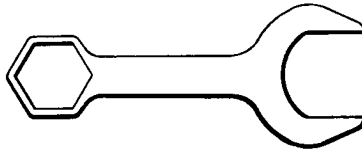

6F4580-WRENCH-1

46212

6F4568 TOOL GROUP

QUANTITY USED	PART NUMBER	DESCRIPTION
3	IH2633	Transfer—"Caterpillar"—6" High Rear side of Ejector
2	IH2650	Transfer—"Caterpillar"—2½" High Front of Draft Frame Spreader

TRANSFERS

ALWAYS GIVE SERIAL NUMBER WHEN ORDERING PARTS

MEMORANDA

ONLY "CATERPILLAR" PARTS GIVE "CATERPILLAR" PERFORMANCE

PART NO.	PAGE NO.	PART NO.	PAGE NO.	PART NO.	PAGE NO.	PART NO.	PAGE NO.
H-13054	12	1D4719	10	4F2377	10	6F4337	10
J-601	13	1D4720	6	4F2381	27	6F4411	13
L-1329	11	1D5976	6	4F2382	27	6F4415	13
S-509	2	2D374	22	4F2383	27	6F4427	13
S-1566	10	2D2507	9	4F2384	27	6F4428	13
S-1585	25	2D2508	9	4F2387	27	6F4447	12
S-1589	10	2D2509	9	4F2444	11	6F4448	12
S-1594	25	2D2510	9	4F2445	13	6F4454	12
S-1595	10	2D2511	9	4F2449	10	6F4580	28
S-1620	13	2D2625	9	4F2759	10	6F4612	23
S-1621	10	1F622	22	4F3191	6	6F4614	23
S-1624	12	1F635	22	4F3193	6	6F4727	11
S-1627	25	1F636	22	4F3213	6	6F4741	12
S-1756	10	1F891	22	4F3214	6	6F5106	13
T-772	6	2F1336	7	4F3258	6	6F6423	11
1A695	16	2F9143	5	4F3259	6	6F8244	10
1A1460	22	3F448	11	4F3333	7	6F6999	6
2A134	22	3F861	10	4F3334	6	6F9711	10
2A983	10	3F862	11	4F3344	9	6F9712	10
2A1538	6	3F956	11	4F3654	12	6F9715	10
2A3688	25	3F2622	22	4F3881	10	7F190	13
2A4576	6	3F3049	13	4F3883	10	7F2092	10
2A4577	7	3F3608	6	4F5166	28	7F2876	13
2A4590	15	3F3868	10	4F5932	10	7F3308	13
1B2886	11	3F3874	10	4F6059	25	7F5281	15
1B3921	13	3F3878	10	4F7471	22	7F5282	13
1B3922	13	3F3993	6	4F7960	12	7F5607	11
1B3925	6	3F4729	11	5F474	13	7F5603	11
1B3942	22	3F5131	6	5F483	11	7F5614	11
1B3953	25	3F5852	23	5F568	15	7F5616	11
1B3955	25	3F5950	6	5F2401	10	7F5624	11
1B4012	25	3F5951	6	5F2539	22	7F5625	11
1B4018	25	3F6154	10	5F5281	13	7F5626	11
1B4157	6	3F6329	11	5F5604	11	7F6087	6
1B4208	12	3F7590	24	5F6459	12	7F9878	11
1B4331	10	3F7603	24	5F6562	25	8F3037	10
1B4332	6	3F7610	24	5F6744	24	8F5991	13
1B4367	10	3F7611	24	5F6770	24	8F5992	13
1B4443	25	3F7827	10	5F6817	24	8F5993	13
2B7408	13	3F7834	10	5F7117	12	8F5994	13
3B489	11	3F7864	25	5F7149	13	8F8873	25
3B4506	6	3F7869	25	5F7231	25	8F9148	25
3B4507	6	3F7958	25	5F7272	25	8F9149	25
3B4508	10	3F8034	15	5F7305	25	8F9440	12
3B4510	6	3F8072	6	5F7309	25	9F1329	24
3B4512	6	3F8079	6	5F7447	25	9F1831	12
3B4514	10	3F8082	6	5F7669	25	9F4665	13
3B4614	6	3F8083	13	5F7958	25	9F4668	13
3B4615	10	3F8085	6	5F7959	25	9F4978	13
3B4618	7	3F8267	11	5F8000	25	9F5411	22
3B4619	25	3F8268	10	5F8001	25	9F5413	22
3B4627	13	3F8273	10	5F8210	12	9F5653	7
3B5319	6	3F8290	25	5F8212	10	9F5665	6
3B5657	13	3F8307	12	5F8213	10	9F5666	6
3B6487	13	3F8353	12	5F8944	25	9F5714	13
3B7283	13	3F8356	12	5F9003	10	9F6261	10
3B8486	11	3F8357	12	5F9004	10	9F6262	10
3B8488	25	3F8365	10	5F9143	13	9F9418	12
3B8489	6	3F8371	11	5F9648	11	9F9522	22
3B8491	11	3F8374	11	5F9999	28	1H1068	11
3B9116	13	3F8376	10	6F850	22	1H2292	10
3B9378	6	3F8378	11	6F1494	10	1H2350	10
4B4043	12	3F8379	11	6F2005	6	1H2567	26
4B4158	11	3F8384	10	6F2245	24	1H2633	28
4B4280	10	3F8389	11	6F2856	25	1H2650	28
4B4281	10	3F8522	23	6F3068	12	1H3046	12
4B4845	7	3F8794	25	6F3640	22	1H3047	12
4B5331	10	3F8795	25	6F3930	9	1H3054	14
5B5812	22	3F9452	10	6F3931	9	1H3055	12
6B3223	13	3F9560	10	6F4177	13	1H3056	12
7B5385	6	3F9588	6	6F4311	21	2H6522	15
7B7423	10	4F333	6	6F4312	21	2H9243	16
1D4566	11	4F1859	6	6F4313	13	2H9244	16
1D4599	6	4F2342	10	6F4314	13	3H206	12
1D4615	13			6F4316	13	3H2784	7

NUMERICAL PARTS INDEX

PART NO.	PAGE NO.	PART NO.	PAGE NO.	PART NO.	PAGE NO.	PART NO.	PAGE NO.
3H2884	15						
3H5242	8						
4H3721	7						
4H4616	22						
1J339	18						
1J598	22						
1J601	15						
1J1560	22						
1H2098	22						
1J2101	22						
1J2123	22						
1J2156	22						
1J2253	22						
1J4270	22						
1J4273	22						
1J4275	22						
1J4279	22						
1J4289	9						
1J4290	9						
1J4394	22						
1J4402	22						
1J4417	9						
1J4418	9						
1J4419	9						
1J4423	22						
1J4428	22						

SPECIFICATIONS

(SUBJECT TO CHANGE WITHOUT NOTICE)

Weight, shipping (approximate)..... 13,500 lbs.

CAPACITIES

Struck	7 cu. yds.
With 8" side boards	8.3 cu. yds.
Heaped, (based on 1:1 slope)	9 cu. yds.
With 8" side boards	10.5 cu. yds.

OVER-ALL DIMENSIONS

Length	28' 2"
Width	9' 4"
Height (Blade on ground)	7' 9"

CABLE

Ejection cable—size 1/2"	76'
Bowl lift—size 1/2"	60'
Apron lift—size 9/16"	19'

GENERAL

Wheelbase	16' 10"
Height of front apron	26"
Apron opening	54"
Height of ejector	60"
Height of sides	47"
Bottom dimensions	92" x 40"
Maximum depth of spread	13 1/2"
Width of cut	7' 8"

MACHINE SERIAL NUMBER PLATE LOCATION

Serial number plates are located on the left-hand side of the draft frame bolster, see page 11.