

TRANSMISSION TOP SHAFT

T-4025

USAGE: Models HD11B, E, ES, S, F

ITEM	PART NO.	QTY.	DESCRIPTION
1	623411	1	RETAINER, front bearing
2	028979	4	CAPSCREW, 1/2"NC x 2-1/2"
	904208	4	LOCKWASHER, 1/2"
3	628823	1	SEAL, oil, front bearing retainer
4	059261	1	GASKET, front bearing retainer
5	069463	1	SPACER, front bearing (1/2" thick)
6	057289	1	RING, snap, top shaft front bearing
7	057282	1	BEARING, roller, top shaft, front
8	069459	1	SLEEVE, spacing, front bearing
9	069461	1	SPACER, hi-range and 2nd reverse gear (3/8" thick)
10	069233	1	GEAR, hi-range and 2nd reverse (41 teeth)(Used prior to tractor #10001)
	644120	1	GEAR, hi-range and 2nd reverse (41 teeth)(Effective with tractor #10001)
11	643486	1	GEAR, lo-range (34 teeth)
12	069235	1	GEAR, 3rd reverse (46 teeth)
13	621678	1	SHAFT, top
14	069456	1	SLEEVE, spacing (3-7/8" long)
15	069240	1	GEAR, 1st reverse (21 teeth)
16	069428	1	BEARING, ball, top shaft, rear
17	069452	4	SHIM, bearing adjusting (.005" thick. Use as required)
18	078864	1	NUT, top shaft
19	069403	1	SLEEVE, rear bearing (Used prior to tractor #10001)
	641912	1	SLEEVE, rear bearing (Standard on tractors #10001 and up; also used on prior units with transmission dry sump conversion. See page 301)
20	621330	1	SCREW, sleeve locking
	904209	1	LOCKWASHER, 5/8"

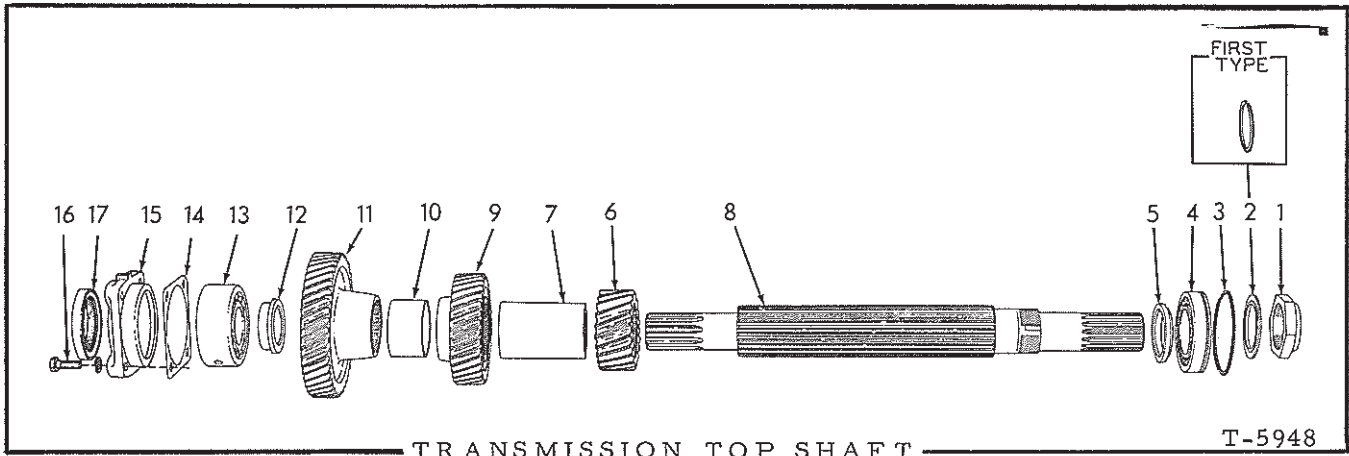

USAGE: Models HD11EC, FC

ITEM	PART NO.	QTY.	DESCRIPTION
1	078862	1	NUT
2	065512	1	RING, snap, rear bearing (small)(Used prior to tractor #10001)
	641493	1	SPACER, rear bearing nut (Standard on tractors #10001 and up; also used on prior units with transmission dry sump conversion. See page 301)
3	040831	1	RING, snap, rear bearing (large)
4	058135	1	BEARING, roller, rear
5	074818	1	SPACER, rear bearing
6	073808	1	GEAR, 1st speed (22 teeth)
7	069444	1	SLEEVE, spacing (4-9/16" long)
8	095960	1	SHAFT
9	073733	1	GEAR, 2nd speed and reverse (36 teeth)
10	069443	1	SLEEVE, spacing (1-3/4" long)
11	074838	1	GEAR, 3rd speed (46 teeth)
12	093713	1	SPACER, front bearing
13	074822	1	BEARING, ball, front
14	074842	7	SHIM, front bearing retainer (.003" thick. Use as required)
15	-----	1	RETAINER, front bearing (Used prior to tractor #6679. Order RETAINER 629041 and SEAL 629040)
	629041	1	RETAINER, front bearing (Effective with tractor #6679)
16	035236	4	CAPSCREW, 1/2"NC x 1-3/4"
	904208	4	LOCKWASHER, 1/2"
17	-----	1	SEAL, oil, front bearing retainer (5/8" wide)(Used prior to tractor #6679. Order SEAL 629040)
	629040	1	SEAL, oil, front bearing retainer (1/2" wide)(Effective with tractor #6679)

TRANSMISSION INTERMEDIATE SHAFT

USAGE: Models HD11B,E,ES,S,F

* Tractors prior to serial No. 6473
 ** Tractors serial No. 6473 and up

ITEM	PART NO.	QTY.		DESCRIPTION
		*	**	
1	621679	1	-	SHAFT, intermediate
	099026	-	1	SHAFT, intermediate
2	078864	1	1	NUT, intermediate shaft, rear
3	042121	1	1	RING, snap, rear bearing
4	057281	1	1	BEARING, roller, rear
5	069236	1	1	GEAR, 1st and 2nd speeds (22 teeth)
6	069457	1	1	SLEEVE, gear spacing (4-1/8" long)
7	069235	1	1	GEAR, 4th and 6th speeds (46 teeth)
8	069460	1	1	SLEEVE, gear spacing (1-5/16" long)
9	069239	1	1	GEAR, 3rd and 5th speeds (41 teeth)
10	069238	1	1	GEAR, low range (40 teeth)
11	069382	2	-	BEARING, roller, low range gear
	623667	-	1	BUSHING, low range gear
12	069254	1	1	HUB, shifting collar and low range gear
13	069243	1	-	COLLAR, shifting
	099899	-	1	COLLAR, shifting (7/16" groove)(Used prior to tractor #11382)
	647321	-	1	COLLAR, shifting (5/8" groove)(Effective with tractor #11382)
14	069458	1	1	WASHER, spacing, high-range gear
15	069389	1	1	RACE, inner, high-range gear
16	069384	2	-	BEARING, roller, high-range gear
	623666	-	1	BUSHING, high-range gear
17	069237	1	1	GEAR, high-range (32 teeth)(Used prior to tractor #10001)
	644121	-	1	GEAR, high-range (32 teeth)(Effective with tractor #10001)
18	069465	1	1	WASHER, spacing, front bearing (Used prior to tractor #10001)
	644117	-	1	WASHER, spacing, front bearing (Effective with tractor #10001)
19	054229	1	1	BEARING, ball, front (Includes snap ring)
20	078860	1	1	NUT, intermediate shaft, front
21	044741	1	-	SEAL, oil retaining

(Continued)

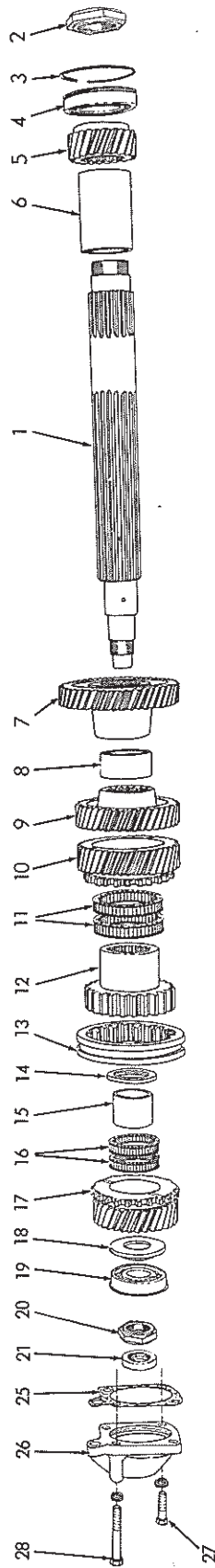

FIRST TYPE

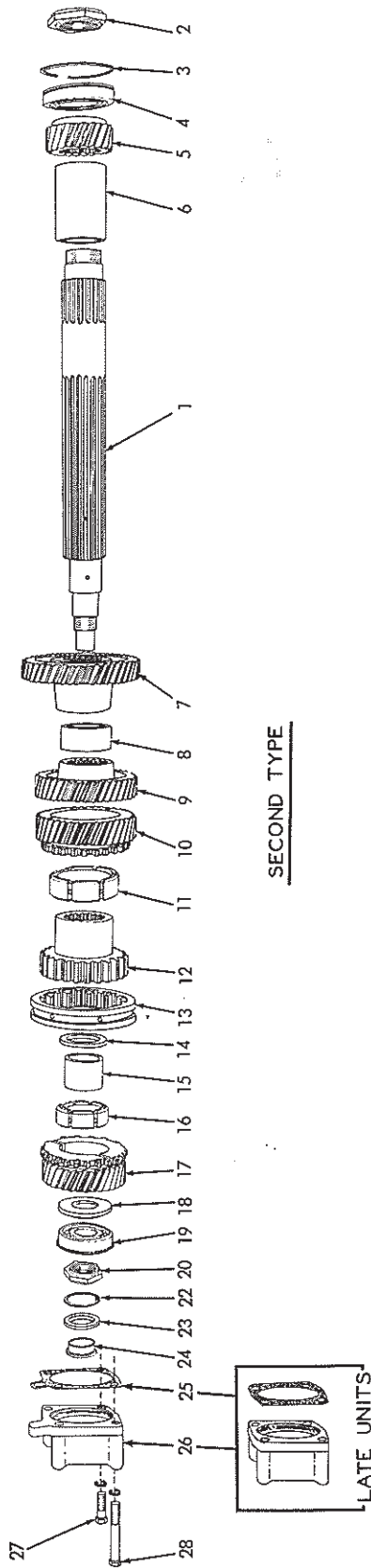

SECOND TYPE

TRANSMISSION INTERMEDIATE SHAFT (Continued)

ITEM	PART NO.	QTY.		DESCRIPTION
		*	**	
22	621446	-	1	RING, snap
23	621332	-	1	RING, oil sealing, outer
24	621333	-	1	RING, oil sealing, inner
25	{ 069514	1	1	GASKET, bearing retainer (Used prior to tractor #10001)
	{ 634996	-	1	GASKET, bearing retainer (Effective with tractor #10001)
26	{ 069401	1	-	COVER, front bearing
	{ 099023	-	1	RETAINER, front bearing (Used prior to tractor #10001)
	{ 644113	-	1	RETAINER, front bearing (Effective with tractor #10001)
27	035061	3	1	CAPSCREW, 1/2"NC x 1-1/4"
28	{ 041877	1	-	CAPSCREW, 1/2"NC x 3"
	{ 061631	-	3	CAPSCREW, 1/2"NC x 3-1/2"
	{ 904208	4	4	LOCKWASHER, 1/2"

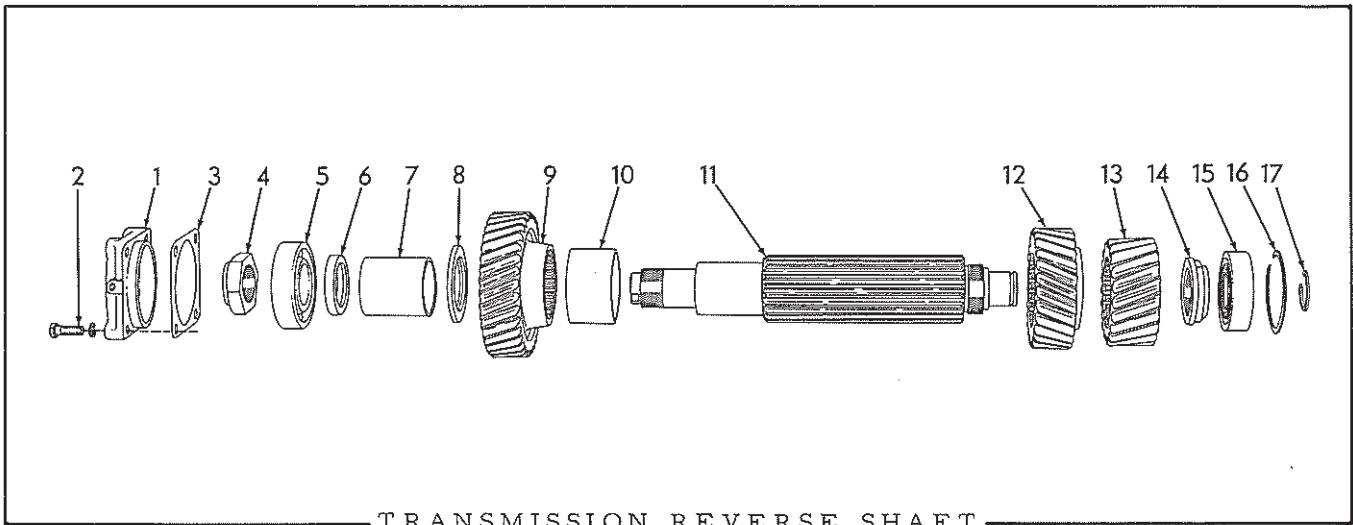

TRANSMISSION REVERSE SHAFT

USAGE: Models HD11EC, FC

ITEM	PART NUMBER	QTY.	DESCRIPTION.
1	098968	1	RETAINER, front bearing
2	035712	4	CAPSCREW, 1/2"NC x 2-1/4"
	904208	4	LOCKWASHER, 1/2"
3	074841	7	SHIM, adjusting (.003" thick. Use as req'd)
4	079234	1	NUT, front
5	090645	1	BEARING, ball, front
6	074817	1	SPACER, front bearing
7	074814	1	SLEEVE, gear retaining (2-1/2" long)
8	074815	1	WASHER, gear retaining
9	073733	1	GEAR, 2nd reverse (36 teeth)
10	069443	1	SLEEVE, gear spacing (1-3/4" long)
11	098958	1	SHAFT, reverse
12	073738	1	GEAR, reverse (28 teeth)
13	073808	1	GEAR, 1st reverse (22 teeth)
14	079256	1	NUT, rear
15	052049	1	BEARING, roller, rear
16	052374	1	RING, snap, rear bearing
17	052225	1	RING, snap, reverse shaft

TRANSMISSION PINION SHAFT

USAGE: Models HD11B, E, ES, S, F

* Tractors prior to serial No. 6473
 ** Tractors serial No. 6473 and up

ITEM	PART NO.	QTY. * **	DESCRIPTION
1	095725	1 -	PINION, bevel (11 teeth)(If for tractors prior to #4529, equipped with Odometer, also order 1 PLATE 095673, 1 NUT 095675, 2 SPACER 095676 and 2 CAPSCREW 011089)
	098998	- 1	
2	098996	- 1	PLUG, pinion oil hole } Used prior to tractor #8807
3	098997	- 1	
4	067627	1 1	RING, snap, rear bevel pinion bearing
5	057283	1 1	BEARING, roller, bevel pinion, rear
6	069469	1 1	SPACER, rear bevel pinion bearing (Used prior to tractor #10001) and up; also used on prior units with transmission dry sump conversion. See page 301)
	641909	- 1	
7	069454	3 3	WASHER, gear spacing
8	069385	12 -	BEARING, roller, pinion shaft gears
9	069462	4 -	SPACER, gear bearing (7/16" long)
10	623668	- 4	BUSHING, pinion shaft gears (2" long)
11	623669	- 2	BUSHING, pinion shaft gears (1-9/16" long)
12	069245 679998	1 1	GEAR, 3rd and 5th speed (55 teeth)
13	069242	1 -	HUB, 2nd reverse and 3rd and 5th speed gears
	099003	- 1	
14	069244	3 -	COLLAR, shifting (7/16" groove)(Used prior to tractor #11592) (Effective with tractor #11592)
	099897	- 3	
	650696	- 3	
15	643487	1 1	GEAR, 2nd reverse (55 teeth)
16	069246	2 2	GEAR, 3rd reverse and 4th and 6th speed (48 teeth)
17	069247	1 -	HUB, 3rd reverse and 4th and 6th speed gears
	099002	- 1	
18	069248	2 2	GEAR, 1st reverse and 1st and 2nd speed (62 teeth)
19	069249	1 -	HUB, 1st reverse and 1st and 2nd speed gears
	099001	- 1	

(Continued)

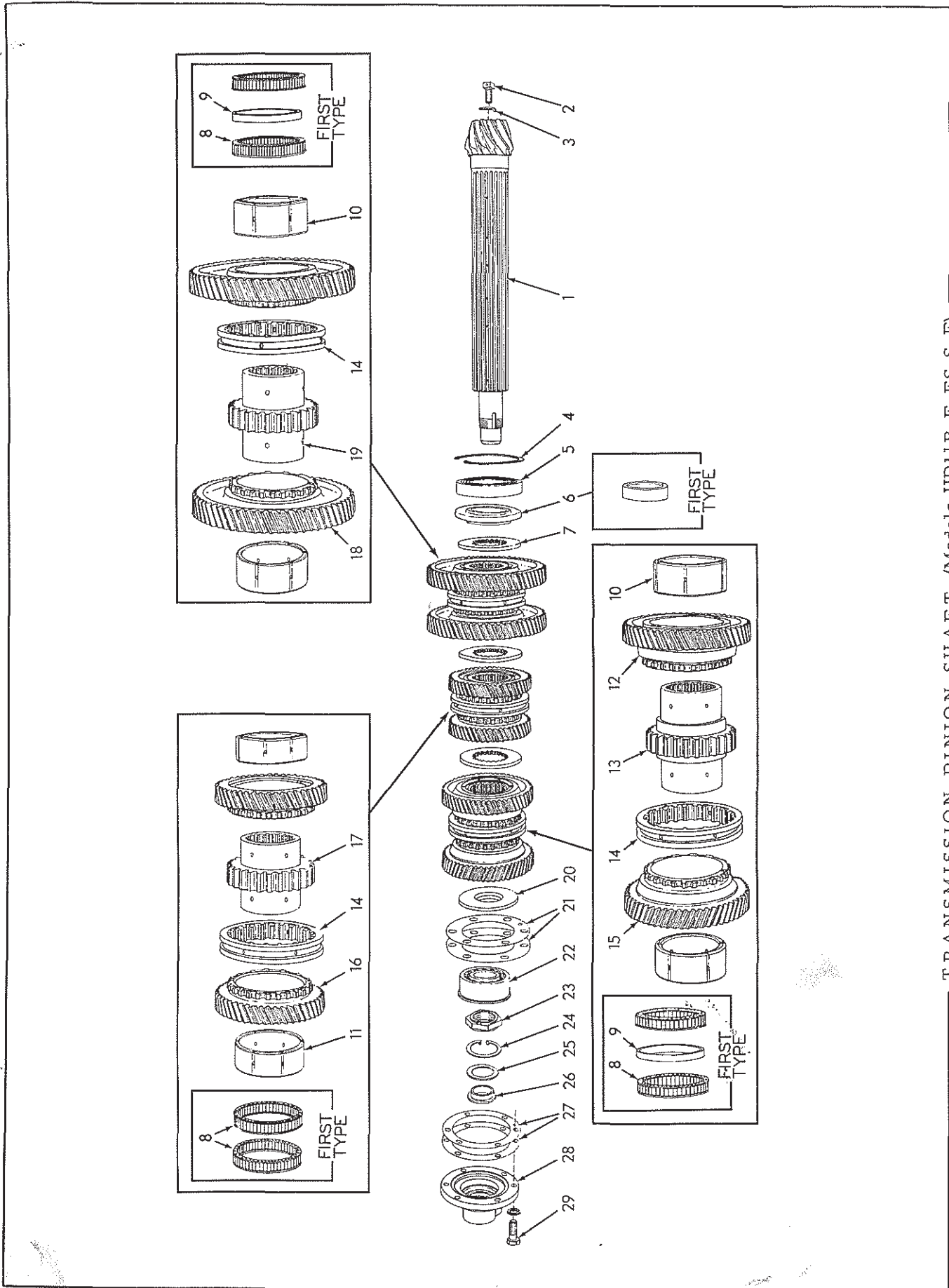

TRANSMISSION PINION SHAFT (Models HD11B, E, ES, S, F)

TRANSMISSION PINION SHAFT (Continued)

ITEM	PART NO.	QTY.		DESCRIPTION	
		*	**		
20	069455	1	1	WASHER, spacing, pinion front bearing	
21	069511	1	1	SHIM, adjusting (.005" thick. Use as required)	
	069512	8	8	SHIM, adjusting (.010" thick. Use as required)	
22	043890	1	1	BEARING, ball, bevel pinion, front (Includes snap ring)	
23	078861	1	1	NUT, bevel pinion (Also see ODOMETER for special nut)	
24	621445	-	1	RING, snap	
25	621334	-	1	RING, oil sealing, outer	
26	621335	-	1	RING, oil sealing, inner	
27	069445	3	3	SHIM, adjusting (.007" thick. Use as required)	
	069446	3	3	SHIM, adjusting (.005" thick. Use as required)	
28	069366	1	-	COVER, front bearing	} See ODOM- ETER for special cover
	099021	-	1	COVER, front bearing (Used prior to tractor #10001)	
	643979	-	1	COVER, front bearing (Effective with tractor #10001)	
29	035190	6	6	CAPSCREW, 1/2"NC x 1-1/2"	
	904208	6	6	LOCKWASHER, 1/2"	

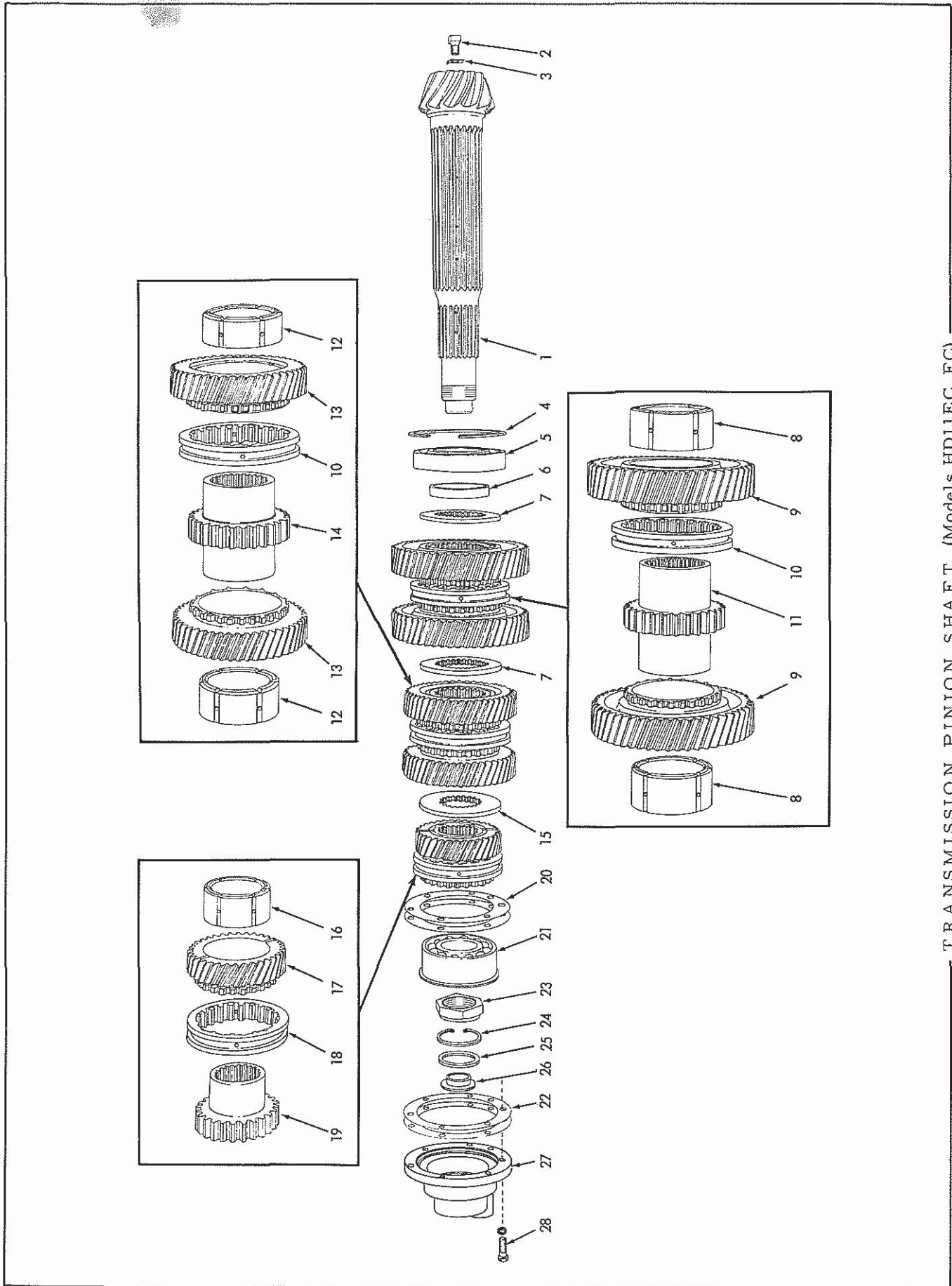

TRANSMISSION PINION SHAFT (Models HD11EC, FC)

TRANSMISSION PINION SHAFT

USAGE: Models HD11EC,FC

ITEM	PART NO.	QTY.	DESCRIPTION
1	620753	1	PINION, bevel (11 teeth)
2	098996	1	PLUG, pinion oil hole } Used prior to tractor #10001
3	098997	1	
4	059589	1	RING, snap, rear bearing
5	059328	1	BEARING, roller, rear
6	069427	1	SPACER, rear bearing (Used prior to tractor #10001) SPACER, rear bearing (Standard on tractors #10001 and up; also used on prior units with transmission dry sump conversion. See page 301)
	643647	1	
7	069386	2	WASHER, gear retaining
8	623334	2	BUSHING, 1st speed gear
9	081202	2	GEAR, 1st reverse and 1st speed (51 teeth)
10	099898	2	COLLAR, shifting (7/16" groove)(Original equipment) COLLAR, shifting (5/8" groove)(Service replacement transmissions)
	650745	2	
11	098957	1	HUB, 1st reverse and 1st speed gears
12	623338	2	BUSHING, 2nd speed gear
13	081200	2	GEAR, 2nd reverse and 2nd speed (48 teeth)
14	098956	1	HUB, 2nd reverse and 2nd speed gears
15	074824	1	WASHER, gear retaining
16	623667	1	BUSHING, 3rd speed gear
17	081201	1	GEAR, 3rd speed (35 teeth)
18	099899	1	COLLAR, shifting, 3rd speed (7/16" groove)(Original equipment) COLLAR, shifting, 3rd speed (5/8" groove)(Service replacement transmissions)
	647321	1	
19	098955	1	HUB, 3rd speed gear
20	069447	4	SHIM, adjusting, pinion depth (.005" thick. Use as required) SHIM, adjusting, pinion depth (.010" thick. Use as required)
	069448	6	
21	048698	1	BEARING, ball, front (Includes snap ring)
22	069445	7	SHIM, cover adjusting (.007" thick. Use as required) SHIM, cover adjusting (.005" thick. Use as required)
	069446	7	
23	078862	1	NUT, bevel pinion
24	621445	1	RING, snap
25	621334	1	RING, oil sealing, outer
26	621335	1	RING, oil sealing, inner
27	098923	1	COVER, bearing (Used prior to tractor #10001) COVER, bearing (Effective with tractor #10001)
	643614	1	
28	035190	6	CAPSCREW, 1/2"NC x 1-1/2" LOCKWASHER, 1/2"
	904208	6	