

DRIVE TRAIN

-18-

SECTION 07

REF. NO.	PART NUMBER	DESCRIPTION	TC-210
----------	-------------	-------------	--------

FINAL DRIVE AND SPROCKET

DRIVE TRAIN

-18-

SECTION 07

REF. NO.	PART NUMBER	DESCRIPTION	TC-210
----------	-------------	-------------	--------

FINAL DRIVE AND SPROCKET -CONTINUED

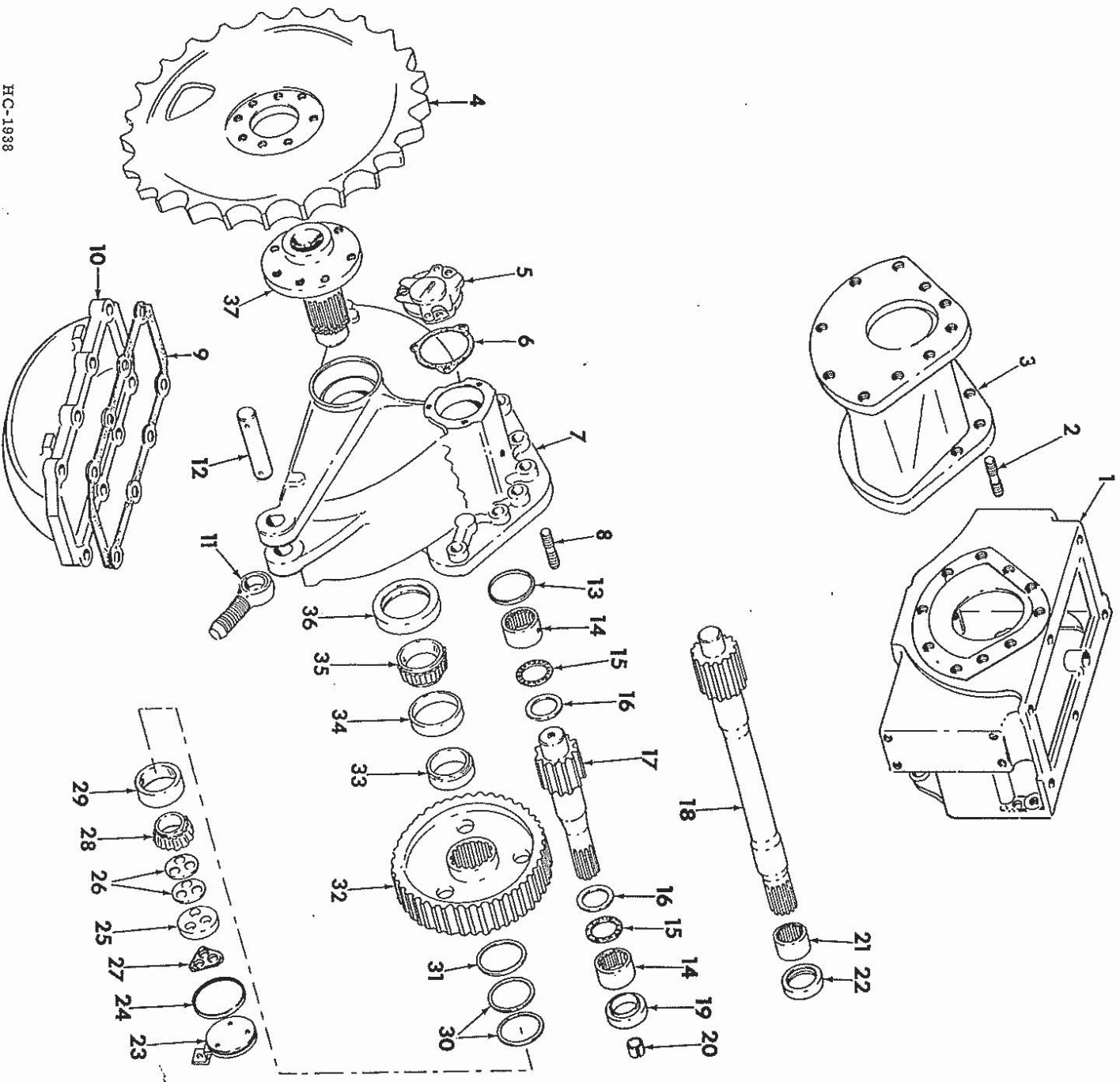

HC-1988

1	852 386 C91	HOUSING ASSY, STEERING CLUTCH RH--SHOWN--
1	852 385 C91	HOUSING ASSY, STEERING CLUTCH LH REFER TO STEERING DRIVE
2	676 108 R1	STUD, GAUGE SPACER MOUNTING -14-- -68 INCH TRACK MIDTH-
	225 861	NUT, 5/8-18 HEX TYPE 8 -14--

3	850 696 C1	SPACER, FINAL DRIVE GAUGE -2-- -68 INCH TRACK MIDTH-
	444 692	PLUG, 1/4 C-2 HEX SKT PIPE -2-
	223 817	BOLT, 5/8-18 X 3-1/2 HEX TYPE 8 -6-
	225 861	NUT, 5/8-18 HEX TYPE 8 -6-

DRIVE TRAIN SECTION 07  
-19-

REF. NO.	PART NUMBER	DESCRIPTION	TC-210
		FINAL DRIVE AND SPROCKET -CONTINUED	
4	852 474 C1	SPROCKET ASSY, TRACK DRIVE -2-	
	223 809	BOLT, 5/8 X 1-1/2 HEX-HD TYPE 8 -16-	
5	676 863 R1	RETAINER, PINION SHAFT -2-	
	180 124	BOLT, 3/8-16 X 1-1/4 HEX-HD -6-	
	120 382	WASHER, 3/8 LOCK -6-	
6	676 865 R1	SHIM, RETAINER - .010 -2-	
7	852 623 C91	HOUSING ASSY, FINAL DRIVE RH -SHOWN-	
		-CONSISTS OF	
	1 HOUSING RH	852 519 C1	
	1 CUP	625 743 C1	
	1 CUP	529 453 R1	
	2 PLUG	444 692	
7	852 622 C91	HOUSING ASSY, FINAL DRIVE LH	
		-CONSISTS OF	
	1 HOUSING LH	852 518 C1	
	1 CUP	625 743 C1	
	1 CUP	529 453 R1	
	2 PLUG	444 692	
8	676 108 R1	STUD, FINAL DRIVE MOUNTING -16-	
	225 861	NUT, 5/8-18 HEX-TYPE 8 -16-	
9	852 521 C1	GASKET, HOUSING OIL PAN -2-	
10	852 520 C1	PAN, HOUSING OIL -2-	
	444 692	PLUG, 1/4-14 HEX SKT PIPE C-2 -8-	
	180 175	BOLT, 1/2-13 X 1-1/4 HEX-HD -20-	
11	852 536 C1	BOLT, FINAL DRIVE STOP EYE -2-	
	25 762 R1	NUT, 1-1/8-7 HEX-TYPE 8 PHC -2-	
	272 139	NUT, 1-1/8-7 HEX-JAM -2-	
	25 862 R1	WASHER, 1.250 X 2.250 X .250 GA	
12	852 533 C1	PIN, EYE BOLT MOUNTING -2-	
	25 489 R1	BOLT, 1/4-20 X 1-3/4 HEX-HD TYPE 8	
	25 519 R1	PHC -4-	
		NUT, 1/4-20 HEX-TYPE 8 PHC -8-	
13	354 836 R1	O RING, RETAINER -2-	
14	111 980 R91	BEARING, PINION SHAFT- INNER/OUTER -4-	
15	584 268 R91	BEARING, PINION SHAFT THRUST -4-	
16	675 704 R1	RACE, PINION SHAFT THRUST -4-	
17	852 522 C1	SHAFT ASSY, FINAL DRIVE PINION -2-	
		- INCLUDES BUSHING 676 862 R1-	
		-50 INCH TRACK WIDTH	
18	852 700 C1	SHAFT ASSY, FINAL DRIVE PINION -2-	
		- INCLUDES BUSHING 676 862 R1-	
		-68 INCH TRACK WIDTH-	
19	676 032 R91	SEAL, PINION SHAFT OIL -2-	
		-50 INCH TRACK WIDTH	
20	676 862 R1	BUSHING, BEVEL GEAR SHAFT -2-	
21	676 871 R91	BEARING, PINION SHAFT INNER -2-	
		-68 INCH TRACK WIDTH-	
22	676 032 R91	SEAL, PINION SHAFT OIL	
		-68 INCH TRACK WIDTH-	
23	852 530 C1	PLUG ASSY, BULL GEAR SHAFT ACCESS-2-	
	180 120	BOLT, 3/8-16 X 3/4 HEX-HD -2-	
	120 382	WASHER, 3/8 LOCK -2-	
24	381 109 R1	RING, ACCESS HOLE PLUG SEAL -2-	
25	852 525 C1	RETAINER, BULL GEAR SHAFT -2-	
	180 175	BOLT, 1/2-13 X 1-1/4 HEX-HD -6-	
26	852 624 C91	SET, INNER BEARING SHIM	
		-CONSISTS OF	
		\$5 SHIM .002	
		\$5 SHIM .005	

DRIVE TRAIN SECTION 07  
-19-

REF. NO.	PART NUMBER	DESCRIPTION	TC-210
		FINAL DRIVE AND SPROCKET -CONTINUED	
27	852 528 C1	WASHER, RETAINER BOLT LOCK -2-	
28	625 742 C91	CONE, BULL GEAR SHAFT INNER BRG -2-	
29	625 743 C1	CUP, BULL GEAR SHAFT INNER BRG -2-	
30	852 534 C1	RING, BULL GEAR INNER RETAINING -4-	
31	852 535 C1	RING, BULL GEAR INNER SHIM -4-	
		USE AS READ	
32	676 872 R1	GEAR, FINAL DRIVE BULL -49T -2-	
33	852 529 C1	SPACER, BULL GEAR OUTER -2-	
34	529 453 R1	CUP, BULL GEAR SHAFT OUTER BRG -2-	
35	529 452 R91	CONE, BULL GEAR SHAFT OUTER BRG -2-	
36	677 917 R91	SEAL, BULL GEAR SHAFT OIL -2-	
37	852 524 C1	SHAFT, BULL GEAR -2-	
		DRIVE ASSY, FINAL LH	
		-CONSISTS OF	
	1 HOUSING ASSY	852 622 C91	
	1 GASKET	852 521 C1	
	1 PAN	852 520 C1	
	2 PLUG	444 692 C1	
	10 BOLTS	180 175	
	1 SEAL	676 032 R91	
	1 BEARING	111 980 R91	
	1 GEAR	676 872 R1	
	2 RING	852 535 C1	
	2 RING	852 534 C1	
	1 SPACER	852 529 C1	
	1 SHAFT	852 524 C1	
	1 SEAL	677 917 R91	
	1 CONE	529 452 R91	
	1 SET	625 742 C91	
	1 RETAINER	852 624 C91	
	3 BOLTS	852 525 C1	
	1 WASHER	180 175	
	1 PLUG ASSY	852 530 C1	
	1 BOLT	180 120	
	1 WASHER	120 382	
	1 RING	381 109 R1	
		DRIVE ASSY, FINAL RH	
		-CONSISTS OF	
	1 HOUSING ASSY	852 623 C91	
	1 GASKET	852 521 C1	
	1 PAN	852 520 C1	
	2 PLUG	444 692 C1	
	10 BOLTS	180 175	
	1 SEAL	676 032 R91	
	1 BEARING	111 980 R91	
	1 GEAR	676 872 R1	
	2 RING	852 535 C1	
	2 RING	852 534 C1	
	1 SPACER	852 529 C1	
	1 SHAFT	852 524 C1	
	1 SEAL	677 917 R91	
	1 CONE	529 452 R91	
	1 SET	625 742 C91	
	1 RETAINER	852 624 C91	
	3 BOLTS	852 525 C1	
	1 WASHER	180 175	
	1 PLUG ASSY	852 530 C1	
	1 BOLT	180 120	
	1 WASHER	120 382	
	1 RING	381 109 R1	
		PACKAGE, FINAL DRIVE GASKET AND SEAL	
		-CONSISTS OF	
	1 O-RING	354 836 R1	
	6 SHIM	676 865 R1	
	1 GASKET	852 521 C1	
	1 SEAL	676 032 R91	
	1 SEAL	677 917 R91	
	1 RING	381 109 R1	